



**CITY OF KEY WEST
CERTIFICATE OF SUBSTANTIAL COMPLETION**

PROJECT CODE / NAME: TRUMAN WATERFRONT PARK PHASE 1A

DATE: July 18, 2017

TO CONTRACTOR: Charlie Toppino and Sons, Inc.
P.O. Box 787
Key West, Florida 33040

This Certificate of Substantial Completion to NTP 1 Phase 2 generally applies to the area between approximately the EcoDiscovery Center, the Pedestrian Sidewalk Circle and the Shipyard Condominiums). The Work to which this Certificate applies has been inspected by authorized representatives of OWNER, CONTRACTOR, AND/OR ENGINEER and that Work is hereby declared to be substantially complete in accordance with the Contract Documents on

June 29, 2017

DATE OF (PARTIAL) SUBSTANTIAL COMPLETION

A list of items associated with the section of work to be completed or corrected are indicated on the attached Substantial Completion Punch List dated July 6, 2017. This list may not be all- inclusive, and the failure to include an item in it does not alter the responsibility of CONTRACTOR to complete all the Work in accordance with the Contract Documents.

IN WITNESS WHEREOF, the parties execute below:

Owner: THE CITY OF KEY WEST

Contractor: Charlie Toppino and Sons, Inc.

By: 

By: 

Title: **Director of Engineering**

Title: 

Dated this 18th day of July, 2017

Dated this 25 day of July, 2017



SUBSTANTIAL COMPLETION PUNCH LIST

To:	Gary Volenec, P.E.
From:	Kirk J. Olney, RLA
Project:	Truman Waterfront Park
RE:	Seagrape Parking (NTP1 PH2) Substantial Completion Walkthrough
Substantial Walkthrough:	June 29, 2017
Conditions During Visit:	Sunny and 88°
Initial Distribution Date:	July 6, 2017
BA Project No.:	14041
Present for Walkthrough:	Gary Volenec, City Engineer – City of Key West Steve Gardner – City of Key West Kirk Olney, Landscape Architect – Bermello Ajamil & Partners, Inc. Allen Perez, Civil Engineer – Perez Engineering Andi Fraley, Project Manager – Charley Toppino & Sons Leo Montiel, Construction Superintendent – Charley Toppino & Sons Evan Bell, Landscape Contractor – Ecoscapes Rick DeKeyser – Blue Island Irrigation
CC:	Randy Hollingworth – Bermello Ajamil & Partners, Inc. Jim Bouquet – City of Key West Andi Fraley – Charley Toppino & Sons

A substantial completion walkthrough inspection was performed at Truman Waterfront Park for NTP1 Phase 2 which, generally, is the Seagrape Parking Lots, west to the pedestrian traffic circle as well as the area between the Eco-Discovery Center and the boat ramp. Below is a list of items deemed not in compliance with the contract documents. All of the below punch list items will need to be corrected before final acceptance.

GENERAL

1. Wayfinding and regulatory signage has not been installed.
2. Wayfinding uprights are not installed.
3. Pavement striping remains to be completed upon asphalt curing.

CIVIL ENGINEERING

1. Provide asphalt density test results.
2. Provide City with sanitary sewer video/test results.
3. Provide City with final as-builts for storm and sanitary sewer.

4. There is asphalt on the concrete curbs.



HARDSCAPE FURNITURE & PAVING

1. Furniture is not installed.
2. Truncated dome pavers are dirty.



LANDSCAPE

1. There are weeds in landscape beds
2. At the west corner of the TACTS Tower site, under the existing Seagrape and Gumbo Limbo trees, the grade next to the sidewalk is too extreme.



3. Near Angela Street at the northern exit to the southern parking lot, add gravel to the backside of the furniture pad.



4. There are concrete chunks in the landscape.



5. The grass edge at the Seagrape mulch is not smooth.



6. The Silver Bismarck Palms are not installed per the plan and are not on the centerline axis of the sidewalk from Angela Street. This situation being a formal application of the landscape, the palms need to be centered on the sidewalk.

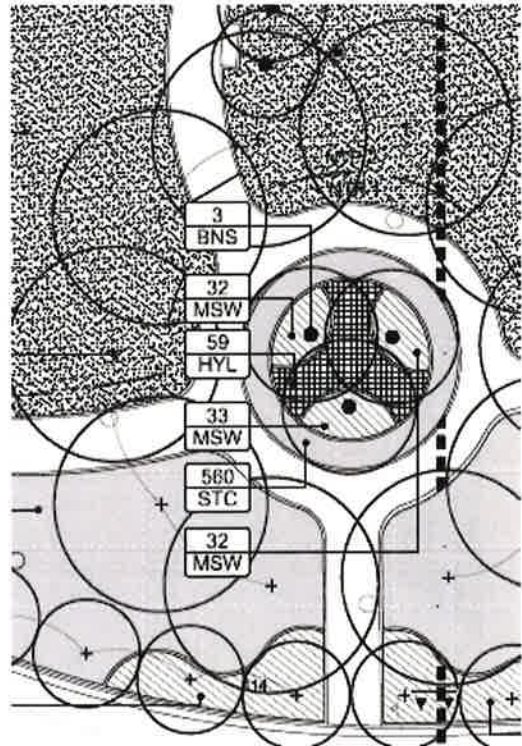

IRRIGATION

1. In the Seagrape Parking lot there is a grass spray head missing at the end of one the landscape islands.
2. At the Eco-Discovery Center, there is a stub out pipe sticking out of the grass.



3. At the Eco-Discovery Center, there is a rotor not operating properly.



4. At the Eco-Discovery Center at the base of one of the relocated Gumbo Limbo trees, the bubbler funny pipe is exposed.



While every attempt has been made to be as comprehensive and as detailed as possible with this list, any and all unfinished items based on the original contract documents and approved changes that do not appear on this list shall continue to be as specified on the original documents and shall be completed as specified.

END OF PUNCH LIST