



City of Key West, Florida

Request for Qualifications

RFQ #17-003

General Landscape Architectural Services

Submitted By:



FERNANDEZ-BERAUD, INC.
Landscape Architecture and Planning

717 Ponce de Leon Boulevard, Suite 223
Coral Gables, Florida 33134

Telephone: (305) 567-0110

Contact: Leticia Fernandez-Beraud, RLA

19 July 2017



July 19th, 2017

City of Key West
Office of the City Clerk
1300 White Street
Key West, Florida 33040

We are pleased to present to the City of Key West the following Request for Qualifications response: RFQ #17-003 – General Landscape Architectural Services

Our firm has an informed appreciation of Key West's history. We understand the City's strong sense of community and its commitment to integrate art and culture into the everyday experience of residents and visitors. We are excited by the opportunity for our team to participate in Key West's future.

Fernandez-Beraud, Inc. is a full-service Landscape Architecture and Planning firm, established as a Woman-owned, Small Business Entity in 2004 in South Florida. Our work has been developed primarily in the public sector, with team members offering decades of professional experience in Parks and Recreation design, including Historical Park preservation/restoration, coastal and waterfront environmental restoration, Contemporary Park planning and design, play sites, streetscapes, bike paths and pedestrian walks, and in roadway and infrastructure enhancements.

We specialize in Crime Prevention through Environmental Design (CPTED), Aesthetic Enhancement studies, concept studies, facilities planning, master planning, design development and final design, permitting and bidding assistance; we author and illustrate landscape maintenance guideline manuals, and serve in construction observation/administration. Construction observation is a critical element of our professional services. A good design can only be realized with thorough and responsible construction observation. Our initial attention to site conditions and details is fundamental to a quality and cost-efficient final product that will maximize the success of our work for the City of Key West.

As a Small Business Entity, our work involves "hands-on", direct interaction with and among our company principals in every project. We apply our decades of personal/professional experience to every phase of project development and delivery.

We truly look forward to working with the City of Key West.

Respectfully,

A handwritten signature in blue ink, appearing to read "Leticia Fernandez-Beraud".

Leticia Fernandez-Beraud, RLA
President





INDEX

| | |
|---|----|
| Cover Letter | 01 |
| Index | 02 |
| Firm Profile | 04 |
| Projects | 09 |
| Professional Resumes | 21 |
| Quality Assurance / Quality Control and Schedule Management | 46 |
| Business License; Professional Licenses; USGBC LEED Certificates; Proof of Insurance | 47 |
| Forms and Affidavits | 51 |





FERNANDEZ - BERAUD INC

Landscape Architecture and Planning

2004-2017 - Thirteen years in business in Florida



Florida Corporation LC26000233 established in 2004 • Woman Owned Business, DBE, CBE, Micro/SBE, FDOT Certified

www.Fernandez-Beraud.com



July 19th, 2017

City of Key West
Office of the City Clerk
1300 White Street
Key West, Florida 33040

RE: Request for Qualifications – RFQ #17-003 – General Landscape Architectural Services

Dear Selection Committee:

We are pleased to submit to you the qualifications of the Landscape Architecture firm of Fernandez-Beraud Inc., and those of our listed consultants, in response to the City of Key West's Request for Qualifications for General Landscape Architectural Services (RFQ #17-003). Fernandez-Beraud Inc. brings to the City of Key West a high quality and comprehensive range of professional Landscape Architectural consulting services. Our firm was created with the intent and commitment of providing excellence in design to enhance the natural and urban environments of Florida. We strive to make a positive difference in the quality of life of the community. We are Landscape Architects who can provide creative and thorough design solutions for the City of Key West.

Fernandez-Beraud Inc. is a Professional, Minority and Woman-Owned Small Business. We are a South Florida based business entity, established as an S-Corporation with the State of Florida in April of 2004. Our current firm staffing consists of four (4) Registered Landscape Architects (RLAs), one (1) Registered Architect, and three (3) CAD/graphics consultants, who work with us on an "as-needed" basis.

Fernandez-Beraud, Inc. will approach each assignment as a unique opportunity to provide innovative and creative solutions for the City of Key West. We utilize our expertise and experience to provide research, analysis, problem evaluation and problem solving. Part of our team immersion and approach to every project is a thorough and comprehensive study of the project site(s), their conditions, opportunities and constraints.

Fernandez-Beraud, Inc. implements a comprehensive and environmentally ethical design approach, focused on aesthetics and functionality. Our firm recognizes that collaboration with the City of Key West, with other critical consultants and disciplines, and with the permitting agencies of jurisdiction, is the professional key to this holistic approach. We believe this interaction enhances our own Quality Assurance and Quality Control process and reviews.

We offer an interactive approach throughout every phase of a project in order that the City of Key West, and other community stakeholders can participate in the process. We understand that consensus among stakeholders is vital and important to the success of every project. Fernandez-Beraud, Inc. endeavors to utilize the most current design and presentation technologies (digital and print) in both client interactions, and public demonstrations, to facilitate consensus-building.





We believe that Landscape Architecture, as a professional practice, requires an integration of the design arts with environmental stewardship. We are a small and agile company, committed to our clients, and completely focused on providing the highest level of professionalism in our practice.

Our professional team of sub-consultants consists of a number of the finest, and most capable artists and engineers available. T.Y. Lin International Group has collaborated with Fernandez-Beraud, Inc. on numerous transportation projects, as well as institutional work and community parks, including the current design and development of Higgs Beach in Key West. T.Y. Lin International provides the team with civil engineering, surveying, hardscape and environmental lighting design. E-Sciences Inc. provides the team with expertise and experience as Certified Arborists, as well as other project support for ecological and environmental consulting, including studies and development involving marine and coastal sciences. Kenneth DiDonato, PE brings 35+ years of dedication and expertise in irrigation engineering throughout the South Florida region and the Caribbean. Tom Graboski Associates (TGA) offers over 30 years of outstanding design practice in professional environmental graphics and urban design; TGA Design brings to the team expert signage and wayfinding design services.

Primary Contact information for the firm is Ms. Leticia Fernandez-Beraud;
Office Address: 717 Ponce de Leon Boulevard, Suite 223, Coral Gables, Florida 33134;
Mailing Address: 2333 Brickell Avenue, Unit 216, Miami, Florida 33129;
Telephone: (305) 567-0110; Email Address: LeticiaF@Fernandez-Beraud.com

Team Members are as follows:

Prime Consultant:

Fernandez-Beraud, Inc.

Firm Expertise: Small, Medium and Large scale municipal parks; Waterfront parks; Ecosystems restoration; Historic Landscapes; Complete Streets and Streetscapes; Roadways landscape enhancements; Bicycle and Pedestrian Planning; Hardscapes; Softscapes and Xeriscape Practices; Landscape maintenance manuals; Aesthetics manuals; Knowledge of Key West Native Plants; Plant Selection Experience for the Florida Keys; "Green" Task Orders; Landscape Installation Oversight; Knowledge of the City of Key West Tree Ordinance and Permitting Process.

Team Members: Leticia Fernandez-Beraud, RLA; Karen Cheney, RLA; David Sacks, RLA; Christopher Alonso, RLA and Bruce Allan Wilson, RA (Registered Architect); all members are LEED Affiliated (3 of whom are LEED Accredited Professionals); one member is CPTED Certified (Crime Prevention Through Environmental Design).





Sub-Consultants:

T.Y. Lin International Group
Coral Gables, Florida

Firm Expertise: Hardscapes; Environmental Lighting; Site Design including Civil Engineering and Land Surveying.

Team Members: Francisco "Frank" Alonso, PE; David Reynolds, PE (both are practicing Senior Civil Engineers).

E-Sciences, Inc.
Fort Lauderdale, Florida

Firm Expertise: Softscapes and Xeriscape Practices; Knowledge of Native Plants and Plant Selection Experience for the Florida Keys; "Green" Task Orders; Ecological and Environmental Design; Knowledge of the City of Key West Tree Ordinances.

Team Members: Justin Freedman, MS; Brian Voelker, MS (both are Senior Scientists).

Kenneth DiDonato Inc.
Hollywood, Florida

Firm Expertise: Softscapes and Xeriscape Practices; Irrigation Engineering Design and Installation.

Team Member: Ken DiDonato, PE

Tom Graboski Associates Inc.
Coral Gables, Florida

Firm Expertise: Streetscapes; Signage and WayFinding.

Team Members: Tom Graboski.





With regards to **Project Management Approach**, Ms. Fernandez-Beraud will be the Team PM and the primary point of contact with the City of Key West. Ms. Fernandez-Beraud performs a Hands-On and Pro-active project management, focusing on making sure that the Task Work Orders are successfully developed, and finalized, on time, on schedule, and on budget. As PM, Ms. Fernandez-Beraud will be the ultimate responsible and accountable individual for all the work produced. Among the responsibilities of the PM, the following are identified: primary point of contact; contract maintenance; preparation of schedules; identification of staff and responsibilities; responsible to ensure that there is sufficient staff to perform work; successful completion of the Task Work Orders; preparation of invoices and reports as applicable; regularly meet with the City of Key West PM (monthly, or as necessary); ensure that QA/QC process is followed. Primary focus in Project Management will be as follows: to accomplish the goals of each Task Work Order; to follow procedures so that the project budgets are not exceeded; to follow up, coordinate and meet with sub-consultants, making sure that the schedule is met and that the City of Key West laws, regulations and standards are followed; to make sure that the is clear and fluid communications with the City of Key West PM.

With regards to **Availability**, the Fernandez-Beraud, Inc. team recognizes the importance of being available for meetings, design collaboration, constructability reviews, conferences, and field work on-site within the City of Key West. The team's Project Manager(s) and other members of the Consultant Team are available and "on-call", and can be in the City of Key West within a day's notice if necessary, to attend wherever and whenever the needs may be scheduled. In cases where the City of Key West requires in-house assistance and consultation, our Team is prepared to provide this support. In addition, our team is experienced and equipped to establish communications using teleconference technologies, including in-house and remote video sharing of visual, graphic information and other communicative materials.

Fernandez-Beraud Inc. seeks to create landscapes that are sustainable, aesthetically pleasing and functional, and which provide lasting value and meaning to their users and communities. We offer personalized attention and commitment in our work with an utmost level of professionalism and integrity, providing the best possible design solutions to achieve the Client's visions and needs. The City of Key West's ideas, needs, budget and schedules are the basis for developing practical design strategies that assure the community's goals become a working, and living reality.

On behalf of the Fernandez-Beraud Inc. team, and our associated consultancies, we thank you for your consideration.

Respectfully,

A handwritten signature in blue ink, appearing to read "Leticia Fernandez-Beraud".

Leticia Fernandez-Beraud, RLA
President



CONSULTANT TEAM ORGANIZATIONAL CHART

REQUEST FOR QUALIFICATIONS - RFQ #17-003
GENERAL LANDSCAPE ARCHITECTURAL SERVICES



**The City of Key West
Florida**



FERNANDEZ-BERAUD, INC.

Landscape Architecture and Planning
(Started in 2004 / 13 years)
LANDSCAPE ARCHITECTURE - CIVIL ENGINEERING
IRRIGATION ENGINEERING - CERTIFIED ARBORIST
ENVIRONMENTALIST - SIGNAGE / WAYFINDING

F-B Inc.

Leticia Fernandez-Beraud, RLA

PRINCIPAL IN CHARGE
PROJECT DESIGN AND MANAGEMENT
(25 years of Experience)

LANDSCAPE ARCHITECTURE
Transportation, Complete Streets, Master Planning, Parks

F-B Inc.

David Sacks, RLA

PROJECT DESIGN & MANAGEMENT
(30 years of Experience)

LANDSCAPE ARCHITECTURE
Master Planning, Parks, Historic Landscapes

F-B Inc.

Karen Cheney, RLA LEED AP

PROJECT DESIGN & MANAGEMENT
(24 years of Experience)

LANDSCAPE ARCHITECTURE
Parks, Play Spaces, Environ. Restoration

F-B Inc.

Christopher Alonso, RLA LEED AP BD+C

PROJECT DESIGN & MANAGEMENT
(30 years of Experience)

LANDSCAPE ARCHITECTURE
Park Planning, Complete Streets, Bike Paths

F-B Inc.

Bruce Allan Wilson, AIA LEED AP BD+C

ARCHITECTURE, GRAPHIC DESIGN
(25 years of Experience)

LANDSCAPE ARCHITECTURE
Const. Docs., Quality Control, Photomontage

Subconsultant

T.Y. Lin International

Frank Alonso, PE
David Reynolds, PE

CIVIL ENGINEERING
Hardscapes, Environmental Lighting,
Site Design (Civil & Land Surveying)

Subconsultant

E-Sciences, Inc.

Justin Freedman, MS
Brian Voelker, MS

**CERTIFIED ARBORIST/
ENVIRONMENTAL SCIENCES**
Ecological & Environ. Design Consultants

Subconsultant

Kenneth DiDonato, Inc.

Kenneth DiDonato, PE

IRRIGATION ENGINEERING
Irrigation Design, Xeriscape Practices

Subconsultant

Tom Graboski Associates

Tom Graboski

**ENVIRONMENTAL
GRAPHIC DESIGN**
Environ. Signage / Wayfinding



PROJECTS





FERNANDEZ - BERAUD INC

Landscape Architecture and Planning

PARKS & TRANSPORTATION

Atlantic Boulevard Relocation at Higgs Beach Park

LOCATION & DATE: City of Key West, Monroe County, Florida; (2015 to current).

DESCRIPTION: Clarence Higgs Beach Park, of approximately 16 acres in size, is one of the most predominant parks in Key West. Of great historical significance, the park includes the presence of the West Martello Tower and the Key West African Cemetery Memorial. The park is highly regarded by the local community and visitors, with heavily used dog parks, sport courts and beach. The project consisted in the design development and construction documentation of the 2010 Higgs Beach Masterplan. The project addresses Phase 1: site renovations and complete street enhancements of this historic waterfront park. Phase 1 includes re-location of the main park roadway, pedestrian & bicycle circulations, new dog parks, racquetball facility, and, landscape improvements.

Fernandez-Beraud, Inc. is in charge of hardscape and landscape design development and construction documentation.

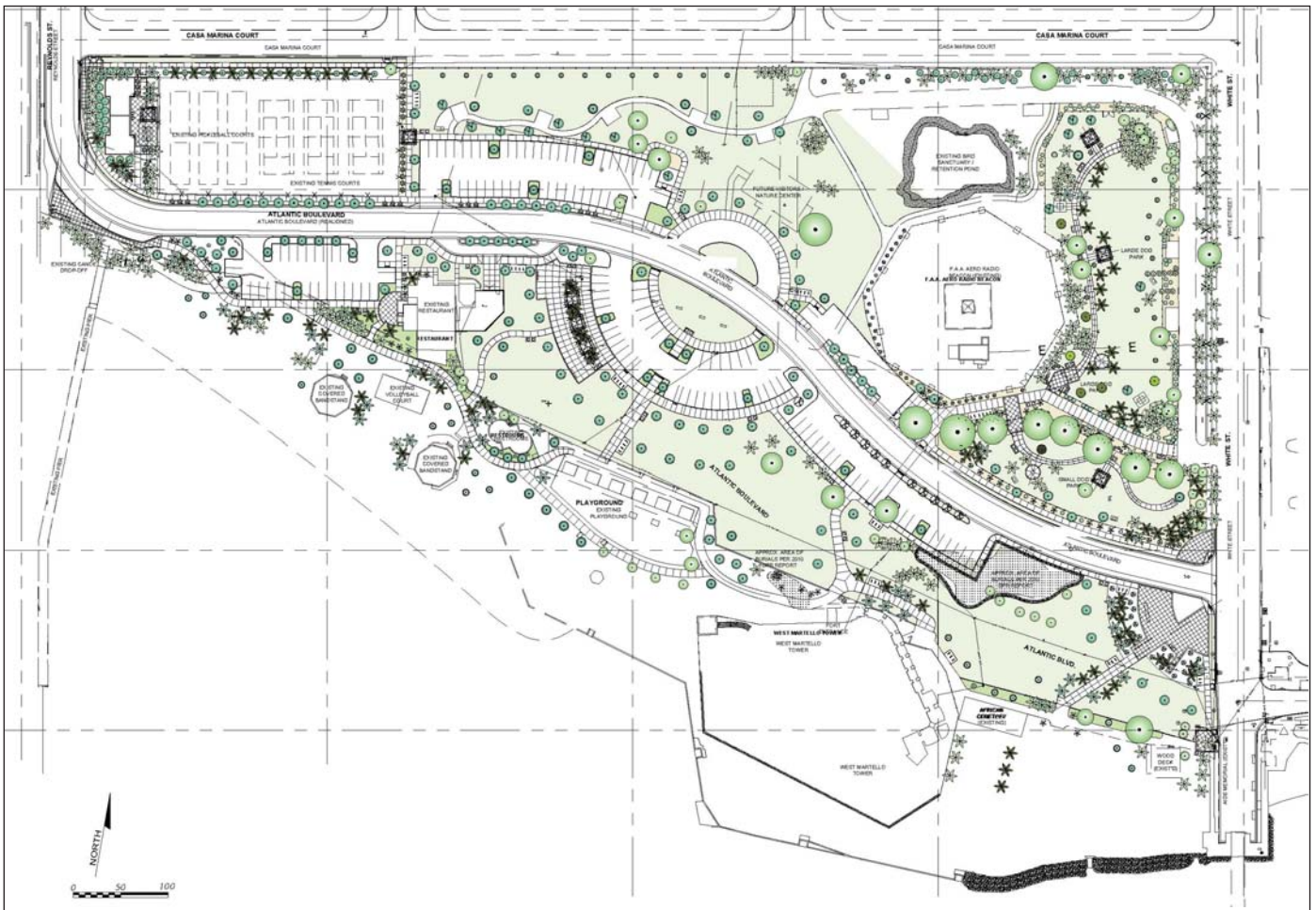

HARDSCAPE AND PLANTING PLAN, 2017.



FERNANDEZ - BERAUD INC

Landscape Architecture and Planning

HIGHER EDUCATION

Miami Dade College Kendall Campus Landscape Enhancements

LOCATION & DATE: 11011 Southwest 104th Street, Miami, Florida 33176; 2014-2015.

DESCRIPTION: Fernandez-Beraud, Inc. provided professional Landscape Architecture services for all phases of the project, from concept development to construction observation.

The landscape enhancements were focused in the main entrances of the campus and the pool area.

The approximate landscape budget which was used as basis for the design was \$900,000.



BUS DROP OFF AREA



POOL AREA LANDSCAPE ENHANCEMENTS



PLAN OF MAIN ENTRANCE / GATEWAY FEATURE (From Killian Drive)



MAIN ENTRANCE / GATEWAY FEATURE (from Killian Drive)



EAST ENTRANCE GATEWAY



FERNANDEZ - BERAUD INC

Landscape Architecture and Planning

T R A N S P O R T A T I O N

MDX SR 836 - Bike Path

LOCATION & DATE: SR 836 north right of way, between NW 87th Ave and NW 107th Ave; Miami-Dade County, Florida; 2009-10.

DESCRIPTION: The two-mile Miami-Dade Expressway Authority's SR 836 Bike Path landscaping was designed to enhance the experience of the bikers and pedestrians by bringing into the landscape color, accents and shade. This is represented by a sequence of different and changing plant material that fulfills a function as well as an aesthetic goal.



BIKE PATH LOCATION MAP: ALONG SR 836, BETWEEN NW 87th AVE. & NW 107th AVE.



BISMARCKIA PALM GROVES: PHOTOMONTAGE - BEFORE AND AFTER



BISMARCKIA PALM GROVES: MATURE RELOCATED BISMARCKIA PALMS GROUPED IN BEDS OF GROUNDCOVER AND SMALL ACCENT PALMS.



PINELANDS: PHOTOMONTAGE - BEFORE AND AFTER



PINELANDS: SLASH PINES WITH ACCENTS OF SAW PALMETTO AND FLORIDA SILVER PALMS IN BEDS OF NATIVE GRASSES.



ROYAL PALM GROUPINGS: PHOTOMONTAGE - BEFORE AND AFTER



ROYAL PALM GROUPINGS: EXISTING ROYAL PALMS WITH SMALL PALMS AT BOTH ENDS AND FLOWERING TREES THROUGHOUT.



FERNANDEZ - BERAUD INC

Landscape Architecture and Planning

PUBLIC WORK

Scott Rakow Youth Center

LOCATION & DATE: 2700 Sheridan Avenue, Miami Beach; Miami-Dade County, Florida; 2007 - 2010

DESCRIPTION: The project was the expansion and upgrade of an existing and very popular community youth center. The landscape area was approximately 3.5 acres.

The project included interior building remodeling, construction of new outdoor areas such as an entrance plaza and additional parking lot facilities, and an upgrade of the street scape. Existing outdoor structures and very valuable specimen trees were primary in the landscape design.

Fernandez-Beraud, Inc. was in charge of Landscape Conceptual Design and Design Development, Construction Documentation, and, Construction Observation.



MAIN ENTRANCE COURTYARD AND SCULPTURE



SPECIMEN FIGUS TREE: MAIN FEATURE OF THE PARKING LOT LANDSCAPE



VIEW OF THE MAIN BUILDING ENTRANCE FROM THE PARKING AREA



VIEW OF THE BUILDING FROM THE PARKING AREA



VIEW THE INFORMAL PLAY FIELD AREA AND THE SPECIMEN PALM TREE



FERNANDEZ - BERAUD INC

Landscape Architecture and Planning

PARKS AND RECREATION

Sunkist Pineland Park

LOCATION & DATE: SW 54th Street and SW 84th Avenue; Miami-Dade County, Florida; 2008.

DESCRIPTION: Miami-Dade Parks and Recreation (MDPR) assigned to Fernandez-Beraud, Inc. the task of preparing Conceptual and Schematic Plans, and a park booklet to serve as a guide in the Construction Documentation phase of the project that was to be developed by MDPR.

This 1-acre neighborhood park had some existing mature Slash Pine trees. The project program included a playground for children from 5 to 12 years old, concrete and mulch paths, seating and water fountain areas, and primarily, the restoration of the existing Rockland Pineland ecosystem.

The plant selection was done in coordination with Fairchild Tropical Botanic Gardens' botanists and scientists who were working towards the conservation of the Rockland Pineland ecosystems of Miami-Dade County.



PHOTOMONTAGE STUDIES



ILLUSTRATIVE LANDSCAPE PLAN



MAIN PLAYGROUND PERIMETER CIRCULATION



VIEW FROM THE PARK ENTRANCE



PLAY AREAS



FERNANDEZ - BERAUD INC

Landscape Architecture and Planning

PUBLIC WORK

Miami-Dade Expressway Authority (MDX) Headquarters

LOCATION & DATE: 3790 NW 21st Street, Miami, FL 33142; 2009 - 2010

DESCRIPTION: Located in a 4-acre site, the scope of the work included the hardscape and landscape design of the street, the entrance garden and picnic area, parking lots, and the street courtyard.

Emphasis was given to the streetscape image, with a continuous curvilinear planting statement throughout the whole street, as well as to the vehicular and pedestrian entrance experience. A picnic and garden area was created for the MDX's employees adjacent to the canal. Colored glass was used at the general entrance, using some of MDX's representative colors, expressing movement and transition into the facilities.

Fernandez-Beraud, Inc. provided professional Landscape Architecture services for the design, construction documentation and construction follow-up.



VIEW OF THE PARKING AREA FROM THE PEDESTRIAN WALKWAY



LANDSCAPING ALONG THE RIGHT OF WAY



PICNIC AREA ADJACENT TO THE CANAL



PRIVACY GARDEN ADJACENT TO OFFICE SPACES



PARKING AREA



FERNANDEZ - BERAUD INC

Landscape Architecture and Planning

LANDSCAPE MAINTENANCE MANUALS

Alligator Alley Rest Area Landscape Maintenance Guidelines

NAME, ADDRESS & PHONE # AND E-MAIL OF THE OWNER'S REPRESENTATIVE: FDOT District 4 (refer to contact information below).

NAME, ADDRESS & PHONE # AND E-MAIL OF THE OWNER'S PROJECT MANAGER: Elisabeth Hassett, District Landscape Architect; Address: 3400 W. Commercial Blvd., Ft. Lauderdale, FL 33309 ; Phone #: 954-777-4219; E-mail: Elisabeth.Hassett@dot.state.fl.us.

NAME, LOCATION & ADDRESS: FDOT SR I-75, Mile Marker 30, Broward County, Florida; 2016.

DESCRIPTION OF WORK: The guidelines were created as a directive for FDOT Inspectors and as a requirement for Landscape Maintenance Contractors, in the landscape maintenance work of the 5-acre Alligator Alley Rest Area. It is also a model of future maintenance manuals for FDOT D4.

CONTRACT START AND COMPLETION DATE: 2016.

PROJECT DOLLAR AMOUNT: \$25,000.

DETAILED INFORMATION ON ANY ADDITIONAL SERVICES PROVIDED, INCLUDING THE REASON, COST AND DESCRIPTION: N/A

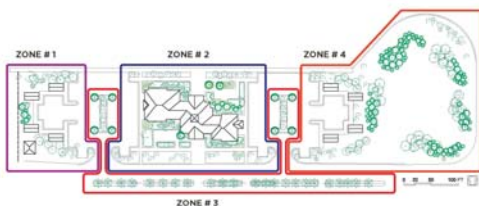

NOTE: ZONE #4 will be maintained in the short term as per diagram. A retained area is being developed, and once that is installed and the establishment period is completed, maintenance requirements in this area shall be adjusted accordingly.

FDOT District Four I-75 LANDSCAPE MAINTENANCE MANUAL ALLIGATOR ALLEY ENVIRONMENTAL EDUCATION REST AREA

INDEX

CHAPTER I - LANDSCAPE MAINTENANCE

PART 1 - LANDSCAPE MAINTENANCE CRITERIA

1.1 Purpose of this Manual.....4

1.2 Landscape Maintenance Goals.....4

1.3 Principal Users.....4

1.4 References.....4

1.5 Quality Assurance.....5

1.6 Compliance.....6

1.7 Landscape Maintenance Guidelines and Procedures.....7

- 1.7.1. Hardwood Trees & Palms Maintenance.....7
- 1.7.2. Shrubs, Ornamental Grasses and Groundcovers Maintenance.....8
- 1.7.3. Wildflower Areas.....9
- 1.7.4. Turf Maintenance.....9
- 1.7.5. Integrated Pest Management (IPM) - Cultural, Biological and Chemical Practices.....9
- 1.7.6. Native Wildlife Nests, Dens and the Animal Young.....11
- 1.7.7. Procedures.....12

PART 2 - LANDSCAPE CHARTS

2.1. **LANDSCAPE CHART #1:** Contractor's Yearly Landscape Maintenance Schedule.....13

2.2. **LANDSCAPE CHART #2:** Existing Plant Material - Maintenance & Plant Replacement.....14

- For Hardwood Trees.....14
- For Palms.....16
- For Shrubs.....16
- For Ornamental Grasses & Cycads.....18
- For Turf.....18

2.3. **LANDSCAPE CHART #3:** Site Specific Category 1 Invasive Plants.....20

- Inv. Hardwood Trees.....20
- Invasive Shrubs.....22
- Invasive Vines.....22

PART 3 - LANDSCAPE PLANS & FORMS

3.1. Site Plan with General Limits of the Landscape Maintenance work.....24

3.2. Site Plan with Zones Outlined.....25

3.3. Summary of Forms to be Used by FDOT Inspectors during the Landscape Maintenance Inspections.....26

3.4. Summary of Forms to be Used by the Contractor during the Landscape Maintenance Contract.....27

3.5. Definitions & Procedures for FORM#100 (Forms #100-1, #100-2, #100-3, #100-4); FDOT Landscape Quality Assessment Checklist and Plan.....28



FERNANDEZ - BERAUD INC

Landscape Architecture and Planning

LANDSCAPE MAINTENANCE MANUALS

MDX Landscape Maintenance Manuals

2012 Award of Excellence - American Planning Association - Gold Coast Section

NAME, ADDRESS & PHONE # AND E-MAIL OF THE OWNER: Miami Expressway Authority (MDX) (refer to contact information below).

NAME, ADDRESS, PHONE # & E-MAIL OF OWNER'S PROJECT MANAGER: Rick Johnson, MDX Maintenance Manager; Address: 3790 NW 21st St, Miami, FL 33142; Phone #: (305) 637-3277; E-mail: rjohnson@mdxway.com.

NAME, LOCATION & ADDRESS OF PROJECT: SR 836, SR 874, SR 878, SR 924, in Miami-Dade County, Florida.

DESCRIPTION OF WORK: The MDX Landscape Maintenance Manuals were prepared with the purpose of providing maintenance personnel with information that was easily accessible, and understandable in a manner that provides both graphic and written instructions regarding proper care of the expressway system's landscape installations. The written text is in English and in Spanish. The Manuals complement the Authority's written technical specifications.

CONTRACT START AND COMPLETION DATE: 2011.

PROJECT DOLLAR AMOUNT: \$10,000.

DETAILED INFORMATION ON ANY ADDITIONAL SERVICES PROVIDED, INCLUDING THE REASON, COST AND DESCRIPTION: N/A.



LANDSCAPE MAINTENANCE GUIDELINES LAYOUT - SR 836



LANDSCAPE MAINTENANCE GUIDELINES LAYOUT - MDX HEADQUARTERS

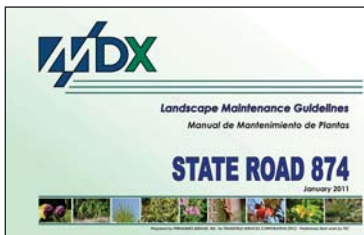
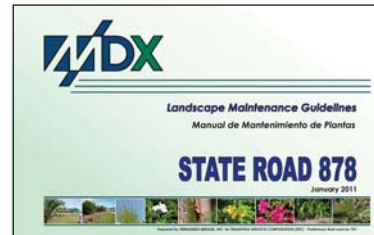

LANDSCAPE MAINTENANCE GUIDELINES BOOKS



FERNANDEZ - BERAUD INC

Landscape Architecture and Planning

T R A N S P O R T A T I O N

MDX SR 874 – Kendall Drive to the Turnpike 2013 Best Practice Merit Award - APA Gold Coast Sect.

LOCATION & DATE: SR 874 between Kendall Drive and NW the Turnpike; Miami-Dade County, Florida; 2012.

DESCRIPTION: Miami-Dade Expressway Authority's State Road 874, from Kendall Drive to the Turnpike was a roadway project of 1.5 miles, inclusive of the Killian Interchange. The median landscape was not part of this project, but coordination and the aesthetics were part of the process. The SR 874 is characterized by the presence of continuous and colorful noise walls, with accent walls of conspicuous shapes and colors.

The landscape design considered the accent walls as background to a series of landscape palm exhibits throughout the entire length. In between the accent walls, the landscape consisted mainly of native trees and palms, which will grow and become a canopy mass. The Killian Interchange included a lake with numerous palms; it also included large landscape areas with great numbers of native trees, representing the South Florida native hammock. Fernandez-Beraud, Inc. was in charge of the design concept, design development and construction documentation.

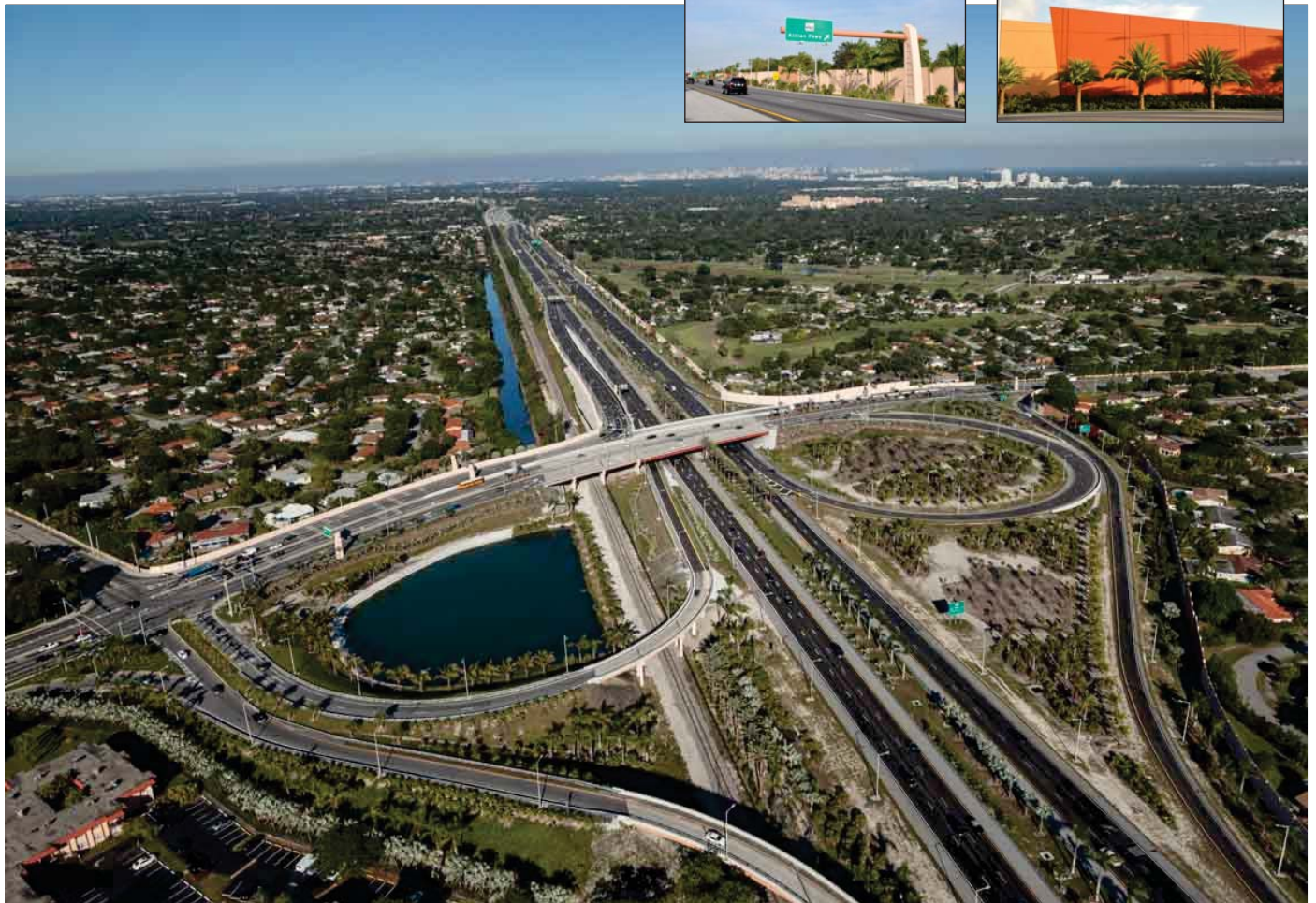



FERNANDEZ - BERAUD INC

Landscape Architecture and Planning

T R A N S P O R T A T I O N

MDX SR 874 – Kendall Drive to the Turnpike

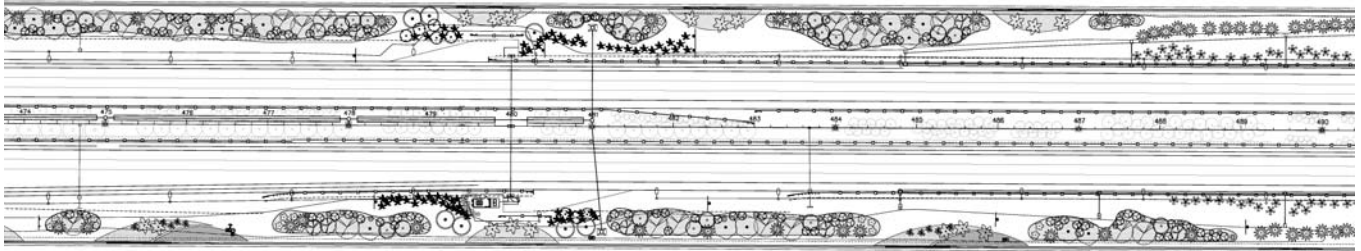

SR 874 CORRIDOR - PARTIAL PLAN



KILLIAN INTERCHANGE PLAN





FERNANDEZ - BERAUD INC

Landscape Architecture and Planning

TRANSPORTATION

MDX SR 83617 – Welcome Gateway

*2009 Transportation Merit Award - APA Gold Coast Sect.
2011 Award of Excellence - FL Native Plant Society*

LOCATION & DATE: SR 836 between NW 87th Ave. and NW 97th Ave.; Miami-Dade County, Florida; 2009-10.

DESCRIPTION: Miami-Dade Expressway Authority's State Road 836, also known as the Dolphin Expressway, is the primary east-west vehicular corridor transversing the greater metropolitan area of the city of Miami and Miami-Dade County.

SR 836 Welcome Gateway serves the greater expressway system as a spatial marker, from the air, and from the ground. It is visualized from the air as a 1200 linear foot sign, observed from ascending and descending aircraft utilizing Miami International Airport, along the north side of SR 836. At ground level, the project is considered to be a "gateway" and "place," as it occurs at a main stretch of transition along the east-west corridor. This aspect is perceived through its strong curvilinear gesture of palms and other planting.



AERIAL PHOTOMONTAGE FROM AN AIRPLANE ARRIVING INTO MIA AIRPORT



CANOPY TREE GROUPINGS IN THE MEDIAN



LANDSCAPE AERIAL MESSAGE



MULTIPLE PALM SPECIES ALONG THE MEDIAN



CURVILINEAR GESTURE OF ROYAL AND PAUROTIS PALMS



PROFESSIONAL RESUMES



Leticia Fernandez-Beraud, RLA

President, Registered Landscape Architect

Description of Experience, Role and Responsibilities

Registered Landscape Architect with over 25 years of experience in a variety of public and private projects, including city/county parks, highways and streetscapes, transportation projects, education, corporate and health facilities, business centers, ocean ports, and condominiums.

Ms. Fernandez-Beraud actively embarks as a leader in master planning and site planning, site analysis, design concepts, design development and construction documentation, landscape design and maintenance guidelines, presentation drawings, cost estimating, construction observation, and interdisciplinary coordination.

Ms. Fernandez-Beraud will be the Principal-in-Charge, and will be actively involved in all aspects of the projects being developed and delivered. Ms. Fernandez-Beraud is fluent in written and spoken Spanish and English.

Relevant Projects List

Relocation of Atlantic Boulevard at Higgs Beach Park, 2015-current, Key West, Monroe County, Florida. Role: Landscape Architect in charge of design development and construction documentation. Project addresses Phase 1 site renovations and complete street enhancements of a historic waterfront park. PH 1 includes re-location of the main park roadway, pedestrian & bicycle circulations, new dog parks, racquetball facility, and, landscape improvements.

FDOT Tiger Grant - 8th Street Pedestrian Bridge for FIU and the City of Sweetwater, 2014, Miami-Dade County, FL. Role: Project Manager and Landscape Architect/Designer. Following the criteria of 'complete streets', the scope of the work included conceptual and schematic designs of streetscapes, pedestrian walkways, plaza and bike paths in a 7 acre site located along 8th Street, within FIU and Sweetwater.

FDOT- Alligator Alley Rest Area Landscape Maintenance Guidelines, 2016, SR I-75, Mile Marker 30, Broward County, Florida. Role: Project Principal. The guidelines were created as a directive for D4's Inspectors and as a requirement for Landscape Maintenance Contractors, in the landscape maintenance work of the 5-acre Alligator Alley Rest Area. The Guidelines serve as a model of future maintenance manuals for FDOT D4.

Miramar Readiness Center, Florida Army Reserve National Guard, 2012-2014, Miramar, Broward County, FL. Role: Project Manager and Designer. Landscape design and construction documentation for a 20-acre high security facility for military readiness, for the Florida Army Reserve National Guard. Security was a major issue and the design followed the guidelines of both, the Anti-terrorism Force Protection protocol, as well as the guidelines of CPTED (Crime Prevention Through Environmental Design).

SR 874 – from Kendall Drive to the Turnpike and Killian Interchange, 2012, Miami-Dade County, FL. Role: Project Manager and Designer. This roadway landscape project of 2.5 miles was inclusive of the Killian Interchange. The median



FERNANDEZ-BERAUD INC.
**Landscape Architecture
and Planning**

Office Address

717 Ponce de Leon #223
Coral Gables, Florida 33134

Office Phone Number

305-567-0110

Office Fax Number

305-913-2210

Email Address:

leticiaf@Fernandez-Beraud.com

Professional License

Florida Registered Landscape
Architect LA 6666730

Academic Background

**Master of Landscape
Architecture**, Ball State
University, Muncie, Indiana,
1992.

Master of Architecture, Ball
State University, Muncie,
Indiana, 1991.

Architecture, Professional
Degree, School of Science and
Technology, Catholic University,
Asuncion, Paraguay, 1988.

Memberships, Associations, and Certifications

APA, American Planning
Association.

ISA, International Society of
Arborist.

USGBC, member; **LEED GA**

CPTED, Crime Prevention
Through Environmental Design

landscape was not part of this project, but coordination and the aesthetics were part of the process.

SR 878 – from SR 826 to SW 87th Street and Residential Landscape Mitigation, 2012, Miami-Dade County, FL. Role: Project Manager and Designer. In addition to the one-mile roadway landscaping design and construction documentation, the project included residential landscape mitigation, with numerous photomontages of before and after for presentations to the adjacent neighborhood.

Roadway Landscape Maintenance Guidelines – Miami-Dade Expressway Authority, 2011, Miami-Dade County, FL. Role: Project Manager and Designer. The MDX Landscape Maintenance Manuals were developed and prepared for the purpose of providing maintenance personnel with information that was easily accessible, and understandable, with both graphic and written instructions regarding proper care of the expressway system's landscape installations.

Scott Rakow Youth Center, Miami Beach, Florida, 2010. Role: Project Manager and Designer. Landscape design development and construction documentation and construction observation for a 3-acre existing facility. The project included an additional parking lot, new entrance plaza, upgrade of existing streetscape, and the addition of a new playfield.

SR 836 Bike Path - developed between NW 87th Ave. and NW 97th Ave., 2010, Miami-Dade County, FL. Role: Project Manager and Designer. Landscape design, construction documentation and construction follow-up of a two-mile bike path project, focused on the creation of native pinelands and accent areas of palm groves.

SR 836 Welcome Sign – located between NW 87th Ave. and NW 97th Ave, 2009, Miami-Dade County, FL. Role: Project Manager and Designer. This 50-acre landscape design and construction documentation project was considered one of the main gateways to the MDX highway systems and to Miami-Dade County.

Homestead Senior Community Center, 2010, Homestead, Florida. Role: Project Manager and Designer. Landscape design development and construction documentation of a senior center in a 3-acre site. The community center included two outdoor courtyards, exercise path with life trail equipment and seating, organic garden and parking facilities.

Flagler Grove Park, Village of Pinecrest, Florida, 2009. Role: Project Manager and Designer. Landscape design development and construction documentation of a 3-acre neighborhood park. The program includes two soccer fields, playground, restrooms and parking lot facilities.

Sunkist Pineland Park, Miami-Dade County, Florida, 2008. Role: Project Manager and Designer. Design concepts and design development of a 1-acre neighborhood park. Emphasis was given to the Rockland Pineland ecosystem restoration. Playground areas for children from 5 to 12 years old, concrete and mulch paths, proposed planting palette, as well as the production of a park booklet.

Margaret Pace Park, 2003, Miami, Florida. Role: Landscape Designer. In charge of conceptual master plan, schematic design and preparation of construction documentation for all phases of a 6-acre urban park on the waterfront. It included plazas, promenade, playground, tennis, basketball and volleyball courts, non-professional soccer and cricket fields, and, restroom facilities.

(CPTED Practitioner Certification), 2011.

Employment

Time Period: April 2004 to present.

Company: **Fernandez-Beraud Inc.**, Coral Gables, FL.

Role: Principal, Landscape Architect, Project Manager and Designer.

Languages

Bilingual – Spanish & English.

Awards and Scholarships

2013 American Planning Association - Gold Coast Section, Merit Award, Professional Practice Project category, MDX SR 874 Landscape Enhancements.

2011 American Planning Association Gold Coast Section, Award of Excellence, Professional Practices category, Miami-Dade Expressway Authority Landscape Maintenance Guidelines.

2011 Florida Native Plant Society, Honor Award, SR 836 Welcome Gateway.

2009 American Planning Association Gold Coast Section, Merit Award, Outstanding Transportation Project category, Welcome Gateway.

2002 American Planning Association Gold Coast Section, Outstanding Publication, Second Place, Miami-Dade Expressway Authority (MDX) System wide Aesthetic Guidelines.

1989 LASPAU-FULBRIGHT Scholarship - Graduate studies in Architecture in the United States.

1985 Catholic University Scholarship.

Karen Cheney, RLA, LEED AP

Registered Landscape Architect

Description of Experience, Role and Responsibilities

Registered Landscape Architect in the State of Florida since 2006 with over 24 years of experience in the practice of Landscape Architecture and Construction. Ms. Cheney's professional practice has been concentrated on parks-related projects ranging from master planning to site-specific design. Ms. Cheney also participated in development of the *Miami-Dade County Parks and Open Spaces System Master Plan* and the *Park Structure and Landscape Pattern Book*, documents commissioned to inform planning and design of open space throughout Miami-Dade County in the 21st Century. Professional interests and expertise include habitat restoration, urban design and the interface of these specialties where they work in synthesis to enhance planning and design of open space in the public realm.

Relevant Projects List

Freshwater Wetland at Country Lake Park, 1998, Miami-Dade County, FL. Role: Designer and Project Manager. Landscape design, construction documentation and construction observation to restore roughly five acres of exotics-infested fresh water wetland in western Miami-Dade County. The site is situated in a rapidly developing suburban area and restoration issues had to be balanced with providing access and recreation opportunities for a rapidly expanding population.

Upland and Wetland Planting to support CERP Project at Charles Deering Estate, 2005 – 2007, Miami-Dade County, FL. Role: Designer and Project Manager. Landscape design, construction documentation and construction observation to create a native hammock edge around a 17-acre property targeted for development as one of the South Florida Water Management District Accelerated Everglades Restoration projects. This was the first restoration project undertaken in an urban area and buffering the site from neighboring high-end residential properties during construction was critical for gaining public support necessary to successfully implement the work.

Freshwater Wetland to enhance CERP Project at Charles Deering Estate, 2013 – 2015, Miami-Dade County, FL. Role: Designer and Project Manager. Landscape design, construction documentation and construction observation to create an additional half-acre fresh water wetland removed from the SFWMD CERP due to financial constraints. Worked with project engineer and restoration biologists (DERM and Natural Areas Management staff) to develop and implement a plan designed to enhance and expand the existing freshwater wetland while creating a habitat characterized by more year-round open water conditions with planting appropriate to the deeper elevations. Emphasis was also placed on creating an upland habitat which will support passive recreation and public access to the site.

Hydric Hammock at Matheson Hammock Park, 1995, Miami-Dade County, FL. Role: Designer and Project Manager. Landscape design and construction observation to plant approximately two-hundred canopy and understory trees at the edge of an existing Natural Forest Community to provide a buffer from open disturbed areas within the site and facilitate regrowth of hydric understory throughout the hammock edge.



FERNANDEZ-BERAUD INC.
Landscape Architecture
and Planning

Office Address

717 Ponce de Leon #223
Coral Gables, Florida 33134

Office Phone Number

305-567-0110

Office Fax Number

305-913-2210

Email Address:

karenc@Fernandez-Beraud.com

Professional License

Florida Registered Landscape
Architect
LA 6666828 (2006)
LEED AP (2009)

Academic Background

**Master of Landscape
Architecture**, Florida
International University, Miami,
Florida; 1993.

Bachelor of Arts, Longwood
College, Farmville, Virginia;
1970.

Employment

Time Period: September 2015
to present
Company: Fernandez-Beraud
Inc., Coral Gables, FL.
Role: Senior Landscape
Architect, Project Manager and
Designer.

Matheson Hammock Park Edge Restoration, 2003, Miami-Dade County, FL. Role: Designer and Project Manager. Landscape design and construction observation to clear and replant approximately two acres of disturbed land along the western edge of the park as an upland hammock.

Dune Restoration at Haulover Park, 2001 through 2004, Miami-Dade County, FL. Role: Landscape design, project management and construction observation for multi-phased restoration of approximately 2 miles of beachfront dunes overgrown with invasive exotic vegetation. Collaborated with consultant landscape architect and with Parks Natural Areas Management biologists to develop methodology to clear and replant the dunes to create a robust dune ecosystem while facilitating access to the beach for users at this flagship metropolitan park.

Freshwater Wetland Improvements at Biscayne Gardens Park, 2005, Miami-Dade County, FL. Role: Landscape design and construction observation for clearing and restoration of approximately two acres of disturbed fresh water wetland at a neighborhood park in northeastern Miami-Dade County.

Rockland Hammock at Camp Owaissa Bauer Park, 2003, Miami-Dade County, FL. Role: Landscape design and construction observation for clearing and replanting of an upland hammock at park's edge.

Oleta River Restoration Project(s) at Highland Oaks Park, 2004-2010, Miami-Dade County, FL. Role: Project management and construction observation for multi-phased fresh water restoration projects implemented to restore connectivity of degraded headwaters/fresh water wetlands critical to the long-term sustainability of the Oleta River downstream of the site. Worked closely with consultant environmental engineers and restoration biologists from both Parks and Department of Environmental Management (DERM) to develop construction and landscape plans to restore degraded habitat.

Wetland Demonstration Garden at Arvida Park, 2007, Miami-Dade County, FL. Role: Landscape design for implementation of a ½ acre wetland planting to capture runoff in the park and function as an educational lab for a park-school partnership.

Sunkist Pineland Park, 2010, Miami-Dade County, FL. Role: Project management, landscape design and construction documentation to implement a master-plan prepared by a consultant for the development of approximately three acres of degraded pine rockland into a neighborhood park. Synthesis of park design and environmental restoration in an urban area led Fairchild Tropical Gardens to include the site in their "Connect to Protect" program developed to maximize function of remaining pine rockland habitats in Miami-Dade County.

South Addition at Charles Deering Estate, 2006-2010, Miami-Dade County, FL. Role: Project management, landscape design and construction observation of a multi-phased project to restore an environmentally sensitive site and reconcile environmental restoration with waterfront access and recreation programming for the general public (canoe/kayak launch, overflow parking for the Estate and passive recreation).

Time Period: July 1993 to August 2015

Employer: Miami-Dade Parks Recreation Open Spaces Department, Miami Dade County, Florida.

Role: Senior Landscape Architect. Retired August 31, 2015 as Landscape Architect III.

Awards

2002 ASLA Florida Chapter Award of Excellence for Virginia Key Beach Parks and Blueways

References

Maria I. Nardi, Chief Planning and Design Excellence Miami-Dade Parks Ph: 305-755-7860

Alicie Warren, Ph.D

Restoration Biologist Miami-Dade Parks Ph: 305-257-0933

Michael Houle, RLA,CGC

Landscape Architecture Section Head, Miami-Dade Parks Ph: 305-755-7860

Amelia Earhart Park (Tom Sawyer Island Playground)

Hialeah, FL



Project experience of team member Karen Cheney, Senior Landscape Architect.

Upland and Wetland Planting to support CERP Project at Charles Deering Estate

Miami-Dade County, FL



Project experience of team member Karen Cheney, Senior Landscape Architect.

David Sacks, ASLA

Registered Landscape Architect

Description of Experience, Role and Responsibilities

Registered Landscape Architect with over 30 years of experience in a broad range of project types, for public sector, not-for-profit, private sector and residential clients. Mr. Sacks offers specialized expertise in cultural and historic landscapes, streetscapes and complete streets, parks, environmental education sites, and, municipal facilities.

He has extensive design and management experience in all phases of project development, from preliminary concepts to master planning and programming, historic site restoration and rehabilitation, and full design services for improvements including circulation, planting, hardscape, natural areas restoration, recreational facilities, water features and other site elements.

Relevant Projects List

Relocation of Atlantic Boulevard at Higgs Beach Park, 2015-current, Key West, Monroe County, Florida. Role: Landscape Architect in charge of design development and construction documentation. Project addresses Phase 1 site renovations and complete street enhancements of a historic waterfront park. PH 1 includes re-location of the main park roadway, pedestrian & bicycle circulations, new dog parks, racquetball facility, and, landscape improvements.

Alexander Park Multi-Use Trail, 2015 (Phase 1 Trail and parking; Phase 2 scheduled for 2016), McDonough, GA. Role: Landscape Architect
Design / construction documents/ construction observation of +/- 2 mile network of pedestrian/bicycle trails and other park improvements including entry drive, parking areas, native re-vegetation and other site amenities.

FDOT Tiger Grant - 8th Street Pedestrian Bridge for FIU and the City of Sweetwater, Miami-Dade County, FL, 2014. Role: Project Landscape Architect and Designer. Following the criteria of 'complete streets', the scope of the work included conceptual and schematic designs of streetscapes, pedestrian walkways, plaza and bike paths in a 7 acre site located along 8th Street, within FIU and Sweetwater.

Salt River Bay National Historical Park Master Plan / Marine Research & Education Center, St. Croix, USVI, 2013. Role: Lead Planner / Landscape Architect. Site master planning and landscape architectural Schematic Design for a \$50-million research facility, residential campus and visitor facilities to be located in a national park; in conjunction with a Master Plan for the 600-acre park containing nationally significant historic and archaeological resources and unique natural areas.

The Mound House Cultural & Environmental Learning Center, 2011, Fort Myers Beach, FL. Role: Project Manager / Principal Designer. Landscape Master Plan, site design and construction documents, and construction phase services for historic house on a Calusa Indian shell mound. The project addressed historic landscape restoration, visitor access and amenities, and interpretive trails.



FERNANDEZ-BERAUD INC.
**Landscape Architecture
and Planning**

Office Address
717 Ponce de Leon #223
Coral Gables, Florida 33134

Office Phone Number
305-567-0110

Office Fax Number
305-913-2210

Email Address:
davids@fernandez-beraud.com

Professional License
Florida Registered Landscape Architect #LA0001392 (1990)
Georgia Registered Landscape Architect #LA001399 (2005)
North Carolina Registered Landscape Architect #1726 (2012)
Alabama Registered Landscape Architect #737 (2012)

Academic Background
Harvard University Graduate School of Design, Master of Landscape Architecture, 1988.
College of William & Mary, Bachelor of Arts in Fine Arts, with Honors, 1984.

Awards
2013 Frederic B. Stresau Award, ASLA Florida Chapter: Bok Tower Gardens Master Plan, Lake Wales, FL
2013 Award of Excellence,

Old Florida Heritage Highway, 2009, Alachua County, FL. Role: Senior Designer. Master plan for a 40-mile network of scenic roadways linking the historic town of Micanopy, FL with a number of unique environmental and historic sites.

Ave Maria University & New Town, 2009, Ave Maria, FL. Role: Landscape Designer. Part of design team for \$200 million new university's first phase of campus development and streetscape design for associated new town development.

WaterSound Bridges & Peninsula, 2007, WaterSound Beach, FL. Role: Project Manager. Landscape architectural design and construction documents for common areas and rights-of-way for the WaterSound Beach Peninsula and Bridges communities.

Flamingo/Lummus Neighborhood Streetscape, 2007, Miami Beach, FL. Role: Project Designer. Landscape design and construction documents for streetscape improvements in the landmark historically designated "Art Deco" National Register Architectural District.

Oceanfront Neighborhood Streetscape, 2007, Miami Beach, FL. Role: Project Designer. Landscape design and construction documents for streetscape improvements in the historically designated "Collins Avenue Corridor" National Register Architectural District.

Matheson Hammock Park General Plan, Miami-Dade County, FL
Role: Project Manager / Lead Planner. General Plan for the 635-acre Matheson Hammock Park, a National Historic Register property and one of the County's oldest and most significant resource-based parks.

Fairchild Tropical Garden Master Plan, Coral Gables, FL
Role: Project Manager / Lead Planner. Master Plan update for historic 83-acre botanical garden, providing locations for additional parking and new Visitor Center, with guidelines for additional site and planting improvements and for preservation of key principles and features of W.L. Phillips' original 1938 garden plan.

Heritage Monument Trail, 1998, Islamorada, FL. Role: Project Director. Development of a village-wide interpretive trail as well as construction documents for site-specific improvements for the Hurricane Monument, a memorial to victims of the 1935 Labor Day Storm.

McKee Botanical Garden, 2011, Vero Beach, FL. Role: Principal Landscape Architect. Planting renovation of garden entrance and main visitor routes for the garden's tenth anniversary celebration (2011). Previous phases of services: preliminary planning for rehabilitation of historic landscape (former McKee Jungle Gardens) and support materials for capital campaign (1994); Master Plan (1997); and design, construction documents and construction observation (1999 -2008).

FSU / Ringling Center for the Cultural Arts, 2004, Sarasota, FL. Role: Project Manager. Historic Landscape Assessment and Landscape Master Plan for 34-acre estate including The John & Mable Ringling Museum of Art, Museum of the Circus, and "Ca'd'Zan" mansion; design and construction documents/observation for \$1.2-million first phase of site improvements for new Visitor Center.

ASLA Florida Chapter, Bok Tower Gardens Master Plan, Lake Wales, FL
2012 Landscape Preservation Award, Florida Trust for Historic Preservation: Cultural Landscape Report for Sunken Gardens, St. Petersburg, FL
2010 Merit Award, ASLA Georgia Chapter: Atlanta Botanical Garden Visitor Center/Parking Facility
2009 Development of Excellence Award, ULI Atlanta: Atlanta Botanical Garden Visitor Center/Parking Facility and Southern Seasons Garden
2005 Residential Grand Award, Builder's Choice Design and Planning Awards: Southern Accents Idea Home, WaterSound Beach, FL
2004 1st Place Landscape Architecture Award, APA Gold Coast Chapter: Medsouth Park, Miami, FL:
2003 Honor Award, ASLA Georgia Chapter: Brook Run Park Master Plan, Dunwoody, GA.
2003 Review Panelist, Florida Bureau of Historic Preservation Grants-In-Aid, 2003
2002 Landscape Preservation Award, Florida Trust for Historic Preservation, 2002: McKee Botanical Garden, Vero Beach, FL
2001 Merit Award, ASLA San Diego Chapter: Quail Botanical Gardens Master Plan, Encinitas, CA.
2000 Design with Natives Award, Florida Native Plant Society: Mangrove Park, Boynton Beach, FL.

The Mound House Cultural & Environmental Learning Center

Fort Myers Beach, FL



Accessible pathways through the "Settlers' Fruit Grove"



The Master Landscape Plan



Phase 1 under construction (2011)

The Mound House project combines rehabilitation of an historic, early-20th century pioneer residential landscape with access to a variety of natural and cultural landscapes, in a compact 2-acre layout. The historic Case family home sits atop a 2,000-year-old ceremonial shell mound, built by the Calusa tribe, elevated almost ten feet above the surrounding site. The design provides universally accessible visitor circulation while avoiding adverse impacts to the archaeological resource. Key features include restored mangroves and hardwood forest; a native meadow; lawn areas for outdoor classes and special events as well as informal enjoyment of the site; and enhanced water access with a renovated kayak launch and a wildlife observation pier. A "plants and people trail" displays and interprets native and introduced plants that have been utilized for food, shelter, medicine, sacrament, ornament, commerce or technology by the successive peoples that have occupied this one site, from the now-vanished Calusas to fisher-folk from colonial Cuba, and from pioneer American Florida settlers to our own society.

Project experience of team member David Sacks, ASLA

McKee Botanical Garden

Vero Beach, FL



Restored "Hall of Giants"



Entrance pergola (top) leads past discreetly placed new buildings to the main pond (above)



Re-created "jungle trails"



North America's first fully engineered bamboo building

McKee Botanical Garden is an oasis built on the remaining acreage of McKee Jungle Gardens, formerly one of old Florida's premier tourist attractions. Now surrounded by busy thoroughfares and residential and commercial properties, the Garden offers a rich and diverse display of tropical and subtropical plantings. The semi-wild ambience of the 1930s – a deep and tranquil oak-palm hammock, within which the gardens were originally developed – has been successfully re-created, even though the property is only a quarter of its former size. The historic center of the gardens, including two unique vernacular buildings, is an award-winning historic landscape *rehabilitation*, carefully done through research and analysis of the site, old drawings, photographs and written records. New visitor-service and education buildings were carefully sited and designed to blend into the landscape, and accessible trails now wind throughout the 18-acre gardens.

Project experience of team member David Sacks, ASLA

Christopher Alonso, RLA, LEED AP BD+C

Registered Landscape Architect

Description of Experience, Role and Responsibilities

Christopher Alonso has over 30 years of experience in planting/restoration design and landscape architecture. He has managed and designed projects for many different types of client assignments throughout the northeast and southeast United States including historical restorations, recreational, streetscapes and trails. With this experience, Mr. Alonso developed extensive knowledge in plant material, ecosystems, and sustainable practices. This results in a realistic and innovative approach that carries through projects from concept to completion.

Mr. Alonso has extensive knowledge in LEED Certification, and Sustainable Design methods, having worked and submitted projects with Gold accreditation. He has participated in the development of the Miami-Dade County Parks and Open Spaces System Master Plan document, which was commissioned to inform planning and design of open space throughout Miami-Dade County in the 21st Century. Mr. Alonso was the Miami-Dade County Parks Recreation & Open Spaces Project Manager on the Framework Plan for the Underline, “a 10 mile linear park, urban trail, and living art destination.”

Relevant Projects List

North East Library (LEED Gold), Aventura, FL, 2009-2016

Role: Landscape Architect. Project achieved a LEED Gold Certification through site-specific design elements, including a cistern system to water the landscape and eventually provide water to other library features. Designed two courtyards with seating, Ipe decking, living walls wrapping the interior of the courtyards, and a granite fountain to reflect the sky. Created an enhanced storm water basin to encourage more wildlife, where previously there was grass.

NW 137th Ave. Master plan for Bike Trail, Miami, FL, 2016

Role: Project Manager & Landscape Architect: Masterplan Development. Project included a bike path, an enhanced pedestrian crosswalk, and trees for shade, grading enhancements, and fitness amenities inside the FPL corridor (NW 8th St. to NW 12th St. along 137th Ave.). The plan helped identify current use and connectivity issues with surrounding communities, schools, and FPL site use and drainage.

157th Ave. Bike Trail/Newton Trail, Miami, FL, 2015-2016

Role: Project Manager & Landscape Architect. Designed & developed construction documents and permitted plans to create a 1-mile multiuse trail, including wayfinding signage, regulatory signage, and enhanced pedestrian crossing and landscaping. The plantings provide shade; the understory planting and wildflower mix will help reduce maintenance cost. The design also created additional linear parks where future shelters, butterfly gardens, and seating can be installed.

152nd Ave. Streetscape, Miami, FL, 2015-2016

Role: Project Manager & Landscape Architect. Development of a planting plan and streetscape planting for Miami-Dade County Public Works and Waste Management Department from SW 152 St. from SW 157 Ave. to SW 147 Ave. The project included an overall assessment of the existing palms and trees, the removal and relocation of large royal palms, and the addition of shade trees and median planting to enhance the overall feel and experience of the installed pedestrian walkway.



FERNANDEZ-BERAUD INC.
Landscape Architecture
and Planning

Office Address

717 Ponce de Leon #223
Coral Gables, Florida
33134

Office Phone Number

305-567-0110

Office Fax Number

305-913-2210

Email Address:

chrisa@Fernandez-
Beraud.com

Professional License

Florida Registered Landscape
Architect LA 6666853

LEED AP BD+C

CLARB Certified #3955

Academic Background:

**Master of Landscape
Architecture**

Rhode Island School of Design
(RISD), 2000

Bachelor of Arts, University
of Georgia, 1996

Employment:

**Miami-Dade County Parks
Recreation & Open Spaces**
October 2011 to January 2017
Landscape Architect

**Miami-Dade County General
Services Administration**

Dec 2008 to October 2011
Landscape Architect 3

CAA Head Start Facility (LEED Silver), Miami, FL, 2010-2015

Role: Landscape Architect. Assisted in locating the building and parking in order to showcase the existing specimen trees and understory planting. The design saved and relocated large oak trees and *Ficus aurea* to preserve the site's original character. Developed playgrounds and pathways around plant communities to develop nature-based play to encourage students to learn from their environment; design arranged plants to encourage kids to touch and feel plants while walking and playing.

Arcola Library, Miami, FL, 2009

Role: Landscape Architect. Arcola Library is located adjacent to the 441, a future corridor near the Community Action & Human Services Department (CASHD) facility and the police station. The landscape and site design helped promote outdoor activities while providing seating, gathering places, and walkways to meander from facility to facility. Eighteen specimen trees were relocated from downtown Miami's Government Center to replenish the non-existing canopy on the site. Phase 2 plans were developed and permitted, including plans for an amphitheater that included an elevated trellis and stage for outdoor movies and storytelling.

Golden Glades Library Site Enhancements with Shade Structure, Miami, FL, 2008. Role: Landscape Architect & Project Manager. Development of the overall site plan, construction documents, and permitted drawings for a shade canopy structure and paving, creating a unique identity for the library while encouraging outdoor activities like storytelling, outdoor shows, and presentations.

Honey Hill Archaeological Site, Miami, FL, 2007-2008

Role: Landscape Architect & Project Manager: Schematic Design, Construction Documents, Permitting and Construction Administration

Developed plans to create an archaeological park that helps preserve and educate the public about an existing village and cemetery of the Tequesta. To help preserve the artifacts, the entire site had to be filled with 2 feet of soil. The park contains interpretive signage, shelters, shade trees, and pathways that encourage a greater appreciation of the space and the history of the place.

Bayfront Park Renovation, Miami, FL, 2006

Role: Project Manager & Designer: Schematic Design, Const. Documents. The Bayfront Park Management Trust selected WRT to prepare a master plan for the restoration of one of the park's original features, a tropical garden overlooking Biscayne Bay. The plan for the garden's restoration included the addition of a café, dining pavilion, and new sculptural stone seating elements.

Miami International Airport, Landscape Master Plan, Miami, FL, 2005

Role: Project Manager & Designer: Master Plan, Construction Documents, and Const. Admin. Miami International Airport decided to establish a new comprehensive Landscape Identity that would reflect the airport's increased importance as a major world transportation hub, while defining an identity for surrounding communities. Provided framework to develop the perimeter and internal roadways (entering and exiting the airport) by creating entry nodes and gateways that enhance the public's experience, the airport's identity circulation, wayfinding in surrounding communities.

Haulover Park, Dune Restoration, Miami, FL, 2004

Role: Project Manager: Construction Documents, Construction Administration
Developed a general plan for Miami-Dade County's largest resources-based park, providing architectural and site design guidelines for the park's future development; including plans for the restoration of the native dune plant community.

Miami-Dade County Parks Recreation & Open Spaces

May 2006 to April 2008
Landscape Architect

Child Associates, Inc.

(Boston, MA)
Nov 2000 to March 2004
Principal, Landscape Designer

Awards

**Graduate Student
Fellowship**, Rhode Island
School of Design, 1999-2000

Memberships

USGBC – US Green Building
Council

Bruce Allan Wilson, AIA, LEED AP BD+C

Registered Architect

Description of Experience, Role and Responsibilities

Registered Architect in the State of Florida since January 2009 with over 25 years of experience in the practice of Architecture and Construction, Digital Graphics and Computer-Aided Design (CAD).

In the past 9 years, Mr. Wilson has been involved in Landscape Architectural projects with Fernandez-Beraud, Inc. He has brought to the Fernandez-Beraud team supporting skills in multi-format and cross-format CAD management and production, graphic design, realizations in photographic media, and consultation for architectonic design in Landscape Architecture.

Mr. Wilson has a developed experience in the implementation of current technologies in Computer-Aided Design (CAD), and Building Information Modeling (BIM). He is also a LEED Accredited Professional for Building Design and Construction.

Relevant Projects List

SR 997 - Krome Avenue - from South of SW 184th Street to South of SW 136th Street, 2016-current, Miami-Dade County, FL. Role: CAD support, QA/QC process. Roadway project that includes the tree disposition of approximately 800 trees.

Relocation of Atlantic Boulevard at Higgs Beach Park, 2015-current, **Key West**, Monroe County, Florida. Role: CAD support in all phases of project, field work, QA/QC process. Project addresses Phase 1 site renovations and complete street enhancements of a historic waterfront park. PH 1 includes re-location of the main park roadway, pedestrian & bicycle circulations, new dog parks, racquetball facility, and, landscape improvements.

Miami Dade College – Campus Gateways and Landscape Enhancements for MDC Kendall and North Campuses, 2014-2015, Miami-Dade County, FL. Role: Preparation of photography and photomontage of project components including campus entries, pool area, and streetscapes; participation in Conceptual/Schematic Design and Design Development; preparation of Construction Documents including drawings and coordination of Project Manual (project specifications).

FDOT Tiger Grant – 8th Street Pedestrian Bridge for FIU and the City of Sweetwater, 2014, Miami-Dade County, FL. Role: Participation in project Conceptual/Schematic Design; preparation of presentation drawings and digital photomontage images.

Miramar Readiness Center, Florida Army Reserve National Guard, 2012-2014, Miramar, Broward County, FL. Role: Participation in project schematic design; preparation of presentation drawings; and preparation of construction documents.

MDX SR 924: As-Built Documentation, 2011-2012, Miami-Dade County, FL. Role: Preparation of as-built CAD drawings for client's records, reference and use; interpretation of survey data of site area, and coordination of production with



FERNANDEZ-BERAUD INC.
**Landscape Architecture and
Planning**

Office Address

717 Ponce de Leon #223
Coral Gables, Florida 33134

Office Phone Number

305-567-0110

Email Address:

brucew@Fernandez-Beraud.com

Professional Licensure

Florida Registered Architect
AR 94629 (2009)

LEED AP BD+C (2014)

Academic Background

Bachelor of Architecture,
Ball State University, Muncie,
IN; 1992.

Bachelor of Science:

Environmental Design, Ball
State University, Muncie, IN;
1992.

Memberships and Associations

AIA, American Institute of
Architects.

USGBC, United States Green
Building Council.

Landscape Architect.

Roadway Landscape Maintenance Guidelines – Miami-Dade Expressway Authority. 2011, Miami-Dade County, FL. Role: Field/site photography, digital (Photoshop) preparation of images, graphic mark-up and illustration of instructional diagrams and imagery; editing and QC of text entries; manual (book) layout and production.

Streetscape of Jackson Memorial Hospital: NW 16th Street – Main Entrance, 2011, Miami-Dade County, FL. Role: Photomontage of design for visual study and presentation; preparation of construction documents.

PD&E Study, SR 922 / NE 125th Street from NE 5th Avenue to NE 7th Avenue, North Miami – Conceptual Landscape Masterplan, 2011, Miami-Dade County, FL. Role: Preparation of CAD and presentation graphics.

Scott Rakow Youth Center, Miami Beach, Florida, 2010. Role: Development of construction documentation for a 3-acre site of an existing facility. Project included an additional parking lot, new entrance plaza, upgrade of existing streetscape, and the addition of a new playfield.

MDX SR 924: NW 57th Avenue Interchange, 2010, Miami-Dade County, FL. Role: Field/site photography; digital photomontage for design studies and client presentation; construction document preparation.

MDX SR 83617: Bike Path, 2010, Miami-Dade County, FL. Role: Photomontage of designs for visual study and presentation.

MDX SR 836: Fourth Phase – Welcome Sign, 2009, Miami-Dade County, FL. Role: Photomontage for presentation; construction documentation.

Flagler Grove Park, Village of Pinecrest, Florida, 2009. Role: CAD production of construction documentation of a 3-acre neighborhood park. Program included two soccer fields, a playground, restrooms and parking areas.

Sunkist Pineland Park, Miami-Dade County, Florida, 2008. Role: Participation in design concepts and design development of a 1-acre neighborhood park. Managed site and area research, and production of graphic illustrations of the park's design booklet.

MDX SR 878/US-1 Intersection, 2008, Miami-Dade County, FL. Role: Field/site photography; digital (Photoshop) preparation of images; and photomontage of proposed designs for client and public review; preparation of construction documents.

Kendallwood Park - Neighborhood & Transportation Landscape Mitigation/Enhancement, 2008, Miami-Dade County, FL. Role: Field/site photography, digital preparation of images; photomontage for presentations to client, and for local public review/approval (photographic illustrations presenting existing conditions and anticipated (proposed) views of the adjacent neighborhood).

FRANCISCO ALONSO, PE

Civil Engineer

Professional Registrations

PE/Mechanical Engineering, Florida / #66918

Building Code Administrator, Florida / #BU1870

Academic Achievements

BS/2002/Mechanical Engineering/University of Miami

Affiliations

Member, Florida Engineering Society Miami Chapter

Mr. Alonso is a Professional Engineer with 14 years of experience in management, planning, design, permitting and construction of municipal engineering projects which include site Civil engineering, coastal facility design, vertical facility design and permitting, water and sewer design and permitting, storm-water master planning, storm-water design and permitting, traffic calming, and general roadway design. In addition he has provided professional engineering services as a consultant managing capital projects for various clients including Monroe County, City of Miami, the City of South Miami, Miami Shores Village, and the City of West Miami where Mr. Alonso's firm serves as the City Engineer.

Monroe County General Engineering Contract, Monroe County, Florida

Mr. Alonso serves as project manager for the firms Miscellaneous Engineering Contract with Monroe County. Tasks under this contract have included:

- **Blimp Road Boat Ramp Improvements** - This project includes the design, permitting and bidding assistance of the repair and extension of an existing boat ramp along Blimp Road.
- **Grouper Lane Drainage and Roadway Improvements** – This project includes the design, permitting, and construction administration of critical drainage improvements at this Key Largo location.
- **Stock Island 9th Avenue Drainage and Roadway Improvements** – this project includes the design, permitting, and construction administration of critical drainage improvements at this Stock Island location.
- **Stock Island Correctional Facility HVAC Improvements** – – this project includes the design, permitting assistance, and construction administration of improvements to this County facility on Stock Island.

Grouper Lane and Stock Island 9th Avenue Drainage and Roadway Improvements Projects, Monroe County, Florida. Mr. Alonso was the Project Manager and Engineer of Record for the drainage design of the storm-water management system for these two projects in Monroe County. The projects included solutions to address the unique drainage conditions of the low-lying coastal areas of the Florida Keys, specifically in Key Largo and Stock Island. The Project included a comprehensive drainage solution for the two locations, roadway design and reconstruction and permitting through the SFWMD. Coordination with the USACOE and the local utility agencies was also required.

Relocation of Atlantic Boulevard at Higgs Beach Restoration, Key West, Florida. Mr. Alonso serves as Project Manager and Engineer of Record Design and environmental permits for the relocation of Atlantic Boulevard as well as the park and coastal elements by implementing the Higg's Beach Masterplan. In addition this project included additional task to assist the County with the replenishment of the sandy beach involving the placement of sand above and below mean high water. Services include managing the regulatory permitting process, design needed to support the permit, and construction phase engineering services in accordance to acceptable industry standards.

FRANCISCO ALONSO, PE
Civil Engineer

Cudjoe Key Boat Ramp Improvements, Florida Keys, Florida. Design and permitting to repair an existing boat ramp that provides access to the bay at the end of Blimp Road on Cudjoe Key. The ramp requires repairs to make it both functional and safe which involved extending the existing ramp's apron. The boat ramp facility was prepared in accordance to Monroe County Code Land Development Regulations for Boat Ramps and both the USACE and FDEP permitting criteria. Project Principal for the firm assigned to oversee the design and permitting phases. Duties including oversight of the management of the project budgets, permitting, schedule, and quality control over project deliverables. In addition, Mr. Alonso served as the client manager coordinating the project progress with Monroe County staff.

SR-5/US1 Overseas Highway from MM 103 to MM 107 Resurfacing, Monroe County, Florida. As part of the Florida Keys Overseas Heritage Trail (FKOHT) project the firm was retained to perform professional engineering services which encompassed the milling, resurfacing and pavement marking plans from MM 103 to MM 107 along the US1 Overseas Highway. The project included drainage design, pavement, signals utilities, lighting and MOT plans. Responsibilities included overseeing the drainage design and acting as a quality control officer on said design.

City of Miami General Engineering Contract – 2002-present Mr. Alonso has provided professional engineering services and project management for various projects under the firm's Miscellaneous Engineering Contract with the City of Miami. The projects have ranged from horizontal roadway improvement and drainage projects as well as vertical projects involving Architecture, structural, MEP design and permitting. Some of the specific projects have included:

- Lummus Park Improvements
- Bayfront Park Electrical Improvements
- Mary Brickell Village Drainage and Roadway Improvements Project
- Overtown Greenway
- NW 14th Street Roadway Improvements
- NW 8th and 14th Court Roadway and Drainage Improvements
- SW 16th Ave, 17th Street, and 17th Terrace Roadway Improvements
- Dinner Key Marina Harbormaster Trailer and Regatta Launch Ramp
- Virginia Key Weigh Station Project
- Annual FEMA PDM Application Preparation
- Durham Terrace Drainage Improvements Project
- Fairlawn Phase III and Tamiami Storm Sewer Improvements Project Master Plan Improvements
- Fairlawn Storm Sewer Improvements – Phase IIB
- Flagami / West End Storm Sewer Improvements – Phase II
- Fueling Dock: Dinner Key Marina
- Coral Gate Wall

David Reynolds, PE
Civil Engineer

Professional Registrations

*Professional Engineer,
Florida, #61052*

Academic Achievements

*BS/1990/Civil
Engineering /Virginia
Military Institute,
Lexington, Virginia*

*United States Military
Academy, West Point,
New York*

Mr. Reynolds has over 25 years of experience in design, project management, and construction inspection for various forms of state and private transportation improvements and site development. His work includes highway/roadway, horizontal/vertical layout, stormwater management, drainage, grading, earthwork, lighting, utility design, erosion-sediment control, maintenance of traffic, right-of-way public involvement, construction estimates, hydrologic and hydraulic analysis, and scour countermeasure design experience. His construction experience includes Inspector and Resident Engineer assignments on highway improvement projects.

Old Highway, Islamorada, Florida; Project Manager. Roadway improvements and stormwater management systems to mitigate minor flooding conditions on approximately 1.6 miles of urban minor collector from US-1 to Blackwood Road on Upper Matecumbe Key. Responsible for the design of pavement reconstruction, milling, and resurfacing, the design of closed storm sewer systems, and project permitting with SFWMD. The project also involves incorporation of a new public bike path, mitigation of private encroachments into the clear zone, and construction phase services.

PortMiami-Civil Infrastructure Engineering Services, Miami, Florida, Civil Engineer. Mr. Reynolds serves as drainage engineer for a multi-year contract to provide comprehensive engineering services for the infrastructural and operational needs of PortMiami, including engineering design and design criteria services for the repair and rehabilitation, removal and replacement, and new construction of PortMiami's ancillary civil infrastructure.

Virginia Key Beach Park, Miami, Florida; Project Manager. Site reconstruction of the 8-acre park site and roadway improvements to Virginia Beach Drive and a circulation road adjacent to beach front and mangrove wetlands. The project included site design for reconstruction of a parking lot, storm-water management improvements, lighting system design, and permitting. The project also involved construction across Coastal Construction Control Line and impact analysis in a marine turtle habitat environment. Responsible for the design of site grading, open and closed storm sewer systems in accordance with City of Miami, SFWMD, and Miami-Dade DERM criteria as well as project permitting with DERM, FDEP, and USACE. The drainage design involved a closed system of swales, inlets, and exfiltration facilities to mitigate flooding conditions.

Low Pressure Sanitary Sewer and Water Main Improvements, Miami Shores Village, FL: Project Engineer. The Project involved the development of a new low-pressure sanitary force main collection system, regional pump station, sanitary discharge force main, and water main improvements to serve the Village Downtown Central Business District. Mr. Reynolds was responsible for utility coordination, the hydraulic analysis of sewage loads and design and layout of grinder pump and low pressure force main collection systems, design of a new regional sanitary pump station, design of 12" water main improvements, development of preliminary plans, design criteria, and production of RFP documents for advertisement of a Design-Build Contract.

David Reynolds, PE
Civil Engineer

Flood Mitigation Projects, City of Miami, Florida, Project Engineer – Project Engineer for the design of integrated closed storm sewer systems, lift stations, force main systems, and drainage canal improvements as part of municipal flood mitigation efforts. The coordinated concurrent projects involved construction of new storm sewer systems, exfiltration sewers and stormwater pumping systems for over 400 acres of urban watershed. The design also included local jurisdictional and state environmental agency permitting as well as municipal design workshops.

SR 5/Brickell Avenue, Miami, FL, Project Engineer. Managed the project design engineering and plan production for the Florida Department of Transportation (FDOT D-6). Provided design and construction phase services for pavement reconstruction proposed for 1.7 miles of an existing four-lane divided highway on SR-5 (Brickell Avenue). The work included concrete pavement restoration, maintenance of traffic, pedestrian access management, street lighting, signalization, and public involvement. Mr. Reynolds was responsible for the overall plan production, development of drainage system improvements, and utility coordination.

NE 71st Street Storm Sewers, Miami, Florida; Project Manager. Roadway improvements to two miles of urban roads and stormwater management systems to mitigate flooding conditions within 35 acres of urban watershed. Responsible for the design of all open and closed storm sewer systems in accordance with City of Miami, SFWMD, and Miami-Dade DERM criteria as well as project permitting with DERM, FDEP, and USACE. The drainage design involves roadside swales, exfiltration facilities, pollution control structures, gravity wells, and multiple discharge points into waters of the United States.

Design Services for offsite drainage; Civil Engineer.

Design services for the drainage systems located to the east and west of the new cruise terminal A at the Port.

South Dade Busway, Miami, FL, Project Engineer – Project involved 7.3 miles of new roadway construction, multi-use trail facilities, and site development for introduction of a new exclusive public transit facility for Miami-Dade Transit. The project design involved intersection improvements, street lighting, signalization, maintenance of traffic, engineered mitigation of in-situ contaminated soils within significant portions of the project corridor. Mr. Reynolds was responsible for the technical design of all storm drainage and stormwater management systems in accordance with FDOT, SFWMD, and Miami-Dade DERM criteria for the project corridor. He was also responsible for environmental permitting with DERM, SFWMD, and USACE as well as construction phase services.

Mr. Freedman is an experienced environmental professional serving public and private clients throughout the State of Florida. He specializes in municipal consulting and has provided plan review, landscape inspection, environmental assessments, expert witness, environmental permitting, ordinance development, street tree inventory, canopy assessments, carbon sequestration analysis and wildlife permitting services to municipalities throughout South Florida. He has also conducted numerous studies related to climate change and sea level rise and was involved with the preparation of the Broward County Climate Change Action Plan. Mr. Freedman is also an advanced diver with extensive experience conducting benthic resource surveys.

Project Experience

City of Tampa Continuing Arborist Services, Tampa, Florida — Mr. Freedman serves as a Tier 2 arborist and urban forestry consultant for the City of Tampa. Services have included an arborist assessment of trees within the Bayshore Boulevard right-of-way proposed to be impacted by bike lane construction and an assessment of trees on the Hillsborough Canal Dam.

Canopy Analysis, City of Miami Beach, Miami-Dade County, Florida — Mr. Freedman served as the Project Manager for this canopy analysis project for the City of Miami Beach. Using i-Tree Canopy, he and his team estimated the canopy coverage for the City's urban forest, as well as percentage of available space remaining within the City for additional tree planting. Mr. Freedman developed a one-page brochure for public education documenting the information from the study.

City of Key West City Hall Arborist Assessment, City of Key West, Monroe County, Florida — The City of Key West is relocating its City Hall facilities to the site of the former Glynn Archer Elementary School at 1300 White Street. In support of landscape and architectural design efforts, Mr. Freedman conducted an assessment of the approximately 65 trees at the site. The purpose was to assess the health and condition of the trees at the site, and to provide recommendations for preservation, transplantation and/or removal and replacement associated with the new design and in accordance with the City's municipal code

Street Tree Inventory, City of Coconut Creek, Broward County, Florida — E Sciences conducted a street tree inventory for the City of Coconut Creek. Work included inventorying approximately 10,000 trees within the City's communities. Mr. Freedman served as project manager for this project.

Village-wide Tree inventory, Village of Palmetto Bay, Miami-Dade County, Florida — E Sciences conducted a street tree inventory for the Village of Palmetto Bay. Work included inventorying approximately trees along the City's roadways, parks and municipal buildings communities, which included approximately 35,000 trees. Mr. Freedman served as project manager for this project.

Tree Inventory and Management Plan, City of Lake Worth, Palm Beach County, Florida — E Sciences conducted a street tree inventory for the City of Lake Work and developed an urban forest management plan. Work included inventorying approximately 8,000 trees within the City's roadways and parks and conducting canopy assessments for three different years. Mr. Freedman served as project manager for this project.

City of Miami Beach Groundwater Elevations Monitoring and Mapping Project (Sea Level Rise Study), City of Miami Beach, Miami-Dade County, Florida — The purpose of the study was to evaluate low lying areas vulnerable to SLR within Miami Beach based on the assumption that the groundwater levels under the City are tidally influenced and therefore flooding may also be influenced or exacerbated by tidal fluctuations. To accomplish this, the E Sciences Team monitored groundwater elevations and other data over a period of seven months. The elevation data collected was used in conjunction with Light Detection and Ranging

Education

M.S., Nova Southeastern University, 2010

B.A., Biology, Tufts University, 1997

Professional Licenses / Certifications

Certified Arborist, FL 5488A

Tree Risk Assessment Qualification (ISA)

FDEP Certified Erosion and Sediment Control Inspector and Instructor

Certified Manatee Observer

PADI Advanced Open Water, Enriched Air Certified Diver

Certified Landscape Inspector

Certified Green Industries Best Management Practices Instructor

Certified in Advanced Maintenance of Traffic

Years of Experience

15

(LiDAR) topography and tidal data to model vulnerability and provide guidance regarding potential stormwater priorities for the City. Mr. Freedman analyzed the data and prepared the report for the City. He presented the findings of this study at the 2013 Annual South Florida Association of Environmental Professionals Symposium.

Citywide Arborist Services, City of Dania Beach, Broward County, Florida — Work for this project was performed under a continuing services contract and involves serving as the City Arborist for Dania Beach. Activities included reviewing tree removal license applications including coordinating license requirements with citizens and approving removal applications. Other tasks included reviewing landscape plans submitted as part of Site Development Plans submitted to the City for proposed developments.

Urban Forest Canopy and Vegetation Analysis, South Florida Audubon Society, Town of Davie, Broward County, Florida — For this project, Mr. Freedman designed and managed a town-wide vegetation sampling project to analyze the extent and structure of the town's urban forest canopy. Services included randomly generating sample plots, coordinating site access, managing field data collection and data entry, analysis of data and reporting. This project also included quantifying the environmental benefits services being provided by the Town's urban forest canopy and design of signage placed at Town Hall that educates residents on the value of the services being provided by the Town's trees. Mr. Freedman published the results of this study in the ISA Florida's publication.

Districtwide PD&E Support, Miscellaneous Support Services, FDOT District Four, Florida — E Sciences, as a sub-consultant, provides miscellaneous environmental support to the FDOT to assist with the Work Program, plans review, environmental features memos, electronic review comments (ERC), and field surveys for environmental issues including contamination, wetland, wildlife/listed species, 4(f) and cultural resources. E Sciences personnel provide in-house support on a regular basis under this contract, including uploading reports to Project Suite, entering ERC, reviewing plans, and meeting regularly with FDOT Project Managers, the District Contamination Impact Coordinator and the District Construction Environmental Coordinator to review environmental issues on planned and upcoming construction projects. Projects reviewed for NEPA compliance include those for roadway and transit projects. Under this contract, E Sciences personnel also provide listed species, benthic and wetland surveys.

Street Tree Inventory, City of West Palm Beach, Palm Beach County, Florida — Mr. Freedman managed this Florida Department of Forestry Urban and Community Forestry Grant funded street tree inventory. Over 19,000 tree and planting space locations were collected and delivered to the client as an ArcGIS shape file. Activities included supervising field staff, field data collection, data quality verification, map preparation, preparation of Urban Forestry management plan, training for client contact on use of GPS data collector and ArcGIS, and training for client and urban forestry staff on use of inventory for managing work flow.

Street Tree Inventory, City of Miami Beach, Miami-Dade County, Florida— Mr. Freedman served as the project manager for a street tree inventory for the City of Miami Beach. Started in 2013, this project has included more than 35,000 trees to date.

Vizcaya Museum and Gardens, City of Miami, Miami-Dade County, Florida — This project involved a multi-disciplinary landscape architecture and environmental restoration plan for the waterways and tidal pool within the museum's property, which balanced ecological function with creative landscape aesthetics, recreational functions and values, and improvements to water quality, and planting designs based on historic flora inventories, including mangroves, native hardwood hammock and coastal scrub species. Mr. Freedman served as the project manager for the construction administration portion of this project, including evaluating contractor qualifications and conducting compliance inspections.

Municipal Tree Inventory, City of Doral, Miami-Dade County, Florida — Mr. Freedman conducted a tree inventory for two City parks – Doral Meadows and Morgan-Levy - locating trees using sub-meter GPS. He prepared GIS-based maps depicting the locations of the trees over aerial photographs.

Mr. Voelker is a senior scientist with over 20 years of experience specializing in natural resource assessments and permitting, as well as certified arborist services. He provides numerous ecological services to clients, including the following: wetland delineation, function evaluation, mitigation design, monitoring, and permitting; upland habitat assessments; coastal habitat assessments and permitting; marine and estuarine habitat assessments and permitting; protected wildlife assessments and permitting; GPS data collection/mapping and GIS database development; NEPA document preparation and oversight; sediment and erosion control monitoring.

As an ISA Certified Arborist, Mr. Voelker provides numerous consulting arborist services to both public and private sector clients, including the following: GPS tree inventories and GIS tree database development; destroyed/damaged tree assessments; tree value estimates; tree grading; tree/utility conflict identification; hazard tree evaluations (risk assessment); analysis of tree canopy cover and ecological/monetary benefits; urban forest management plans; planting and maintenance bid packages, mangrove trimming oversight; tree removal permitting.

Project Experience

Canopy Analysis, City of Miami Beach, Miami-Dade County, Florida — Mr. Voelker served as lead project scientist for this canopy analysis project for the City of Miami Beach. Using i-Tree Canopy, he and his team estimated the canopy coverage for the City's urban forest, as well as percentage of available space remaining within the City for additional tree planting. Mr. Voelker developed a one-page brochure for public education documenting the information from the study.

Canopy Analysis, City of Oakland Park, Broward County, Florida — Mr. Voelker served as lead project scientist for this canopy analysis project for the City of Oakland Park. Using i-Tree Canopy, he and his team estimated the canopy coverage for the City's urban forest, as well as percentage of available space remaining within the City for additional tree planting. Mr. Voelker developed a one-page brochure for public education documenting the information from the study.

City of Coconut Creek Street Tree Inventory, Broward County, Florida — E Sciences conducted a GPS street tree inventory for the City of Coconut Creek. Work included inventorying approximately 10,000 trees within the City's communities. Mr. Voelker served as lead project scientist for this project, performing the majority of the GPS inventory as well as the generation of a GIS tree database.

City of Miami Beach Street Tree Inventory, Miami-Dade County, Florida — Mr. Voelker served as the lead project scientist for two phases of street tree inventory/health assessment for the City of Miami Beach; the two phases encompassed the Normandy Shores and Normandy Isles neighborhoods. The assessments include health and structure evaluations, identification of utility conflicts, pruning recommendations, and general risk evaluations. The resulting GPS data will be used to generate a GIS tree database which the City can then use as a tool for managing urban forest resources in this particular community. The results of this analysis may then be used to develop the framework for a City-wide GIS tree database. Mr. Voelker performed the entire GPS inventory and created the resulting GIS tree database.

General In-house Environmental Services, FDOT District Four, Florida — E Sciences provided in-house environmental support to the FDOT District Four Planning and Environmental Management (PL&EM) Office. Mr. Voelker assisted with various services, including environmental phase reviews, preparation and review of NEPA documentation for numerous roadway and bridge projects, and field identification of listed species habitat, wetlands, historic resources, Section 4(f) sites, and contaminated sites.

Education

M.S., Coastal Zone Management, Marine Biology, Nova Southeastern University, 2000

B.S., Environmental Studies, State University of New York, 1996

Professional Licenses / Certifications

LIAF Certified Landscape Inspector #2012-125

SWS Professional Wetland Scientist #1355

ISA Certified Arborist #FL-5378A

ISA Tree Risk Assessment Qualification

PADI Certified Rescue Diver

FDEP Certified Stormwater Erosion and Sedimentation Control Inspector #29437

Years of Experience

20

Kendall Breeze Residential Community Tree Inventory, Kendall, Miami-Dade County, Florida (07/2013 – 08/2013) — This project involved a GPS tree inventory and photo documentation for all trees falling within Homeowner Association (HOA) managed portions of this 90+ acre residential community. Tree general condition and health (relative to pests) was also recorded. The resulting GPS tree data was provided to the client in both GIS format, as well as hard copy format (maps and corresponding tree tables). The inventory will then be used by the HOA's consulting arborist as a tool that will allow the HOA to efficiently and effectively manage their urban forest resources. Mr. Voelker served as lead project scientist for this project, performing the majority of the GPS inventory as well as preparation of the GIS tree database.

Venetian Islands Infrastructure Improvement Arborist Services, City of Miami Beach, Miami-Dade County, Florida — This project consisted of reviewing an existing tree survey and proposed infrastructure plans to identify potential conflicts between existing trees and proposed infrastructure. E Sciences then performed field visits to visually inspect and mark potential conflict trees. The field visits also involved coordination with the contractor to determine the limits of construction and verify if particular trees would be impacted based upon proposed construction methods. Pending these field visits, E Sciences generated a final plan set mark up and associated tree table identifying conflict trees. Mr. Voelker served as lead project scientist for this project, performing all field inspections as well as field meetings and coordination with City staff.

Village of Palmetto Bay - Village-wide Tree inventory, Miami-Dade County, Florida (2014) — E Sciences conducted a street tree inventory for the Village of Palmetto Bay. Work included inventorying approximately 27,000 trees along the City's roadways, parks and municipal buildings communities. Mr. Voelker served as lead project scientist for this project, performing the majority of the GPS inventory, preparation of the GIS tree database, and attended meetings with Village staff.

Sullivan Park Improvements Permitting, City of Deerfield Beach, Florida — The City of Deerfield Beach CRA received grant funding to improve its Sullivan Park property located on the Intracoastal Waterway. Improvements include upland features (i.e. new bathroom facilities, a splash park, landscaping, etc.) and in-water infrastructure including a dock for kayaking and paddle boarding and finger piers for boats. E Sciences was engaged by the project design firm Bermejo Ajamil to provide permitting support. Mr. Voelker assisted with various services including a benthic resource survey, coordination with the permitting agencies, and preparation of permit applications.

SR 786/PGA Boulevard ESBA, City of Palm Beach Gardens, Palm Beach County, Florida — This work was performed for FDOT District Four as a sub-consultant to Erdman Anthony. FDOT proposed to elevate the segment of SR 786 between SR 710/Beeline Highway and the C-18 Canal to alleviate flooding as well as improve hydrologic and wildlife connectivity under the roadway. Mr. Voelker provided various services, including database research, extensive field reviews, and the preparation and submittal of a revised ESBA report to account for roadway design modifications.

Greynolds Park Habitat Restoration, North Miami, Miami-Dade County, Florida — This work was performed for the Miami-Dade County Parks, Recreation, and Outdoor Spaces Division (PROS) as a sub to Gurri Matute. The work involved the design and permitting of a habitat restoration project intended to improve water quality and flushing for the estuarine mangrove habitat comprising the majority of the ±249 acre park. Elements of the project included wetland delineation and habitat mapping, earthwork/grading design, and supplemental planting design. Mr. Voelker served as lead project scientist on this project, performing extensive field reviews, preparing and submitting permit applications, and attending meetings with regulatory agencies and County staff.

Vizcaya Museum and Gardens, City of Miami, Miami-Dade County, Florida — This project involved a multi-disciplinary landscape architecture and environmental restoration plan for the waterways and tidal pool within the museum's property. The plan included planting designs based on historic flora inventories, including mangroves, native hardwood hammock and coastal scrub species. The project resulted in improved ecological functions and water quality improvements, improved landscape aesthetics, and increased recreational functions and values. Mr. Voelker served as the lead project scientist for the project, attending contractor meetings and conducting compliance inspections.

KENNETH DIDONATO, P.E.

Principal, Kenneth DiDonato, Inc.
Irrigation Consultant

2210 Hollywood Boulevard
Hollywood, Florida 33020
(954) 923-2555

Academic Background

Naval Officer Candidate School, 1969
Master of Science in Civil Engineering, University of Florida, 1968
Bachelor of Science in Civil Engineering, Newark College of Engineering, 1966

Professional Registration

Profession Engineer, State of Florida, PE #0020892

Professional Experience

Mr. DiDonato has over 35 years of experience in the design and installation of irrigation systems. He has worked on projects ranging from golf courses, parks and recreation, institutional and commercial. He has also worked with numerous public clients such as Broward County, City of Hollywood, Metro-Dade, City of Boca Raton, Cooper City, Town of Davie, City of Hialeah, City of Miami Beach, and Miami Dade Public Schools. Most recently, Mr. DiDonato has worked on projects in which the irrigation systems are responding to current Xeriscape Ordinances, as well as utilizing the latest in computer technology from the irrigation industry.

Projects Experience

- Miami Dade College, Kendall Campus, Miami, Florida
- Miami Dade College, North Campus, Miami, Florida
- Scott Rackow Community Youth Center, Miami Beach, Florida
- Flagler Grove Park, Pinecrest, Florida
- Margaret Pace Park, Miami, Florida
- Jackson Memorial Hospital Pediatric Playground, Miami, Florida
- Salvadore Park Playground, Coral Gables, Florida
- State School CCC-1 South Dade Senior High School, Miami, Florida
- Palmetto Bay Park, Miami, Florida
- Wittkop Park, Homestead, Florida
- Lummus Park, Miami Beach, Florida
- Atlantis Resort, Bahamas
- Ocean Club, Key Biscayne, Florida
- Pierson Park, West Palm Beach, Florida
- Tree Farm Park, Key Biscayne, Florida
- Collier Medical Office Complex, Naples, Florida
- The Tequesta, Miami, Florida
- Fisher Island, Miami, Florida
- Williams Island, Miami, Florida
- Grand Bay Hotel, Miami, Florida
- 41st Street Beautification, Miami Beach, Florida
- Paradise Island Roadway, Bahamas
- Aventura Boulevard, Aventura, Florida

Tom Graboski

President

Recent Projects:

Royal Caribbean International's
Project Genesis Series
Celebrity Cruise Line's
Project Solstice Series
NCL's Joy Newbuilding
Pines City Center
Pembroke Pines, FL
1 Hotel & Homes, Miami Beach

Relevant Projects:

City of Key West Historic
Seaport Signage
City of Miami
City of Coral Springs
City of Coral Gables
City of Aventura
Doral Park, City of Doral

Tom Graboski received his BFA from the Art Center College of Design in Los Angeles, and was awarded his Masters Degree in Urban Design from the University of Miami School of Architecture in 1977. In 1980, he founded Tom Graboski Associates, specializing in wayfinding, environmental signage and graphic design, branding, retail, exhibit design, and industrial design.

Tom's unique background in architecture, interior design, urban planning and graphic design blends talents that are essential to any project.

He has developed environmental graphics programs for a broad range of clients, including Royal Caribbean International, Universal Studios, Disney Development Corporation, Berkowitz Development, Bascom Palmer Eye Institute, the Marriott Corporation, Flagler Development, the University of Miami, Baptist Health South Florida, and the Cities of Coral Gables, Aventura, Coral Springs, and Miami.

A member of the Society for Environmental Graphic Design, the Industrial Design Society of America, and the American Institute of Graphic Arts, he has been the recipient of many local and national awards. Tom has taught, lectured, and been a visiting critic at the University of Miami, Florida International University, Miami Dade Community College, the Miami International University of Art and Design, and Miami Ad School. His work has been published extensively, both nationally and internationally.

Related Project Experience

Doral Park, City of Doral

Preparation an overall sign masterplan for the entire PUD site that is Downtown Doral. The plan included all sign types to be utilized throughout the site. TGA Design located each sign on a site plan and identified each sign type by function and design. Both vehicular and pedestrian wayfinding and major project identity signage was included.

City of Key West Bight Historic Seaport, Key West

Design of signage for the historic Seaport, comprising of identity, vehicular and pedestrian wayfinding, and regulatory, informational and interpretive graphics.

City of Coral Springs

Tom assisted the City of Coral Springs in re-writing the sign code portion of their City ordinance. Tom also attends all commission and stakeholder meetings on behalf of the City.

Coconut Grove Streetscape

TGA created a vehicular and pedestrian wayfinding signage system for Coconut Grove, Florida as part of the Coconut Grove streetscape charrette team. The signage component consisted of vehicular guide signage, entry feature banner poles, pedestrian wayfinding, map plan kiosks, neighborhood street signs, distinctive post applications for standard DOT traffic and information signage and City of Miami parking lot identity and directional signage.



QUALITY ASSURANCE / QUALITY CONTROL & SCHEDULE MANAGEMENT

Quality Assurance / Quality Control establishes processes and guidelines that the Fernandez-Beraud Team and sub-consultants will use to ensure that every activity and function required in providing services and products for this project meet both Fernandez-Beraud's and the City of Key West's highest expectations. A project-specific Quality Control Plan is prepared for each and every contract of work. It is intended to be a "living document" that will continue to be updated over the life of the team's design, production and work efforts.

Fernandez-Beraud is committed to achieving a high degree of satisfaction from the City of Key West. It is the responsibility of Fernandez-Beraud staff to plan and execute assignments with the highest standards in mind, so that Fernandez-Beraud produces quality work in the form and of the character that is expected by the Client and by Fernandez-Beraud. The preparation of the work must also meet or exceed normal, legally acceptable, "Due Diligence" ("Due or Ordinary Care") requirements that the standards of practice have established for Client work.

At the beginning of a project, the Project Manager develops a written Project Quality Assurance and Control Plan. The plan should include the project specific Quality Control Process and identify project staffing, including the Responsible Professionals for each work element, task and deliverable. The plan may address unique contractual requirements.

For any project awarded to Fernandez-Beraud, Inc., the following are participant professionals in the QA/QC process: Leticia Fernandez-Beraud, Project Manager & Principal-in-Charge (Senior Landscape Architect); Karen Cheney, Quality Checker (Senior Landscape Architect); Bruce A. Wilson, Quality Manager (Senior Architect); and, David Sacks, Independent Peer Reviewer (Senior Landscape Architect).

Good communications are essential to producing a quality product. Good internal communications among all parties involved in the project are also crucial to producing an error free product.

The Quality Assurance Process on any given project is to follow all requirements of the Client. The intent of the Quality Assurance Process is to confirm that Fernandez-Beraud has developed a Project Quality Assurance and Quality Control Plan and to verify that it is being followed. This process will determine whether or not the deliverable is being prepared and checked according to all Client requirements and in conformance to the Fernandez-Beraud Quality Control Process.

Schedule Management: We understand the importance of the City of Key West's commitment to their work program schedule. We are fully committed to meeting this need: As Project Manager, Ms. Fernandez-Beraud will work with the City of Key West PM to prepare the individual Tasks Work Orders schedules, which will follow the Critical Path Method of scheduling, or in any manner as it may be preferred by the City. We aim to set our INTERNAL TEAM SCHEDULE one month ahead of this to allow for a full 4-week period to resolve any unforeseen issues and to perform a more intensified and focused QA/QC process.



City of Key West, Florida

RFQ # 17-003

General Landscape Architectural Services



BUSINESS LICENSE

PROFESSIONAL LICENSES

USGBC LEED CERTIFICATES

PROOF OF INSURANCE

Fernandez-Beraud, Inc.

Landscape Architecture and Planning





State of Florida
Department of State

I certify from the records of this office that FERNANDEZ-BERAUD INC. is a corporation organized under the laws of the State of Florida, filed on April 8, 2004.

The document number of this corporation is P0400062444.

I further certify that said corporation has paid all fees due this office through December 31, 2017, that its most recent annual report/uniform business report was filed on January 17, 2017, and that its status is active.

I further certify that said corporation has not filed Articles of Dissolution.

Given under my hand and the Great Seal of the State of Florida at Tallahassee, the Capital, this the Seventeenth day of January, 2017

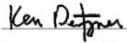
Secretary of State

Tracking Number: CC8943693287

To authenticate this certificate, visit the following site, enter this number, and then follow the instructions displayed.
<https://services.sunbiz.org/Files/CertificateOfStatus/CertificateAuthentication>

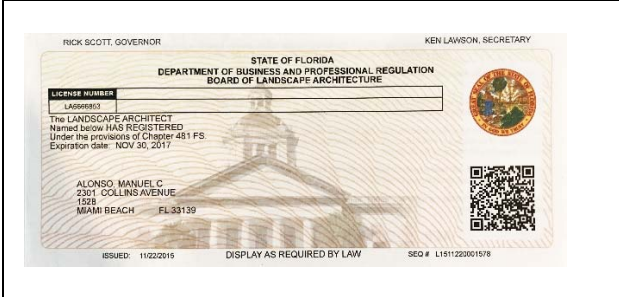
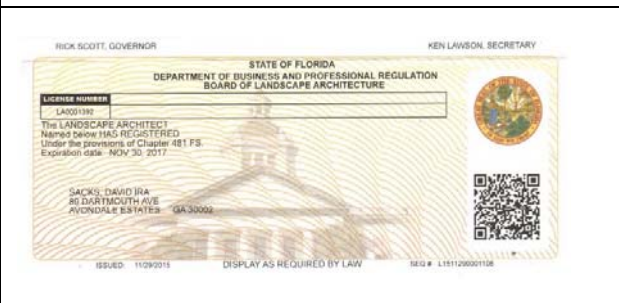
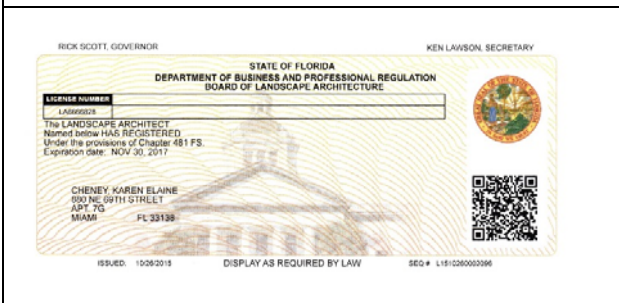
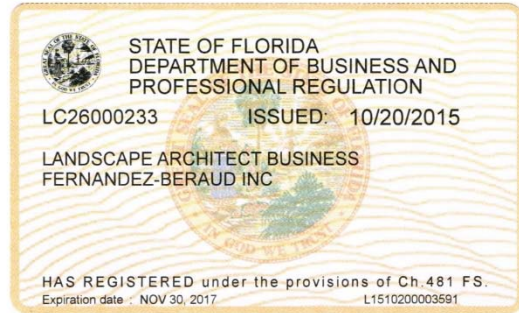



| | |
|--|--|
| | |
| | |
| | |
| | |





FORMS AND AFFIDAVITS



**SWORN STATEMENT UNDER SECTION 287.133(3)(a)
FLORIDA STATUTES ON PUBLIC ENTITY CRIMES**

**THIS FORM MUST BE SIGNED IN THE PRESENCE OF A NOTARY PUBLIC OR OTHER OFFICE
AUTHORIZED TO ADMINISTER OATHS.**

1. This sworn statement is submitted with Bid, Bid or Contract No. RFQ #17-003 for
GENERAL LANDSCAPE ARCHITECTURAL SERVICES

2. This sworn statement is submitted by FERNANDEZ-BERAUD, INC.
(Name of entity submitting sworn statement)

whose business address is 717 Ponce de Leon Blvd., Ste. 223, Coral Gables, Florida 33134

and (if applicable) its Federal
Employer Identification Number (FEIN) is 45-0538160 (If the entity has no FEIN,
include the Social Security Number of the individual signing this sworn statement.)

3. My name is Leticia Fernandez-Beraud and my relationship to
(Please print name of individual signing)

the entity named above is President.

4. I understand that a "public entity crime" as defined in Paragraph 287.133(1)(g), Florida Statutes, means a violation of any state or federal law by a person with respect to and directly related to the transaction of business with any public entity or with an agency or political subdivision of any other state or with the United States, including but not limited to, any Bid or contract for goods or services to be provided to any public entity or an agency or political subdivision of any other state or of the United States and involving antitrust, fraud, theft, bribery, collusion, racketeering, conspiracy, material misrepresentation.

5. I understand that "convicted" or "conviction" as defined in Paragraph 287.133(1)(b), Florida Statutes, means a finding of guilt or a conviction of a public entity crime, with or without an adjudication of guilt, in any federal or state trial court of record relating to charges brought by indictment information after July 1, 1989, as a result of a jury verdict, nonjury trial, or entry of a plea of guilty or nolo contendere.

6. I understand that an "affiliate" as defined in Paragraph 287.133(1)(a), Florida Statutes, means
 1. A predecessor or successor of a person convicted of a public entity crime: or
 2. An entity under the control of any natural person who is active in the management of the entity and who has been convicted of a public entity crime. The term "affiliate" includes those officers, directors, executives, partners, shareholders, employees, members, and agents who are active in the management of an affiliate. The ownership by one person of shares constituting controlling interest in another person, or a pooling of equipment or income among persons when not for fair market value under an arm's length agreement, shall be a prima facie case that one person controls another person. A person who knowingly enters into a joint venture with a person who has been convicted of a public entity crime in Florida during the preceding 36 months shall be considered an affiliate.

7. I understand that a "person" as defined in Paragraph 287.133(1)(8), Florida Statutes, means any natural person or entity organized under the laws of any state or of the United States with the legal power to enter into a binding contract and which Bids or applies to Bid on contracts for the provision of goods or services let by a public entity, or which otherwise transacts or applies to transact business with a public entity. The

INDEMNIFICATION

To the fullest extent permitted by law, the CONSULTANT expressly agrees to indemnify and hold harmless the City of Key West, their officers, directors, agents, and employees (herein called the "indemnitees") from liabilities, damages, losses and costs, including, but not limited to, reasonable attorney's fees and court costs, such legal expenses to include costs incurred in establishing the indemnification and other rights agreed to in this Paragraph, to persons or property, to the extent caused by the negligence, recklessness, or intentional wrongful misconduct of the CONSULTANT, its Sub-consultants or persons employed or utilized by them in the performance of the Contract. Claims by indemnitees for indemnification shall be limited to the amount of CONSULTANT's insurance or \$1 million per occurrence, whichever is greater. The parties acknowledge that the amount of the indemnity required hereunder bears a reasonable commercial relationship to the Contract and it is part of the project specifications or the bid documents, if any.

The indemnification obligations under the Contract shall not be restricted in any way by any limitation on the amount or type of damages, compensation, or benefits payable by or for the CONSULTANT under workers' compensation acts, disability benefits acts, or other employee benefits acts, and shall extend to and include any actions brought by or in the name of any employee of the CONSULTANT or of any third party to whom CONSULTANT may subcontract a part or all the Work. This indemnification shall continue beyond the date of completion of the work.

CONTRACTOR: FERNANDEZ-BERAUD, INC.

SEAL:

717 Ponce de Leon Boulevard, Suite 223
Coral Gables, Florida 33134
Address

Signature

Leticia Fernandez-Beraud
Print Name

President
Title

JULY 18, 2017
Date

EQUAL BENEFITS FOR DOMESTIC PARTNERS AFFIDAVIT

STATE OF FLORIDA)
 : SS
COUNTY OF MIAMI-DADE)

I, the undersigned hereby duly sworn, depose and say that the firm of FERNANDEZ-BERAUD, INC. provides benefits to domestic partners of its employees on the same basis as it provides benefits to employees' spouses per City of Key West Ordinance Sec. 2-799.

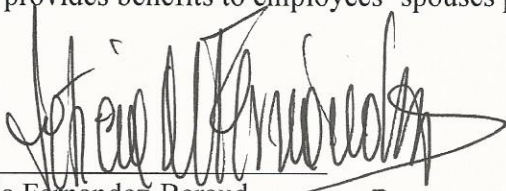
By: 
Leticia Fernandez-Beraud

Sworn and subscribed before me this
18 day of July, 2017.

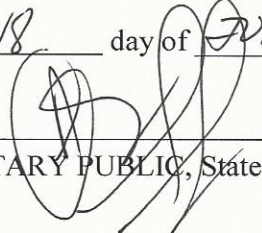
NOTARY PUBLIC, State of Florida at Large

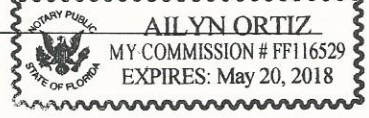
My Commission Expires: 

City Ordinance Sec. 2-799
Requirements for City Contractors to Provide Equal Benefits for Domestic Partners

(a) Definitions. For purposes of this section only, the following definitions shall apply:

- (1) **Benefits** means the following plan, program or policy provided or offered by a contractor to its employees as part of the employer's total compensation package: sick leave, bereavement leave, family medical leave, and health benefits.
- (2) **Bid** shall mean a competitive bid procedure established by the city through the issuance of an invitation to bid, request for proposals, request for qualifications, or request for letters of interest.
- (3) **Cash equivalent** means the amount of money paid to an employee with a domestic partner in lieu of providing benefits to the employee's domestic partner. The cash equivalent is equal to the employer's direct expense of providing benefits to an employee for his or her spouse.

The cash equivalents of the following benefits apply:

- a. For bereavement leave, cash payment for the number of days that would be allowed as paid time off for the death of a spouse. Cash payment would be in the form of the wages of the domestic partner employee for the number of days allowed.
 - b. For health benefits, the cost to the contractor of the contractor's share of the single monthly premiums that are being paid for the domestic partner employee, to be paid on a regular basis while the domestic partner employee maintains such insurance in force for himself or herself.
 - c. For family medical leave, cash payment for the number of days that would be allowed as time off for an employee to care for a spouse who has a serious health condition. Cash payment would be in the form of the wages of the domestic partner employee for the number of days allowed.
- (4) **Contract** means any written agreement, purchase order, standing order or similar instrument entered into pursuant to the award of a bid whereby the city is committed to expend or does expend funds in return for work, labor, professional services, consulting services, supplies, equipment, materials, construction, construction related services or any combination of the foregoing.
 - (5) **Contractor** means any person or persons, sole proprietorship, partnership, joint venture, corporation, or other form of doing business, that is awarded a bid and enters into a covered contract with the city, and which maintains five (5) or more full-time employees.
 - (6) **Covered contract** means a contract between the city and a contractor awarded subsequent to the date when this section becomes effective valued at over twenty thousand dollars (\$20,000).
 - (7) **Domestic partner** shall mean any two adults of the same or different sex, who have registered as domestic partners with a governmental body pursuant to state or local law authorizing such registration, or with an internal registry maintained by the employer of at least one of the domestic partners. A contractor may institute an internal registry to allow for the provision of equal benefits to employees with domestic partner who do not register their partnerships pursuant to a governmental body authorizing such registration, or who are located in a jurisdiction where no such governmental domestic partnership

registry exists. A contractor that institutes such registry shall not impose criteria for registration that are more stringent than those required for domestic partnership registration by the City of Key West pursuant to Chapter 38, Article V of the Key West Code of Ordinances.

- (8) ***Equal benefits*** mean the equality of benefits between employees with spouses and employees with domestic partners, and/or between spouses of employees and domestic partners of employees.

(b) Equal benefits requirements.

- (1) Except where otherwise exempt or prohibited by law, a Contractor awarded a covered contract pursuant to a bid process shall provide benefits to domestic partners of its employees on the same basis as it provides benefits to employees' spouses.
- (2) All bid requests for covered contracts which are issued on or after the effective date of this section shall include the requirement to provide equal benefits in the procurement specifications in accordance with this section.
- (3) The city shall not enter into any covered contract unless the contractor certifies that such contractor does not discriminate in the provision of benefits between employees with domestic partners and employees with spouses and/or between the domestic partners and spouses of such employees.
- (4) Such certification shall be in writing and shall be signed by an authorized officer of the contractor and delivered, along with a description of the contractor's employee benefits plan, to the city's procurement director prior to entering into such covered contract.
- (5) The city manager or his/her designee shall reject a contractor's certification of compliance if he/she determines that such contractor discriminates in the provision of benefits or if the city manager or designee determines that the certification was created, or is being used for evading the requirements of this section.
- (6) The contractor shall provide the city manager or his/her designee, access to its records for the purpose of audits and/or investigations to ascertain compliance with the provisions of this section, and upon request shall provide evidence that the contractor is in compliance with the provisions of this section upon each new bid, contract renewal, or when the city manager has received a complaint or has reason to believe the contractor may not be in compliance with the provisions of this section. This shall include but not be limited to providing the city manager or his/her designee with certified copies of all of the contractor's records pertaining to its benefits policies and its employment policies and practices.
- (7) The contractor may not set up or use its contracting entity for the purpose of evading the requirements imposed by this section.

(c) Mandatory contract provisions pertaining to equal benefits. Unless otherwise exempt, every covered contract shall contain language that obligates the contractor to comply with the applicable provisions of this section. The language shall include provisions for the following:

- (1) During the performance of the covered contract, the contractor certifies and represents that it will comply with this section.
- (2) The failure of the contractor to comply with this section will be deemed to be a material breach of the covered contract.
- (3) If the contractor fails to comply with this section, the city may terminate the

covered contract and all monies due or to become due under the covered contract may be retained by the city. The city may also pursue any and all other remedies at law or in equity for any breach.

- (4) If the city manager or his designee determines that a contractor has set up or used its contracting entity for the purpose of evading the requirements of this section, the city may terminate the covered contract.

(d) Enforcement. If the contractor fails to comply with the provisions of this section:

- (1) The failure to comply may be deemed to be a material breach of the covered contract; or
- (2) The city may terminate the covered contract; or
- (3) Monies due or to become due under the covered contract may be retained by the city until compliance is achieved; or
- (4) The city may also pursue any and all other remedies at law or in equity for any breach;
- (5) Failure to comply with this section may also subject contractor to the procedures set forth in Division 5 of this article, entitled "Debarment of contractors from city work."

(e) Exceptions and waivers.

The provisions of this section shall not apply where:

- (1) The contractor does not provide benefits to employees' spouses.
- (2) The contractor is a religious organization, association, society or any non-profit charitable or educational institution or organization operated, supervised or controlled by or in conjunction with a religious organization, association or society.
- (3) The contractor is a governmental entity.
- (4) The sale or lease of city property.
- (5) The provision of this section would violate grant requirement, the laws, rules or regulations of federal or state law (for example, the acquisition services procured pursuant to Chapter 287.055, Florida Statutes known as the "Consultants' Competitive Negotiation Act").
- (6) Provided that the contractor does not discriminate in the provision of benefits, a contractor may also comply with this section by providing an employee with the cash equivalent of such benefits, if the city manager or his/her designee determines that either:
 - a. The contractor has made a reasonable yet unsuccessful effort to provide equal benefits. The contractor shall provide the city manager or his/her designee with sufficient proof of such inability to provide such benefit or benefits which shall include the measures taken to provide such benefits or benefits and the cash equivalent proposed, along with its certificate of compliance, as is required under this section.
- (7) The city commission waives compliance of this section in the best interest of the city, including but not limited to the following circumstances:
 - a. The covered contract is necessary to respond to an emergency. b.

- Where only one bid response is received.
- c. Where more than one bid response is received, but the bids demonstrate that none of the bidders can comply with the requirements of this section.
- (f) City's authority to cancel contract. Nothing in this section shall be construed to limit the city's authority to cancel or terminate a contract, deny or withdraw approval to perform a subcontract or provide supplies, issue a non-responsibility finding, issue a non-responsiveness finding, deny a person or entity prequalification, or otherwise deny a person or entity city business.
- (g) Timing of application. This section shall be applicable only to covered contracts awarded pursuant to bids which are after the date when this section becomes effective.

CONE OF SILENCE AFFIDAVIT

STATE OF FLORIDA)
 : SS
COUNTY OF MIAMI-DADE)

I the undersigned hereby duly sworn depose and say that all owner(s), partners, officers, directors, employees and agents representing the firm of FERNANDEZ-BERAUD, INC. have read and understand the limitations and procedures regarding communications concerning City of Key West issued competitive solicitations pursuant to City of Key West Ordinance Section 2-773 Cone of Silence (attached).

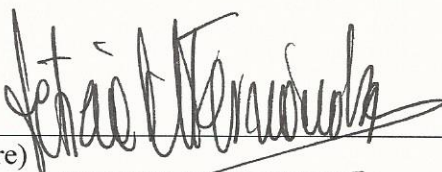

(signature) JULY 18, 2017

(date)

Sworn and subscribed before me this

18 Day of July, 2017.

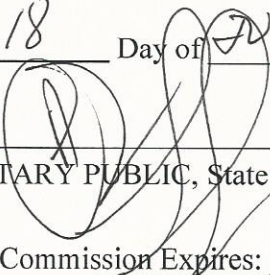

NOTARY PUBLIC, State of Florida at Large

My Commission Expires: _____

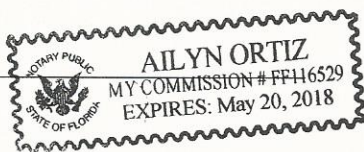

City Ordinance Sec. 2-773. - Cone of silence.

- (a) *Definitions.* For purposes of this section, reference to one gender shall include the other, use of the plural shall include the singular, and use of the singular shall include the plural. The following definitions apply unless the context in which the word or phrase is used requires a different definition:
- (1) *Competitive solicitation* means a formal process by the City of Key West relating to the acquisition of goods or services, which process is intended to provide an equal and open opportunity to qualified persons and entities to be selected to provide the goods or services. Competitive solicitation shall include request for proposals ("RFP"), request for qualifications ("RFQ"), request for letters of interest ("RFLI"), invitation to bid ("ITB") or any other advertised solicitation.
 - (2) *Cone of silence* means a period of time during which there is a prohibition on communication regarding a particular competitive solicitation.
 - (3) *Evaluation or selection committee* means a group of persons appointed or designated by the city to evaluate, rank, select, or make a recommendation regarding a vendor or the vendor's response to the competitive solicitation. A member of such a committee shall be deemed a city official for the purposes of subsection (c) below.
 - (4) *Vendor* means a person or entity that has entered into or that desires to enter into a contract with the City of Key West or that seeks an award from the city to provide goods, perform a service, render an opinion or advice, or make a recommendation related to a competitive solicitation for compensation or other consideration.
 - (5) *Vendor's representative* means an owner, individual, employee, partner, officer, or member of the board of directors of a vendor, or a consultant, lobbyist, or actual or potential subcontractor or sub-consultant who acts at the behest of a vendor in communicating regarding a competitive solicitation.
- (b) *Prohibited communications.* A cone of silence shall be in effect during the course of a competitive solicitation and prohibit:
- (1) Any communication regarding a particular competitive solicitation between a potential vendor or vendor's representative and the city's administrative staff including, but not limited to, the city manager and his or her staff;
 - (2) Any communication regarding a particular competitive solicitation between a potential vendor or vendor's representative and the mayor, city commissioners, or their respective staff;
 - (3) Any communication regarding a particular competitive solicitation between a potential vendor or vendor's representative and any member of a city evaluation and/or selection committee therefore; and
 - (4) Any communication regarding a particular competitive solicitation between the mayor, city commissioners, or their respective staff, and a member of a city evaluation and/or selection committee therefore.
- (c) *Permitted communications.* Notwithstanding the foregoing, nothing contained herein shall prohibit:
- (1) Communication between members of the public who are not vendors or a vendor's representative and any city employee, official or member of the city commission;
 - (2) Communications in writing at any time with any city employee, official or member of the city commission, unless specifically prohibited by the applicable competitive solicitation.
 - (A) However, any written communication must be filed with the city clerk. Any city employee, official or member of the city commission receiving or making any written communication must immediately file it with the city clerk.

- (B) The city clerk shall include all written communication as part of the agenda item when publishing information related to a particular competitive solicitation;
 - (3) Oral communications at duly noticed pre-bid conferences;
 - (4) Oral presentations before publically noticed evaluation and/or selection committees;
 - (5) Contract discussions during any duly noticed public meeting;
 - (6) Public presentations made to the city commission or advisory body thereof during any duly noticed public meeting;
 - (7) Contract negotiations with city staff following the award of a competitive solicitation by the city commission; or
 - (8) Purchases exempt from the competitive process pursuant to section 2-797 of these Code of Ordinances;
- (d) *Procedure.*
- (1) The cone of silence shall be imposed upon each competitive solicitation at the time of public notice of such solicitation as provided by section 2-826 of this Code. Public notice of the cone of silence shall be included in the notice of the competitive solicitation. The city manager shall issue a written notice of the release of each competitive solicitation to the affected departments, with a copy thereof to each commission member, and shall include in any public solicitation for goods and services a statement disclosing the requirements of this ordinance.
 - (2) The cone of silence shall terminate at the time the city commission or other authorized body makes final award or gives final approval of a contract, rejects all bids or responses to the competitive solicitation, or takes other action which ends the competitive solicitation.
 - (3) Any city employee, official or member of the city commission that is approached concerning a competitive solicitation while the cone of silence is in effect shall notify such individual of the prohibitions contained in this section. While the cone of silence is in effect, any city employee, official or member of the city commission who is the recipient of any oral communication by a potential vendor or vendor's representative in violation of this section shall create a written record of the event. The record shall indicate the date of such communication, the persons with whom such communication occurred, and a general summation of the communication.
- (e) *Violations/penalties and procedures.*
- (1) A sworn complaint alleging a violation of this ordinance may be filed with the city attorney's office. In each such instance, an initial investigation shall be performed to determine the existence of a violation. If a violation is found to exist, the penalties and process shall be as provided in section 1-15 of this Code.
 - (2) In addition to the penalties described herein and otherwise provided by law, a violation of this ordinance shall render the competitive solicitation void at the discretion of the city commission.
 - (3) Any person who violates a provision of this section shall be prohibited from serving on a City of Key West advisory board, evaluation and/or selection committee.
 - (4) In addition to any other penalty provided by law, violation of any provision of this ordinance by a City of Key West employee shall subject said employee to disciplinary action up to and including dismissal.
 - (5) If a vendor is determined to have violated the provisions of this section on two more occasions it shall constitute evidence under City Code section 2-834 that the vendor is not properly qualified to carry out the obligations or to complete the work contemplated by any new competitive solicitation. The city's purchasing agent shall also commence any available debarment from city work proceeding that may be available upon a finding of two or more violations by a vendor of this section.

(Ord. No. 13-11, § 1, 6-18-2013)