

#	Botanical Name	Common Name	DBH	Ht	Spread	Action
1	<i>Cocos nucifera</i>	Coconut Palm	10"	20'	6-8'	Preserve
2	<i>Cocos nucifera</i>	Coconut Palm	10"	20'	6-8'	Preserve
3	<i>Cocos nucifera</i>	Coconut Palm	10"	20'	6-8'	Preserve
4	<i>Cocos nucifera</i>	Coconut Palm	10"	20'	6-8'	Preserve
5	<i>Cocos nucifera</i>	Coconut Palm	10"	20'	6-8'	Preserve
6	<i>Cocos nucifera</i>	Coconut Palm	10"	20'	6-8'	Preserve
7	<i>Cocos nucifera</i>	Coconut Palm	10"	20'	7'	Preserve
8	<i>Cocos nucifera</i>	Coconut Palm	10"	20'	8'	Preserve
9	<i>Sabal palmetto</i>	Sabal Palm	14"	10'	7'	Preserve
10	Unknown	Unknown	multi-trunk	12'	8'	Preserve
11	<i>Cocos nucifera</i>	Coconut Palm	8"	18'	8'	Preserve
12	Unknown	Unknown	multi-trunk	10'	9'	Preserve
13	Unknown	Unknown	multi-trunk	11'	6'	Preserve
14	<i>Cocos nucifera</i>	Coconut Palm	11"	23'	8'	Preserve
15	Unknown	Unknown	multi-trunk	10'	6'	Preserve
16	<i>Cocos nucifera</i>	Coconut Palm	10"	20'	8'	Preserve
17	<i>Cocos nucifera</i>	Coconut Palm	9"	19'	8'	Preserve
18	<i>Veitchia Merrilli</i>	Christmas Palm	multi-trunk	20'	9'	Remove
19	<i>Veitchia Merrilli</i>	Christmas Palm	multi-trunk	20'	10'	Remove
20	<i>Veitchia Merrilli</i>	Christmas Palm	multi-trunk	20'	9'	Remove
21	<i>Veitchia Merrilli</i>	Christmas Palm	multi-trunk	20'	9'	Remove
22	<i>Sabal palmetto</i>	Sabal Palm	10"	8'	6'	Remove
23	<i>Veitchia Merrilli</i>	Christmas Palm	multi-trunk	20'	10'	Remove
24	<i>Veitchia Merrilli</i>	Christmas Palm	multi-trunk	20'	9'	Remove
25	<i>Veitchia Merrilli</i>	Christmas Palm	multi-trunk	20'	11'	Remove

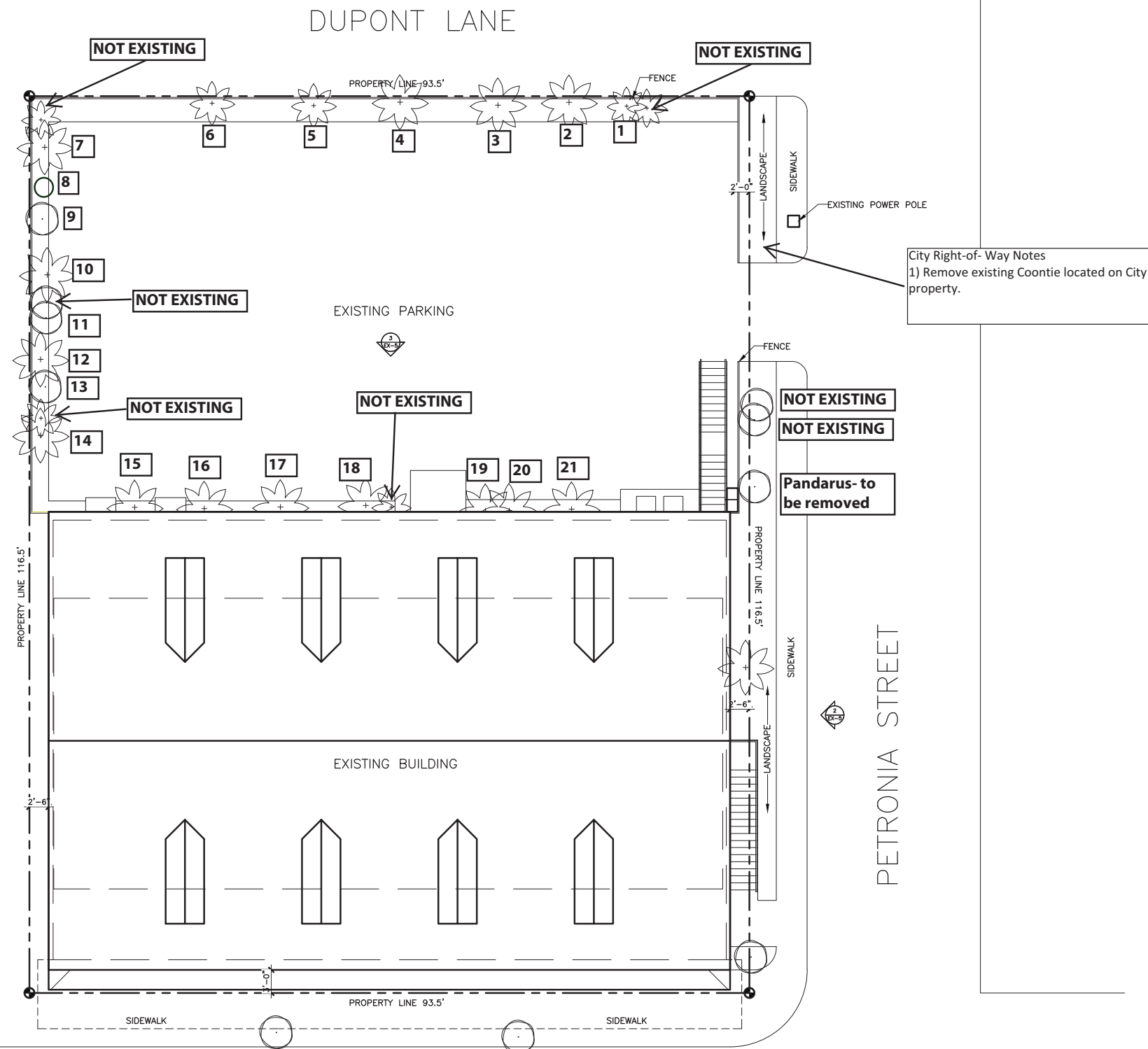

DUPONT LANE

DUVAL STREET

PETRONIA STREET

NEW HOUSING UNITS
 725 DUVAL STREET
 KEY WEST, FLORIDA.

SEAL _____

DATE
 04-28-15 DRC

REVISIONS _____

DRAWN BY
 KS

PROJECT
 NUMBER _____

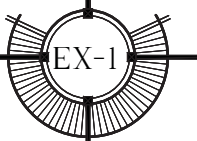

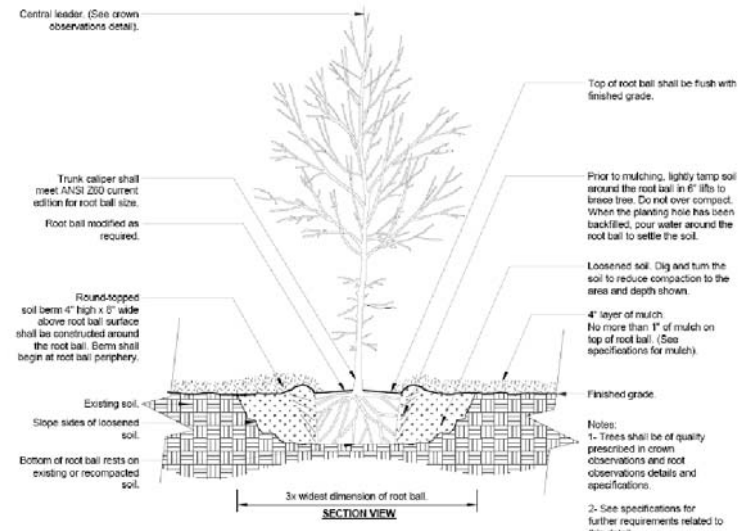

P-X TREE w/ BERM (EXISTING SOIL NOT MODIFIED)

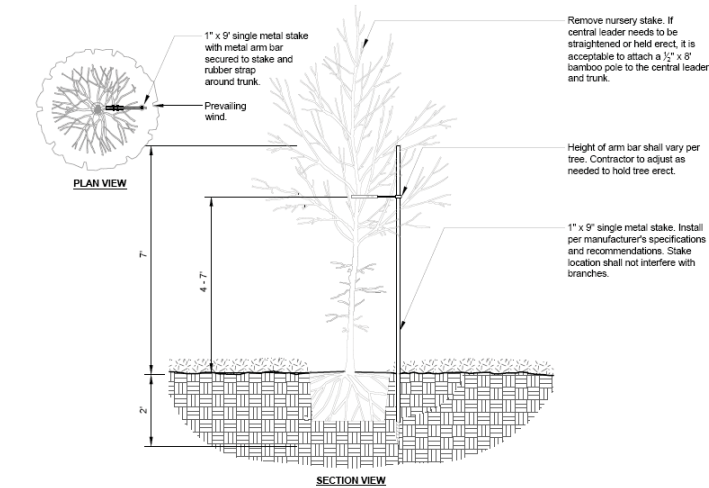

P-X TREE STAKING - SINGLE METAL STAKE

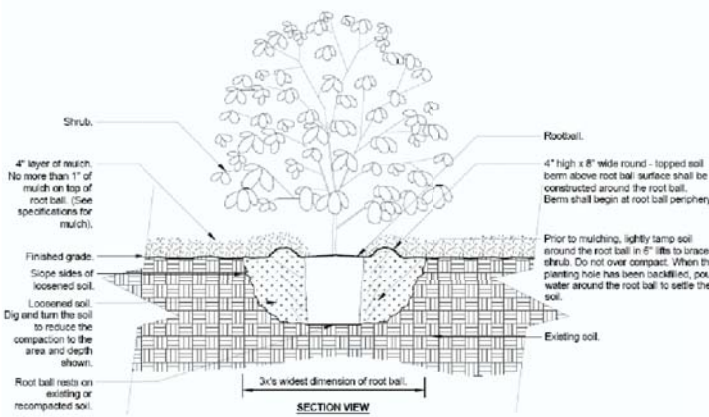

P-X SHRUB - UNMODIFIED SOIL

#	Botanical Name	Common Name	Specifications
20	<i>Psychotria nervosa</i>	Wild Coffee	7 GAL. 3'x3' minimum
8	<i>Sabal palmetto</i>	Sabal Palm	25 GAL. 6-8' OA
75	<i>Ernodea litteralis</i>	Golden Creeper	1 GAL. 12" OC

Section 108-518

Wild coffee (*Psychotria nervosa*)

Sabal Palms (*Sabal palmetto*)

Golden creeper (*Ernodea litteralis*)

Existing, preserved trees to remain

LANDSCAPE NOTES

1. Tree planting shall comply with details herein and the International Society of Arboriculture (ISA) standards.
2. The owner shall be responsible for the establishment, maintenance, and vigor of plant material in accordance with the design intent and appropriate for the season of the year.
3. Tree maintenance shall be in accordance with the American National Standards for Tree Care Operations, ANSI A300 and the standards of the International Society of Arboriculture (ISA).
4. Tree staking materials, if used, shall be removed after (1) growing season and not more than (1) year after installation.
5. No equipment shall be cleaned, or harmful liquids deposited within the limits of the root zone of trees which remain on site.
6. No signs, wires, or other attachments shall be attached to any tree to remain on site.
7. Vehicular and construction equipment shall not park or drive within the limits of the drip line.
8. No trenching shall be allowed within the drip-line of a tree, unless approved by the City.
9. The developer is responsible for all actions of his contractors and subcontractors until the improvements are accepted by the City.
10. Landscape irrigation shall be provided by hose end yard sprinklers, handheld hose or watering can to all new plantings at the following rate: Daily for 1 month, every other day for 3 months, then weekly until established.

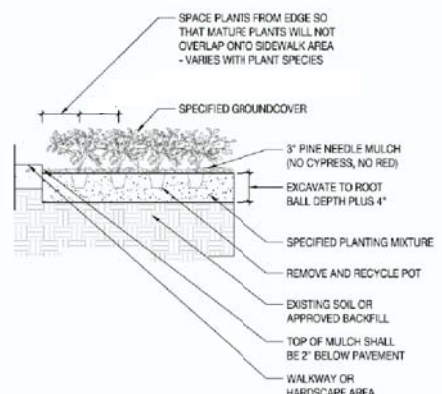

5 GROUND COVER PLANTING DETAIL

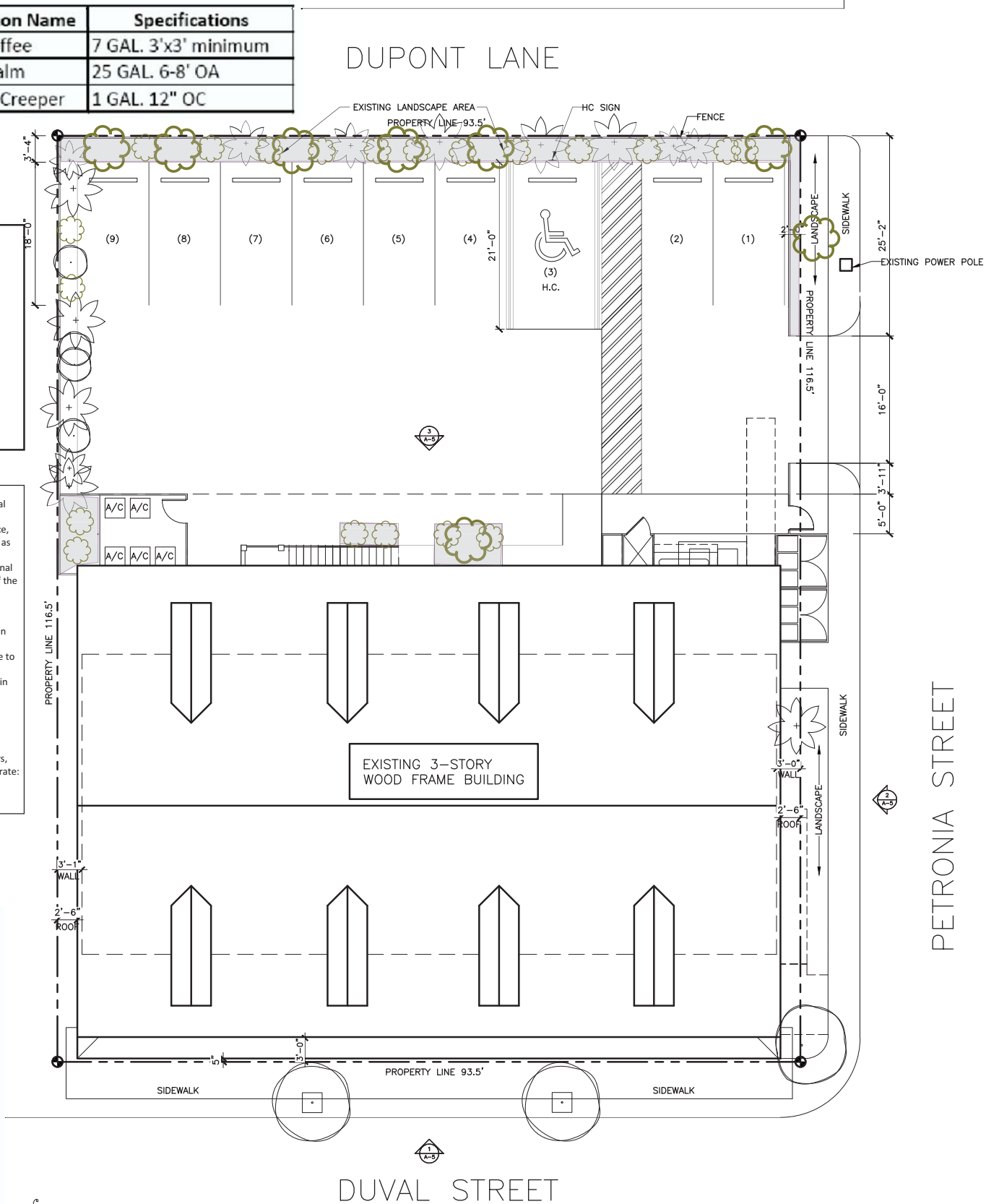

PROPOSED LANDSCAPE PLAN



NEW HOUSING UNITS
725 DUVAL STREET
KEY WEST, FLORIDA

NEW HOUSING UNITS
725 DUVAL STREET
KEY WEST, FLORIDA

SEAL

DATE

REVISIONS
5/27/15

DRAWN BY
KS

PROJECT
NUMBER

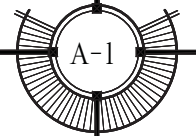

STAFF REPORT

DATE: May 27, 2015

RE: **725 Duval Street – Major Development Review
Conceptual Landscape Plan with Tree Removal**

FROM: Karen DeMaria, Urban Forestry Manager, City of Key West

An application was submitted for Conceptual Landscape Plan approval for a major development project at 725 Duval Street. The redevelopment of the existing building at 725 Duval will require the removal of (7) Christmas Palms, (1) Sabal palm, and (1) Pandarus (on City right-of-way). The removal of these trees will require the replacement of 9 palms on the property or in the immediate right of way. A large coontie plant in the City right of way will also be removed (no permit required).

The proposed landscape plan shows 7 sabal palms being planted in existing planting beds with an understory of wild coffee and golden creeper. The landscape plan meets the 70% native plant criteria. One additional native palms will need to be included in the plant in order to meet the tree removal replacement requirement. The applicant will be requesting waivers for other required landscaping including property line and parking buffer/tree requirements.



Standing in the property looking toward Dupont Lane at the existing Coconut Palms. Area to be enhanced with additional plantings.



Standing at the corner of Dupont Lane and Petronia Street looking at property.



Coontie to be removed-no permit required.



Pandarus tree to be removed

Standing at the corner of Dupont Lane and Petronia Street looking down Petronia toward Duval Street.



Standing on Petronia Street looking toward Duval Street at side of existing building/work area. Palm tree to remain and be protected.



Existing palms to be removed.



Existing vegetation to remain and to be enhanced with additional plantings.

RECOMMENDATION: Recommend approval of the Conceptual Landscape Plan with Tree Removal.

#	Botanical Name	Common Name	DBH	Ht	Spread	Action
1	Cocos nucifera	Coconut Palm	10"	20'	6-8'	Preserve
2	Cocos nucifera	Coconut Palm	10"	20'	6-8'	Preserve
3	Cocos nucifera	Coconut Palm	10"	20'	6-8'	Preserve
4	Cocos nucifera	Coconut Palm	10"	20'	6-8'	Preserve
5	Cocos nucifera	Coconut Palm	10"	20'	6-8'	Preserve
6	Cocos nucifera	Coconut Palm	10"	20'	6-8'	Preserve
7	Cocos nucifera	Coconut Palm	10"	20'	7'	Preserve
8	Cocos nucifera	Coconut Palm	10"	20'	8'	Preserve
9	Sabal palmetto	Sabal Palm	14"	10'	7'	Preserve
10	Unknown	Unknown	multi-trunk	12'	8'	Preserve
11	Cocos nucifera	Coconut Palm	8"	18'	8'	Preserve
12	Unknown	Unknown	multi-trunk	20'	9'	Preserve
13	Unknown	Unknown	multi-trunk	11'	6'	Preserve
14	Cocos nucifera	Coconut Palm	11"	23'	8'	Preserve
15	Unknown	Unknown	multi-trunk	10'	6'	Preserve
16	Cocos nucifera	Coconut Palm	10"	20'	8'	Preserve
17	Cocos nucifera	Coconut Palm	9"	19'	8'	Preserve
18	Veitchia Merrillii	Christmas Palm	multi-trunk	20'	9'	Remove
19	Veitchia Merrillii	Christmas Palm	multi-trunk	20'	10'	Remove
20	Veitchia Merrillii	Christmas Palm	multi-trunk	20'	9'	Remove
21	Veitchia Merrillii	Christmas Palm	multi-trunk	20'	9'	Remove
22	Sabal palmetto	Sabal Palm	10"	8'	6'	Remove
23	Veitchia Merrillii	Christmas Palm	multi-trunk	20'	10'	Remove
24	Veitchia Merrillii	Christmas Palm	multi-trunk	20'	9'	Remove
25	Veitchia Merrillii	Christmas Palm	multi-trunk	20'	11'	Remove

9a Sabal palmetto 6' preserve

26 Pandarus palm remove

27 coontie - remove NRR

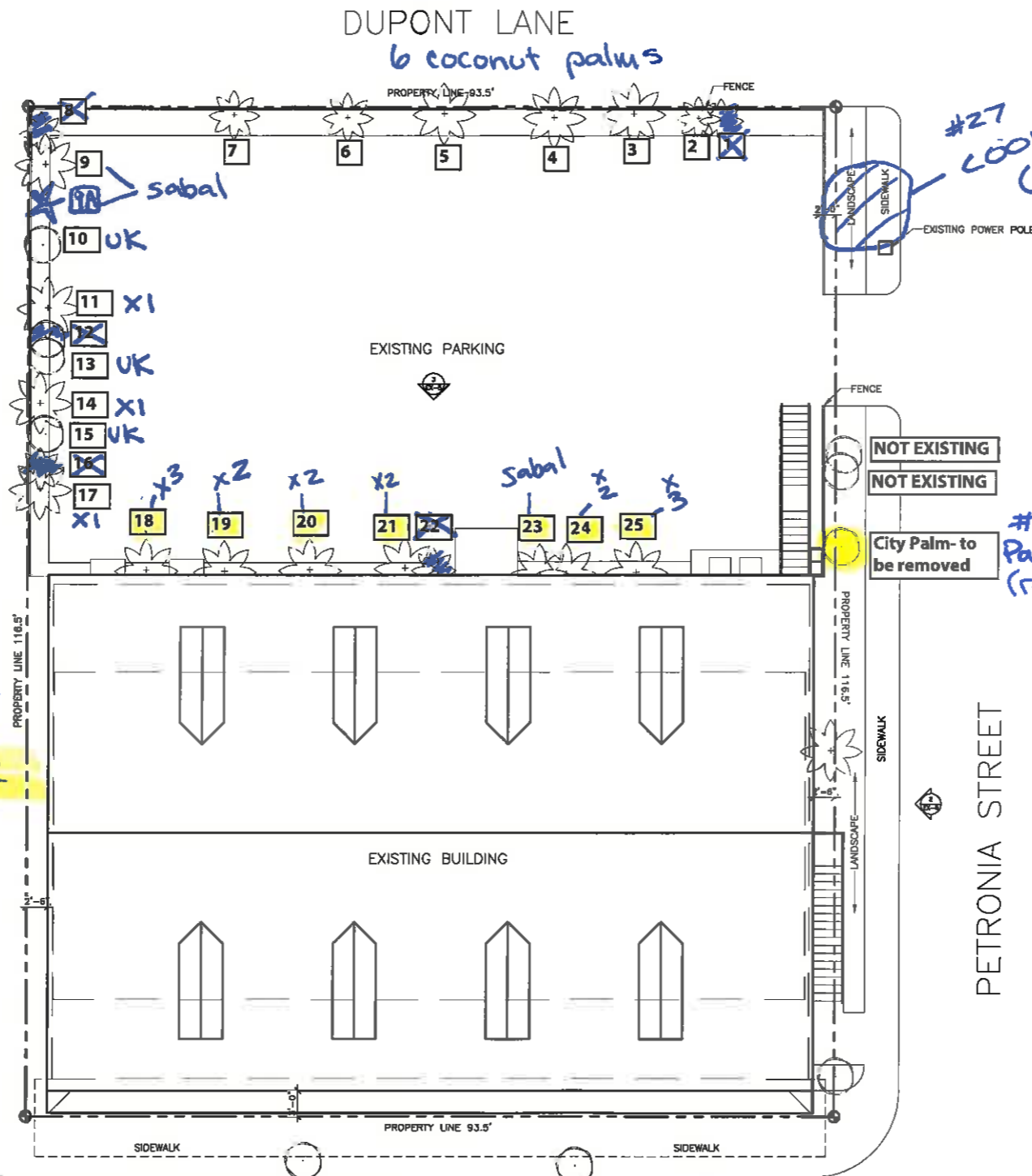

#27 coontie (remove-NPR)

x1 = single trunked Christmas palm

x2 = double trunked Christmas palm

x3 = triple trunked Christmas palm

UK = unknown dicot tree

#26 Pandarus (remove) palm

5.21.15
KS

SEAL

DATE
04-28-15 DRC

REVISIONS

DRAWN BY
KS

PROJECT NUMBER

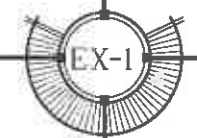

Application



7425

Tree Permit Application

Date: 5/20/2015

Please Clearly Print All Information unless indicated otherwise.

Tree Address 725 Duval Street
Cross/Corner Street Duval & Petronia
List Tree Name(s) and Quantity 7 Christmas Palms, 1 Sabal Palm
Species Type(s) check all that apply (Palm) (Flowering) (Fruit) (Shade) (Unsure)
Reason(s) for Application:

- () REMOVE () Tree Health () Safety () Other/Explain below
 () TRANSPLANT () New Location () Same Property () Other/Explain below
 () HEAVY MAINTENANCE () Branch Removal () Crown Cleaning/Thinning () Crown Reduction

Additional Information and Explanation Requesting approval for
1) Removal of 8 Palms along building
2) Landscape Plans (listed below)

Property Owner Name 725 Duval Street, LLC
Property Owner eMail Address _____
Property Owner Mailing Address 725 Duval Street
Property Owner Mailing City Key West **State** FL **Zip** 33040
Property Owner Phone Number (____) _____ - _____
Property Owner Signature _____

Representative Name Trepanier & Associates, Inc.
Representative eMail Address kevin@owentrepanier.com
Representative Mailing Address 1421 First st
Representative Mailing City Key West **State** FL **Zip** 33040
Representative Phone Number (305) 293 - 8983

NOTE: A Tree Representation Authorization form must accompany this application if someone other than the owner will be representing the owner at a Tree Commission meeting or picking up an issued Tree Permit.
 Tree Representation Authorization form attached ()

<<<<< Sketch location of tree in this area including cross/corner Street >>>>>

Please identify tree(s) with colored tape

Please see landscape plans included herein:

1. Existing Landscape Plan
2. Proposed Landscape Plan
3. Tree Protection Plan

If this process requires blocking of a City right-of-way, a separate ROW Permit is required. Please contact 305-809-3740.

City of Key West
Planning Department



Verification Form

(Where Authorized Representative is an entity)

I, OWEN TREPANIER, in my capacity as PRESIDENT
(print name) (print position; president, managing member)
of TREPANIER & ASSOCIATES, INC.
(print name of entity serving as Authorized Representative)

being duly sworn, depose and say that I am the Authorized Representative of the Owner (as appears on the deed), for the following property identified as the subject matter of this application:

725 DUVAL STREET
Street Address of subject property

All of the answers to the above questions, drawings, plans and any other attached data which make up the application, are true and correct to the best of my knowledge and belief. In the event the City or the Planning Department relies on any representation herein which proves to be untrue or incorrect, any action or approval based on said representation shall be subject to revocation.

[Signature]
Signature of Authorized Representative

Subscribed and sworn to (or affirmed) before me on this 4-29-2014 by
Owen J. Trepanier.
Name of Authorized Representative

He/She is personally known to me or has presented _____ as identification.

[Signature]
Notary's Signature and Seal

Richard Puente
Name of Acknowledger typed, printed or stamped



FF 067969
Commission Number, if any

City of Key West
Planning Department



Authorization Form
(Where Owner is a Business Entity)

Please complete this form if someone other than the owner is representing the property owner in this matter.

I, Joseph Cohen as
Please Print Name of person with authority to execute documents on behalf of entity

PRESIDENT of 725 Duval Street, LLC
Name of office (President, Managing Member) *Name of owner from deed*

authorize Trepanier & Associates, Inc.
Please Print Name of Representative

to be the representative for this application and act on my/our behalf before the City of Key West.

[Signature]
Signature of person with authority to execute documents on behalf on entity owner

Subscribed and sworn to (or affirmed) before me on this 4/29/2014 by
date

Joseph Cohen
Name of Authorized Representative

He/She is personally known to me or has presented _____ as identification.

[Signature]
Notary's Signature and Seal

Richard Puente
Name of Acknowledger typed, printed or stamped

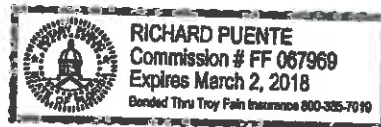

FF 067 969
Commission Number, if any