



THE CITY OF KEY WEST
Tree Commission

Post Office Box 1409 - Key West, FL 33041-1409
Telephone: 305-809-3723

May 8, 2024

Patrick T. Hegerty & Christopher Rounds
1125 Duval Street
Key West, FL 33040

To Whom It May Concern:

The City of Key West Tree Commission recently considered your application, TP2024-0001, for Conceptual Landscape Plan approval for the redevelopment of 1125 Duval Street, Key West, Florida, at their regularly scheduled meeting on May 7, 2024.

The Tree Commission approved the Conceptual Landscape Plan with palm removal, as submitted on landscape plans dated and revised April 25, 2024, to include the removal of (1) Foxtail palm (double trunked) and (2) Christmas palms.

This approval now allows the project to proceed through the review process with the Planning Board and HARC Commission. Once you have received approvals from these boards, an application should be made again to the Tree Commission for Final Landscape Plan approval. If no significant changes have occurred to the plan, then the Urban Forestry Manager will be able to file a memo into the file regarding Final landscape plan approval.

If you have any questions, please call the office at (305) 809-3768.

Sincerely,

Misha McRAE
Chairman, Tree Commission

Karen DeMaria
Acting Urban Forestry Manager
kdemaria@cityofkeywest-fl.gov

cc: Gregory Oropeza

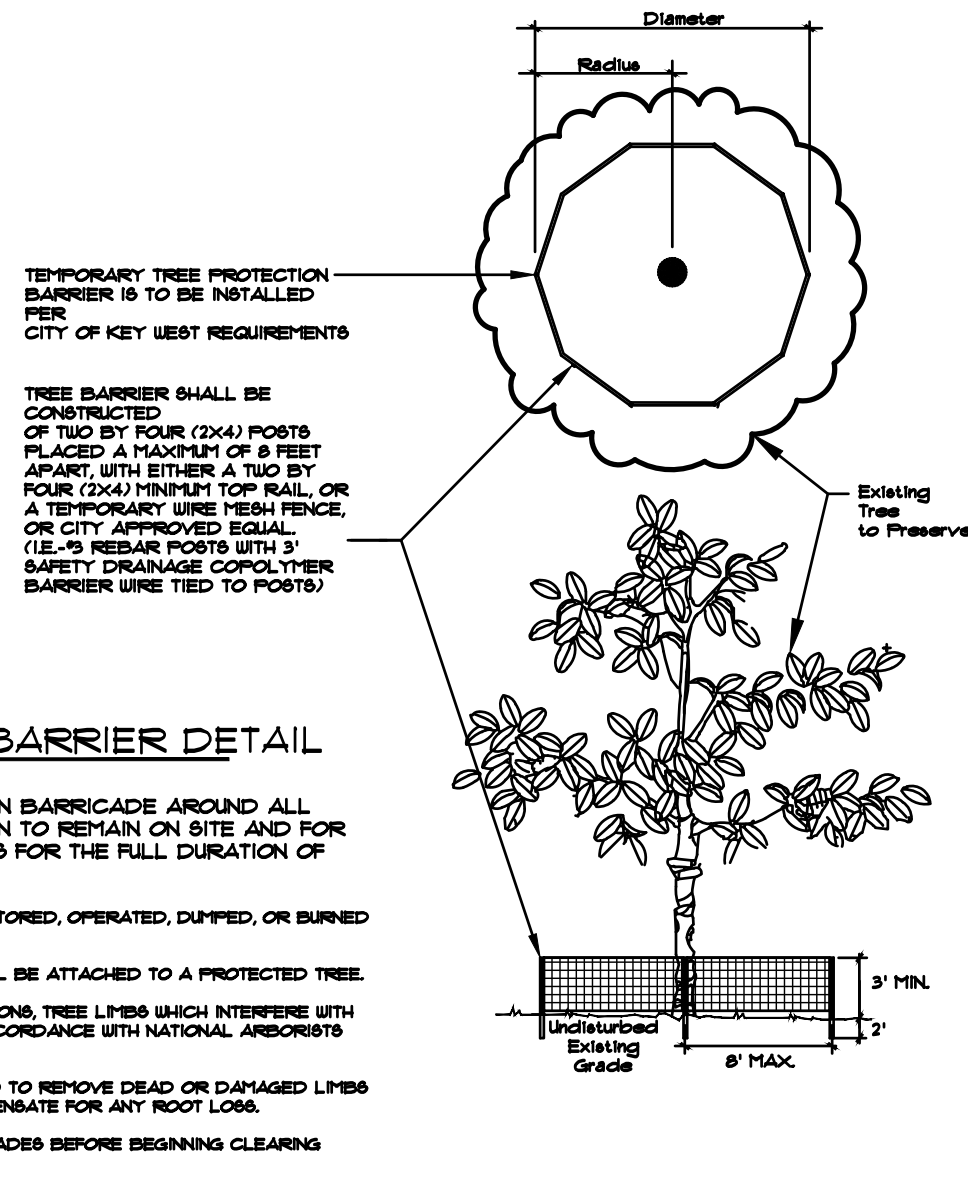

TREE PROTECTION BARRIER DETAIL
NO SCALE

EXISTING PLANTING				
QTY	BOTANICAL NAME	COMMON NAME	SPECIFICATION	DISPOSITION
6	Guaiacum sanctum	Lignum Vitae	3" DBH	Remain
5	Wodyetia bifurcata	Foxtail Palm	3" - 10" DBH (Approx. 39" Total)	Remain
2	Wodyetia bifurcata	Foxtail Palm	7" - 9" DBH (Approx. 16" Total)	Remove
8	Adonia merrillii	Christmas Palm	3" - 10" DBH (Approx. 41" Total)	Remain
2	Adonia merrillii	Christmas Palm	6" DBH (Approx. 12" Total)	Remove
3	Sable palmetto	Cabbage Palm	7" - 8" DBH (Approx. 23" Total)	Remain
1	Bursera simaruba	Gumbo Limbo	30" DBH	Remain
1	Conocarpus erectus	Buttonwood	4' - 6' Tall Hedge	Remain
1	Dracaena marginata	Dragon Tree	6" DBH	Remain
1	Livistona chinensis	China Fan Palm		Remain
1	Veitchia Montgomeryana	Montgomery Palm	Cluster	Remain
	Dypsis lutescens	Areca Palm	Various Clusters (refer to plans)	Remain
	Dypsis lutescens	Areca Palm	Various Clusters (refer to plans)	Remove
		Banana Trees	Cluster	Remove
1		Schefflera		Remove
1		Roses		Remove

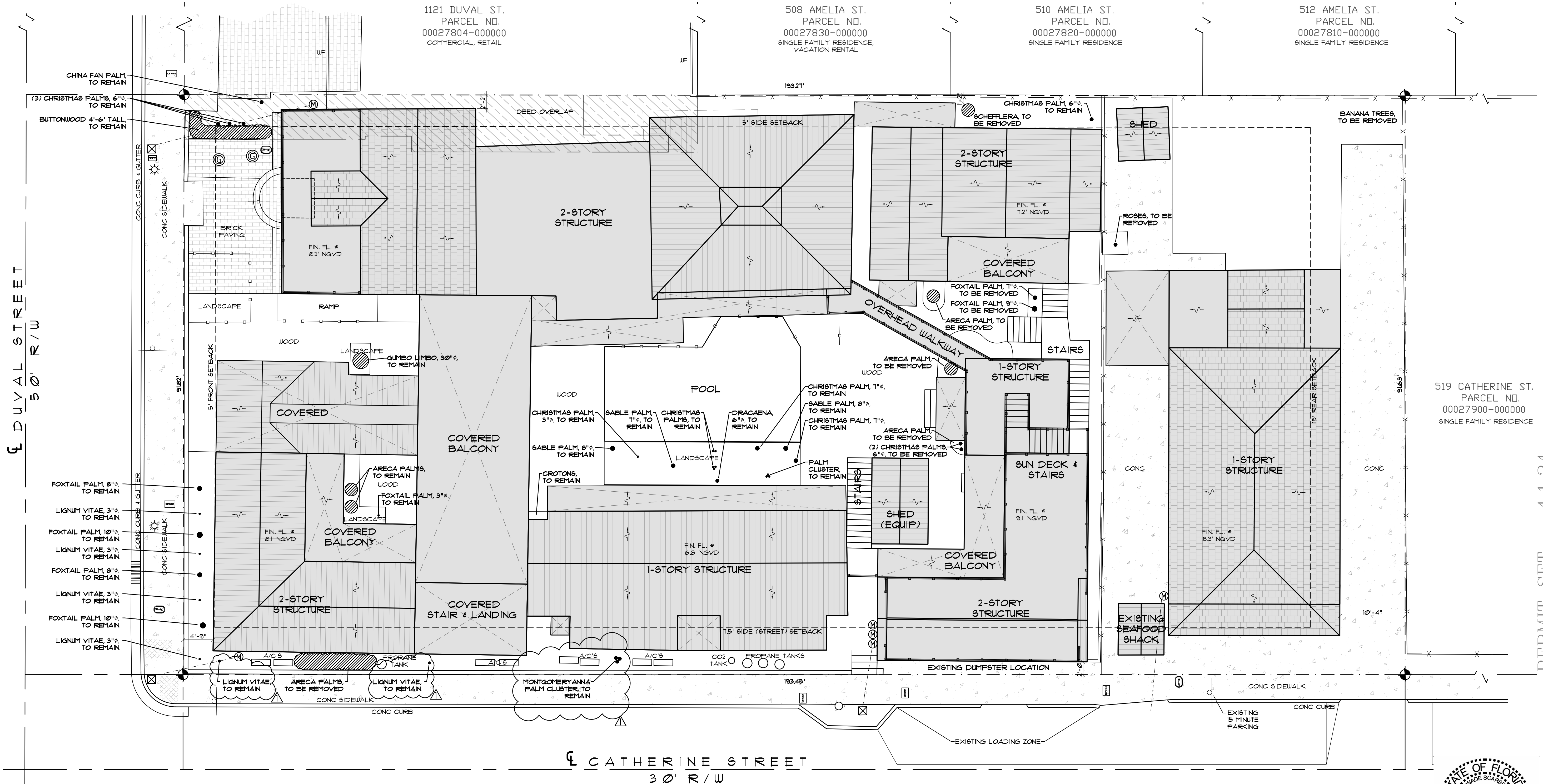

LaTeDa Resort
 1125 Duval & 515 Catherine Key West, FL

PERMIT SET - 4.1.24
 POPE-SCARBROUGH-ARCHITECTS
 THOMAS E. POPE, P.A.
 (305) 296 3611 610 White St, Key West FL

date: 04/01/24
 revision: 4/25/24

sheet:
 A0.3

NARRATIVE OF REVISION 1 (DATED 4/25/24):
 LIGNUM VITAE & MONTGOMERY PALM ADDED TO SITE PLAN AND TREE DISPOSITION.

Tree Disposition Plan
1/8" = 1' - 0"

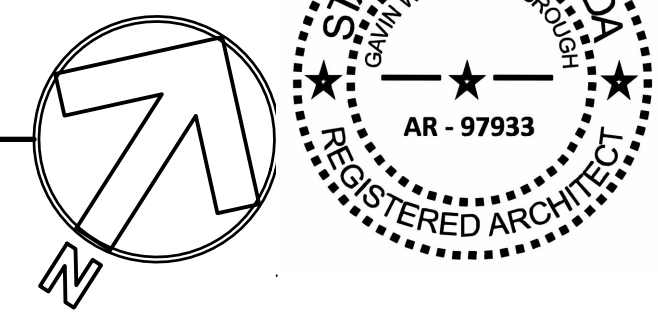

LANDSCAPE CALCULATIONS

BUFFER YARD D (12 LF)

REQUIRED:
 5' WIDE W/ 6' OPAQUE FENCE
 15 PLANT UNITS PER 100 LF
 12 LF/100 LF = 0.12 x 15 = 1.8 PLANT UNITS

PROVIDED:
 (4) ORNAMENTAL TREES = 20 PLANT UNITS
 (5) SHRUBS = 5 PLANT UNITS

BUFFER YARD D (81 LF)

REQUIRED:
 5' WIDE W/ 6' OPAQUE FENCE
 15 PLANT UNITS PER 100 LF
 81 LF/100 LF = 0.81 x 15 = 12.15 PLANT UNITS

PROVIDED:
 (5) ORNAMENTAL TREES = 25 PLANT UNITS
 (35) SHRUBS = 35 PLANT UNITS

60 PLANT UNITS PROVIDED
 6' OPAQUE FENCE PROVIDED IN ACCORDANCE WITH KEY WEST LDC SECTION 108-341

TOTAL PLANTING LIST

QTY	SPECIES	COMMON NAME	SPECIFICATION	REMARKS
9	PTYCHOSPERMA ELEGANS	ALEXANDER PALM	12'-14" CLEAR TRUNK	(5) ALEXANDER PALMS REPLACEMENT FOR PREVIOUSLY REMOVED PALMS (4) ALEXANDER PALMS REPLACEMENT FOR PROPOSED REMOVAL OF 4 PALMS
5	CALYPTRANTHES ZUYZGIUM	MYRTLE OF THE RIVER	6'-8" MIN. PH (2" DBH)	
9	EUGENIA FOETIDA	SPANISH STOPPER	6'-8" PH (2" DBH)	(2) SPANISH STOPPERS REPLACEMENT FOR REMOVED ARECA PALMS ALONG CATHERINE ST.
2	COCCOLOBA DIVERSIFOLIA	PIGEON PLUM	6'-8" PH (2" DBH)	
112	ERNODEA LITTORALIS	GOLDEN CREEPER	1 GAL	
N/A		BLACK EUCALYPTUS MULCH	3" DEPTH IN ALL PLANTED AREAS	
N/A		PLANTING SOIL	AS NEEDED	

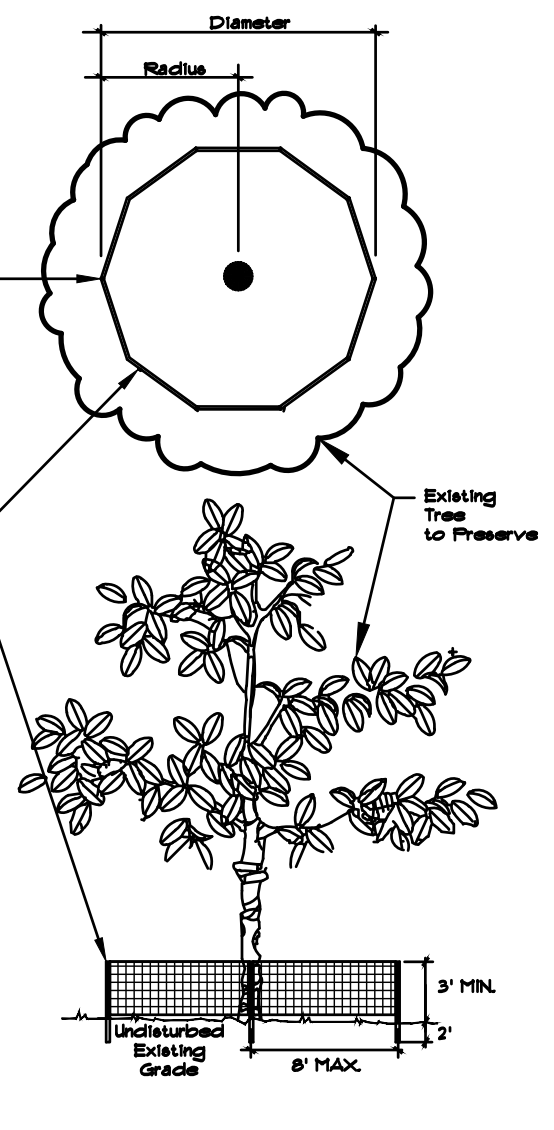

TREE PROTECTION BARRIER DETAIL
 NO SCALE

NOTE: PROVIDE TREE PROTECTION BARRICADE AROUND ALL EXISTING TREES AND PALMS SHOWN TO REMAIN ON SITE AND FOR ALL RELOCATED TREES OR PALMS FOR THE FULL DURATION OF CONSTRUCTION.

NO MATERIALS OR EQUIPMENT SHALL BE STORED, OPERATED, DUMPED, OR BURNED WITHIN THE PROTECTED AREA.

NO ATTACHMENT (WIRES, SIGNS, ETC.) SHALL BE ATTACHED TO A PROTECTED TREE.

PRIOR TO ANY LAND CLEARING OPERATIONS, TREE LIMBS WHICH INTERFERE WITH CONSTRUCTION SHALL BE REMOVED IN ACCORDANCE WITH NATIONAL ARBORISTS ASSOCIATION PRUNING STANDARDS.

ALL PROTECTED TREES SHALL BE PRUNED TO REMOVE DEAD OR DAMAGED LIMBS AND FERTILIZED AS NECESSARY TO COMPENSATE FOR ANY ROOT LOSS.

OBTAIN CITY APPROVAL OF TREE BARRICADES BEFORE BEGINNING CLEARING OPERATIONS OR ANY SITE DEVELOPMENT.

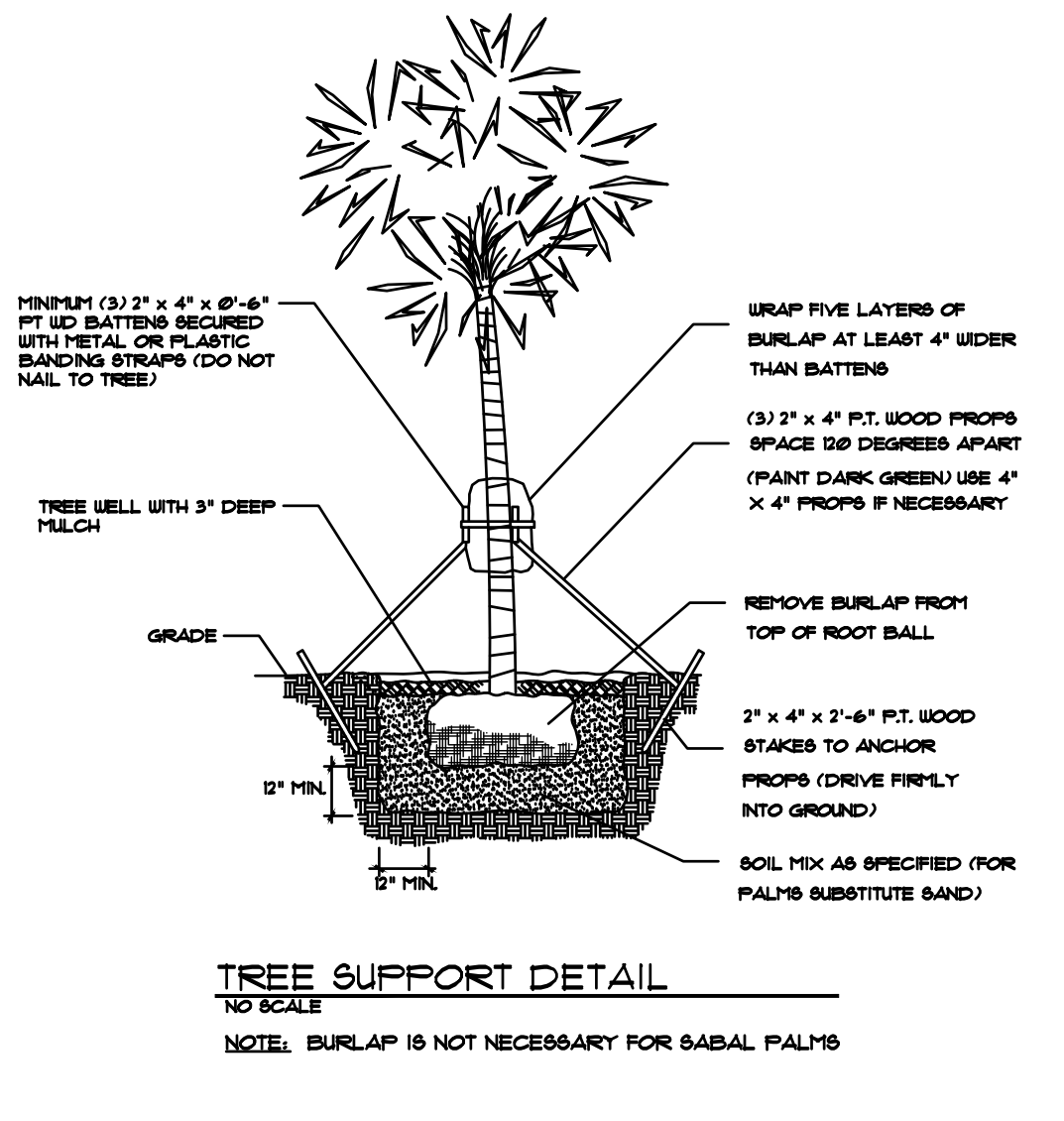

TREE SUPPORT DETAIL
 NO SCALE

NOTE: BURLAP IS NOT NECESSARY FOR SABAL PALMS

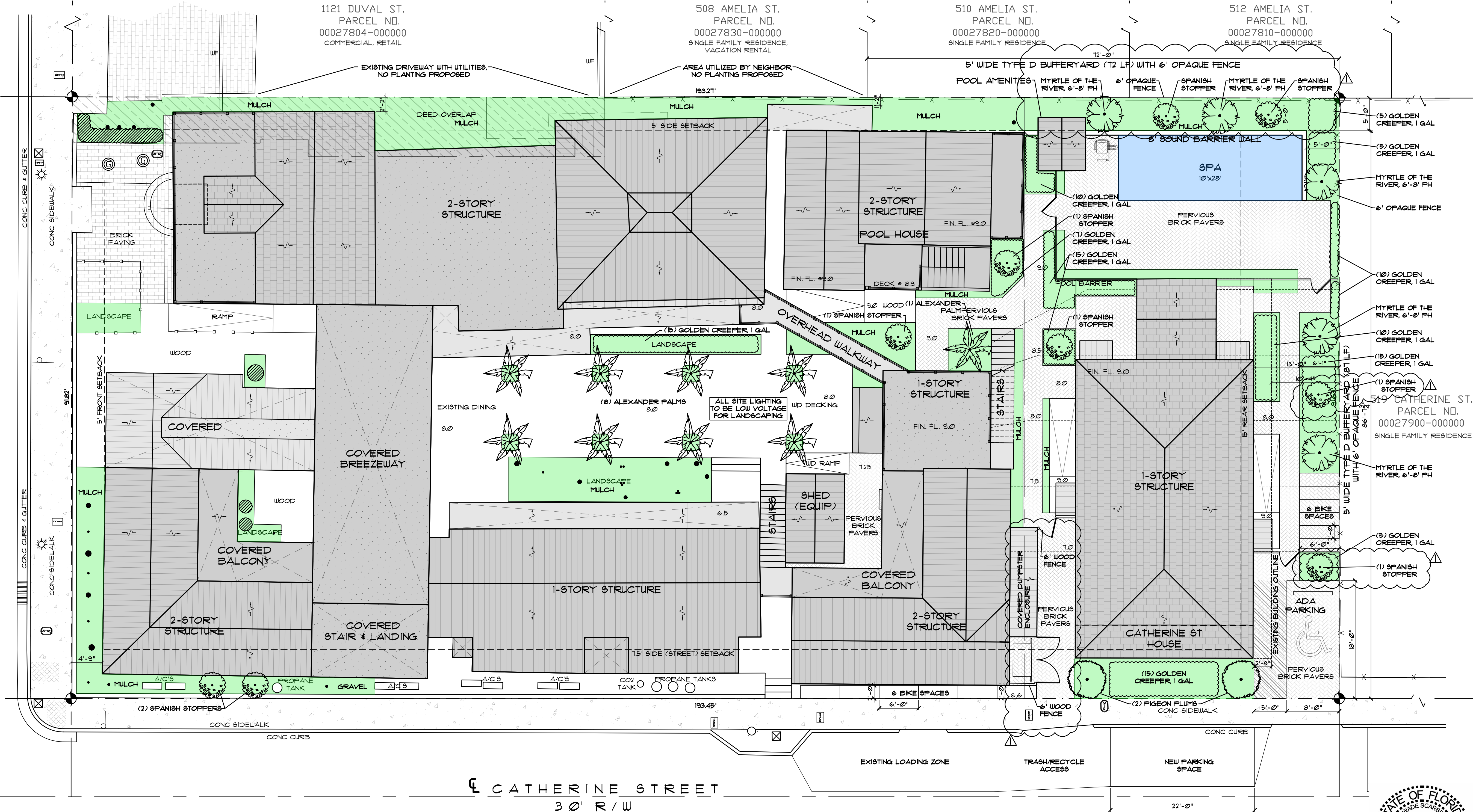

NARRATIVE OF REVISION I (DATED 4/25/24):
 BUFFERYARD CALCULATIONS AND PLANTING LIST CHART ADJUSTED FOR CLARITY.
 ALEXANDER PALMS SPECIFIED AND ADDED TO PLANTING LIST.
 SPANISH STOPPERS ADDED TO BUFFERYARDS AND PLANTING LIST.
 6' WOOD FENCE & DUMPSTER ENCLOSURE NOTE ADDED TO DUMPSTER AREA.

Proposed Landscape Plan

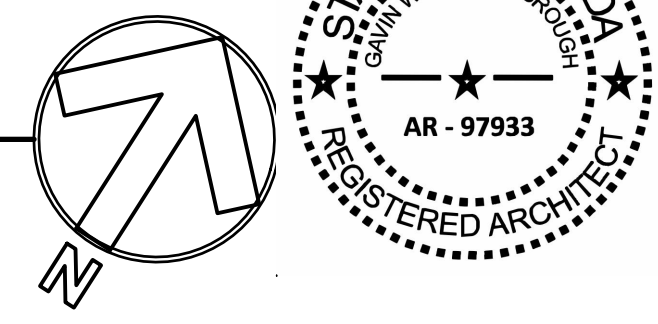

LaTeDa Resort
 1125 Duval & 515 Catherine Key West, FL

POPE-SCARBROUGH-ARCHITECTS
 THOMAS E. POPE, P.A.
 (305) 296 3611 610 White St, Key West FL

date: 04/01/24
 revision: 4/25/24

sheet:
 A0.4

PERMIT SET - 4.1.24