

HISTORIC SEAPORT HARBORWALK - AREA #3 (EXISTING)

SCALE: 1/8"=1'-0"

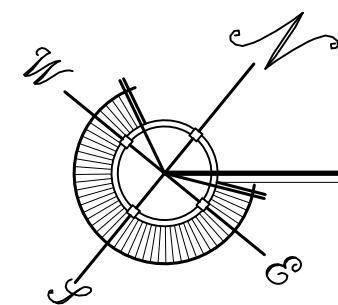
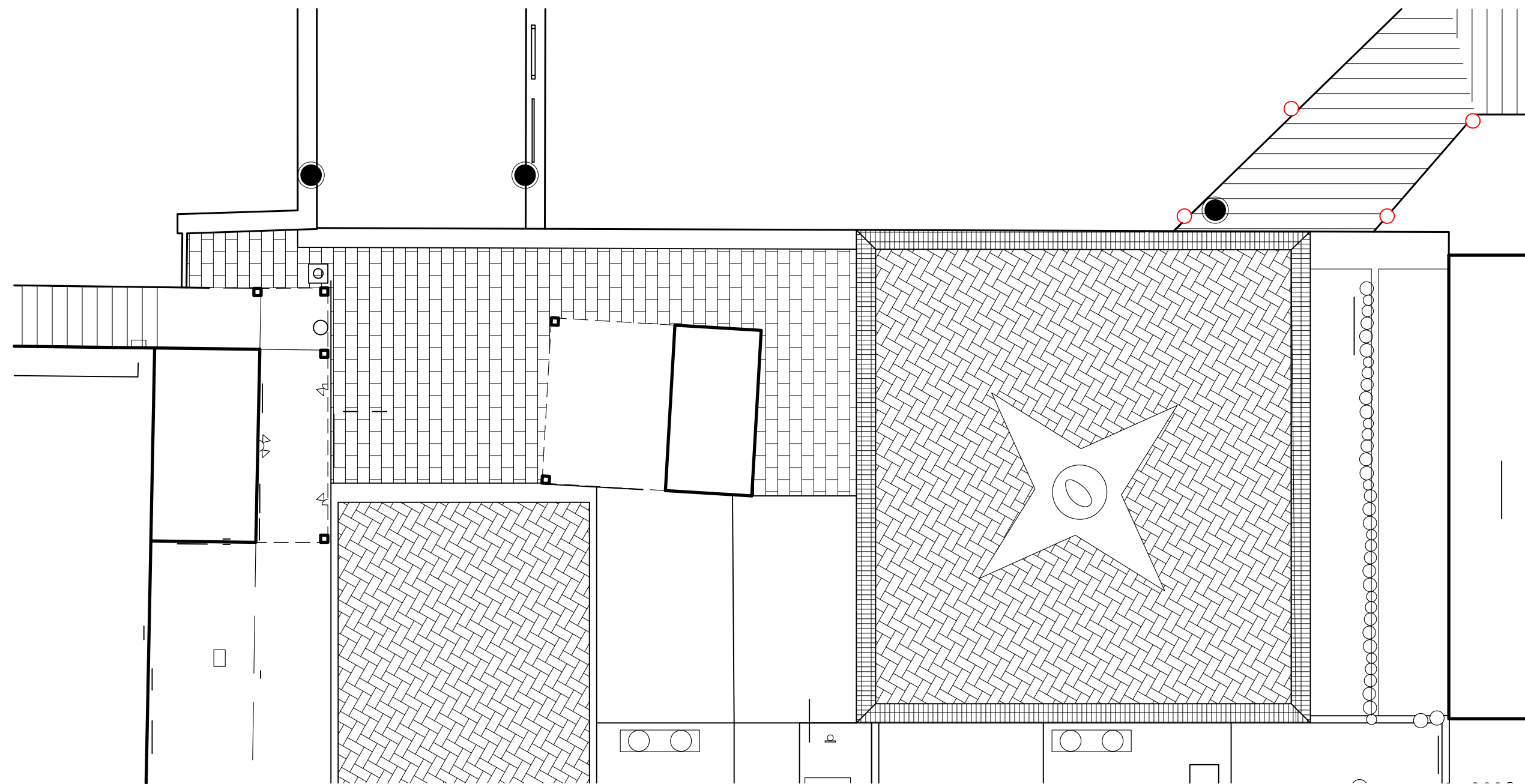

HISTORIC SEAPORT HARBORWALK - AREA #4 (EXISTING)

SCALE: 1/8"=1'-0"

WILLIAM P. HORN
ARCHITECT, P.A.

915 EATON ST.
KEY WEST,
FLORIDA
33040

TEL. (305) 296-8302
FAX (305) 296-1033

LICENSE NO.
AA 0003040

KEY WEST
BIGHT
HISTORIC
SEA PORT
PHASE I

KEY WEST BIGHT
KEY WEST, FL. 33040

SEAL

THESE DRAWINGS MAY
NOT BE REPRODUCED
WITHOUT WRITTEN
AUTHORIZATION BY
WILLIAM P. HORN

DATE

02-25-14
06-19-14 HARC

REVISIONS

DRAWN BY

OCE
FH
EMA

PROJECT
NUMBER

1226

