

STAFF REPORT

DATE: November 18, 2014

**RE: 2601 S. Roosevelt Blvd-Key West By the Sea
(permit application #7169)**

FROM: Karen DeMaria, Urban Forestry Manager,
City of Key West

An application was received for the removal of **(3) Bottlebrush trees**. A site inspection was done on October 29, 2014 and documented the following:



Tree Species: Bottlebrush Tree (Callistemon sp.)

Tree
#1







Tree #2
and #2



Tree #1

1. Diameter: 13.7"
Location: 80%
Species: 50% (not on protected or not protected tree list)
Condition: 20% (termites)
Total Average Value = 50%
Value x Diameter = **6.8 replacement caliper inches**



Tree #2





2. Diameter: 33.4" (double trunk)
Location: 80%
Species: 50% (not on protected or not protected tree list)
Condition: 20%
Total Average Value = 50%
Value x Diameter = **16.7 replacement caliper inches**

Tree
#3





3. Diameter: 18.4”
Location: 80%
Species: 50% (not on protected or not protected tree list)
Condition: 20%
Total Average Value = 50%
Value x Diameter = **9.2” replacement caliper inches**

Recommendations: Recommend approval of the removal of (3) Bottlebrush trees located at 2601 S. Roosevelt Blvd, to be replaced with 32.7 caliper inches of FL#1 native dicot or fruit trees.

Application



7169

Tree Permit Application

Date: Nov. 17th, 2014

Please Clearly Print All Information unless indicated otherwise.

Tree Address 24001 S. ROOSEVELT Blvd.
Cross/Corner Street _____
List Tree Name(s) and Quantity Bottlebrush tree (3)
Species Type(s) check all that apply () Palm () Flowering () Fruit () Shade ☒ Unsure
Reason(s) for Application:

☒ **REMOVE** () Tree Health ☒ Safety () Other/Explain below
() **TRANSPLANT** () New Location () Same Property () Other/Explain below
() **HEAVY MAINTENANCE** () Branch Removal () Crown Cleaning/Thinning () Crown Reduction

Other/Explain _____

Reason for Request Inspection by Keys Pest - Bottlebrush trees are infested with subterranean termites.

Property Owner Name Key West by the Sea
Property Owner eMail Address jessica@icamac.com
Property Owner Mailing Address 24001 S. ROOSEVELT Blvd.
Property Owner Mailing City Key West **State** FL **Zip** 33040
Property Owner Phone Number (305) 294-7401
Property Owner Signature Jessica Steinbach, Manager.

Representative Name Jessica Steinbach
Representative eMail Address Jessica@icamac.com
Representative Mailing Address 24001 S. ROOSEVELT Blvd.
Representative Mailing City Key West **State** FL **Zip** 33040
Representative Phone Number (305) 294-7401

NOTE: A Tree Representation Authorization form must accompany this application if someone other than the owner will be representing the owner at a Tree Commission meeting or picking up an issued Tree Permit.

Tree Representation Authorization form attached ()

<<<<< **Sketch location of tree in this area including cross/corner Street** >>>>>

Please identify tree(s) with colored tape

Trees are along the West side of C Bldg from C-105-C107.
Karen DeMaria has already been out to inspect the trees.

If this process requires blocking of a City right-of-way, a separate ROW Permit is required. Please contact 305-809-3740.



KEYS PEST CONTROL



P.O. BOX 2294 KEY WEST, FL. 33045

(305) 294-5048 OR 1-800-804-0534

To whom it may concern,

A termite inspection was performed at Key West By the Sea located at 2601 S. Roosevelt Boulevard, Key West, Florida 33040. Three bottle brush trees were found to be infested with Subterranean Termites. It is recommended that these trees be removed. They pose an imminent danger in falling causing injury to people or property.

Gilbert Font Jr.

Certified Pest Control Operator



Jessica Steinbach

Key West by the Sea
2601 South Roosevelt Blvd.
Key West, FL 33040

Office 305-294-7401
Cell 305-587-2705
Fax 305-293-0748
Jessica@icamco.com



2601 S. Roosevelt Blvd.
Key West, Fla. 33040
(305) 294-7401

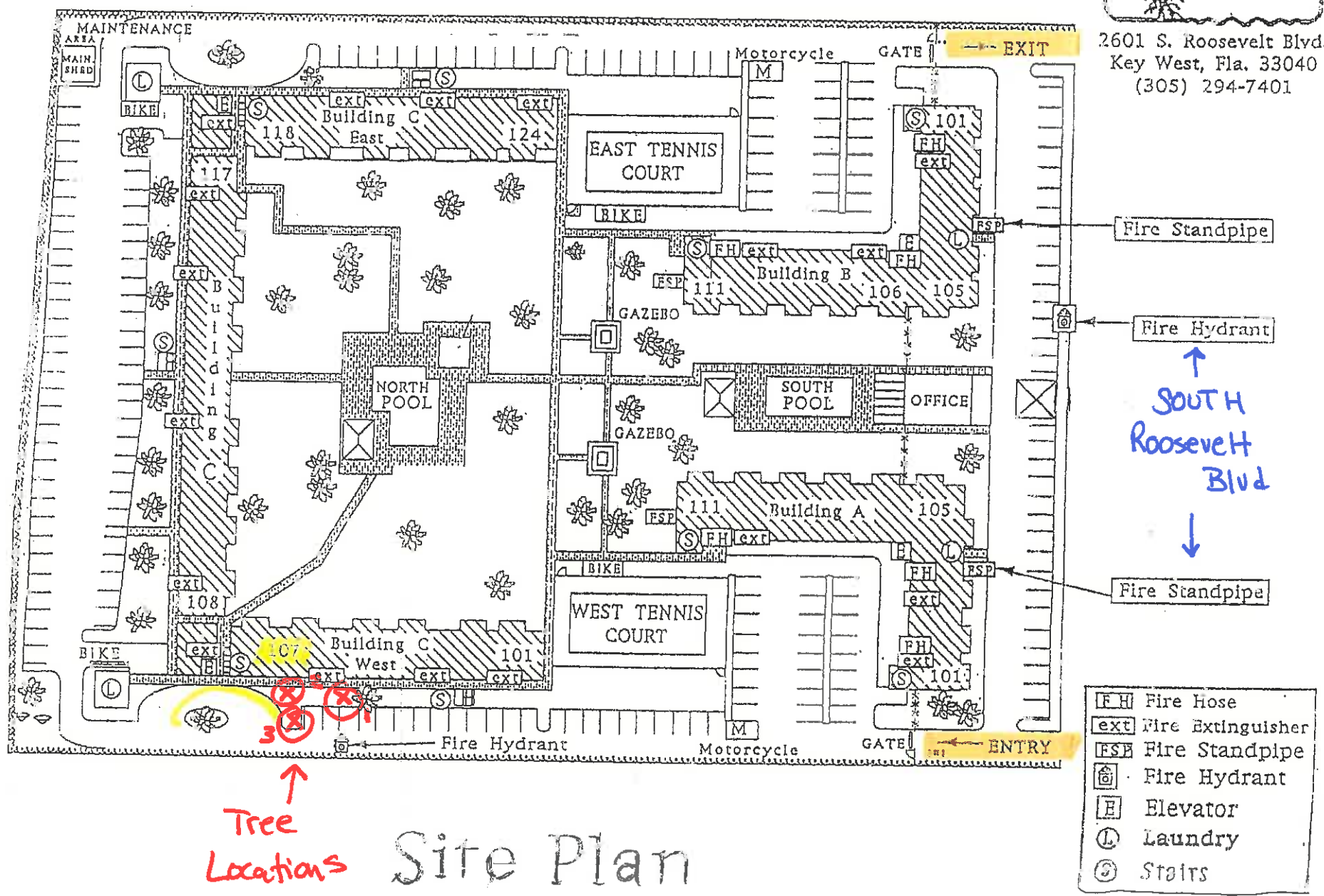

Site Plan

Karen DeMaria

From: Jessica Steinbach <Jessica@icamco.com>
Sent: Tuesday, November 18, 2014 9:04 AM
To: Karen DeMaria
Subject: Key West by the Sea

Good Morning Karen,

I dropped off the tree permit this morning in the box (under the turtle). The Board has decided to move forward with Tarzan to remove the tree's. I did note on the permit that you had already been out inspect and measure the trees. Can you tell me how many inches we need to replace so that I can get an order in with Mama's?

Please let me know if there is anything else I need to do.

Thank you,
Jessica Steinbach
Key West by the Sea
2601 S. Roosevelt Blvd.
Key West, FL 33040
305-294-7401 Ph.
305-293-0748 Fax