

# STAFF REPORT

DATE: April 29, 2015

**RE: 525 Francis Street (permit application #7391)**

FROM: Karen DeMaria, Urban Forestry Manager,  
City of Key West

An application was received for the removal of **(1) Golden Senna tree**. A site inspection was done on April 24, 2015 and documented the following:

Tree Species: Golden Senna (*Senna surrattensis*)











Diameter: 4.7"

Location: 60% (canopy in utility lines)

Species: 50% (not on protected or not protected tree list)

Condition: 60% (fair)

Total Average Value = 56%

**Value x Diameter = 2.6 replacement caliper inches**

**Recommendations: Recommend approval of the removal of (1) Golden Senna tree located at 525 Frances Street, to be replaced with 2.6 caliper inches of FL#1 trees from approved list.**

# Application



7391

## Tree Permit Application

Date: 4-22-2015

Please Clearly Print All Information unless indicated otherwise.

Tree Address 525 Francis St  
Cross/Corner Street Stump Lane  
List Tree Name(s) and Quantity 1 Cesa 1- boldenSenna **RD**  
Species Type(s) check all that apply ☐ Palm ☒ Flowering ☐ Fruit ☐ Shade ☐ Unsure  
Reason(s) for Application:

☐ REMOVE ☐ Tree Health ☐ Safety ☒ Other/Explain below  
☐ TRANSPLANT ☐ New Location ☐ Same Property ☐ Other/Explain below  
☐ HEAVY MAINTENANCE ☐ Branch Removal ☐ Crown Cleaning/Thinning ☐ Crown Reduction  
Other/Explain owners would rather have a Pigeon Plum tree.

### Reason for Request

Property Owner Name Mary and Karl Haffenlaffer  
Property Owner eMail Address \_\_\_\_\_  
Property Owner Mailing Address 525 Francis St  
Property Owner Mailing City Key West State FL Zip 33040  
Property Owner Phone Number (305) 292-2525  
Property Owner Signature \_\_\_\_\_

Representative Name Kenneth King  
Representative eMail Address \_\_\_\_\_  
Representative Mailing Address 1602 Laird St  
Representative Mailing City Key West State FL Zip 33040  
Representative Phone Number (305) 296-8101

NOTE: A Tree Representation Authorization form must accompany this application if someone other than the owner will be representing the owner at a Tree Commission meeting or picking up an issued Tree Permit.

Tree Representation Authorization form attached ☐

&lt;&lt;&lt;&lt;&lt; Sketch location of tree in this area including cross/corner Street &gt;&gt;&gt;&gt;&gt;

Please identify tree(s) with colored tape

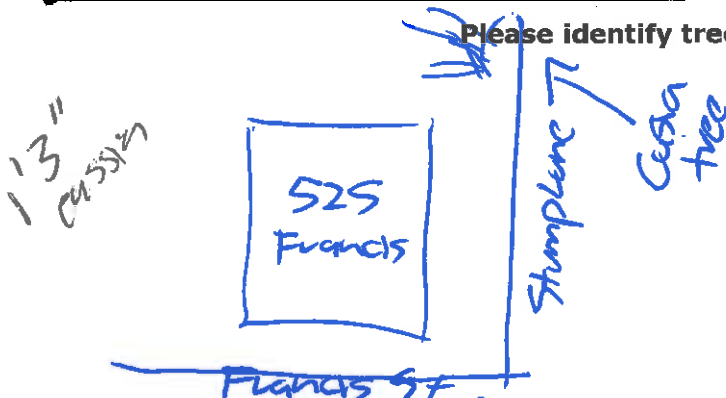

If this process requires blocking of a City right-of-way, a separate ROW Permit is required. Please contact 305-809-3740.



## Tree Representation Authorization

Date: 22 APR 15

Attendance at the Tree Commission meeting on the date when your request will be discussed is necessary in order to expedite the resolution of your application. This Tree Representation Authorization form must accompany the application if the property owner is unable to attend or will have someone else pick up the Tree Permit once issued.

Please Clearly Print All Information unless indicated otherwise.

Tree Address 525 FRANCES ST

Property Owner Name KARL + MARY L. HAFFNER  
 Property Owner eMail Address khaffner@gmail.com  
 Property Owner Mailing Address 525 FRANCES ST 33040  
 Property Owner Mailing City KW State FL Zip 33040  
 Property Owner Phone Number (305) 292-2525  
 Property Owner Signature [Signature]

Representative Name Kenneth King  
 Representative eMail Address \_\_\_\_\_  
 Representative Mailing Address 1602 Laird  
 Representative Mailing City Key West State FL Zip 33040  
 Representative Phone Number (305) 296-8101

I KARL HAFFNER, hereby authorize the above listed agent(s) to represent me in the matter of obtaining a Tree Permit from the City of Key West for my property at the tree address above listed. You may contact me at the telephone listed above is there is any questions or need access to my property.

Property Owner Signature

[Signature]

The forgoing instrument was acknowledged before me on this 23<sup>rd</sup> day April, 2015.

By (Print name of Affiant) KARL HAFFNER who is personally known to me or has produced Florida driver's license as identification and who did take an oath.

NOTARY PUBLIC

Sign Name: [Signature]

Print Name: Nicole Rouse - Culver

My Commission Expires: July 17, 2018

Notary Public - State of Florida (seal)

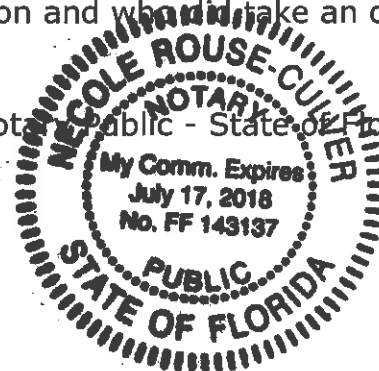



## *Senna surattensis*

Golden Senna, Bush Senna, Glauous Cassia,  
Scrambled Egg Tree

**Fabaceae**

Flower Display: A+



North Fort Myers, Florida

Late November

Under most circumstances *Senna surattensis* is a dependable and impressive small flowering tree. It is commonly planted as a street and landscape tree in south Florida and the Bahamas. The flowering days of *S. surattensis* are prolonged and beautiful. As a species, it is capable of flowering from January through December. Many trees have their best show in the spring and summer while others are at their showiest from fall into spring. Late summer and mid winter are usually the two periods of minimum or no flower displays, and mid winter is when many trees can become quite unkempt. What's quite noticeable is that most trees, growing in close proximity to each other, either put on an exceptional show or nary a flower. This suggests that flowering is stimulated by local maintenance regimes more so than by changing weather. Newly planted trees must be kept well watered to become established and apparently to flower adequately. After establishment reduce irrigation. In alternate years, prune once after a major flowering episode to keep a tight attractive canopy. You may want to prune more often since heavy flowering can leave some trees disheveled, with scant leaves and dry, hanging, blackened pods. The trunk and branches are a silver-gray color. The crown is naturally rounded and airy, but pruning and wind damage will thicken and shorten the canopy of many

Continues on next page



Fort Myers, Florida

Mid March



Fort Myers, Florida

Mid November  
Caterpillar soon to become a Cloudless Sulphur butterfly



Fort Myers, Florida

Late November



Naples, Florida

Early October



Fort Myers, Florida

Late November

**Leaves:** Even-pinnate, alternate, dark green, to about 7 inches long usually having 6-9 opposite pairs of obovate to oblong leaflets

**Flowers:** Yellow with 10 stamens to 1-1 ½ inches wide in semi-erect panicles

**Fruits:** Pods, flat, papery to about 7 inches long

Continued from previous page

trees. Easily toppled by wind, *S. surattensis* should probably be staked for up to three years after planting or until it becomes properly established. It is generally not a long-lived tree, and will usually not survive for more than 6 years under normal streetscape conditions. However, properly tended, it can live for more than 10 years. This means keeping it properly standing and maintaining it free of scales and the pink hibiscus mealybug. Typical of this genus, *S. surattensis* attracts egg-laying cloudless sulfur butterflies. The caterpillars feed on the leaves and flowers of the tree. However, caterpillar feeding does little to detract from the beauty of its magnificent displays. Maintain a fertilizer schedule for best appearance.





North Fort Myers, Florida  
Hurricane toppled *Senna Surattensis*

Mid August



Fort Myers, Florida Mid December  
Scale insects can cause stem die-back

Tropical Flowering Trees List  
Questions/Comments:  
Email: [brownsh@leegov.com](mailto:brownsh@leegov.com)

### Golden Senna

**Syn:** *Cassia glauca*, *Cassia surattensis*  
**Origin:** India, Southeast Asia, Tropical Australia

**Zone:** 9b-12b, 20°F

**Growth Rate:** Fast

**Flowering Months:** January through December

**Flowering Days:**

**Leaf Persistence:** Evergreen to Semi-Deciduous

**Messiness:** Moderate

**Salt Tolerance:** Low

**Drought Tolerance:** Medium

**Nutritional Requirements:** Medium

**Potential Pests:** Caterpillars, Hibiscus Mealybugs, Scales

**Typical Dimensions:** 14'x11'

**Uses:** Butterfly Garden, Container, Garden, Park, Parking Lot, Poolside, Streetscape

The Institute of Food and Agricultural Sciences (IFAS) is an Equal Opportunity Institution authorized to provide research, educational information and other services only to individuals and institutions that function with non-discrimination with respect to race, religion, age, disability, sex, sexual orientation, marital status, national origin, political opinions or affiliations. U.S. Department of Agriculture, Cooperative Extension Service, University of Florida, IFAS, Florida A. & M.