

Smith

E-72

Latitude: 24.550215 Longitude: -81.804453

EXISTING TREE TABLE							
NUMBER	COMMON NAME	BOTANICAL NAME	DBH	RATING	REPLACEMENT	STATUS	PERMIT REQUIRED
1	UNKNOWN	CAESALPINNA SPECIES	3" & 4"	2	7.4"	R	Y
2	WILD TAMARIND	LYSILOMA LATISILIQUUM	11"	3	0	S	Y
3	WILD CINNAMON	CANELLA WINTERANA	11"	3	0	S	Y
4	GUMBO LIMBO	BURSERA SIMARUBA	20"	3	0	S	Y
4A	BRAZILIAN PEPPER	SCHINUS TEREBINTHIFOLIUS		3	0	R	N
5	THATCH PALM	THRINAX RADIATA		3	0	S	Y
6	BLACK OLIVE	BUCIDA BUCERAS	3" & 4"	3	0	S	N
7	SIMPSON STOPPER	MYRCIANTHES FRAGRANS	3"	2	0	S	Y
8	SPANISH STOPPER	EUGENIA FOETIDA	4"	2	0	S	Y
9	CABBAGE PALM PUP	SABAL PALMETTO		3	0	S	Y
9A	POTATO TREE	SOLANUM ERIANTHUM	3"	1	0	R	N
10	THATCH PALM	THRINAX RADIATA		3	0	S	Y
11	GUMBO LIMBO	BURSERA SIMARUBA	10"	3	0	S	Y
12	THATCH PALM	THRINAX RADIATA		3	0	S	Y
13	THATCH PALM	THRINAX RADIATA		3	0	S	Y
14	ROYAL POINCIANA	DELONIX REGIA	16"	3	0	S	Y
15	THATCH PALM	THRINAX RADIATA		3	0	S	Y
16	ROYAL POINCIANA	DELONIX REGIA	13"	3	0	S	Y
17	GUMBO LIMBO	BURSERA SIMARUBA	15"	3	0	S	Y
18	THATCH PALM	THRINAX RADIATA		3	0	S	Y
18A	BRAZILIAN PEPPER	SCHINUS TEREBINTHIFOLIUS		3	0	R	N
19	PONGAMIA PINNATA	PONGAM	17"	3	0	S	N
20	CABBAGE PALM PUP	SABAL PALMETTO		3	0	R	N
21	BLACK OLIVE	BUCIDA BUCERAS		3	0	R	N
22	BLACK OLIVE	BUCIDA BUCERAS	8"	3	0	R	N
23	BLACK OLIVE	BUCIDA BUCERAS	7"	3	0	R	N
24	MAHOGANY	SHIETENIA MAHAGONI	1"	3	.6"	R	Y
25	BLACK OLIVE	BUCIDA BUCERAS	6"	3	0	R	N
25A	BLACK OLIVE CLUMP	BUCIDA BUCERAS		3	0	R	N
26	UNKNOWN CLUMP	UNKNOWN		3	0	R	N
27	FIREBUSH	HAMELIA NODOSA	3"	3	0	R	N
28	HIBISCUS	HIBISCUS ROSA-SINENSIS		3	0	R	N
28A	FICUS	FICUS SPECIES		3	0	R	N
TOTAL DEFICIT INCHES					8"		

- CONDITION CHART
- 1 POOR
 - 2 FAIR
 - 3 GOOD
 - 4 EXCELLENT

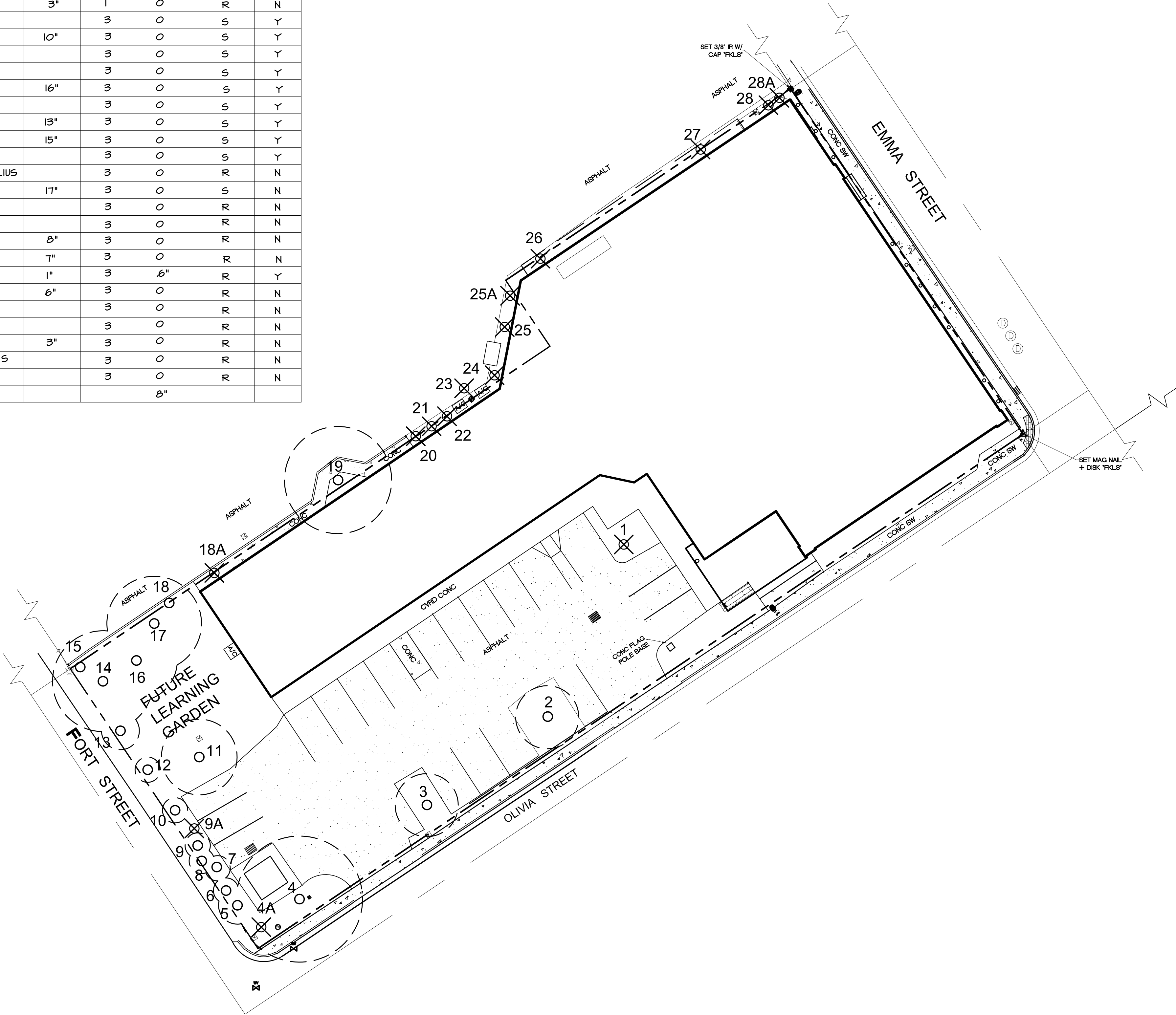
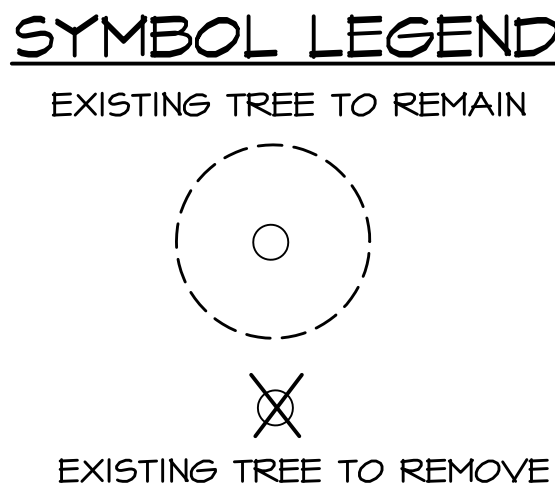

hayes | cumming
architects

2210 central ave, suite 100
st. petersburg, fl 33712
ph 727.321.0900
fx 727.321.0903
AA26001260
hc-arc.com

andrew m. hayes, aia, leed bd+c
© Copyright - All Rights Reserved

members of

American
Institute of
Architects

CONSULTANT:

CLIENT / PROJECT NAME:

CITY OF KEY WEST

ALTERATIONS TO

FREDERICK DOUGLASS
RECREATION CENTER

111 OLIVIA STREET
KEY WEST, FL 33040

Original drawing is 24"x36". Scale accordingly if reduced.

SHEET TITLE:

TREE REMOVAL PLAN

REVISIONS:

DATE ISSUED: 07/31/2015
PROJECT NO.: 12.0D01

DRAWING NUMBER:

L-001

SHEET: 1 OF 2

12/17/2014 11:00:22 AM



TREE REMOVAL PLAN

SYMBOL	QUANTITY	BOTANICAL NAME	COMMON NAME	SPECIFICATIONS	SPACING
CR	3	CLUSIA ROSEA	PITCH APPLE	12' HT X 5' SPD, 3" CALIPER	AS SHOWN
PS	1	PLUMERIA SPECIES	PLUMERIA	7' HT X 4' SPD, 1" CALIPER	AS SHOWN
AE	4	ARDISIA ESCALLONIOIDES	MARLBERRY	7' HT X 4' SPD, 1" CALIPER	AS SHOWN
ZF	28	ZAMIA FLORIDANA	COONTIE	18" HT X 18" SPD, 3 GALLON	36" OC
CH	40	CHRYSOBALANUS ICAGO	COCOPLUM	24" HT X 24" SPD, 3 GALLON	36" OC
HP	20	HAMELIA PATENS "COMPACTA"	DWARF FIREBUSH	24" HT X 24" SPD, 3 GALLON	36" OC
HL	28	HYMENOCALLIS LATIFOLIA	SPIDER LILY	12" HT X 12" SPD, 3 GALLON	AS SHOWN
PN	86	PSYCHOTRIA NERVOSA "LITTLE PSYCHO"	DWARF WILD COFFEE	18" HT X 18" SPD, 3 GALLON	36" OC
EL	135	ERNODEA LITTERALIS	GOLDEN CREEPER	8" HT X 8" SPD, 1 GALLON	24" OC
CI	65	CROSSOPETALUM ILICIFOLIUM	QUAIL BERRY	8" HT X 8" SPD, 1 GALLON	24" OC
GP	48	GAILLARDIA PULCHELLA	BLANKET FLOWER	8" HT X 8" SPD, 1 GALLON	24" OC
LM	5	LANTANA MONTEVIDENSIS	LAVENDER WEeping LANTANA	4" HT X 12" SPD, 1 GALLON	AS SHOWN

LANDSCAPE INSTALLATION NOTES

- 1) ALL PLANT MATERIALS SHALL BE FLORIDA #1 OR BETTER AS GIVEN IN GRADES AND STANDARDS FOR NURSERY PLANTS, LATEST EDITION, PUBLISHED BY THE FLORIDA DEPARTMENT OF AGRICULTURE AND CONSUMER SERVICES.
- 2) LOCATION OF PLANTS ON THE PLAN ARE DIAGRAMMATIC- SEE THE LANDSCAPE ARCHITECT FOR QUESTIONS ON EXACT LOCATIONS. THE PLANT MATERIALS LIST IS PROVIDED FOR THE CONVENIENCE OF THE LANDSCAPE CONTRACTOR. SHOULD THERE BE ANY DISCREPANCY BETWEEN THE PLANT LIST AND THE PLAN, THE PLAN SHALL PREVAIL.
- 3) IT IS THE LANDSCAPE CONTRACTORS RESPONSIBILITY TO ENSURE THAT ALL PLANT BED AREAS HAVE PROPER DRAINAGE FOR OPTIMUM GROWTH OF LANDSCAPE MATERIAL BEFORE INSTALLATION BEGINS.
- 4) THE CONTRACTOR SHALL ENSURE THAT ALL PLANTING ISLANDS AND OTHER AREAS SHALL BE CLEAN OF TRASH, CONSTRUCTION DEBRIS, OR OTHER WASTE MATERIALS TO A DEPTH OF 24" PRIOR TO LANDSCAPE INSTALLATION.
- 5) ALL PLANT BEDS AND TREE RINGS SHALL BE TREATED WITH A PRE-EMERGENT HERBICIDE AND THEN TOP-DRESSED WITH 3" DEEP PINE BARK NUGGETS. ALL NEW TREES SHALL HAVE A TREE RING WITH A MINIMUM OF 24" RADIUS. ALL NEW TREES AND PALMS SHALL BE STAKED. ALL EXISTING TREES TO REMAIN SHALL HAVE A 6" RADIUS MULCH RING AT A DEPTH OF 3".
- 6) NEW SOD SHALL BE ± 600 SQ. FT. OF ARGENTINE BAHIA SOD AS SHOWN ON THE PLAN. CONTRACTOR SHALL DETERMINE EXACT QUANTITIES IN THE FIELD. SOD AREAS SHALL BE MAINTAINED BY THE CONTRACTOR FROM THE TIME OF INSTALLATION TO THE TIME OF FINAL ACCEPTANCE.
- 7) TREES SHRUBS, AND GROUND COVER SHALL BE INSTALLED USING THE FOLLOWING PROCEDURE: PLANT PITS SHALL BE EXCAVATED TO TWICE THE DIAMETER OF THE PLANT ROOT BALL. AERATE EXISTING SOIL BEFORE BACKFILLING PIT.
- 8) TREE INSTALLATION: ALL REQUIRED TREES SHALL BE INSTALLED 1" - 2" ABOVE FINISH GRADE. TREES INSTALLED OR BURIED TOO DEEP SHALL BE RESET TO THIS STANDARD. REMOVE THE TOP 1/3 OF THE WIRE BASKETS ON ALL B & B STOCK.

ESTABLISHMENT PERIOD WATERING SCHEDULE

DURING LANDSCAPE INSTALLATION THE CONTRACTOR SHALL WATER-IN INSTALLED LANDSCAPE MATERIALS AND CONTINUE WATERING UNTIL SUBSTANTIAL COMPLETION. AT SUBSTANTIAL COMPLETION THE CONTRACTOR SHALL BEGIN THE FOLLOWING 90 DAY WATERING SCHEDULE. THE LANDSCAPE CONTRACTOR SHALL WATER ALL PLANT MATERIALS SHOWN ON THE LANDSCAPE PLANTING PLANS, FOR A THIRTEEN WEEK, NINETY DAY WATERING PERIOD BASED ON THE FOLLOWING PLANT ESTABLISHMENT PERIOD SCHEDULE.

15 GALLON CONTAINER PLANTS:	15 GALLONS WATER/EACH APPLICATION
7 GALLON CONTAINER PLANTS:	10 GALLONS WATER/EACH APPLICATION
3 GALLON CONTAINER PLANTS:	5 GALLONS WATER/EACH APPLICATION
1 GALLON CONTAINER PLANTS:	3 GALLONS WATER/EACH APPLICATION

1ST 4 WEEKS @ 3 APPLICATIONS PER WEEK =	12 EVENTS
2ND 4 WEEKS @ 2 APPLICATIONS PER WEEK =	8 EVENTS
3RD 5 WEEKS @ 1 APPLICATION PER WEEK =	5 EVENTS

TOTAL NUMBER OF APPLICATIONS = 25 EVENTS

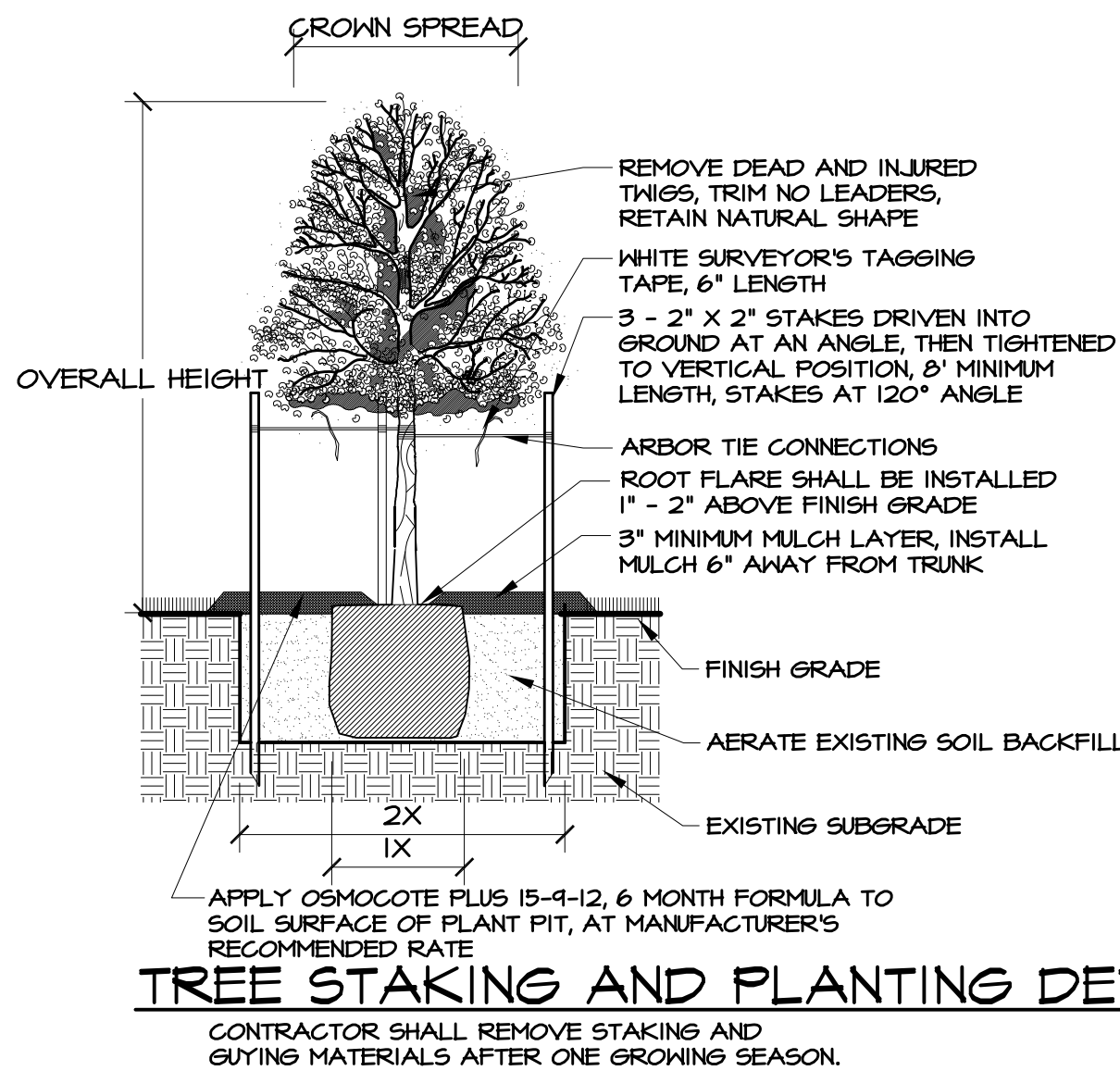

TREE STAKING AND PLANTING DETAIL

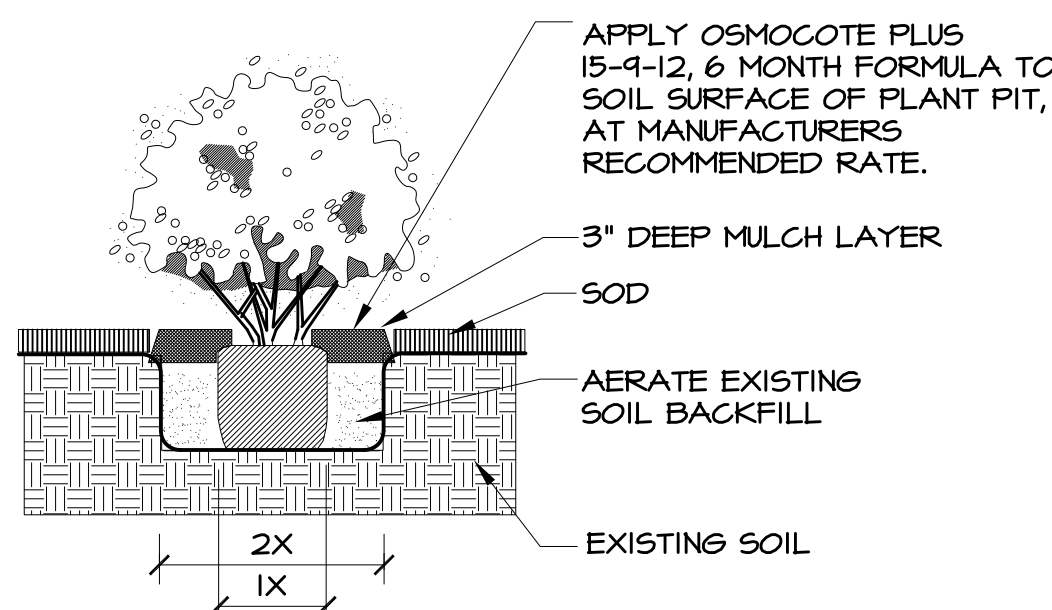

SHRUB PLANTING DETAIL

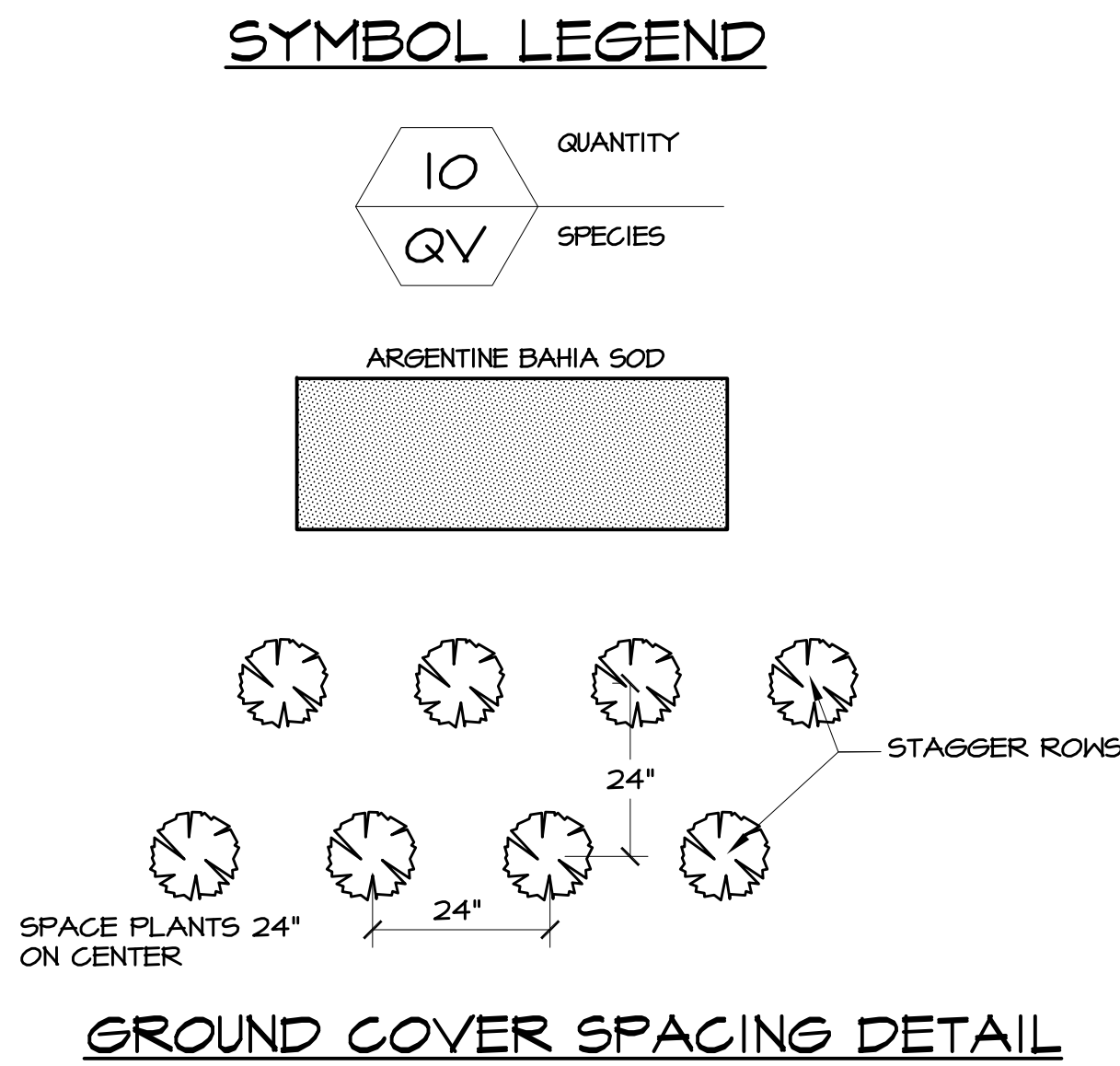

SYMBOL LEGEND

10	QUANTITY
QV	SPECIES

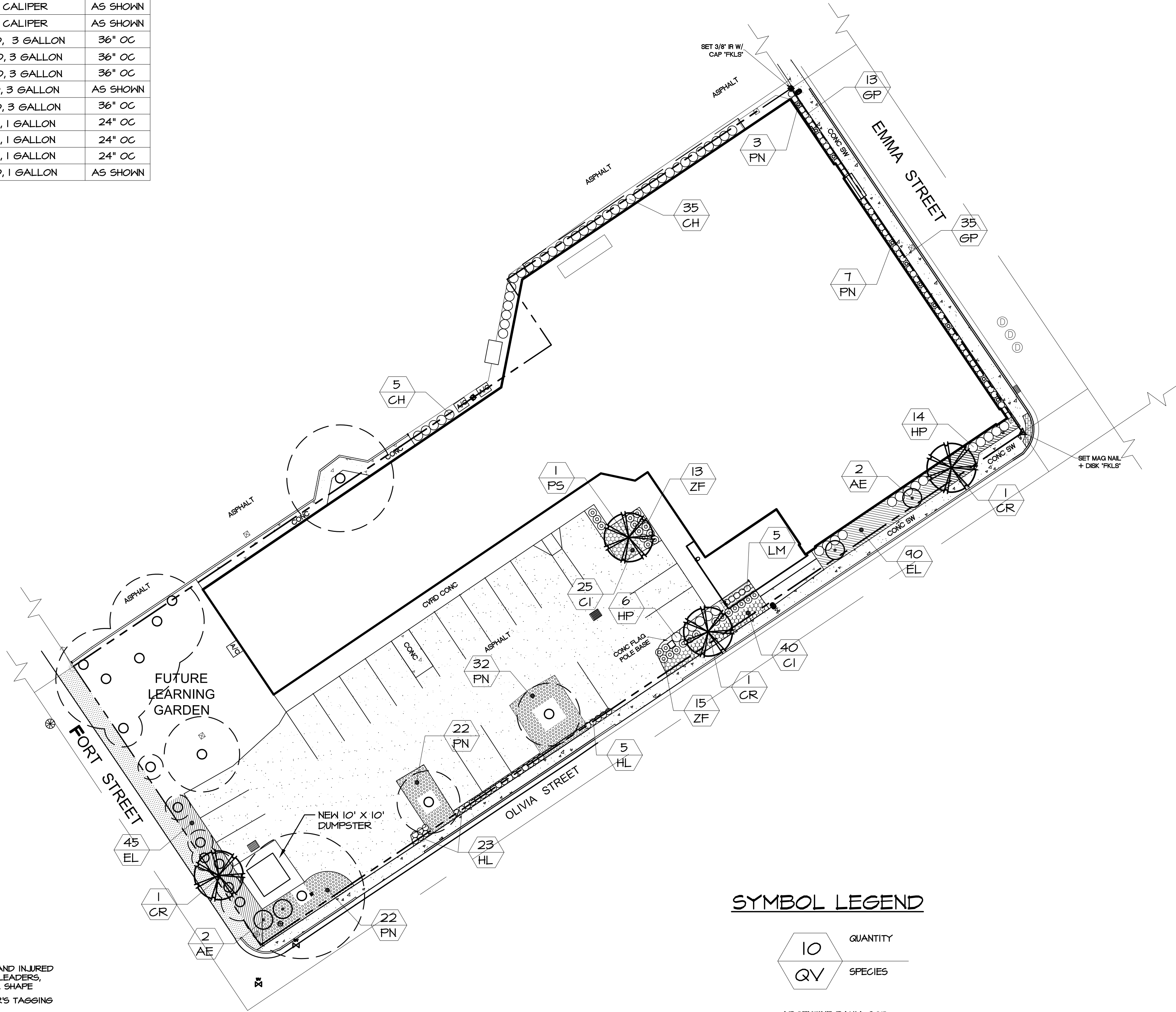
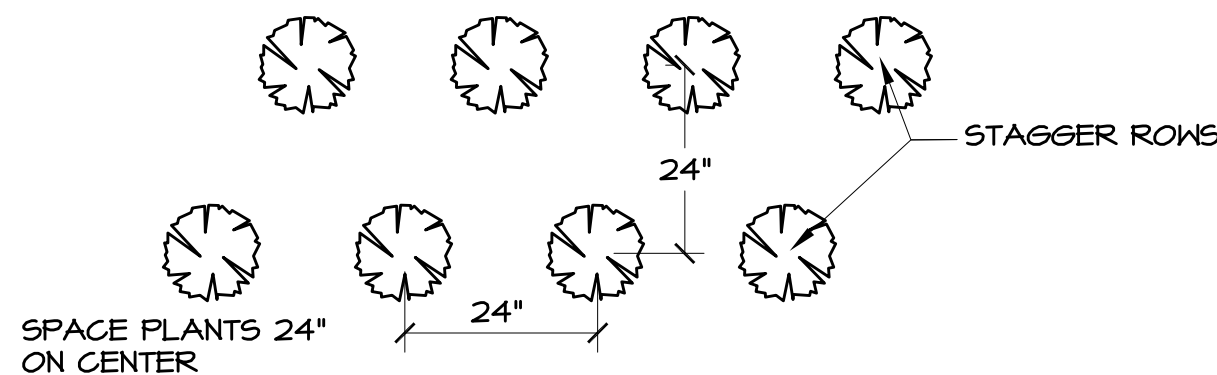
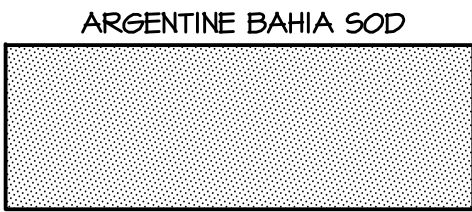

hayes | cumming

architects

2210 central ave, suite 100
st. petersburg, fl 33712
ph 727.321.0900
fx 727.321.0903

AA26001260
hc-arc.com

andrew m. hayes, aia, leed bd+c
© Copyright - All Rights Reserved

members of

American
Institute of
Architects

CONSULTANT:

CLIENT / PROJECT NAME:

CITY OF KEY WEST

ALTERATIONS TO

FREDERICK DOUGLASS
RECREATION CENTER

111 OLIVIA STREET
KEY WEST, FL 33040

Original drawing is 24"x36". Scale accordingly if reduced.

SHEET TITLE:

LANDSCAPE PLAN

REVISIONS:

DATE ISSUED: 07/31/2015
PROJECT NO.: 12.0001

DRAWING NUMBER:

L-002

SHEET: 2 OF 2

12/17/2014 11:00:22 AM



LANDSCAPE PLAN



Monroe County
Health Dept

This is an aerial photograph of a large, light-colored building complex. The building has a flat roof and is surrounded by a parking lot with several cars. A red rectangular box is drawn on the left side of the image, highlighting a specific area. The text 'Monroe County Health Dept' is written in a stylized font across the top of the building. Below it, the text 'Key West Fredrick Douglass Gym' is written. At the bottom right, the text 'Olivia St' is visible. There are also some small icons, possibly representing trees or other features, scattered around the building.

Key West Fredrick
Douglass Gym

Olivia St

Building: 43'

Side
walk

WATER

Vines: passionflowers
50'

Black-bead

Lignum vitae

Strong-bark

Torch-wood

Cinnamon Bark

50'

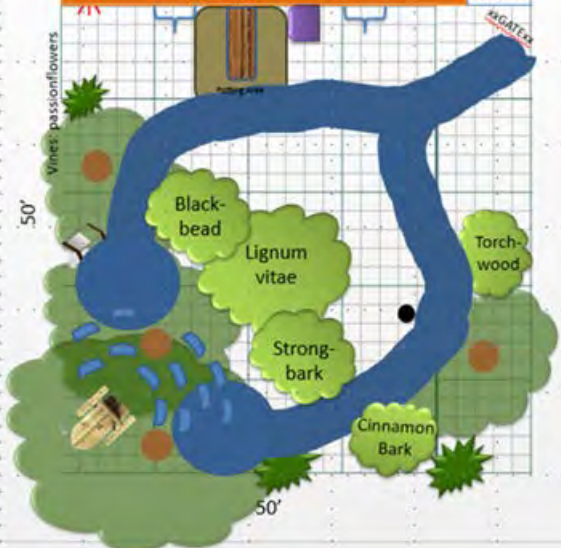

Learning Garden Tree Planting April 2015





STAFF REPORT

DATE: August 3, 2015

RE: 111 Olivia Street (Fredrick Douglas Gym)
(permit application #7512)

FROM: Karen DeMaria, Urban Forestry Manager,
City of Key West

An application was received for Final Landscape Plan Approval with Tree Removal. A site inspection was done initially on November 20, 2014 and January 28, 2015.

Due to issues with the existing building, the City is rebuilding/redeveloping a portion of the property. The primary construction area is along the corner of Emma and Olivia Streets. In this area, regulated vegetation to be removed includes 1-Caesalpinna tree at the front entrance to the building on Olivia Street and 1-young mahogany tree in the back of the building. There is no vegetation along Emma Street and the rest of the vegetation being removed from the back of the building is not regulated. At the present time, all other regulated trees on the property are to remain in place.

1. Comments regarding the Final Landscape plan: Plan meets compliance with City code requiring 70% native vegetation be used.

Along Emma Street, due to the very small area between the sidewalk and building, the decision was made to plant low vegetation. Along the rear of the property, only hardy shrubs are being planted due to the limited space and the overhang on part of the building. This area is also a high traffic area being part of the parking lot/roadway for the adjacent housing authority property.

It was requested that a flowering tree be planted at the entrance to the building. The tree that is being removed from that location was a flowering tree. The plans propose planting a Plumeria. It is recommended that the size of the tree be increased from 1" caliper to 3" caliper.

The area at the corner of Fort Street and Olivia Street is being improved with vegetation being added to the existing trees to help buffer the proposed dumpster location.

2. Trees being removed that are regulated:

A. Tree Species: *Caesalpinna* sp.



Diameter: 14" (multi trunked)
Location: 70%
Species: 50% (not on protected or not protected tree list)
Condition: 40% (fair to poor)
Total Average Value = 53%
Value x Diameter = **7.4 replacement caliper inches**

B. Tree Species: Mahogany (Swietenia mahagoni)



Diameter: 1"
Location: 30% (will be major foundation issues-wrong tree, wrong place)
Species: 100% (on protected tree list)
Condition: 70% (young)
Total Average Value = 66 %
Value x Diameter = **.6 replacement caliper inches**

Recommendations: Recommend approval of the Final Landscape Plan with removal of 1-Caesalpinna sp. and 1-Mahogany tree to be replaced with a total of 8 caliper inches within the landscape plan.

[illegible]

MEMORANDUM

DATE: November 20, 2014

RE: 111 Olivia St (Frederick Douglas Gym Property)

FROM: Karen DeMaria, Urban Forestry Manager, City of Key West

NOTES FOR THE EXISTING VEGETATION MAP

Tree #: Description

1. 2-Yellow Flowering, Non-native trees
(2.8" and 14" diameters, possibly *Caesalpinna cacalaco*?)





Base of Tree
#1 (A & B)

2. Wild Tamarind (10.8" diameter)



3. Wild Cinnamon Tree (10.8" diameter)



4. Gumbo Limbo (20.4" diameter)



5. Thatch Palm



6. 2 Black Olive Trees (3.8" and 3.2" diameters)



7. Simpson Stopper (3" diameter)



8. Spanish Stopper (3.5" diameter) and 9. Sabal Palm



Simpson
Stopper

Spanish stopper

9A: Potato Tree (3" diameter)



10. Thatch Palm



11. Gumbo Limbo (10.2" diameter)



12. Thatch Palm



13. Thatch Palm



14. Royal Poinciana (15.9" diameter)



#14

#13

15. Thatch Palm



16. Royal Poinciana (13.4" diameter)



17. Gumbo Limbo (15.3" diameter)



#16

18. Thatch Palm



#17

#18

19. Unknown, non-native flowering tree (16.9" diameter)



20. Sabal Palm



21. Resprouting, Black Olive stump (<24" diameter)



23. Black Olive (7" diameter)

22. Black Olive (8.3" diameter)

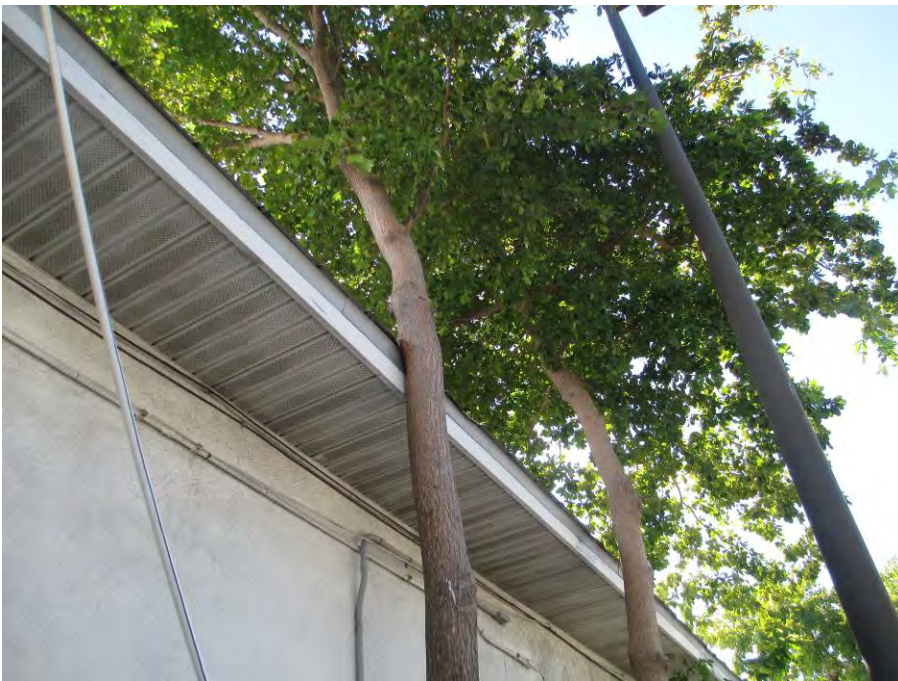

24. Mahogany (1" diameter)



25A: Young Black Olive tree

25. Black Olive (6.3" diameter)
with dead ornamental shrub



26. Clump of vegetation that includes non native firebush, young black olive and a young fan palm.



27. Non native firebush



28. Young ficus and hibiscus



PHOTOS OF PROPERTY:



Olivia Street



Olivia Street



Corner of Olivia Street and Fort Street



Fort Street



Fort Street looking at rear of building



Back of Building-
Clump of Brazilian
Pepper



Rear of building



Rear of Building



Rear of Building



Emma Street

Landscaping Modification / Waiver Summary				
Landscaping Type	Minimum Required	Existing	Proposed	Change/Waiver
Land use buffer (Sec. 108-347) Proposed Use: Medium impact	Type D adjacent to single family residential uses across Olivia & Emma St; Type D adjacent to multifamily residential use to the rear; plant units required varies	Olivia St – 87 Emma St. – 17 Fort St – 117 Rear Alley - 49	Olivia St – 198 Emma St – 58 Fort St – 184 Rear Alley – 32	Modification/Improving
Minimum landscaping requirement (Sec. 108-412)	20%	15.1% 5,097 sq. ft.	15.3% 5,159 sq. ft.	Modification
Street frontage (Sec. 108-413)	Between 0.5 to < 1 acre site area = 20' wide, 80 plant units per 100 linear feet; minimum 80 plant units required	Olivia St – adjacent to gym – 6.79' -adjacent to clinic varies; 19.2' to 1.6'	Olivia St – adjacent to gym – 6.79' -adjacent to Clinic varies; 19.2' to 1.6'	Modification
Interior parking areas (Sec. 108-414)	20% of total parking area; minimum 6' dim, 60 SF & 1 shade tree per landscape area; 1 tree per 100 SF of landscape area; interior landscape strips between rows and every 10 spaces	No change to non-conforming parking, 17% of total parking area, landscape proposed complies	No change to non-conforming parking, 17% of total parking area, landscape proposed complies	Modification
Perimeter parking landscaping (Sec. 108-415)	Building sites 20,000 -50,000 SF: 7.5' wide, 1 canopy shade tree, 10 shrubs per 35 LF	Varies from 10.2' to 1.6' landscape proposed cannot comply	Varies from 10.2' to 1.6' landscape proposed cannot comply	Modification
Nonvehicular use areas (Sec. 108-416)	Site with less than 30% nonvehicular open space (NOS): 4 trees / 2,000 SF NOS	landscape proposed complies	landscape proposed complies	In compliance

Other notes:

Lot Area = 33,700 sq.ft.

Building Area = 18,053 sq. ft

Setbacks

Olivia St. (Front of Building)

- 6.79' - for 69.5' frontage (at gym)
- 60.66' - for 125.8' frontage (at clinic)
- Varies at entry to medical clinic

Emma Street (Gym Side of Building)

- Varies between 1.93' and 2.15' for entire length of frontage; 119.1'

Fort Street (Clinic Side of Building)

- 47.81' for entire length of building; 57.2'

Rear of Building (Adjacent to Vehicle Parking)

- 2.7' for entire length of building; 242.17'

Pervious Area = 5,097 sq. ft.



THE CITY OF KEY WEST
Tree Commission
Post Office Box 1409 Key West, FL 33041-1409
Telephone: 305-809-3764

February 11, 2015

City of Key West
P.O. Box 1409
Key West, FL 33041

To Whom, It May Concern:

The City of Key West Tree Commission recently considered your permit application regarding property located at 111 Olivia Street, Key West, Florida, at their regularly scheduled meeting on February 10, 2015.

The request of the permit application was for Conceptual Approval of the Landscape Plan with Tree Removal for the above mentioned property. The Tree Commission approved the conceptual landscape plan to allow the project to proceed through the permitting process with HARC and the Planning Board, with conditions that the architect continue to work with the Urban Forestry Manager on a final landscape plan. Once you have received approval from HARC and the Planning Board, application should be made again to the Tree Commission for Final Landscape Plan approval with Tree Removal.

If you have any questions please call the office at (305) 809-3768.

Sincerely,

Karen DeMaria
Urban Forestry Program Manager
City of Key West
3140 Flagler Avenue
Key West, FL 33040
Office: 305/809-3768
Fax: 305/809-3978

Cc: Hayes Cumming Architects

Application



7512

Date: July 14, 2015

Please Clearly Print All Information unless indicated otherwise.

Tree Address 111 Olivia St.
Cross/Corner Street Emma St
List Tree Name(s) and Quantity See attached Landscape Plan, sheet L-002.
Species Type(s) check all that apply () Palm (X) Flowering () Fruit (X) Shade () Unsure
Reason(s) for Application :
(X) REMOVE (X) Tree Health (X) Safety () Other/Explain below
() TRANSPLANT () New Location () Same Property () Other/Explain below
() HEAVY MAINTENANCE () Branch Removal () Crown Cleaning/Thinning () Crown Reduction
Additional Information Plants that have grown naturally in odd places but are inappropriate species are being removed as part of the overall renovation plan.
and Explanation

Property Owner Name City of Key West
Property Owner eMail Address jbouquet@cityofkeywest-fl.gov
Property Owner Mailing Address 3140 Flagler Ave.
Property Owner Mailing City Key West State FL Zip 33040
Property Owner Phone Number (305) 809 - 3951
Property Owner Signature

Representative Name Andrew M. Hayes, AIA
Representative eMail Address ahayes@hc-arc.com
Representative Mailing Address 2210 Central Avenue, Suite 100
Representative Mailing City St Petersburg State FL Zip 33712
Representative Phone Number (727) 321 - 0900

NOTE: A Tree Representation Authorization form must accompany this application if someone other than the owner will be representing the owner at a Tree Commission meeting or picking up an issued Tree Permit.

Tree Representation Authorization form attached ()

<<<<< Sketch location of tree in this area including cross/corner Street >>>>>

Please identify tree(s) with colored tape

Removed : 1- Caesalpinna
1- Mahogany

(requiring permits)

If this process requires blocking of a City right-of-way, a separate ROW Permit is required. Please contact 305 - 809 - 3740.



7512

Tree Representation AuthorizationDate: 7-20-15

Attendance at the Tree Commission meeting on the date when your request will be discussed is necessary in order to expedite the resolution of your application. This Tree Representation Authorization form must accompany the application if the property owner is unable to attend or will have someone else pick up the Tree Permit once issued.

Please Clearly Print All Information unless indicated otherwise.

Tree Address

111 Olivia St

Property Owner Name

City of Key West

Property Owner eMail Address

Property Owner Mailing Address

PO Box 1409

Property Owner Mailing City

Key West

State

FL

Zip

33041

Property Owner Phone Number

() -

Property Owner Signature

Representative Name

Andrew Hayes - AIA

Representative eMail Address

ahayes@hc-arc.com

Representative Mailing Address

2210 Central Ave. Suite 100

Representative Mailing City

St. Petersburg

State

FL

Zip

33712

Representative Phone Number

(727) 321 - 0900

I Jim K. Scholl, hereby authorize the above listed agent(s) to represent me in the matter of obtaining a Tree Permit from the City of Key West for my property at the tree address above listed. You may contact me at the telephone listed above if there are any questions or need access to my property.

Property Owner Signature

jscholl

The forgoing instrument was acknowledged before me on this 20th day July, 2015.

By (Print name of Affiant) Jim K. Scholl who is personally known to me or has produced _____ as identification and who did take an oath.

NOTARY PUBLIC

Sign Name:

Portia H. Navarro

Print Name:

Portia H. Navarro

My Commission Expires:

5/13/2018

Notary Public - State of Florida (seal)

