

# Model to Monument at the Truman Water Front Park Key West

Sculptures of the Art Student's League of New York's  
2016-2017 Model to Monument collection:  
Comparison of appraised values\* and installation costs

# \*Estimated Appraised Values

Q: What are the appraised values for each piece, we will require appraisal certificates for the purpose of liability and insurance; however, if the certificates are not currently available, a written statement from either Ira, Director of the School, or Greg, Curator of the Collection, documenting the anticipated dollar value of each piece, will serve our needs for the decision-making process.

A: The gauge we've used to determine the value for these works is based solely on their cost. They are as follows:

Aaron Bell:	\$ 14,381
Sheila Berger:	21,201
James Emerson	13,132
Tanda Francis	19,791
Markus Holtby	19,086
Shiho Sato	13,839
Sarah Thompson	<u>12,098</u>
Total	113,528

# M2M @ TWFP

- The purpose of this document is to provide the decision-making Boards of the City of Key West with the details needed to determine their recommendations to the City Commission regarding a proposed donation, from Mr. John Padget and Jacob Decker, of Public Art to be installed at the Truman Water Front Park in Key West, Florida.
- The AIPP Board should consider the collection complete and whole. It is being offered in its entirety or not at all. If a determination is made to accept all of the pieces, the AIPP Board should then recommend the locations for the installation of the pieces along the Quay based on other features to be included in the Park design; relevant details are offered on the following slides and a consensus vote should be achieved in establishing the Board's recommendation.

## DONATION OFFER from the DONOR AGREEMENT:

WHEREAS, DONOR (Mr. John Padget and Jacob Decker) desires to donate to the CITY the sculptures of the Art Students' League of New York's 'Model to Monument' Collection, currently housed in Riverside Park along the Hudson River in New York and to be installed in the planned Truman Waterfront Park in Key West, Florida, the associated de-installation of the sculptures from Riverside Park, New York, and their transportation to the City of Key West, Florida...

The City of Key West would be responsible for all other costs including:

- Storage of works until Park construction allows for installation
- Design for and installation of the works into designated sites within the TWFP
- Maintenance and Conservation of the works for the lifetime of the installation
- De-installation, or removal of the works, as determined by the City Commission and the AIPP Board
- Insurance; including Liability costs



Fragments

Shiho Sato

Value \$13,839

Cost \$17,500





Tarkus

Markus Holtby

Value \$19,086

Cost \$18,500

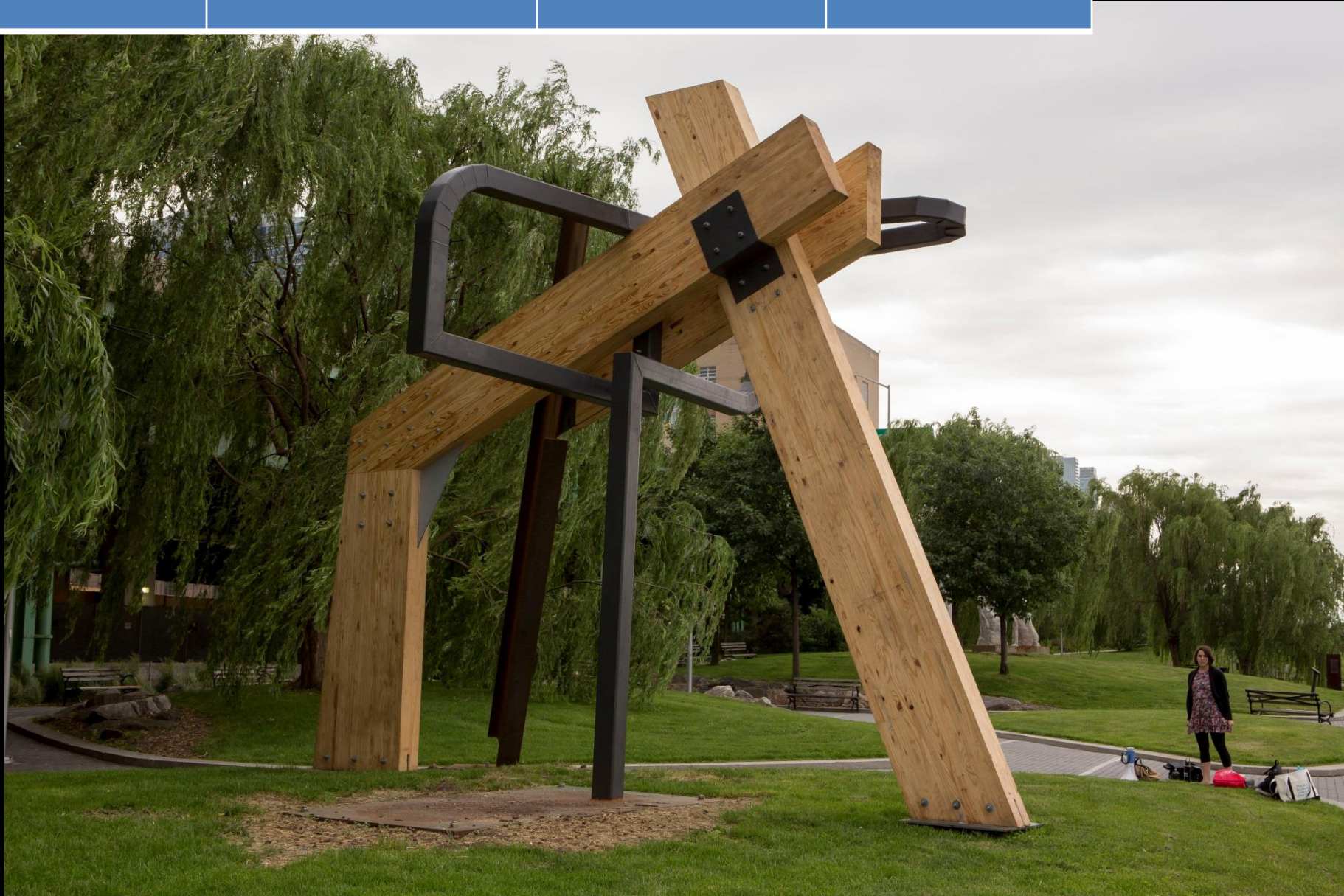



Pyramid

James Emerson

Value \$13,132

Cost \$19,300





Masks

Tanda Francis

Value \$19,791

Cost \$15,700





Wind Warp	Sarah Thompson	Value \$12,098	Cost \$19,300
-----------	----------------	----------------	---------------





Avis Glorise & Nature Eternal

Sheila Berger

Value \$ 21,201

Cost \$9,000+\$9,600= \$18,600







**Avis Glorae & Nature Eternal**

**Sheila Berger**

**Value \$21,201**

**Cost \$9,000+\$9,600=\$18,600**



Stand Tall	Aaron Bell	Value: \$14,381	Cost: \$9,700
------------	------------	--------------------	------------------





ART WORK	ARTIST	VALUE	INSTALLATION COST
Fragments	Shiho Sato	\$ 13,839	\$17,500
Tarkus	Markus Holtby	\$ 19,086	\$18,500
Pyramid	James Emerson	\$ 13,132	\$19,300
Masks	Tanda Francis	\$ 19,791	\$15,700
Wind Warp	Sarah Thompson	\$ 12,098	\$19,300
Avis Glorïae & Nature Eternal	Sheila Berger	\$ 21,201	\$9,000+\$9,600=\$18,600
Stand Tall	Aaron Bell	\$ 14,381	\$9,700
<b>Totals</b>		\$113,528	\$118,600
Overhead / Project-wide Costs			
TWFP Design			\$18,000
Modifications			
Mob			\$10,000
Subtotal - Overhead Costs			\$28,000
		<b>Total Project Value=</b>	<b>Total Project Costs=</b>
		<b>\$113,528</b>	<b>\$146,600</b>







CITYOFKEYWEST,FL

P.O. BOX 1409  
3140 FLAGLER AVENUE  
KEY WEST, FL 33041



PROJECTNAME

**NORTHPARK  
TRUMAN  
WATERFRONT PARK**

0000 0000 0000 0000 0000 0000 0000 0000

TRUMANWATERFRONTPAR  
NORTHOFBUILDING103TO  
ADMIRAL'SSCUT

---

**PEREZENGINEERING &  
DEVELOPMENT, INC.**  
Certified as a Minority Business Enterprise

1010 Kennedy Drive  
Suite 201  
Key West, Florida 33040  
(305) 293-9440  
Fax: (305) 298-0343

PROFESSIONAL SEAL:

ALLENE PEREZ, P.E.  
FLORIDA REGISTERED ENGINEER  
51468

SUBMITTAL DESCRIPTION (MILISTON)

100 CONSTRUCTION  
DOCUMENTS  
December 16, 2016

REVISION

---

<u>DRAWING SHEET INFORMATION</u>	
BAPROJECTNO:	14041.01
SCALE:	1"=4'
DATE:	
DRAWNBY:	BGO
CHECKEDBY:	AE

DRAWING TITLE:  
NTP3  
SITE GEOMETRY  
PLAN

CG-20

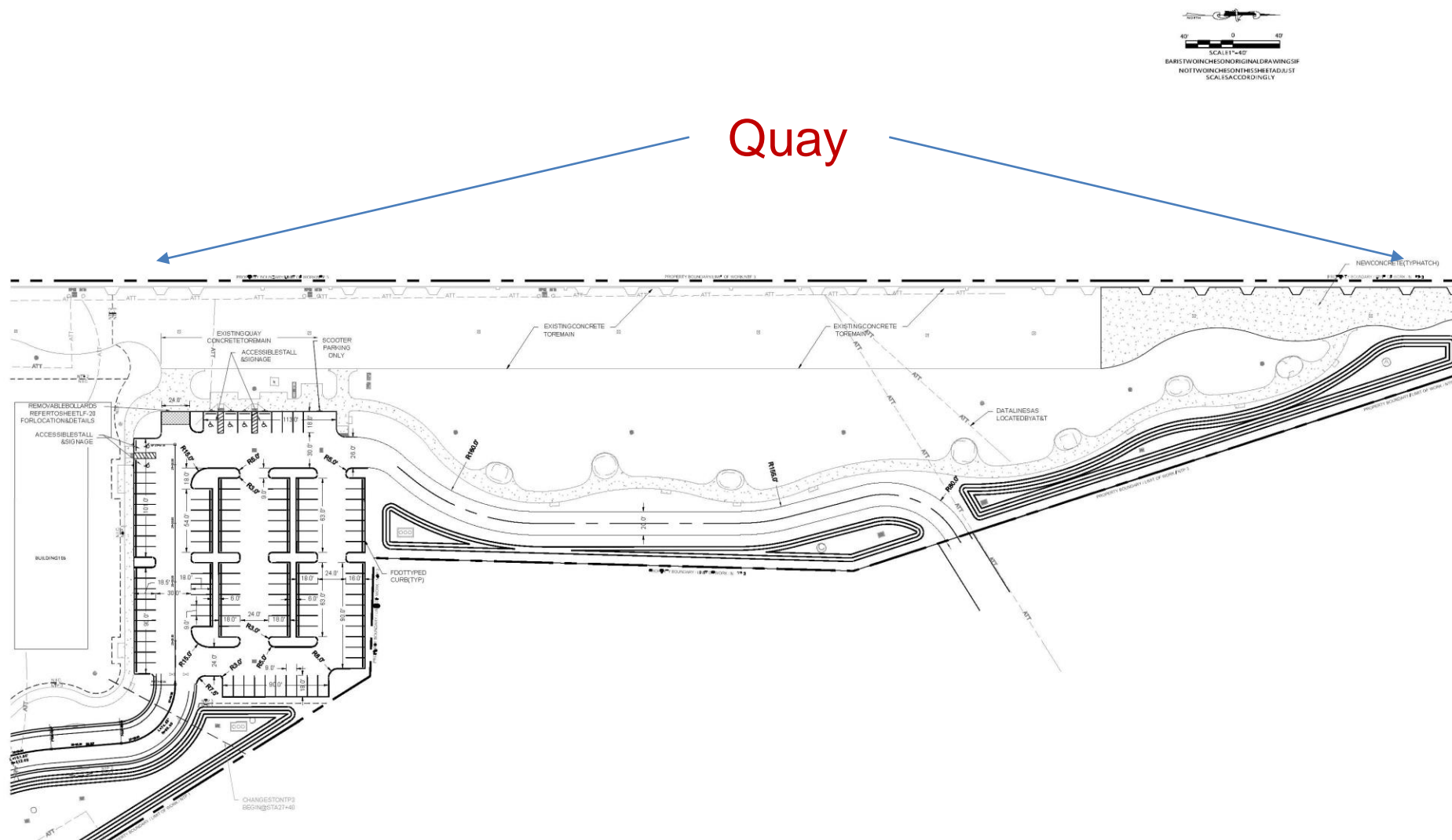

# Quay

PREPARED FOR:  
CITY OF KEY WEST, FL  
P.O. BOX 1499  
3140 FLAGLER AVENUE  
KEY WEST, FL 33041



PROJECT NAME:  
**NORTH PARK  
TRUMAN  
WATERFRONT PARK**

PROJECT LOCATION/ACCESS:  
TRUMAN WATERFRONT PARK,  
NORTH OF BUILDING 103 TO  
ADMIRAL'S CUT

SUB-CONSULTANT INFORMATION:



KIRK J. OLNEY  
FLORIDA REGISTERED LANDSCAPE  
ARCHITECT  
LAB091765

SUBMITTAL DESCRIPTION / DELIVERABLE:

100% CONSTRUCTION  
DOCUMENTS  
December 16, 2016

REVISIONS:

DRAWING SHEET INFORMATION:  
BA PROJECT NO.: 14041.010  
SCALE: 1" = 40'-0"  
DATE: KJO  
DRAWN BY: KJO  
CHECKED BY: RPH

DRAWING TITLE:  
**NTP3  
LANDSCAPE PLAN**

SHEET NO.

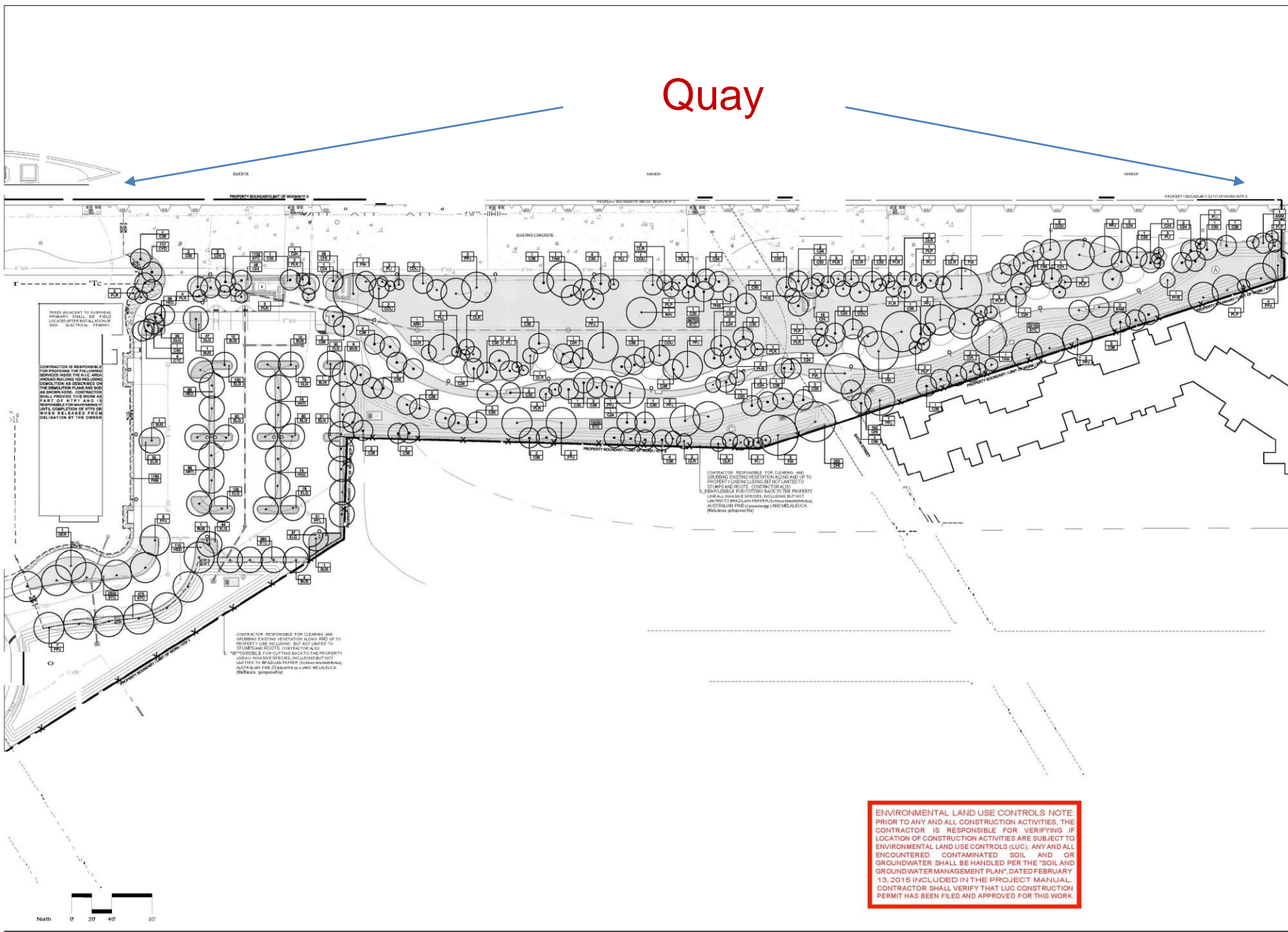

ENVIRONMENTAL LAND USE CONTROLS NOTE  
PRIOR TO ANY AND ALL CONSTRUCTION ACTIVITIES, THE  
CONTRACTOR IS RESPONSIBLE FOR VERIFYING IF  
LOCATION OF CONSTRUCTION ACTIVITIES ARE SUBJECT TO  
ENVIRONMENTAL LAND USE CONTROLS (LUC). ANY AND ALL  
ENCOUNTERED CONTAMINATED SOIL AND/OR  
GROUNDWATER SHALL BE HANDLED PER THE "SOIL AND  
GROUNDWATER MANAGEMENT PLAN", DATED FEBRUARY  
13, 2016 INCLUDED IN THE PROJECT MANUAL.  
CONTRACTOR SHALL VERIFY THAT LUC CONSTRUCTION  
PERMIT HAS BEEN FILED AND APPROVED FOR THIS WORK.



➤ Storage of works until Park construction allows for installation: potential within City facilities includes Fleming Key (outside along fence), and possibly Building 103 (if facility can be emptied of currently stored contents and selected sculptures are small). Fleming Key presents the only storage option if the entire collection is accepted. Backhoe equipment required to move the pieces is available for up to 4,000/5,000 lbs. for weights over this amount, a crane will be required to move the pieces for installation.

➤ Design for and installation of the works into designated sites within the TWFP:  
Based on the cost determinations calculated by the City of Key West's Engineering Department and noted on previous slides

➤ Maintenance and Conservation of the works for the lifetime of the installation: During the year the work was on display (in New York), any maintenance and conservation costs were (conducted) strictly on an as-needed basis ... This year, we (ASLNY) spent \$1400 when we modified his (sic) piece and \$440 to repair Sheila Berger's piece that suffered minor vandalism damage. Per KW Engineering: stainless steel pieces can be coated with wax to preserve the integrity of the metal, it is also possible to install bare steel. With no coating or weatherization, and maintenance limited to an as-needed-basis, the life expectancy of the 'Tarkus' sculpture is predicted to be approximately 20 years. This is the low-end of the life expectancy of the works and further discussion with Community Services is required. Primary concern of Community Services is vandalism.

- De-installation, or removal of the works from their sited locations, as determined by the City Commission and the AIPP Board: de-installation costs for each piece installed in Key west are expected to mirror the installation costs for each piece. De-installation of any work in the AIPP Program should be supported by an AIPP Board recommendation and will require City Commission approval. All related costs will be incurred by the City of Key West. Removal of donated works may occur for any of the following purposes:
  - Relocation
  - Disposal
  - Sale
  - Loan
  
- Insurance, including Liability costs: Art in the AIPP program can be insured in one of two ways: pieces can be insured under the City's General Liability Policy or for their individually appraised values- the determination will be made through the Risk Management Division of the Finance Department



SITE	ARTIST	TITLE	BASE (L)	BASE (W)	BASE (sq ft)	NOTES
SITE 7	TANDA FRANCIS	EVERYONE BREAKS	1.5	1.5	2.25	1" thick
SITE 7			1.5	1.5	2.25	1" thick
SITE 7			2	2	4.00	1" thick
	TOTAL 1" THICKNESS				8.50	
SITE 6	AARON BELL		5	5.5	27.50	3/4" thick
SITE 5A	SHEILA BERGER	AVIS GLORIAE	7	7	49.00	3/4" thick PLATE AT GRADE
SITE 5A			6	4	24.00	3/4" thick SUB PLATE ON SLAB
SITE 2	MARKUS HOLTBY		3	2	6.00	3/4" thick
SITE 2			2	2	4.00	3/4" thick
SITE 2			4	6	24.00	3/4" thick
SITE 4	SARAH THOMPSON MOORE		10 dia.		78.50	3/4" thick
	TOTAL 3/4" THICKNESS				213.00	
SITE 1	SHIHO SATO	FRAGMENTS	4	4	16.00	1/2" thick top
SITE 1			3.67	9.167	33.64	1/2" thick top
SITE 1			4.75	3.167	15.04	1/2" thick top
SITE 1			16	1	16.00	1/2" thick sides
SITE 1			25.674	1	25.67	1/2" thick sides
SITE 1			15.834	1	15.83	1/2" thick sides
	TOTAL 1/2" THICKNESS				122.19	
	TOTAL SQ FT MATERIAL				343.69	COST @ \$77.10 PER SQ FT =
						\$26,498.82

Reviewing all the drawings for base dimensions, there are variation in thickness, detailed below. Ignoring those variations, the total sq ft material comes to just under 344 sq ft, which at \$77.10 per sq ft gives a cost of just over \$26,500.

RVW/Sculpture (professional transporters), states that concerning transport from Riverside South, they will partner with United Freight Trucking to professionally pack and tarp all (7) M2M sculptures on (3) flatbed trucks to move them to Key West. He will recommend that Key West engineers determine how much stainless steel upgrading work needs to guarantee local conditions permanent placement; he will have NYC-Metro fabricators do the work if they so desire, or meet with Key West engineering at Riverside South with myself for on-site evaluations.

Q: What type of equipment was used in the installation i.e. crane v backhoe? Also the approximate weight of each piece and when they are transported what type of container is anticipated to be used?

How will the pieces be de-constructed and shipped?

If they are taken apart will the artist be available to supervise the re- construction?

A: We use a hydraulic telescopic forklift with a 2 to 3 ton capacity which was sufficient for the installation of all the sculptures. We will get you the info on the container shortly. I'm sure the artists will be able to supervise the re-construction of works if needed.