

8388

Tree Permit Application

Date: 03-22-2017

Final Landscap Plan with tree Removal

Please Clearly Print All Information unless indicated otherwise.

Tree Address	1000 Atlantic Boulevard, Key West, FL 33040 (Higgs Beach Park)
Cross/Corner Street	Please refer to attached Tree Disposition Plans (LD-01 to LD-07)
List Tree Name(s) and Quantity	Please refer to Tree Disposition List (LD-12 to LD-22)
Species Type(s) check all that apply	<input type="checkbox"/> Palm <input type="checkbox"/> Flowering <input type="checkbox"/> Fruit <input type="checkbox"/> Shade <input type="checkbox"/> Unsure
Reason(s) for Application:	
YES <input type="checkbox"/> REMOVE	<input type="checkbox"/> Tree Health <input type="checkbox"/> Safety <input type="checkbox"/> Other/Explain below
YES <input type="checkbox"/> TRANSPLANT	<input type="checkbox"/> New Location <input type="checkbox"/> Same Property <input type="checkbox"/> Other/Explain below
YES <input type="checkbox"/> HEAVY MAINTENANCE	<input type="checkbox"/> Branch Removal <input type="checkbox"/> Crown Cleaning/Thinning <input type="checkbox"/> Crown Reduction
Other/Explain	In the way of construction YES <input type="checkbox"/> Selective Pruning as per ANSI Standards (of remaining trees)
Reason for Request	Relocation of Atlantic Boulevard at Higgs Beach Park based on the 2010 Masterplan
Property Owner Name	Steven Sanders - Monroe County Project Manager
Property Owner eMail Address	sanders-steven@monroecounty-fl.gov
Property Owner Mailing Address	1100 Simonton Street, Room 2-216
Property Owner Mailing City	City of Key West
Property Owner Phone Number	305-295-4337
Property Owner Signature	
Representative Name	Leticia Fernandez-Beraud, RLA
Representative eMail Address	leticiaf@fernandez-beraud.com
Representative Mailing Address	2333 Brickell Avenue #216
Representative Mailing City	Miami
Representative Phone Number	305-567-0110

NOTE: A Tree Representation Authorization form must accompany this application if someone other than the owner will be representing the owner at a Tree Commission meeting or picking up an issued Tree Permit.

Tree Representation Authorization form attached ()

<<<<< Sketch location of tree in this area including cross/corner Street >>>>>

Please identify tree(s) with colored tape

1000 Atlantic

If this process requires blocking of a City right-of-way, a separate ROW Permit is required. Please contact 305-809-3740.

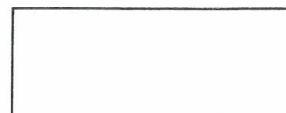

Tree Representation Authorization

Date:

03/22/2017

Attendance at the Tree Commission meeting on the date when your request will be discussed is necessary in order to expedite the resolution of your application. This Tree Representation Authorization form must accompany the application if the property owner is unable to attend or will have someone else pick up the Tree Permit once issued.

Please Clearly Print All Information unless indicated otherwise.

Tree Address HIGGS BEACH PARK

Property Owner Name STEVEN SANDERS

Property Owner eMail Address _____

Property Owner Mailing Address _____

Property Owner Mailing City _____

Property Owner Phone Number _____

Property Owner Signature _____

1100 SIMONTON ST. ROOM 2-216

KEY WEST

State FL

Zip 33040

305-295-4337

Representative Name

Leticia Fernandez-Beraud

Representative eMail Address

2333 Brickell, Avenue 216

Representative Mailing Address

leticiaf@fernandez-Beraud.com

Representative Mailing City

Miami

State fl

Zip 33129

Representative Phone Number

(305) 567 -0110

I Steven Sanders, hereby authorize the above listed agent(s) to represent me in the matter of obtaining a Tree Permit from the City of Key West for my property at the tree address above listed. You may contact me at the telephone listed above is there is any questions or need access to my property.

Property Owner Signature

The forgoing instrument was acknowledged before me on this 22nd day March 2017.

By (Print name of Affiant) STEVEN SANDERS who is personally known to me or has produced n/a as identification and who did take an oath.

NOTARY PUBLIC

Sign Name: _____

Notary Public - State of Florida (seal)

Print Name: _____

Ann M. Mytnik

My Commission Expires: _____

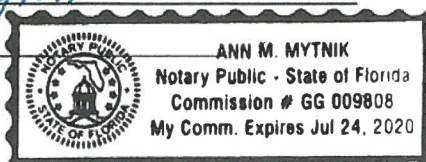

Karen DeMaria

From: leticiaf@fernandez-beraud.com
Sent: Wednesday, March 22, 2017 3:46 PM
To: Natalie Hill
Cc: Karen DeMaria
Subject: RE: Submittal for Tree Permit - Atlantic Boulevard Relocation at Higgs Beach Park - email 1 (0-22-17)
Attachments: 01-Tree Permit-AtlBlvRelo- HiggsBeach-Notarized form.pdf; 02-AtlBlvReloc-Permit Ap-03-22-2017-signed.pdf

RE: Submittal for Tree Permit - Atlantic Boulevard Relocation at Higgs Beach Park - email 1 (0-22-17)

Natalie,

Please refer to the attachment - signed forms - and confirm upon receipt.

I will start sending the plans via email.

The files are 10 and 11 mb. I will start sending the first one and I will call you back to confirm the receipt.

Thank you for your help.

With regards,

Leticia Fernandez-Beraud, RLA
LA 6666730

leticiaf@Fernandez-Beraud.com
Fernandez_Beraud@bellsouth.net

www.Fernandez-Beraud.com



FERNANDEZ-BERAUD, INC.
Landscape Architecture and Planning
LC26000233

Mailing Address:
2333 Brickell Avenue 216
Miami, Florida 33129

Physical Address:
717 Ponce de Leon #223
Coral Gables, Florida 33134
Ph: 305-567-0110
Fax: 305-567-0115



Overview



Legend

- Major Roads
- Centerline
- Hooks
- Road Center
- - - Rights of Way
- [] Condo Building
- [] Conservation Easement
- [] Key Names
- [] Parcels

Parcel ID	00058790-000100	Alternate ID	1059285	Owner Address	MONROE COUNTY FLORIDA
Sec/Twp/Rng	05/68/25	Class	STATE PARKS		500 WHITEHEAD ST
Property Address	1000 ATLANTIC BLVD	Acreage	213997		KEY WEST, FL 33040-6581
	KEY WEST				

District n/a
Brief Tax Description KW PT TR 27 RR-342/343 W-458/459 OR561-949 OR603-558/564 OR619-949/956
(Note: Not to be used on legal documents)

Date created: 3/28/2017
Last Data Uploaded: 3/28/2017 1:47:10 AM



Developed by
The Schneider Corporation

CLARENCE HIGGS BEACH

MASTER PLAN

KEY WEST, FLORIDA

MASTER PLAN TEAM MEMBERS				LIST OF DRAWINGS
<u>ARCHITECT:</u> WILLIAM P. HORN ARCHITECT, P.A. WILLIAM P. HORN, RA, LEED AP EVELIA MEDINA, LEED AP 915 EATON ST. KEY WEST, FL 33040 TEL. (305) 296-8302	<u>PLANNER:</u> MITCHELL PLANNING & DESIGN BARBARA MITCHELL, LEED AP 15450 SE 103rd. PLACE RD. OAKLAHA, FL. 32197 (305) 509-0966	<u>LANDSCAPE DESIGN:</u> LANDWISE DESIGN LADD ROBERTS, RLA 9822 TAPESTRY PARK CIRCLE SUITE 201 JACKSONVILLE, FL 32246 TEL. (904) 343 4194		A-1 COVER SHEET, SITE DATA A-2 EXISTING SITE PLAN 1" = 60.0' A-3 PROPOSED SITE PLAN 1" = 60.0' A-4 PARTIAL SITE PLAN 1/16" = 1'-0" A-5 PARTIAL SITE PLAN 1/16" = 1'-0" A-6 PARTIAL SITE PLAN 1/16" = 1'-0" A-7 VISITOR/NATURE CENTER, PLANS, ELEVATIONS & RENDERINGS A-7.1 VISITOR/NATURE CENTER, ELEVATIONS & RENDERINGS A-8 STORAGE BUILDINGS, PLANS, ELEVATIONS, RENDERINGS & SITE DETAILS E-1 LIGHTING SITE PLAN
<u>CIVIL ENGINEERING:</u> PEREZ ENGINEERING AND DEVELOPMENT INC. ALLEN E. PEREZ, PE 1010 EAST KENNEDY DRIVE SUITE 400 KEY WEST, FL 33040 TEL. (305) 293-9440	<u>LIGHTING DESIGN:</u> INNOVATIVE ENGINEERING GROUP INC. SUDHIR GUPTA, PE, LEED AP 5532 N.W. 72ND AV. MIAMI FL. 33166 TEL. (305) 888-9626	<u>TRAFFIC ENGINEER:</u> TRAFFIC TECH ENGINEERING JOAQUIN VARGUS, PE 8400 N. UNIVERSITY DR. FT. LAUDERDALE, FL 33321 TEL. (954) 582 0988	<u>SURVEYOR:</u> ISLAND SURVEYING INC, FREDERICK H. HILDEBRANDT, PE 33152 NORTHSIDE DRIVE #201. KEY WEST, FL. 33040 TEL. (305) 293-0466	C-1 CONCEPTUAL DRAINAGE PLAN C-2 CONCEPTUAL DRAINAGE PLAN -A C-3 CONCEPTUAL DRAINAGE PLAN -B C-4 CONCEPTUAL DRAINAGE PLAN -C L-1 TREE IMPACT PLAN L-2 CODE PLANTING & TREE RELOCATIONS L-3 PLANTING DETAILS & SUGGESTED PLANT PALETTE SURVEY

SITE DATA	
SITE AREA: 762,891 S.F. (17.5 ACRES)	
LAND USE: PS (PUBLIC SERVICES INC. RECREATION & OPEN SPACE)	
FLOOD ZONE: AE +8.0'/AE +9.0'/AE +10.0'/VE 10/VE 12	
SETBACKS:	
FRONT SETBACK:(WHITE STREET) REQUIRED = 20.0' EXISTING = 25'-4" (WOOD DECK) PROPOSED= 25'-4" (WOOD DECK)	
SIDE SETBACK:(CASA MARINA COURT) REQUIRED = 15.0' EXISTING = 123'-9" (COV'D. TABLE IN PLAYGROUND) PROPOSED= 24'-0" (EQUIPMENT STORAGE)	
REAR SETBACK:(REYNOLDS STREET) REQUIRED = 20.0' EXISTING = 237'-8" (COVERED BANDSTAND) PROPOSED= 55'-4" (TENNIS PAVILION)	
COASTAL CONST. CONTROL LINE: REQUIRED = 50'-0" EXISTING = 11'-5"(WEST MARTELLO) PROPOSED= 11'-5" (WEST MARTELLO)	
FAR: (INTERIOR AND COVERED AREA) ALLOWABLE: 0.2 MAX. (152,578 S.F.) EXISTING: 0.02 (19,578 S.F.) PROPOSED: 0.02 (22,605 S.F.)	
HEIGHT: ALLOWABLE: 25.0' EXISTING: 25.0' (WEST MARTELLO) PROPOSED: 25.0' (NEW VISITOR CENTER)	
LOT COVERAGE AREA:	
REQUIRED: 305,156 S.F. (40% MAX.) EXISTING: 29,945 S.F. (3.92%) PROPOSED: 32,972 S.F. (4.32%)	
IMPERVIOUS AREA:	
REQUIRED: 381,446 S.F. (50% MAX.) EXISTING: 230,499 S.F. (30.2%) PROPOSED: 256,333 S.F. (33.6%)	
LANDSCAPE AREA:	
REQUIRED: 152,578 S.F. (20%) EXISTING: 532,392 S.F. (69.78%) PROPOSED: 506,558 S.F. (66.31%)	
OPEN SPACE (INCLUDES RECREATIONAL OPEN SPACE):	
REQUIRED: 152,578 S.F. (20%) EXISTING: 570,362 S.F. (74.7%) PROPOSED: 544,528 S.F. (71.3%)	
PARKING:	
EXISTING: 145 SPACES PROPOSED: 145 SPACES (INCLUDES 6 HANDICAP SPACES)	
BIKE/SCOOTER PARKING:	
EXISTING: 60 SPACES (±18 NON CONFORMING) PROPOSED: 45 SPACES	

WILLIAM P. HORN
ARCHITECT, P.A.

915 EATON ST.
KEY WEST,
FLORIDA
33040

TEL. (305) 296-8302
FAX (305) 296-1033

LICENSE NO.
AA 0003040

HIGGS BEACH
KEY WEST, FL.



MITCHELL PLANNING & DESIGN

INNOVATIVE ENGINEERING
GROUP INC.

TRAFFIC TECH ENGINEERING

ISLAND SURVEYING INC.



SEAL

THESE DRAWINGS MAY
NOT BE REPRODUCED
WITHOUT WRITTEN
AUTHORIZATION BY
WILLIAM P. HORN

DATE

06-22-10
06-30-11 DRC
08-18-11 PL. BD.

REVISIONS

12-30-10
01-06-11
02-25-11

DRAWN BY

EMA

PROJECT
NUMBER

1004

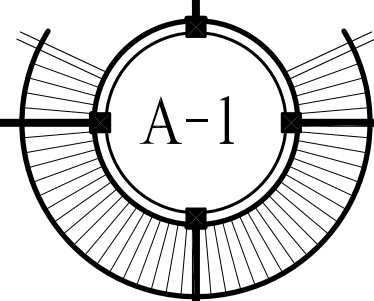

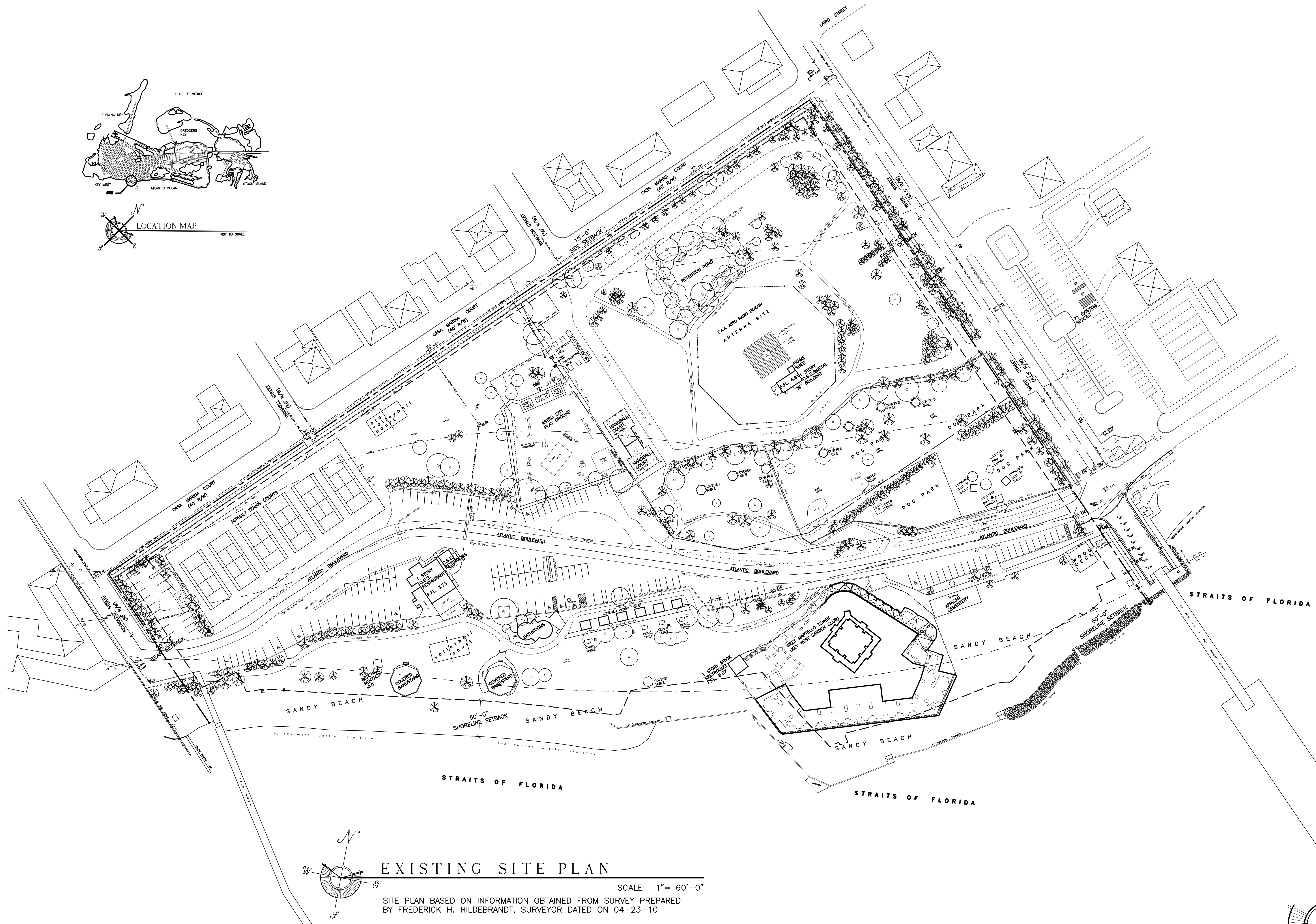
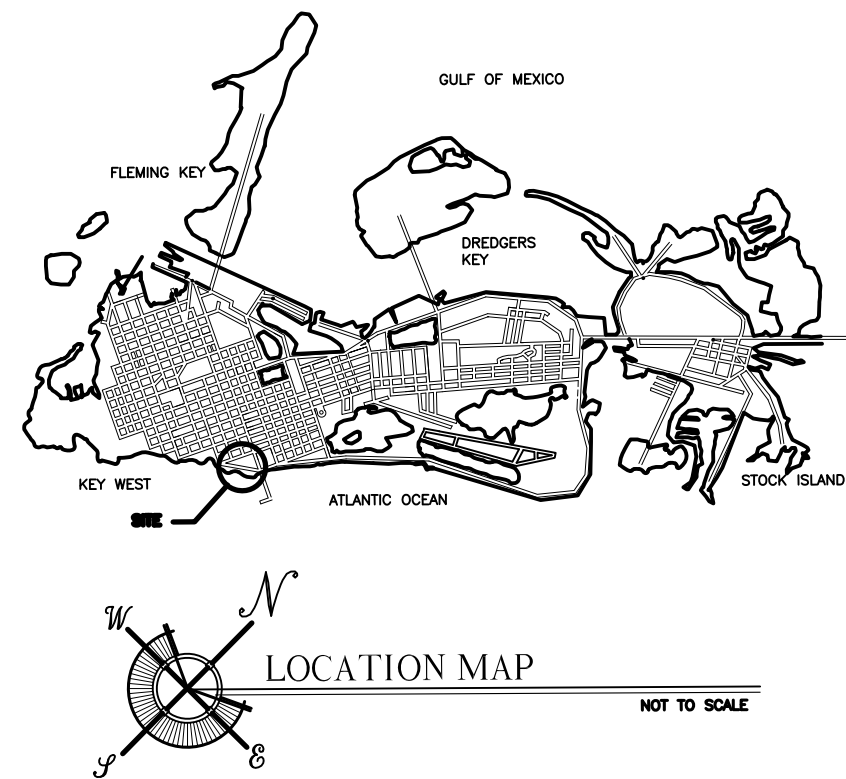

EXISTING SITE PLAN

SCALE: 1" = 60'-0"

SITE PLAN BASED ON INFORMATION OBTAINED FROM SURVEY PREPARED
BY FREDERICK H. HILDEBRANDT, SURVEYOR DATED ON 04-23-10

CLARENCE HIGGS BEACH - MASTER PLAN

KEY WEST, FLORIDA



RECEIVED

August 30, 2011

KW Planning Dpt

WILLIAM P. HORN
ARCHITECT, P.A.

915 EATON ST.
KEY WEST,
FLORIDA
33040

TEL. (305) 296-8302
FAX (305) 296-1033

LICENSE NO.
AA 0003040

HIGGS BEACH
KEY WEST, FL.



MITCHELL PLANNING & DESIGN

INNOVATIVE ENGINEERING
GROUP INC.

TRAFFIC TECH ENGINEERING

ISLAND SURVEYING INC.



SEAL

THESE DRAWINGS MAY
NOT BE REPRODUCED
WITHOUT WRITTEN
AUTHORIZATION BY
WILLIAM P. HORN

DATE

06-22-10
06-30-11 DRC
08-18-11 PL. BD.

REVISIONS

12-30-10
01-06-11
02-25-11

DRAWN BY

EMA

PROJECT
NUMBER

1004

A-2



- ① FITNESS TRAIL STOP
- ⬡ COVERED TABLE
- ⊠ SHADE STRUCTURE



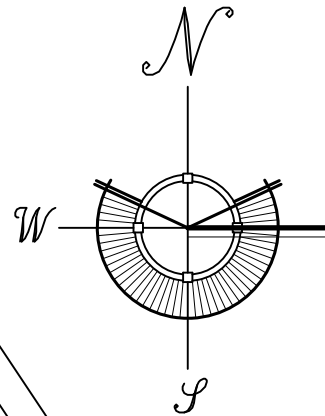
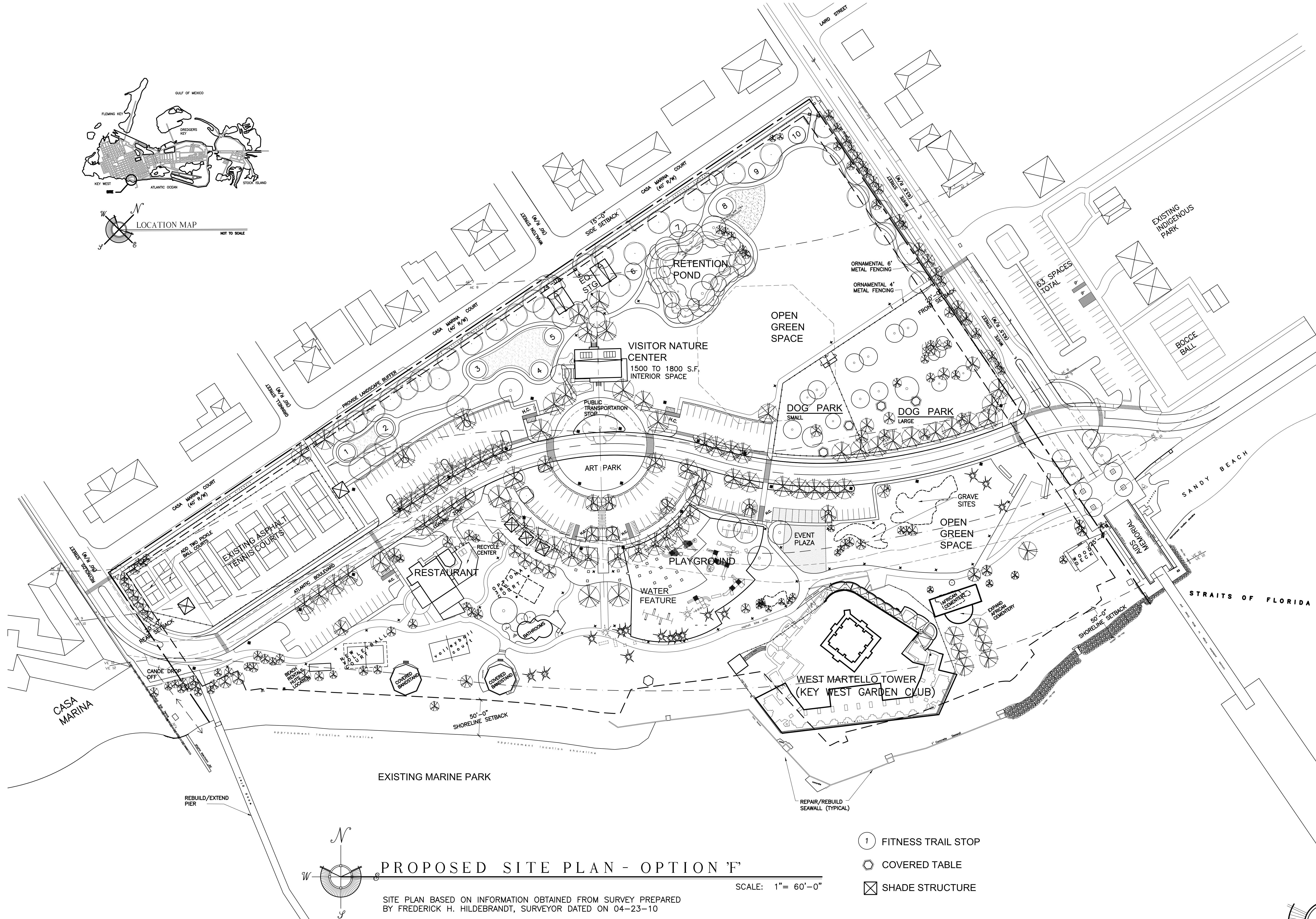
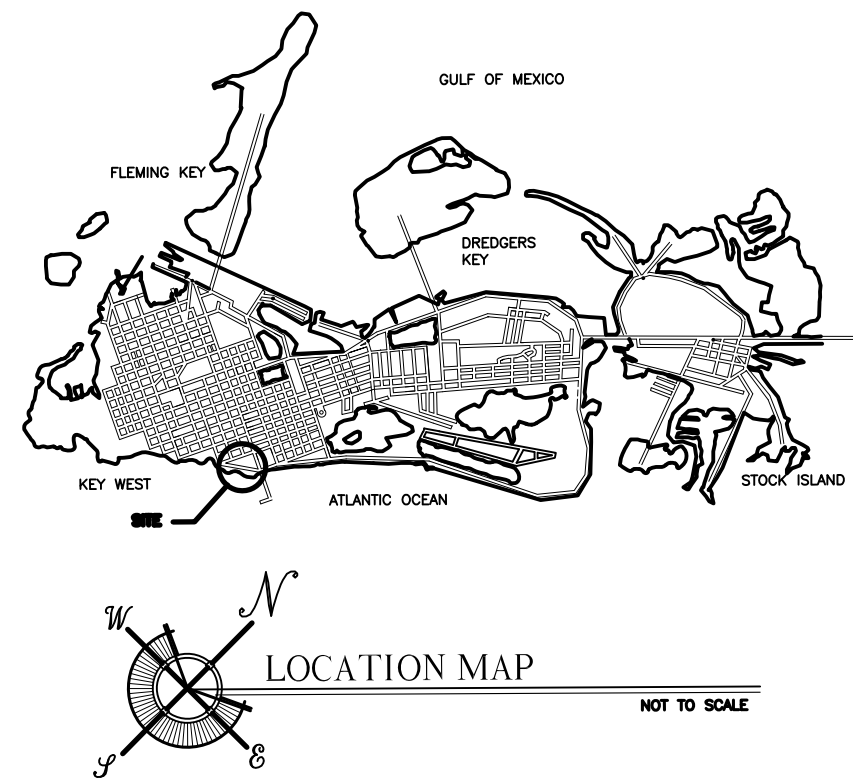

PROPOSED SITE PLAN - OPTION F

SCALE: 1" = 60'-0"

SITE PLAN BASED ON INFORMATION OBTAINED FROM SURVEY PREPARED BY FREDERICK H. HILDEBRANDT, SURVEYOR DATED ON 04-23-10

- 1 FITNESS TRAIL STOP
- COVERED TABLE
- SHADE STRUCTURE

CLARENCE HIGGS BEACH - MASTER PLAN

KEY WEST, FLORIDA



RECEIVED
August 30, 2011
KW Planning Dpt

WILLIAM P. HORN
ARCHITECT, P.A.

915 EATON ST.
KEY WEST,
FLORIDA
33040

TEL (305) 296-8302
FAX (305) 296-1033

LICENSE NO.
AA 0003040

HIGGS BEACH
KEY WEST, FL.



MITCHELL PLANNING & DESIGN

INNOVATIVE ENGINEERING
GROUP INC.

TRAFFIC TECH ENGINEERING

ISLAND SURVEYING INC.



SEAL

THESE DRAWINGS MAY
NOT BE REPRODUCED
WITHOUT WRITTEN
AUTHORIZATION BY
WILLIAM P. HORN

DATE
06-22-10
06-30-11 DRC
08-18-11 PL. BD.

REVISIONS
12-30-10
01-06-11
02-25-11

DRAWN BY
EMA

PROJECT
NUMBER
1004

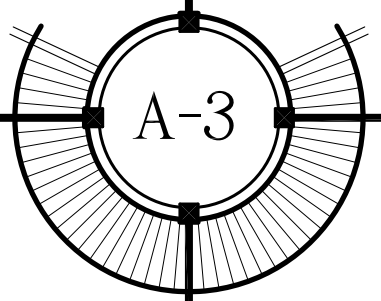

Landscape Waiver Letter

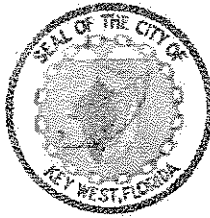

THE CITY OF KEY WEST

Post Office Box 1409 Key West, FL 33041-1409 (305) 809-3700

October 11, 2011

VIA ELECTRONIC MAIL

Mr. William P. Horn, P.A.
915 Eaton Street
Key West, Florida 33040

**RE: 1000 Atlantic Boulevard Higgs Beach Park
Major Development Plan
Waiver per Section 108-226**

Dear Mr. Horn:

We are in receipt of your August 28, 2011, request to waive landscape requirements associated with the Major Development Plan for the Higgs Beach Park Master Plan. The project involves modifications to an existing site. Open space requirements, building coverage, impervious surface, and Floor Area Ratio are all well below the required maximum dimensional requirements and a Landscape Plan is proposed as part of the application. The Planning Department, in concurrence with the City Urban Forestry Program Manager, has determined that landscape requirements associated with new development are not relevant to this project.

Section 108-226 of the Code allows the City Planner to waive requirements of the Major Development Plan process upon rendering of a written finding that waiver requirements have been met. This letter constitutes a finding that the required landscape buffer for Minimum Standards for Landscaping Along the Right-of Way and Perimeter Landscape Requirements for Parking Lots, and the requirement that no more than 25% of trees on the site shall be palms. Section 108-413(b)), Section 108-415(a) and Section 108-481(a) are hereby waived, due to the following findings: the required landscape buffer and limitation on palm trees are not necessary in order to protect the public interest or adjacent properties due to the principals of Crime Prevention Through Environmental Design (CEPTED) and best management principals for adaptive reuse of plant material; landscape buffers and limitations on palm trees do not bear any relationship to the landscape improvements, safety, shade, of the Beach Park design and its impacts Beach Park in a residential neighborhood; and, a landscape buffer yard and limitations on palm trees are not practical based on the CEPTED principals of design and . No impacts to the environment, public facilities or adjacent land uses are anticipated.

Mr. William P. Horn

October 11, 2011

Page 2

Please feel free to contact me at (305) 809-3728 with any questions or comments.

Sincerely,



Donald Deland Craig, AICP, Planning Director

Xc: Geo File

K:\Geo Projects\Higgs Beach\2011 Master Plan\20111012 Landscape Waiver Letter.doc