



Truman Waterfront - Southernmost Tropical Fruit Park

Concept

Overview: Key West has a rich history of tropical fruit, a history that is nearly forgotten today. The early Key West settlers were a mix of Bahamians, Cubans and Anglos. The Cubans and Bahamians families, culturally different, had different preferred fruits and different culinary uses for fruit. As the cultures integrated, they formed an interesting and historically significant tropical fruit culture in Key West.

One of many Key West tropical fruit stories and a better known one is the mamey sapote. The one growing near a fire station in Key West is a prized cultivar. The seeds of this tree were believed to come from Cuba by way of 19th century dissidents who left the island at that time. The tree was originally called the Key West mamey sapote until it was selected and propagated by Eugenio Pantin in the early 1950s. The story goes that a Cuban émigré named Josefina Jimenez smuggled three mamey seeds into the US in her brassiere and gave them to Pantin, who grew them as seedling rootstocks, onto which he grafted budwood of the Key West mamey tree. Pantin then proceeded to plant a small commercial orchard in Miami-Dade County, Florida. This mamey is known throughout the tropical fruit world as the Pantin or Key West mamey.

Truman Waterfront – Southernmost Tropical Fruit Park wants to distinguish Key West’s little known tropical fruit history. The park will be a living museum. It will create a space for visitors and locals to learn, and enjoy the wonders of tropical fruit, as well as understand the edible vegetation used historically in Key West. The park will have a strong educational component. It will be an excellent resource for local history and food education. It will be an asset in teaching our youth about nutrition, agriculture and preparing fruits. Nationally the local food movement is growing exponentially. The park will also be a symbol for local food and will support agro-tourism in Key West. The park will be a non-burden to the Key West City system.

Organization: Patrick Garvey founded Grimal Grove in 2013. Grimal Grove is a historic tropical fruit grove, once owned by an inventor Adolf Grimal. The property sat idle for many years after Grimal’s death and eventually became severely overgrown, a homeless camp, illegal dump site with \$850,000 of code enforcement fines. Mr. Garvey has led the restoration of Grimal Grove for the past 5 years. The Grimal Grove currently has the rarest and most diverse tropical fruit collections in the Florida Keys.

Grimal Grove LLC specializes in the growing and distribution of tropical fruit and local produce. It also offers a tropical fruit tree consulting service for Monroe County. Grimal Grove LLC is proposing to design the park and source the fruit trees.

Team: Mr. Garvey, a history graduate, has passionately invested his past 6 years into the world of tropical fruit and south Florida agriculture. He also has extensive experience in the government sector as well as in management and community development in south Florida. He's developed a wealth of networks within the tropical fruit community in south Florida and is nationally recognized for his work with Grimal Grove.

Jeff Stotts is a tropical fruit specialist. He has over 20 years in tropical fruit business and a graduate from the Tropical Research Education Center in Homestead. He has an extensive knowledge of Key West history.

Implementation will be sub-contracted to one of the existing agencies involved.

Grimal Grove is available for on-going consulting and/or managing of the Southernmost Tropical Fruit Park.

In the future, the Grimal Grove's nonprofit entity - the Growing Hope Initiative - has the potential for community engagement for the park as well educational workshops for adults and youth. Growing Hope has created agro-educational initiatives in Monroe and Miami-Dade County.

Property Design: See Map

Design: A Wind break of buttonwoods on the North Side of property. This will reduce wind damage to fruit trees as well as reduced salt spray.

Suggested Fruit Trees: Sapodilla, 3 mangoes(early, mid and late season varieties), mamey sapote, 2 avocados (A and B type), 2 Spanish Lime (1 male and 1 female or 1 hermaphrodite), Tamarind, 2 soursop, 2 sugar apple, barbados cherry, guava, sour orange, key lime, bananas, Key West Grape (vine runs along fence line).

Size and spacing: Our design will also factor the long-term size of the trees. Whenever possible, we will choose smaller varieties and implement growing techniques that will also make easier tree management and reduce risk. Pruning will still be needed but reduced. We recommend keeping trees to 10 – 15 ft height.

The selected location receives the required 6 hours of sunlight for fruit trees. A drip irrigation system is suggested. Frequent irrigation will be needed for all immature trees; frequency of watering will lessen as trees mature. Some mature trees will no longer need watering.

In addition to the fruit tree grove, we propose a "conch style house." The 10 X 16 unit will included a 6 X 10 shed. The remainder of the sloped metal roof will have no walls, and will be used for a shelter for the interactive display, for small workshop and to protect people from the elements. A 10 X 16 shed/interactive display and open walled shelter area. Above ground cisterns will be used to collect rain water, a necessary practice used before the water pipeline came to Key West In the 1950's. This historic replica and interactive display will tell the story of our ancestry's relationship with tropical fruit. The shed portion will store tree, ground maintenance, safety and educational supplies.

(Picture is for visual interpretation; not for actual design.)



Budget

Line Item	Cost
Consulting Hours 60 - 80 @ \$70 per hour Hours include completed approved design, written narrative of history, tree/fruit uses, and botanical information, sourcing trees, delivering trees. Area preparation and planting oversight. Hours vary on additional meetings with city, etc.	\$4,200 - \$5,600
Administration 25 hours @ \$25 per hour	\$625
Tree Cost 15 @ \$250 each (tree costs vary; max for tree is \$250) 3 gal aprx \$50 7 gal aprx \$90 15 gal aprx \$150 25 gal aprx \$250	Max \$3,750
Fruit Tree Delivery \$500	\$500
Total	\$9,075 - \$10,475

Costs do not include "conch house shed", Tools, plaques, Interactive display Center, above ground cistern. Nor does it include buttonwoods for the wind break. Does not include cost for sub-contractor to installation.

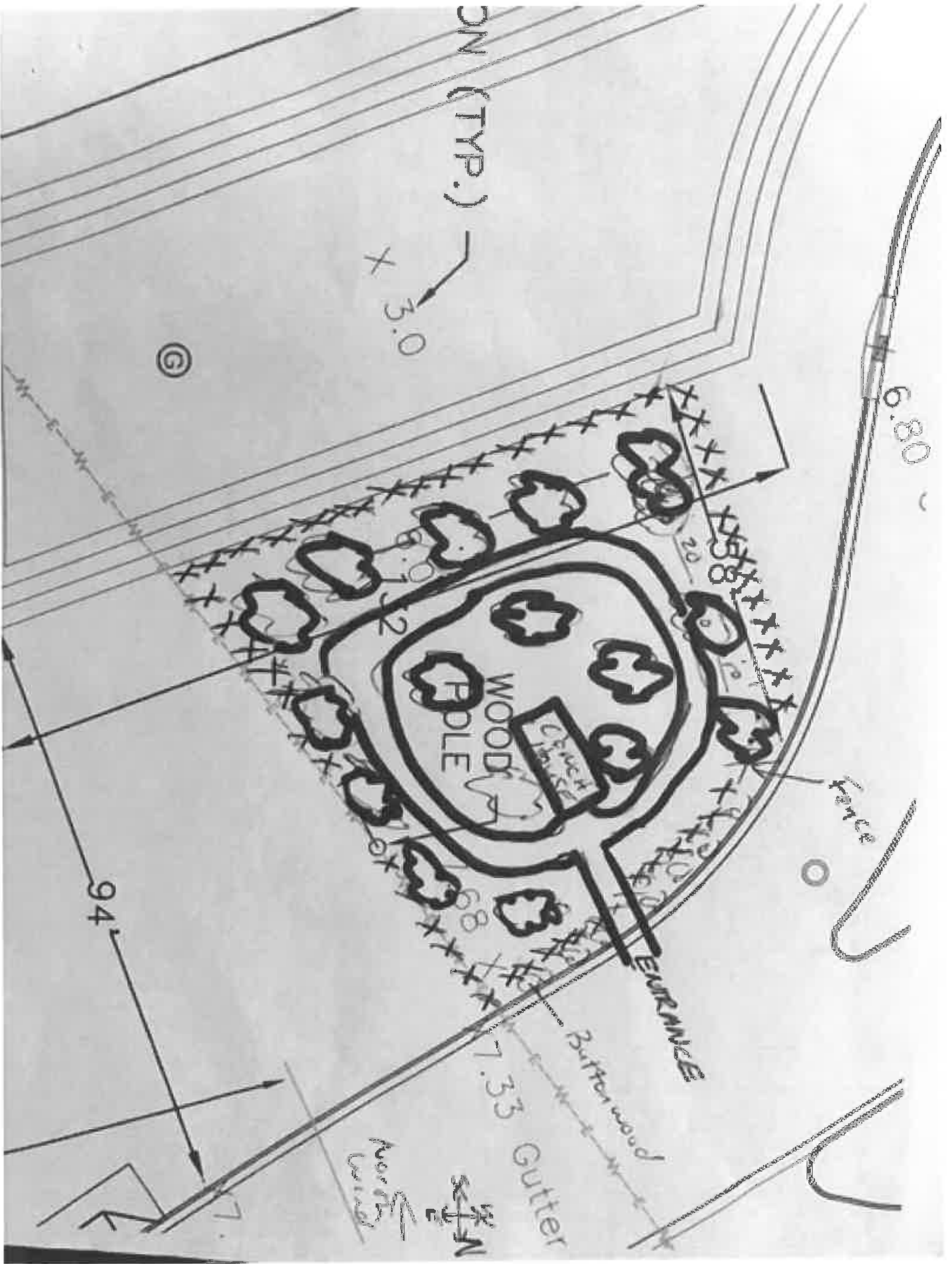

ON (TYP.)

3.0

G

6.80

WOOD
POLE

Covered
house

ENTRANCE

Buffer wood

Gutter

94'

N
S
E
W

North

force

7'

