

STAFF REPORT

DATE: June 1, 2017

RE: **744 Windsor Lane (permit application # T17-8494)**

FROM: Karen DeMaria, City of Key West Urban Forestry Manager

An application was received requesting the removal of **(1) Avocado tree** and **(1) Japanese Fern tree**. A site inspection was done on May 26, 2017 and documented the following:

Tree Species: Avocado (*Persea americana*)





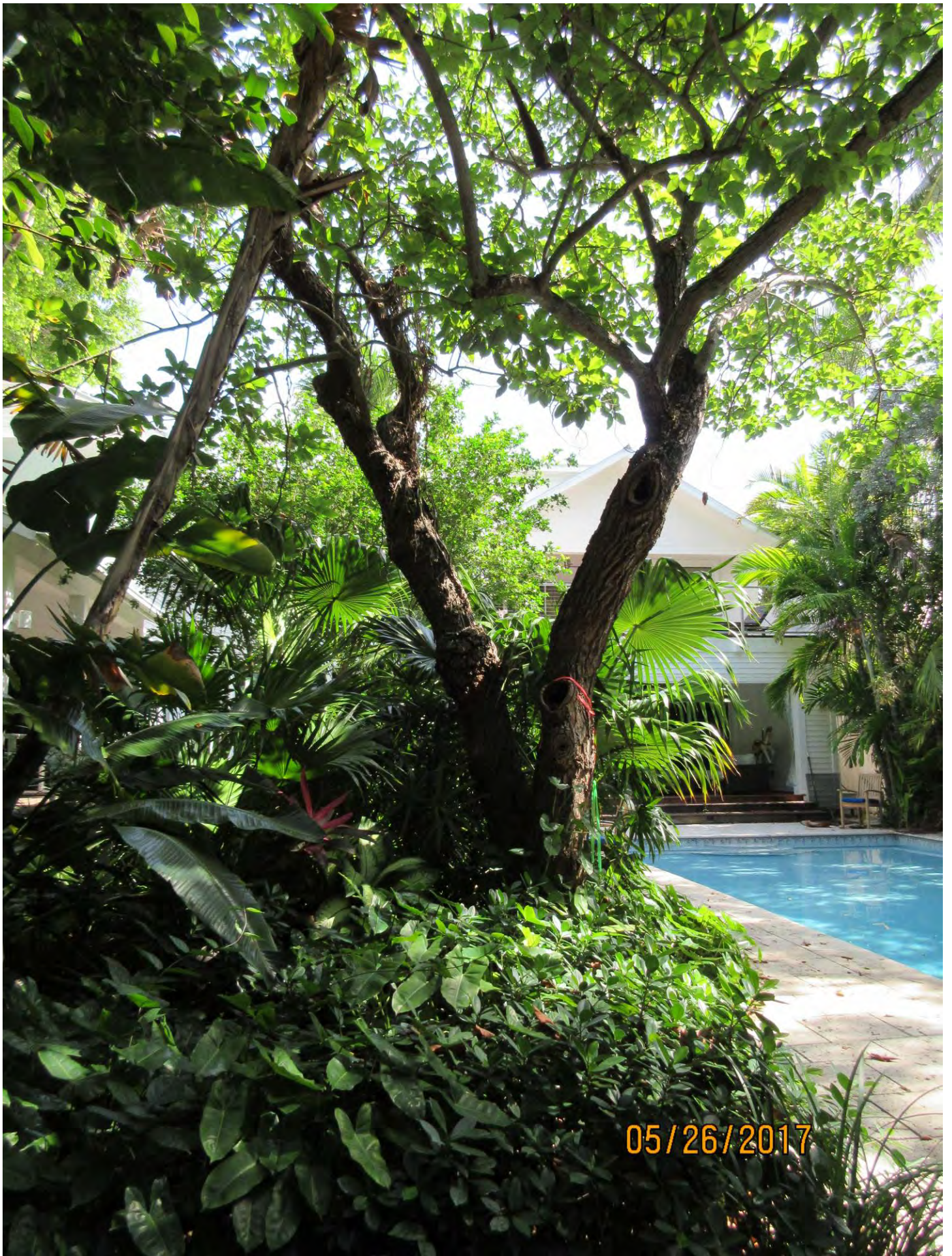





05/26/2017





Diameter: 26"

Location: 80%

Species: 100% (on protected tree list)

Condition: 40% (poor, codominant trunks, major decay in one trunk, gall and lean with decay in branches on other trunk)

Total Average Value = 73%

Value x Diameter = 18.9 replacement caliper inches

Tree Species: Japanese Fern Tree (*Filicium decipiens*)





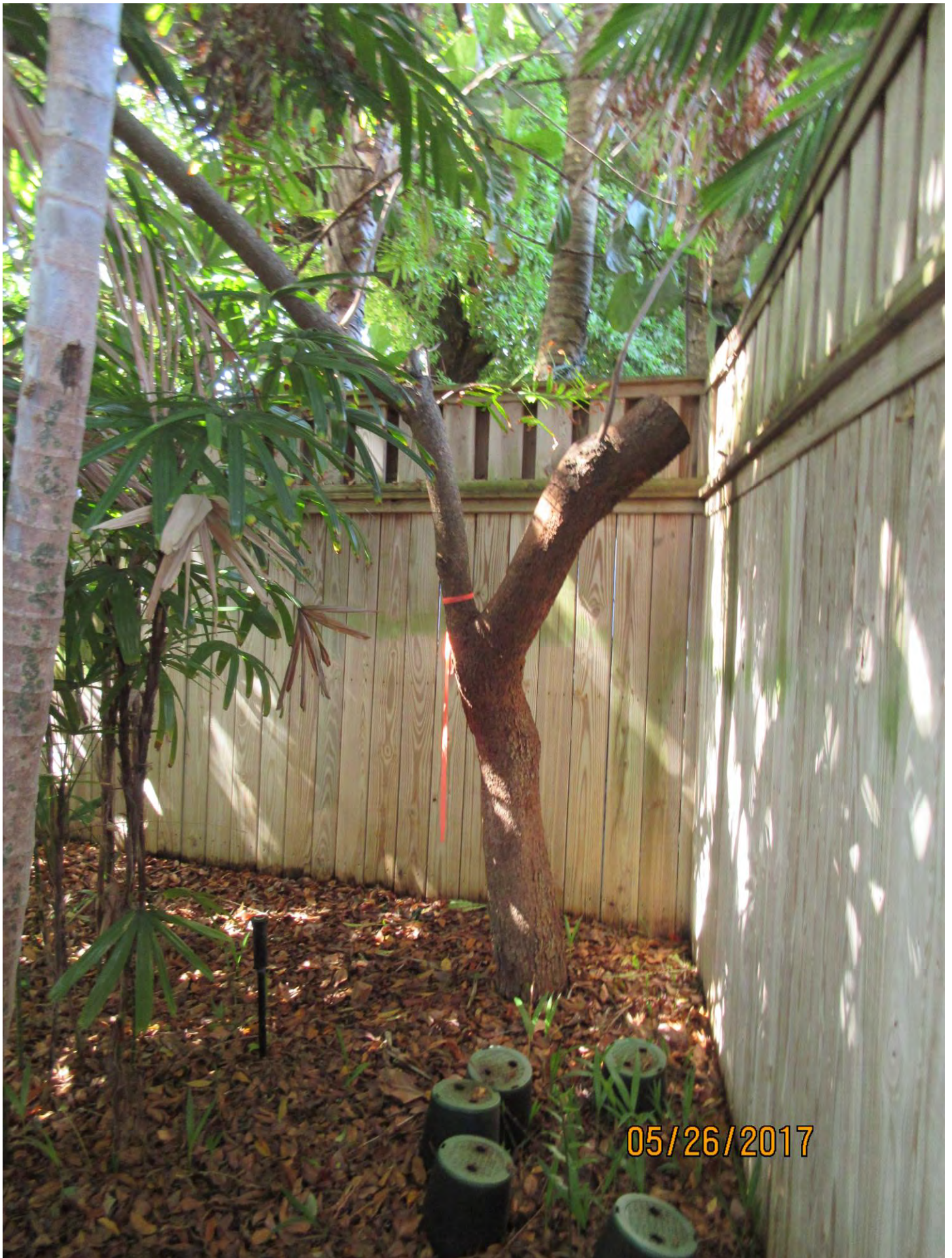

05/26/2017



Diameter: 10"

Location: 70% (one trunk close to fence and property line-cut, tree fighting for light in canopy)

Species: 50% (not on protected or not protected tree list)

Condition: 40% (poor structure)

Total Average Value = 53%

Value x Diameter = 5.3 replacement caliper inches

NOTE: Property is being updated and re-landscaped.

Recommendation: Recommend approval of the removal of one (1) Avocado tree and one (1) Japanese Fern tree at 744 Windsor Lane to be replaced with 24.2 caliper inches of dicot or fruit trees from approved list, FL#1, to be planted on site.

Application



Copy -
Removal

8494

Tree Permit Application

Please Clearly Print All Information unless indicated otherwise.

Date: 5/11/17

Tree Address 744 Windsor Dr
Cross/Corner Street Williams
List Tree Name(s) and Quantity See Attached 1-Avocado 1-Japanese
Species Type(s) check all that apply ☒ Palm () Flowering () Fruit ☒ Shade () Unsure Rem
Reason(s) for Application:

☒ REMOVE () Tree Health () Safety ☒ Other/Explain below
() TRANSPLANT () New Location () Same Property () Other/Explain below
() HEAVY MAINTENANCE () Branch Removal () Crown Cleaning/Thinning () Crown Reduction

Additional Information New Landscape Design
and Explanation

Property Owner Name Chris Mario
Property Owner eMail Address chris@mariofamily.com
Property Owner Mailing Address 744 Windsor Lane
Property Owner Mailing City Key West State FL Zip 33040
Property Owner Phone Number (305) 342-2400
Property Owner Signature [Signature]

Representative Name Shade Tree Inc.
Representative eMail Address shadetreeservices@yahoo.com
Representative Mailing Address P.O. Box 1341
Representative Mailing City Key West State FL Zip 33041
Representative Phone Number (305) 342-8094

NOTE: A Tree Representation Authorization form must accompany this application if someone other than the owner will be representing the owner at a Tree Commission meeting or picking up an Issued Tree Permit.

Tree Representation Authorization form attached ()

<<<<< Sketch location of tree in this area including cross/corner Street >>>>>

Please identify tree(s) with colored tape

All Removals tagged with orange
tape please see attached

Avocado
26" dbh
J. Fern
10" dbh

gate code
5225

If this process requires blocking of a City right-of-way, a separate ROW Permit is required. Please contact 305-809-3740.

Updated: 02/22/2014

Page 1

PA
\$



Tree Representation Authorization

Date: 5/10/17

Attendance at the Tree Commission meeting on the date when your request will be discussed is necessary in order to expedite the resolution of your application. This Tree Representation Authorization form must accompany the application if the property owner is unable to attend or will have someone else pick up the Tree Permit once issued.

Please Clearly Print All Information unless indicated otherwise.

Tree Address 744 Windsor Lane
Mario Revocable Trust
Property Owner Name Chris Mario, trustee
Property Owner eMail Address chrismario@mac.com
Property Owner Mailing Address 744 Windsor Lane
Property Owner Mailing City Key West State FL Zip 33040
Property Owner Phone Number (808) 924-2400
Property Owner Signature Chris Mario

Representative Name Shade Tree Inc.
Representative eMail Address shadetreeservice@yahoo.com
Representative Mailing Address PO Box 1341
Representative Mailing City Key West State FL Zip 33041
Representative Phone Number (305) 340-8094

I Christopher B. Mario, trustee of the Mario Revocable Trust, hereby authorize the above listed agent(s) to represent me in the matter of obtaining a Tree Permit from the City of Key West for my property at the tree address above listed. You may contact me at the telephone listed above is there is any questions or need access to my property.

Property Owner Signature Chris Mario

The forgoing instrument was acknowledged before me on this 15th day May.

By (Print name of Affiant) Christopher B. Mario who is personally known to me or has produced NA as identification and who did take an oath.

NOTARY PUBLIC

Sign Name: Marylou Rowe Notary Public - State of New Jersey Florida (seal)

Print Name: Marylou Rowe

My Commission Expires: 4/30/19

MARYLOU ROWE
NOTARY PUBLIC OF NEW JERSEY
My Commission Expires 4/30/2019

RELOCATION 744 WINDSOR LANE

1 THATCH PALM - #45 RELOCATE, PLEASE SEE ATTACHED PLAN

1 CINNAMON BARK - #57 RELOCATE, PLEASE SEE ATTACHED PLAN

1 ROEBELENII PALM - #62 RELOCATE, PLEASE SEE ATTACHED PLAN

1 CINNAMON BARK - #67 RELOCATE, PLEASE SEE ATTACHED PLAN

1 BUCCANEER PALM - #70 RELOCATE, PLEASE SEE ATTACHED

PLAN

1 ROEBELENII PALM - #73 RELOCATE, PLEASE SEE ATTACHED PLAN

8 LADY PALM - RELOCATE, PLEASE SEE ATTACHED PLAN

2 LADY PALM - RELOCATE, PLEASE SEE ATTACHED PLAN

REMOVAL 744 WINDSOR LANE

1 FICUS BENJAMINA - #39 REMOVE, PLEASE SEE ATTACHED PLAN
2 FISHTAIL PALM - #37 & #38 REMOVE, PLEASE SEE ATTACHED PLAN
4 ARECA PALM(S) - #75, #76, #77, #78 REMOVE, PLEASE SEE ATTACHED PLAN
1 FICUS BENJAMINA - #17 REMOVE, PLEASE SEE ATTACHED PLAN
2 ADONIDA PALM - #18 & #71 REMOVE, PLEASE SEE ATTACHED PLAN
3 QUEEN PALM - #58, #59, #72 REMOVE, PLEASE SEE ATTACHED PLAN
1 ALEXANDER PALM - #60 REMOVE, PLEASE SEE ATTACHED PLAN
4 ARECA PALM(S) - #51, #52, #54, #61 REMOVE, PLEASE SEE ATTACHED PLAN
1 CABADA PALM - #53 REMOVE, PLEASE SEE ATTACHED PLAN
1 PAUROTIS PALM - #55 REMOVE, PLEASE SEE ATTACHED PLAN
1 THATCH PALM - #74 REMOVE, PLEASE SEE ATTACHED PLAN
2 ARECA PALM(S) - #63 & #64 REMOVE, PLEASE SEE ATTACHED PLAN
1 ADONIDA PALM - #65 REMOVE, PLEASE SEE ATTACHED PLAN
1 ALEXANDER PALM - #66 REMOVE, PLEASE SEE ATTACHED PLAN
2 BAMBOO PALM - REMOVE, PLEASE SEE ATTACHED PLAN
1 AVACADO TREE - 49 REMOVE, PLEASE SEE ATTACHED PLAN
1 BIRD OF PARADISE - #79 REMOVE, PLEASE SEE ATTACHED PLAN
1 JAPANESE FERN - #80 REMOVE, PLEASE SEE ATTACHED PLAN
1 FICUS BENJAMINA - #33 REMOVE, PLEASE SEE ATTACHED PLAN
1 SHEFFELERA - #32 REMOVE, PLEASE SEE ATTACHED PLAN

TREE DISPOSITION PLAN

ID	Botanical Name	Common Name	Size	Disposition
TREES & PALMS				
1	Dysox cabadia	Cabada Palm	25' OA	REMAIN
2	Cocos nucifera	Coconut Palm	30' GW	REMAIN
3	Cocos nucifera	Coconut Palm	30' GW	REMAIN
4	Phycosperma macarthurii	Macarthur Palm	Multi-trunked - 15' OA	REMAIN
5	Bismarckia nobilis	Bismarck Palm	16' GW	REMAIN
6	Adonidia merillii	Christmas Palm	Double-trunked - 8' CT	REMAIN
7	Cocos nucifera	Coconut Palm	4' GW	REMAIN
8	Adonidia merillii	Christmas Palm	4-trunked, 18' GW	REMAIN
9	Capparis cynophallophora	Jamaican Caper	3' caliper @ DBH	REMAIN
10	Capparis cynophallophora	Jamaican Caper	6' caliper @ DBH	REMAIN
11	Capparis cynophallophora	Jamaican Caper	8' caliper @ DBH	REMAIN
12	Eugenia foetida	Spanish Stopper	3' caliper @ DBH	REMAIN
13	Thrinax montii	Silver Thatch Palm	4' GW	REMAIN
14	Adonidia merillii	Christmas Palm	7' GW	REMAIN
15	Guadua officinale	Lignum Vitae	5' caliper @ DBH	REMAIN
16	Pseudophoenix sargentii	Buccanier Palm	5' GW	REMAIN
17	Ficus spp.	Ficus	24' caliper @ DBH	REMAIN
18	Adonidia merillii	Christmas Palm	Double-trunked - 20' GW	REMAIN
19	Adonidia merillii	Christmas Palm	12' GW	REMAIN
20	Adonidia merillii	Christmas Palm	10' GW	REMAIN
21	Adonidia merillii	Christmas Palm	10' GW	REMAIN
22	Adonidia merillii	Christmas Palm	Double-trunked - 16' GW	REMAIN
23	Thrinax radiata	Green Thatch Palm	5' OA	REMAIN
24	Adonidia merillii	Christmas Palm	Double-trunked - 16' GW	REMAIN
25	Phycosperma elegans	Alexander Palm	Double-trunked - 18' GW	REMAIN
26	Phycosperma macarthurii	Macarthur Palm	Multi-trunked - 14' OA	REMAIN
27	Bucida buceras	Black Olive	20' caliper @ DBH	REMAIN
28	Adonidia merillii	Christmas Palm	7' GW	REMAIN
29	Ligustrum japonicum	Ligustrum	6' caliper @ DBH	REMAIN
30	Phycosperma elegans	Alexander Palm	Multi-trunked - 12' GW	REMAIN
31	Phycosperma elegans	Alexander Palm	18' GW	REMAIN
32	Schefflera arboricola	Umbrella Tree	24' caliper @ DBH	REMAIN
33	Ficus spp.	Ficus	30' caliper @ DBH	REMAIN
34	Phycosperma macarthurii	Macarthur Palm	Multi-trunked - 12' OA	REMAIN
35	Wodyetia bilucata	Foxtail Palm	20' GW	REMAIN
36	Phycosperma macarthurii	Macarthur Palm	Multi-trunked - 16' OA	REMAIN
37	Caryota mitis	Fishtail Palm	Multi-trunked - 14' GW	REMAIN
38	Caryota mitis	Fishtail Palm	Multi-trunked - 12' GW	REMAIN
39	Ficus spp.	Ficus	36' caliper @ DBH	REMAIN
40	Phycosperma elegans	Alexander Palm	12' GW	REMAIN
41	Phycosperma elegans	Alexander Palm	Double-trunked - 12' GW	REMAIN
42	Phycosperma elegans	Alexander Palm	Triple-trunked - 12' GW	REMAIN
43	Thrinax radiata	Green Thatch Palm	Multi-trunked - 6' OA	REMAIN
44	Persea americana	Avocado	26' caliper @ DBH	REMAIN
45	Thrinax radiata	Green Thatch Palm	8' OA	RELOCATE
46	Thrinax radiata	Green Thatch Palm	10' OA	REMAIN
47	Murraya exaltata	Orange Jasmine	10' caliper @ DBH	REMAIN
48	Coccothrinax crinita	Old Man Palm	10' CT	REMAIN
49	Adonidia merillii	Christmas Palm	18' GW	REMAIN
50	Eugenia foetida	Spanish Stopper	4' caliper @ DBH	REMAIN
51	Dysox lutescens	Areca Palm	20' OA	REMAIN
52	Dysox lutescens	Areca Palm	25' OA	REMAIN
53	Dysox cabadae	Cabada Palm	20' OA	REMAIN
54	Dysox lutescens	Areca Palm	25' OA	REMAIN
55	Acrocalymma wrightii	Parrot Palm	Multi-trunked - 15' OA	REMAIN
56	Utility Pole	Not A Plant		REMAIN
57	Canele winteriana	Cinnamon Bark	4' caliper @ DBH - 18' OA	RELOCATE
58	Syagrus romanzoffiana	Queen Palm	20' GW	REMAIN
59	Syagrus romanzoffiana	Queen Palm	20' GW	REMAIN
60	Phycosperma elegans	Alexander Palm	Multi-trunked - 20' OA	REMAIN
61	Dysox lutescens	Areca Palm	20' OA	REMAIN
62	Phoenix roebelenii	Roebelenii Palm	7' GW	RELOCATE
63	Dysox lutescens	Areca Palm	20' OA	REMAIN
64	Dysox lutescens	Areca Palm	20' OA	REMAIN
65	Adonidia merillii	Christmas Palm	Triple-trunked - 20' GW	REMAIN
66	Phycosperma elegans	Alexander Palm	Double-trunked - 25' OA	REMAIN
67	Canele winteriana	Cinnamon Bark	2.5' caliper @ DBH	RELOCATE
68	Phycosperma elegans	Alexander Palm	Double-trunked - 20' GW	REMAIN
69	Phycosperma elegans	Alexander Palm	Triple-trunked - 20' GW	REMAIN
70	Pseudophoenix sargentii	Buccanier Palm	6' GW	RELOCATE
71	Adonidia merillii	Christmas Palm	Double-trunked - 20' GW	REMAIN
72	Syagrus romanzoffiana	Queen Palm	18' GW	REMAIN
73	Phoenix roebelenii	Roebelenii Palm	7' GW	RELOCATE
74	Thrinax radiata	Green Thatch Palm	5' OA	REMAIN
75	Dysox lutescens	Areca Palm	18' OA	REMAIN
76	Dysox lutescens	Areca Palm	20' OA	REMAIN
77	Dysox lutescens	Areca Palm	20' OA	REMAIN
78	Dysox lutescens	Areca Palm	20' OA	REMAIN
79	Streptocarpus	Giant Bird of Paradise	25' OA	REMAIN
80	Felicium decipiens	Japanese Fern Tree	10' caliper @ DBH	REMAIN

benjamin
NPR

NPR
benjamin
NPR

NPR
NPR

NPR
NPR
NPR

NPR
NPR

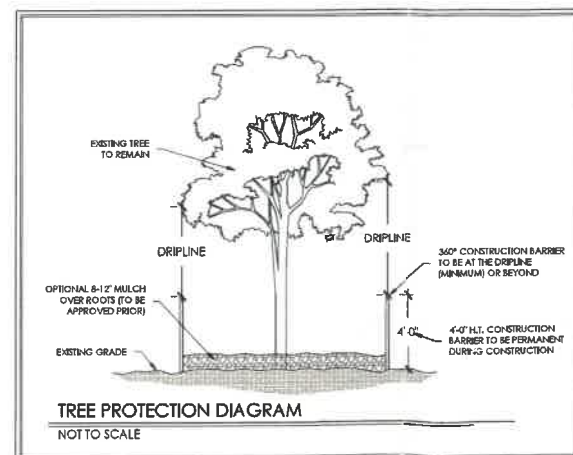
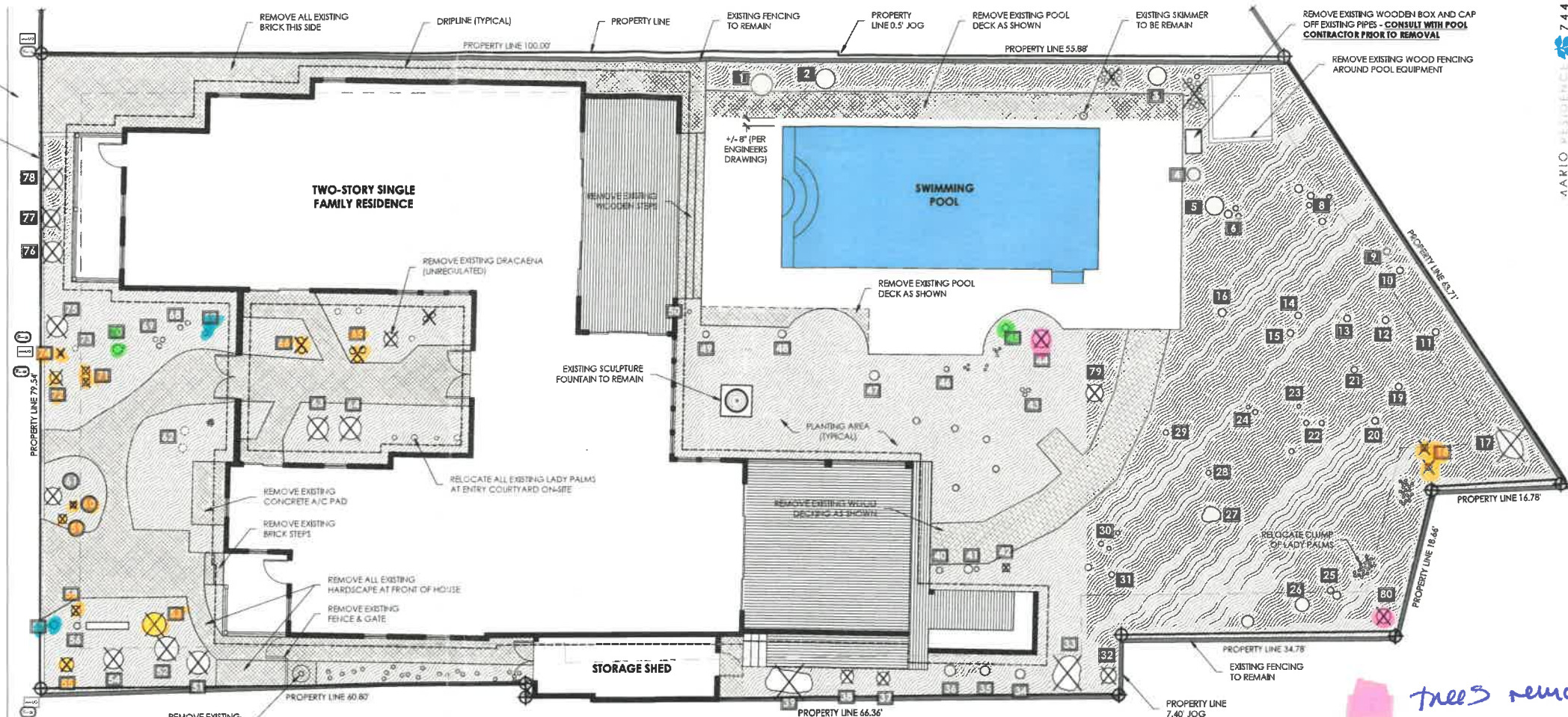

NOTE: GENERAL CONTRACTOR TO COORDINATE ALL TREE REMOVALS & RELOCATIONS WITH QUALIFIED LANDSCAPE CONTRACTOR OR ARBORIST AS WELL AS COORDINATION WITH CITY AND TREE COMMISSION OFFICIALS. **NO EXCEPTIONS.**

NOTE: CONTRACTOR TO CONFIRM ALL JURISDICTIONAL APPROVALS ARE IN PLACE BEFORE PROCEEDING WITH ANY SITE WORK. **NO EXCEPTIONS.**

NOTE: COMPARE & CONFIRM ALL DEMOLITION WITH PROPOSED LAYOUT PLANS - SHEET LC-3. **NO EXCEPTIONS.**

DEMOLITION LEGEND	
	EXISTING TREE/PALM/SHRUB TO BE REMOVED
	EXISTING TREE/PALM/SHRUB TO REMAIN
	EXISTING TREE/PALM/SHRUB TO BE RELOCATED ON-SITE
	EXISTING WOOD/SYNTHETIC DECKING TO BE REMOVED
	EXISTING HARDSCAPE TO BE REMOVED
	OPEN SPACE / PLANTING AREAS

tree's removal
Tree Transplant
palm's removal
palm transplant