

Sign No.	Type	Msg.	Notes
1	B	(up arrow) Historic Seaport Restaurants & Bars Shopping Plaza 2 Elizabeth Street Public Restrooms (symbols) Ferry Terminal	Single-face Ver. Loc.
2 (omit)			
3	A	2 (Directory Map)	Double-face
4. (omit)			
5	B	(side a): (up arrow) Historic Seaport Restaurants & Bars Shopping Public Restrooms (symbols) Plaza 3 William Street Ferry Terminal (side b): (up arrow) Historic Seaport Restaurants & Bars Shopping Plaza 2 Elizabeth Street	Double-face Ver. Loc.
6	C	(side a): (up arrow) (M/F/HC symbols) Plaza 3 William Street Public Restrooms (side b): (up arrow) (Historic Seaport logo) Plaza 2 Elizabeth Street	Double-face Ver. Loc.

7	C	(side a): (up arrow) (M/F/HC symbols) Plaza 4 Margaret Street	Single-face Ver. Loc.
8	A	3 (Directory Map)	Double-face
9	B	(side a): (right arrow) (M/F/HC symbols) (up arrow) Historic Seaport Restaurants & Bars Shopping Plaza 4 Margaret Street Ferry Terminal (side b): (left arrow) Public Restrooms (M/F/HC symbols)	Double-face Ver. Loc.

10	C	(side a): (up arrow) Caroline Street Parking Lot (side b): (up arrow) (Historic Seaport logo) Plaza 3	Double-face Ver. Loc.
11	D	(sides a & b): (P symbol) LOT 2	Double-face
12	C	(side a): (up arrow) (Historic Seaport logo) Plaza 5 Grinnell Street (side b): (M/F/HC symbols)	Double-face Ver. Loc.
13	A	4 (Directory Map)	Double-face
14	C	(side a): (up arrow) (Historic Seaport logo) Plaza 5 Grinnell Street (side b): (up arrow) (symbols) Plaza 4 Margaret Street	Double-face Ver. Loc.

15	A	5 (Directory Map)	Double-face
16	D	(sides a & b): (P symbol) LOT 4	Double-face
17 - 18 (omit)			
19	D	(side a): (P symbol) LOT 1	Single-face
20 (omit)			
21	D	(sides a & b): (P symbol) LOT 1	Double-face
22	D	(sides a & b): (P symbol) LOT 1	Double-face
23	D	(sides a & b): (P symbol) LOT 3	Double-face
24	D	(sides a & b): (P symbol) LOT 5	Double-face (adjacent panels)

Sign Types

A - Plaza ID Marker & Directory

B - Large Trail Blazer Directional

C - Small Trail Blazer RR Directional

D - Parking Directional/ID

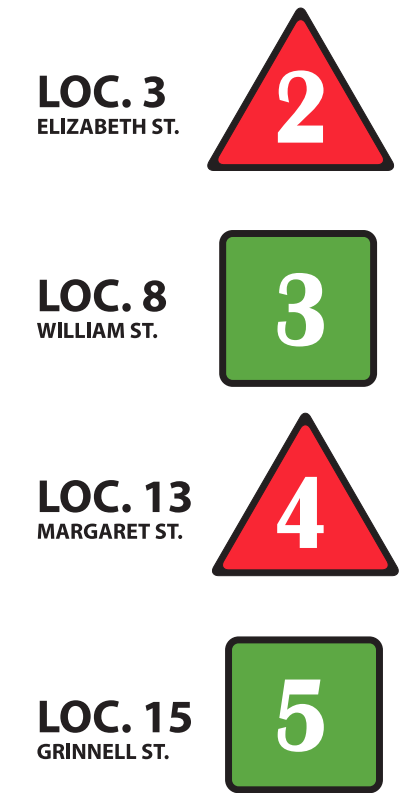
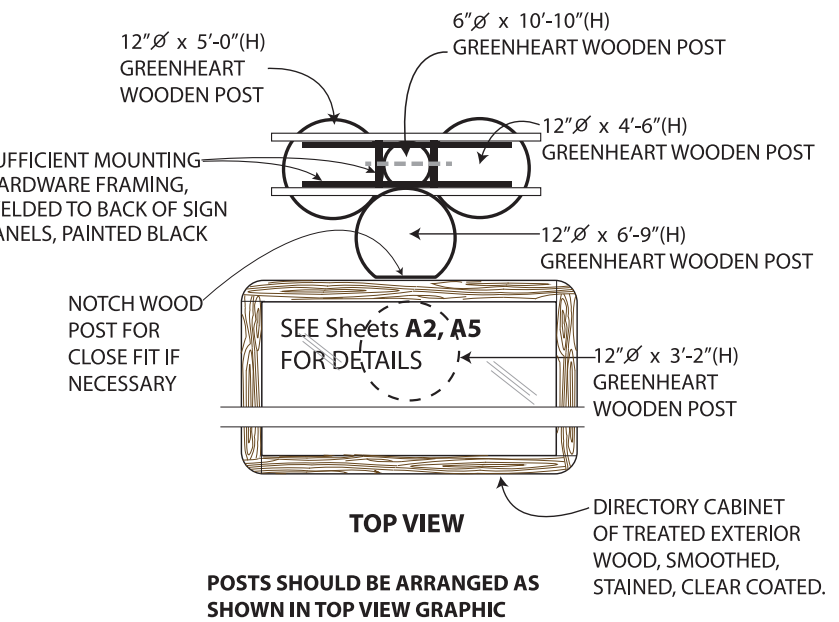

FONT USED: BRITANNIC BOLD

COLOR CODING

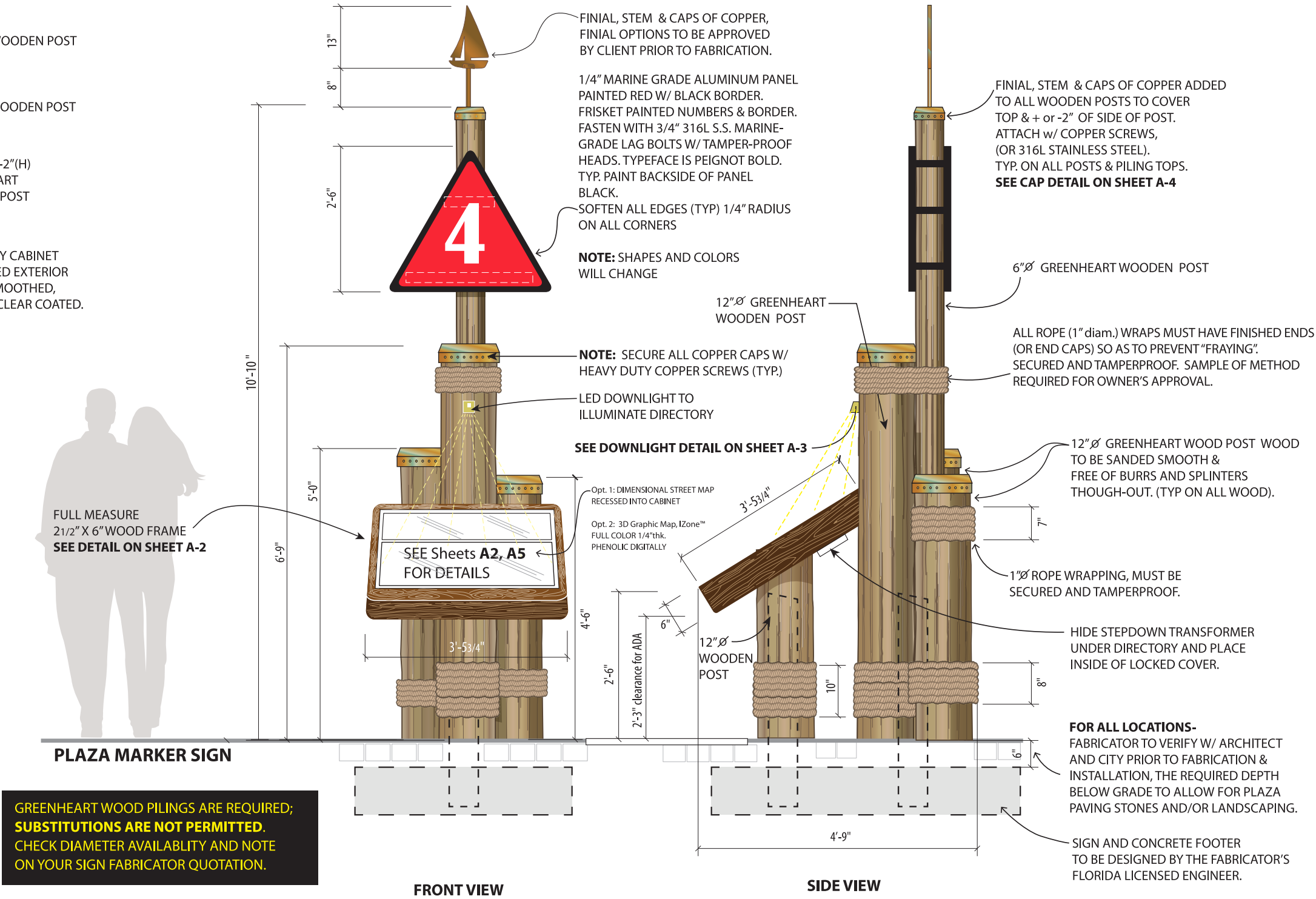

OPTION 1 - NATURAL FINISH THE PREFERRED FINISH OPTION. SELECT WOOD ACCORDINGLY.

OPTION 2 - SATIN TRANSPARENT STAIN FOR WOOD T.B.D.

SIGN TYPE **A**

3'-5 3/4" x 3'-5 3/4"

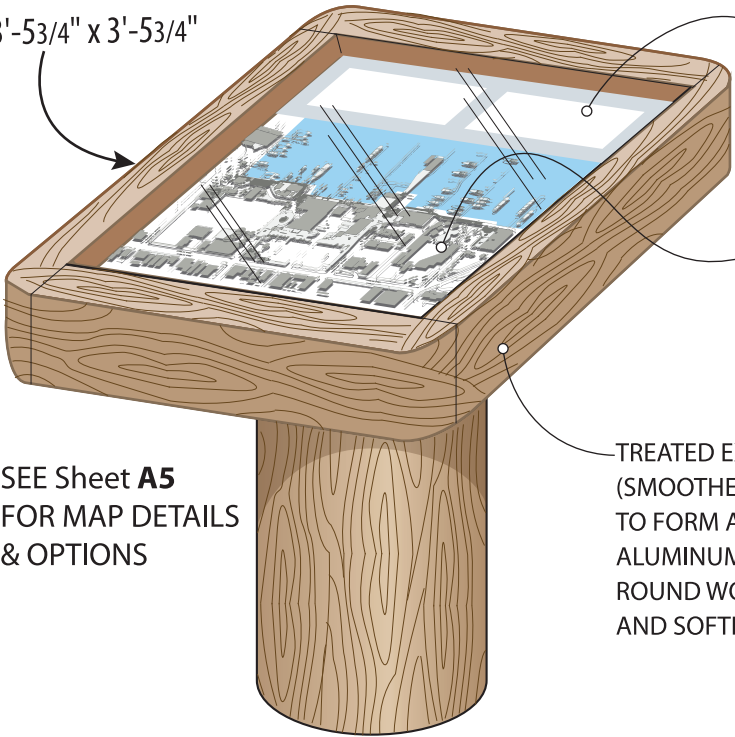

SEE Sheet **A5**
FOR MAP DETAILS
& OPTIONS

FRONT VIEW
CONCEPTUAL

IZone™ / FULL COLOR
1/4" thk. PHENOLIC DIGITALLY
DIRECTORY LISTING OF SEAPORT
DESTINATIONS. (SCREWED FROM
BACK AS SHOWN IN DETAIL)

Opt. 1: DIMENSIONAL STREET MAP
RECESSED INTO CABINET

Opt. 2: 3D Graphic Map, IZone™
FULL COLOR 1/4" thk. PHENOLIC
DIGITALLY

TREATED EXTERIOR WOOD FRAME
(SMOOTHED, STAINED, CLEAR COATED)
TO FORM A CLOSED CABINET WITH
ALUMINUM SUB-SURFACE BACKPANEL.
ROUND WOOD CORNERS w/ 1" RADIUS
AND SOFTEN ALL EDGES.

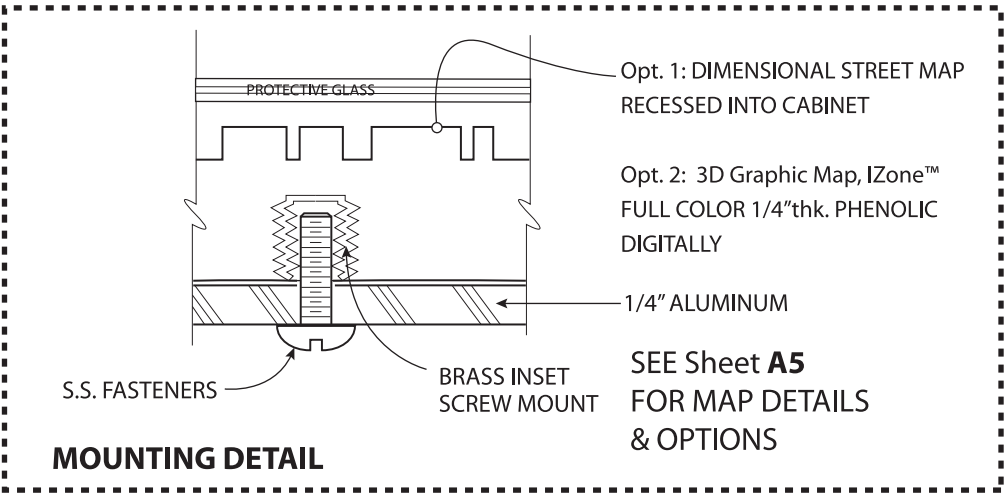

OPTION 1 - NATURAL FINISH THE PREFERRED
FINISH OPTION. SELECT WOOD ACCORDINGLY.
OPTION 2 - SATIN TRANSPARENT STAIN FOR
WOOD T.B.D.

PROTECTIVE CLEAR GLASS, SHATTERPROOF
WITH GASKETS/SEALS TO PREVENT WATER
PENETRATION. GLASS MUST BE REMOVABLE,
BUT TAMPERPROOF, FOR ACCESS & CHANGE-
ABILITY OF DIRECTORY INFO. PANELS. SHOP
DRAWINGS REQUIRED BY SIGN CONTRACTOR,
FOR APPROVAL BY THE CITY, PRIOR TO
FABRICATION OF UNIT.

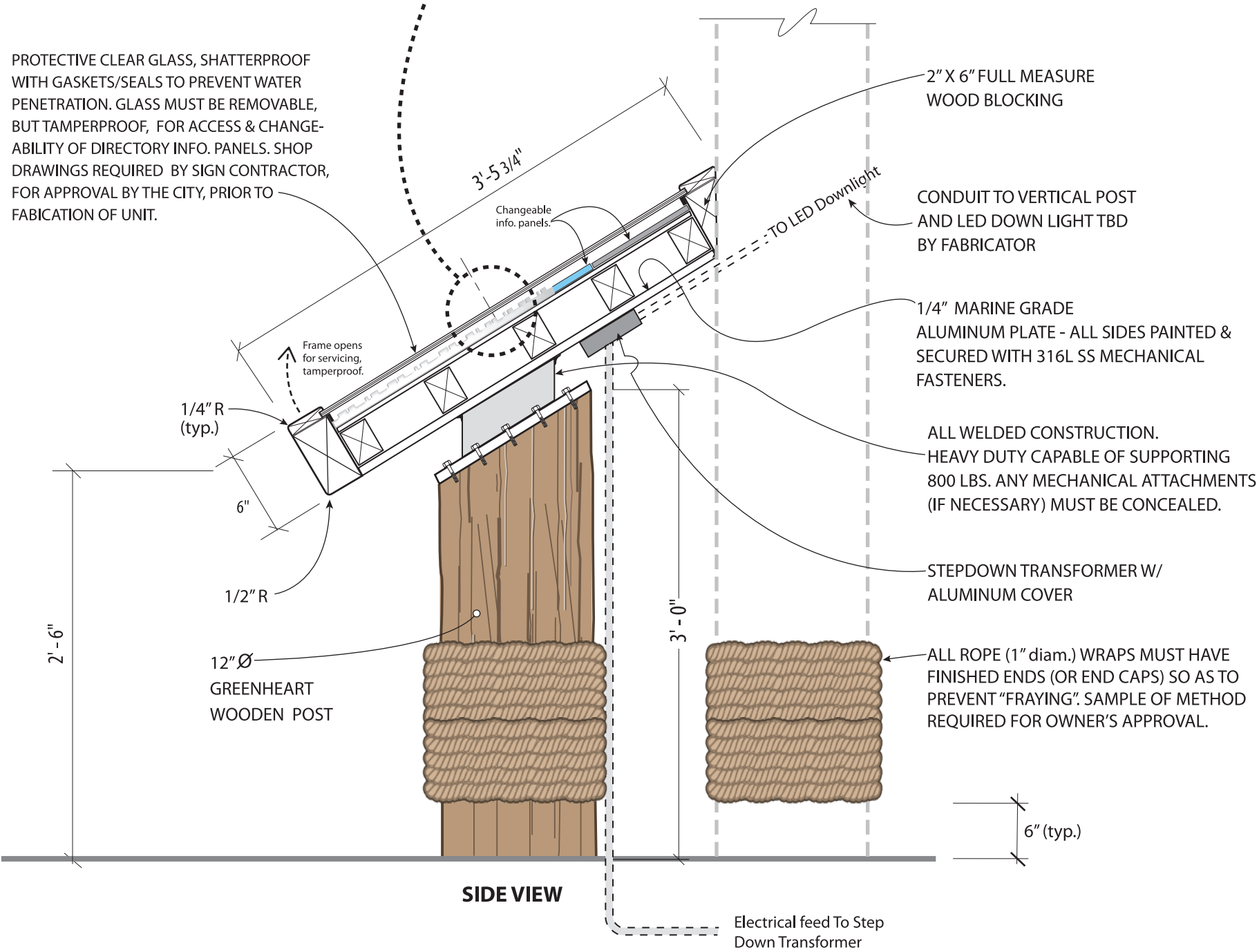

SIDE VIEW

GREENHEART WOOD PILINGS ARE REQUIRED;
SUBSTITUTIONS ARE NOT PERMITTED.
CHECK DIAMETER AVAILABILITY AND NOTE
ON YOUR SIGN FABRICATOR QUOTATION.

LED Wall Lights

ORDERING INFORMATION

LED



The MO offers the frosted glow of the PO in a larger 3LED for more light output and is the only 20 watt equivalent wall light compatible with the Luxor® system. Four interchangeable faceplates provide versatility, including use as a walkway light and recessed-style can light.

Cascade Lighting - Exterior Waterproof Down Light

MO-WW-BS - 20W 3 LED (2700k -12V

MO: Wall Lights

NUMBER OF LEDS:	1	3
HALOGEN LUMEN OUTPUT EQUIVALENT:	10 Watt	20 Watt
USEFUL LED LIFE (L70):	50,000 hrs avg	50,000 hrs avg
INPUT VOLTAGE:	10 to 15V	10 to 15V
VA TOTAL: (Use this number to size the transformer)	2.4	4.5
WATTS USED:	2.0	4.2
LUMENS PER WATT (EFFICACY):		
RD	18.38	20.84
SQ	17.64	20.36
ST	35.20	42.93
WW	6.28	8.15
MAX LUMENS:		
RD	35.80	83.50
SQ	34.10	81.70
ST	68.10	169.44
WW	12.90	33.20
CRI (Ra):	81.80	81.50

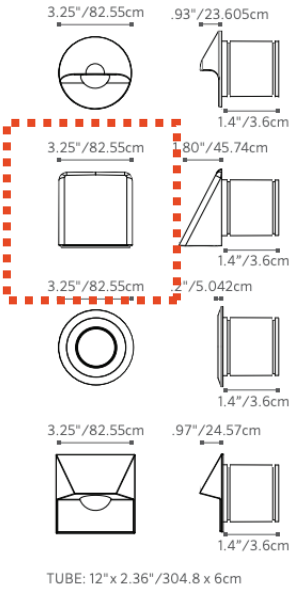

MO: Wall Lights

FACTORY INSTALLED OPTIONS: Order 1 + 2 (optional) + 3 + 4 + 5

Step	Description	Code
1	FIXTURE	MO
2		
3	LAMP	3LED (50,000 avg. life hours)
4	FACEPLATE	WW (Wall Wash),
5	FINISH	AB*, AT*, NP*, BS, WG, FW, AL, BZ, DG, WI, VF, SB, FB

EXAMPLE: MO-ZD-1LED-RD-BZ = MO - ZD Option - 1LED Board - Round Faceplate - Bronze Metallic Finish

PHOTOMETRICS:

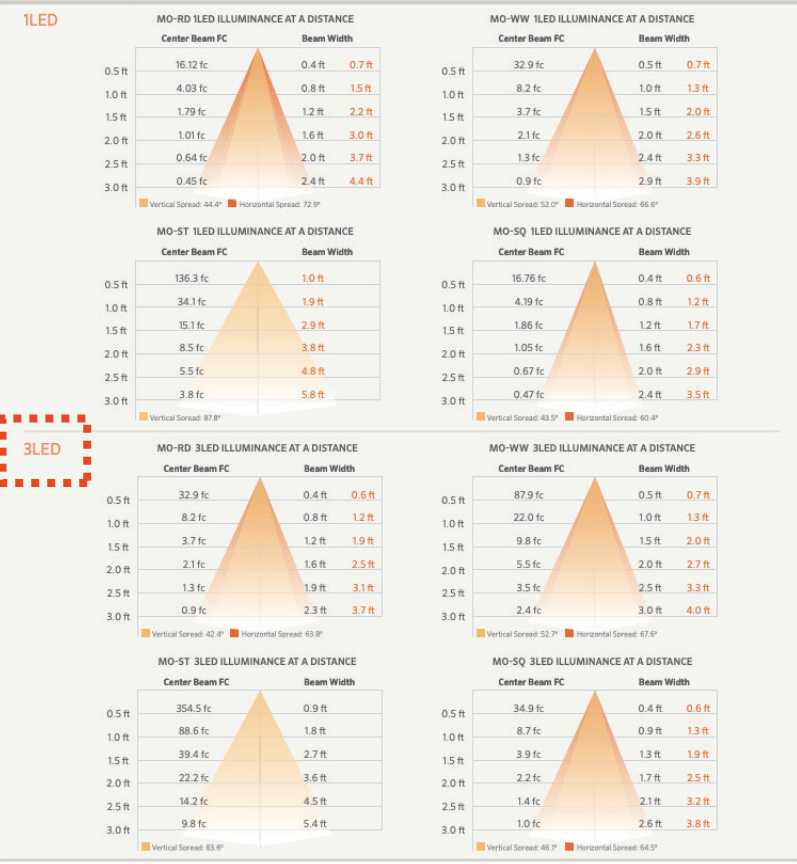

NOTE: THIS IS A SOLE SOURCE ITEM.
NO SUBSTITUTIONS WITHOUT CITY AND
ARCHITECT APPROVAL OF A SUBSTITUTION.

METALS

	AB = Antique Bronze* (On Brass)
	AT = Antique Tumbled* (On Brass)
	NP = Nickel Plate*
	BS = Natural Brass

POWDER COAT

	WG = White Gloss
	FW = Flat White
	AL = Almond
	SV = Silver
	BZ = Bronze Metallic
	DG = Desert Granite
	WI = Weathered Iron
	VF = Verde Speckle
	SB = Sedona Brown
	FB = Flat Black

All MO wall lights come standard with amber, blue, and green filters

The MO includes a mounting conduit, 9 ft lead wire, and choice of LED board and faceplate finish.

* May require longer lead time

Photometric Charts: Beam angle is calculated using LM-79 method for SSL Luminaires. Beam angle is defined as two times the vertical angle at which the intensity is 50% of the maximum.



Learn more about FX Luminaire wall lights. Visit fxl.com

760.744.5240 | fxl.com

760.744.5240 | fxl.com FXLIT-188_SS_MO 11/14

FXLuminaire®

SIGN TYPE
A

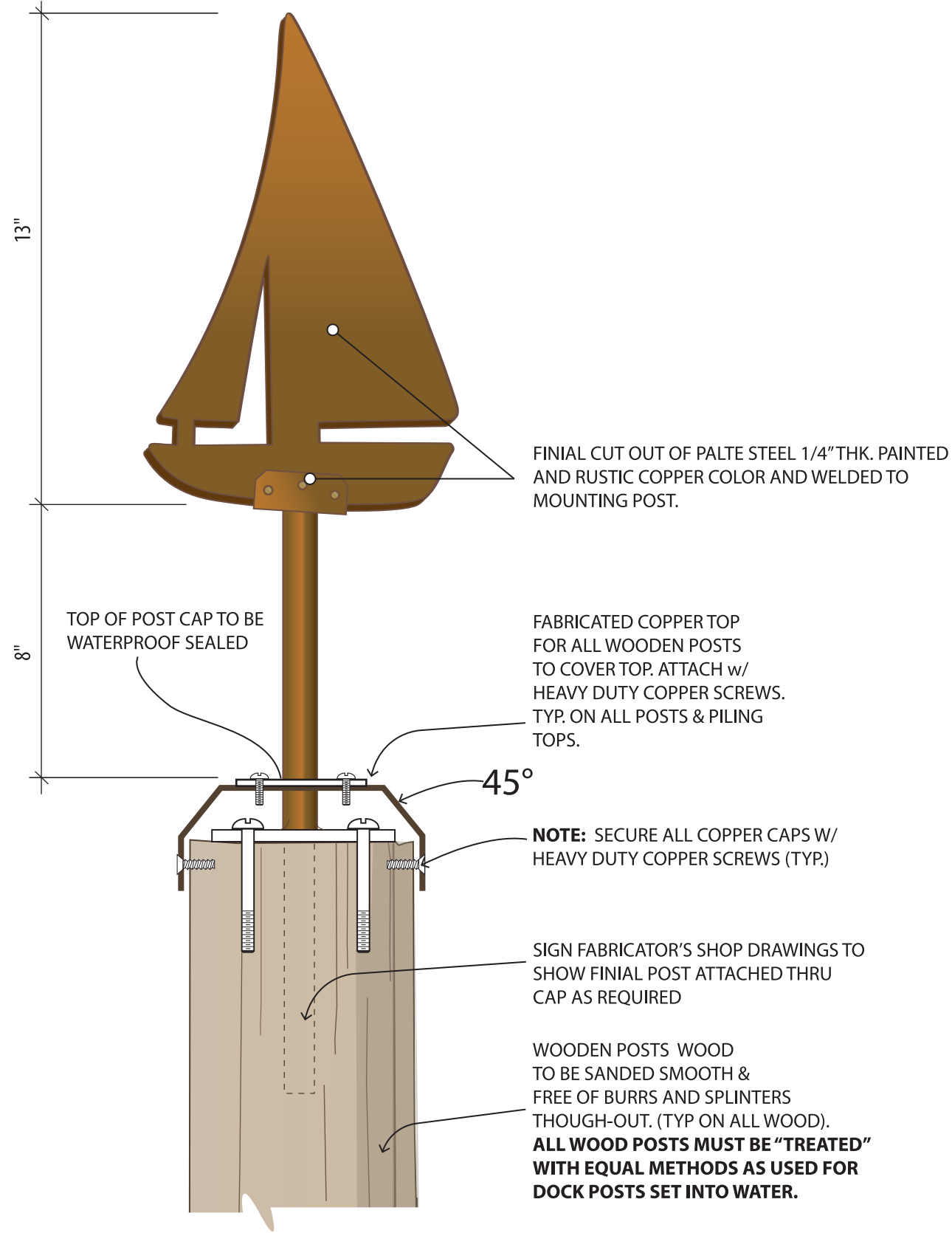

CUSTOM FINIAL OPTION 1
SAILBOAT

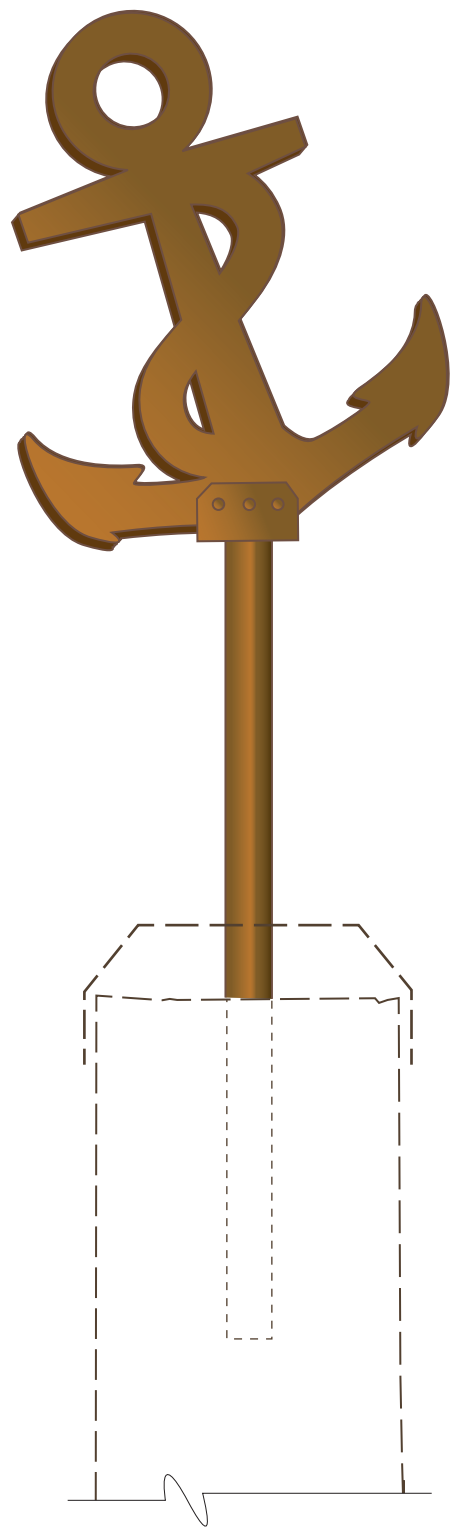

CUSTOM FINIAL OPTION 2
ANCHOR

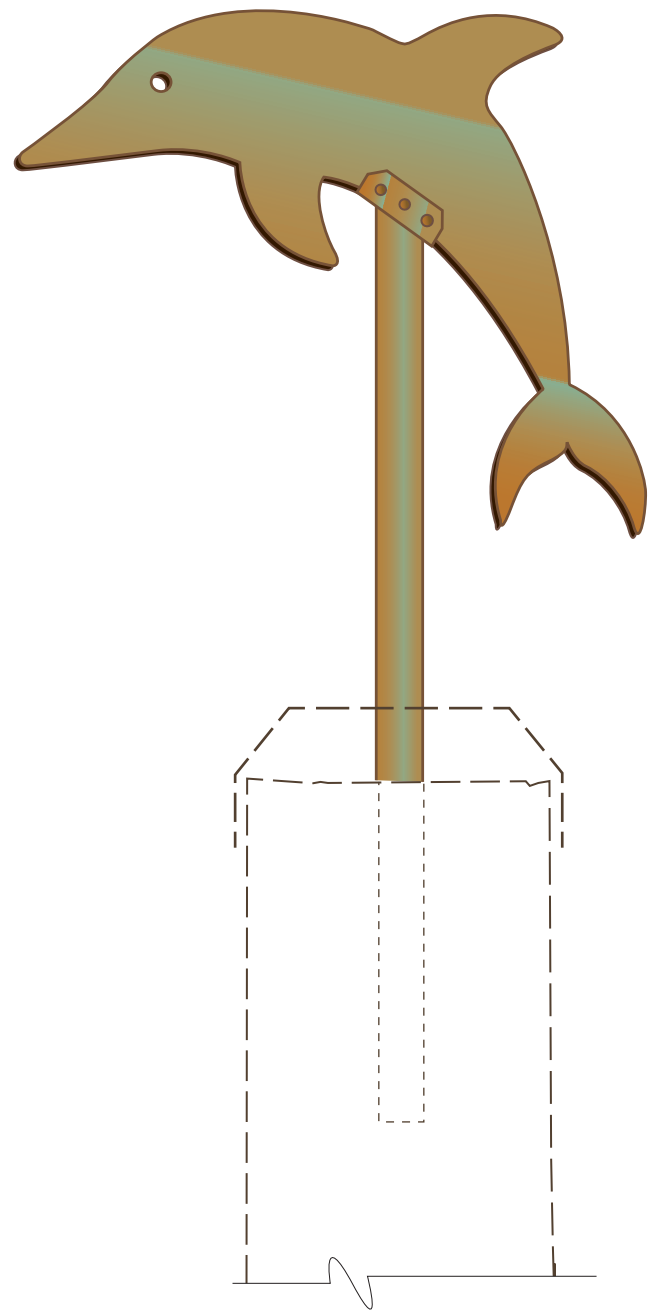

CUSTOM FINIAL OPTION 3
DOLPHIN

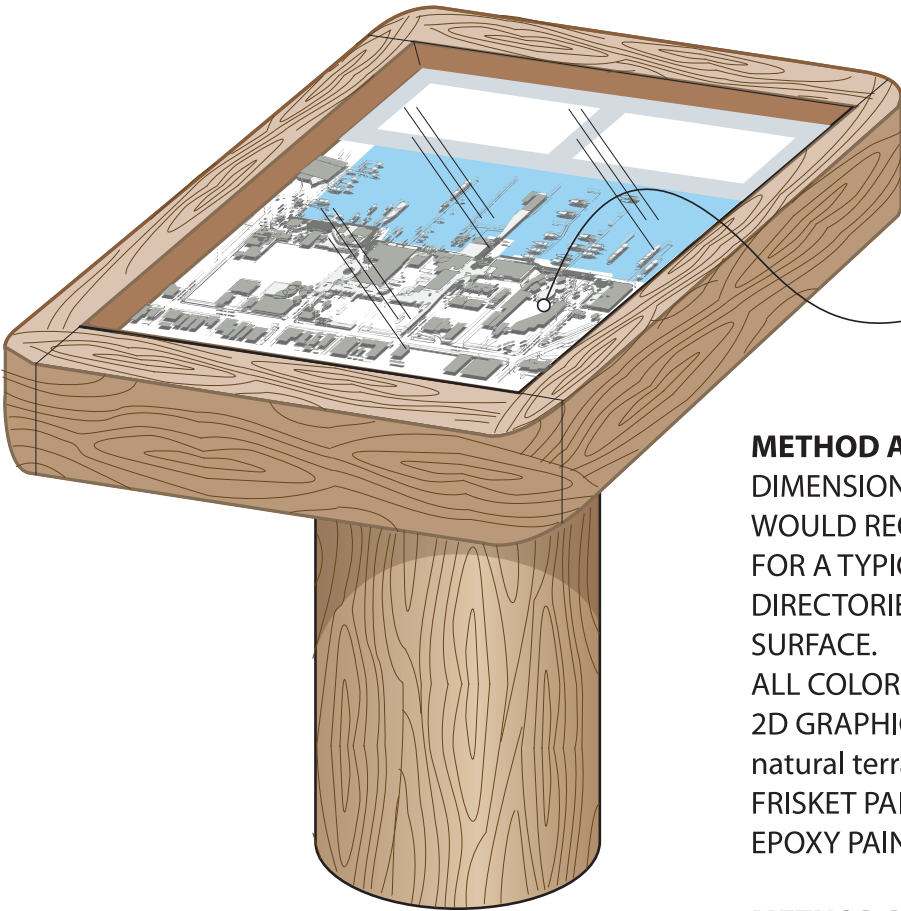

OPTION A
DIMENSIONAL STREET MAP
CONCEPTUAL VIEW

Opt. 1:
DIMENSIONAL STREET MAP
RECESSED INTO CABINET

METHOD A option:
DIMENSIONAL STREET MAP, MULTI-COLOR,
WOULD REQUIRE 3D PRINTING OR SCULPTING
FOR A TYPICAL MOLD TO ALLOW FOR QTY. 4
DIRECTORIES FINISHED WITH FIBERGLAS
SURFACE.
ALL COLORS OF DIMENSIONAL ELEMENTS AND
2D GRAPHICS (roads, pavements, labels, water,
natural terrain) MUST BE HAND-PAINTED or
FRISKET PAINTED WITH DURABLE EXTERIOR
EPOXY PAINTS.

METHOD B option:
DIMENSIONAL STREET MAP MADE FROM
MOLD-FORMED RESIN WITH “LUMINORE”
METALLIC LOOK, WOULD REQUIRE 3D PRINT-
ING OR SCULPTING FOR A TYPICAL MOLD TO
ALLOW FOR QTY. 4. FINISHES COULD BE
PEWTER, STEEL, BRASS, BRONZE.

PROTECTIVE CLEAR GLASS, SHATTERPROOF WITH
GASKETS/SEALS TO PREVENT WATER PENETRATION. GLASS
MUST BE REMOVABLE, BUT TAMPERPROOF, FOR ACCESS &
CHANGEABILITY OF DIRECTORY INFO. PANELS. SHOP
DRAWINGS REQUIRED BY SIGN CONTRACTOR, FOR
APPROVAL BY THE CITY, PRIOR TO FABICATION OF UNIT.

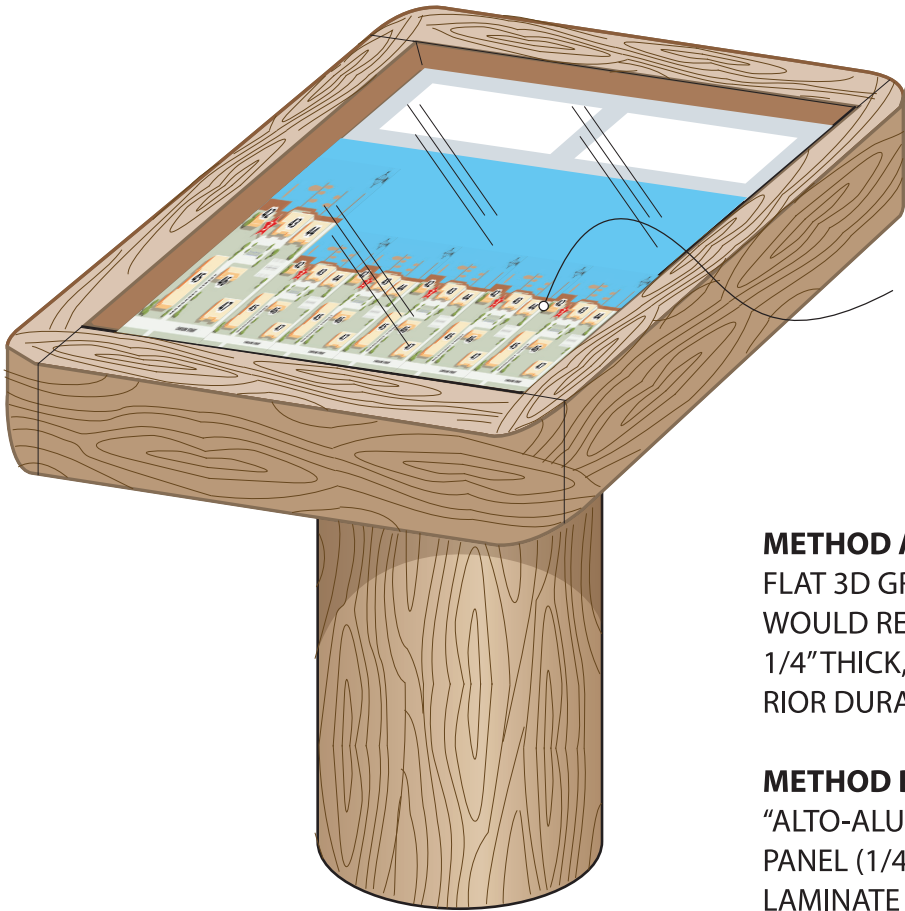

Opt. 2:
3D Graphic Map, IZone™
FULL COLOR 1/4”THK. PHENOLIC
DIGITALLY

METHOD A option:
FLAT 3D GRAPHIC STREET MAP, MULTI-COLOR,
WOULD REQUIRE DIGITAL PRINTING FOR QTY. 4,
1/4”THICK, EMBEDDED PHENOLIC RESIN. EXTE-
RIOR DURABILITY REQUIRED.

METHOD B option:
“ALTO-ALUMINUM” (www.altoaluminum.com/)
PANEL (1/4”THK.) or FOLIA, HIGH PRESSURE
LAMINATE GRAPHICS.

OPTION B
3D GRAPHIC STREET MAP
CONCEPTUAL VIEW

SIGN TYPE **B**

GREENHEART WOOD PILINGS ARE REQUIRED;
SUBSTITUTIONS ARE NOT PERMITTED.
CHECK DIAMETER AVAILABILITY AND NOTE
ON YOUR SIGN FABRICATOR QUOTATION.

OPTION 1 - NATURAL FINISH THE PREFERRED
FINISH OPTION. SELECT WOOD ACCORDINGLY.
OPTION 2 - SATIN TRANSPARENT STAIN FOR
WOOD T.B.D.

NOTE:
SEE SIGN LOCATION PLAN & MES-
SAGE SCHEDULE FOR EXACT LOCA-
TIONS & MESSAGES, SHEET A.0.2.

SEE SHEET B.1 FOR EXACT
GRAPHIC LAYOUTS.

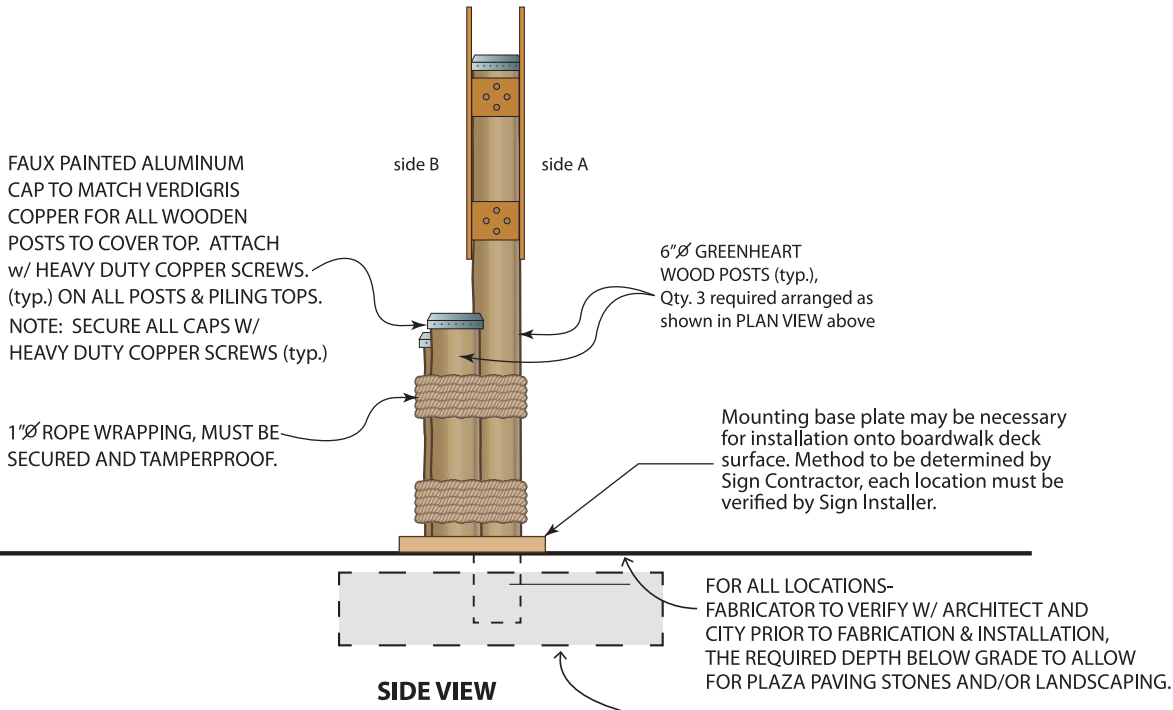
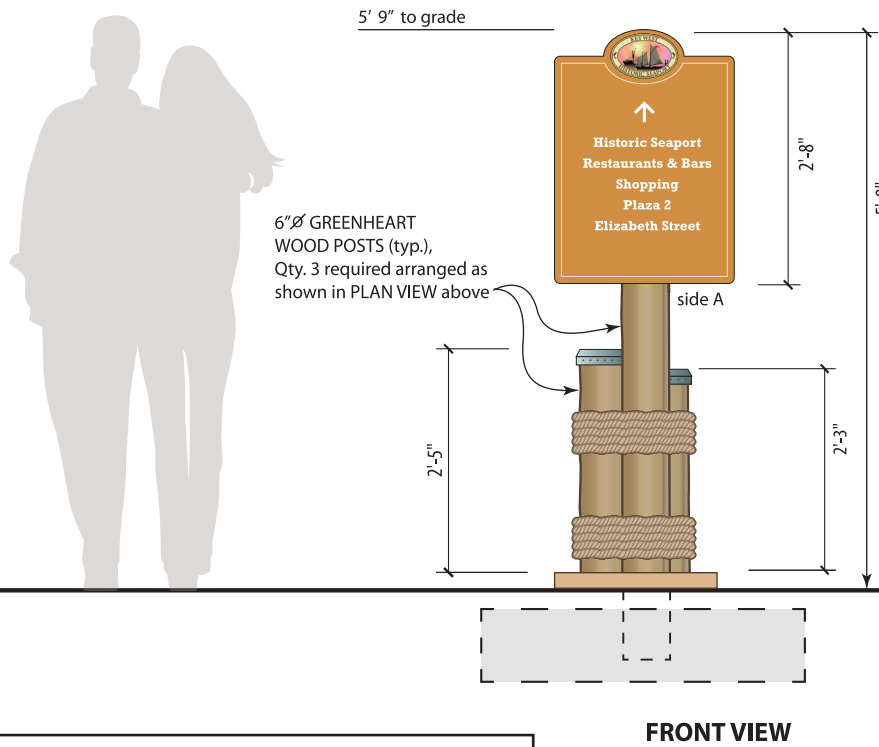
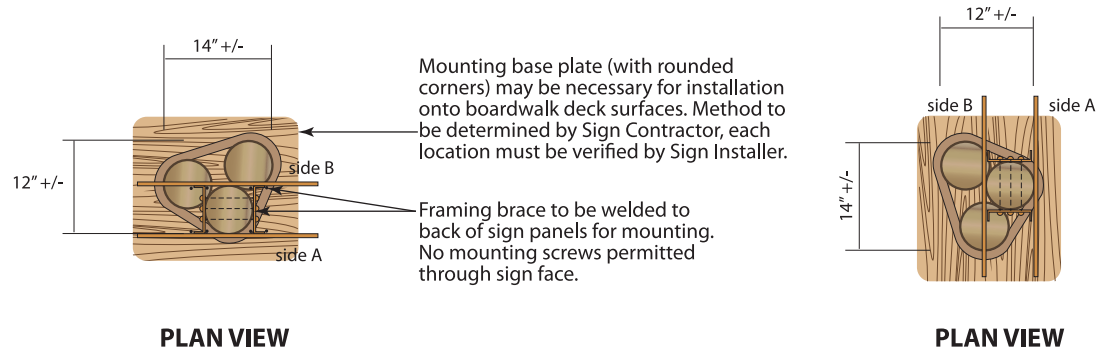

- SIGN TEXT AND VECTOR LOGO TO BE PROVIDED BY CITY TO THE FABRICATOR.
 - TEXT ON EACH SIGN WILL VARY BY LOCATION. SEE SIGN MESSAGE SCHEDULE FOR EACH LOCATION.
 - SIGN MAY BE SINGLE FACED OR DOUBLE FACED. VERIFY WITH CITY, PROVIDED TEXT & APPROVED MESSAGE SCHEDULE.
- 3/4" IZONE EXTERIOR GRADE UV RESISTANT PHENOLIC PANELS MOUNTED TO POST WITH S.S. FASTENERS
- EACH SIGN LOCATION MUST BE VERIFIED AND APPROVED BY THE CITY WITH SIGN CONTRACTOR INITIAL WALK-THRU WITH CITY.

SIGN TYPE **B**

Arrow direction is subject to change based on exact location of sign installation.



Sign No. 1 (single-faced)



Sign No. 5 (side A)



Sign No. 5 (side B)

Pantone
PMS 145c



Sign No. 9 (side A)



Sign No. 9 (side B)

SIGN PLAQUES OF 3/4" thk. IZONE
EXTERIOR GRADE PHENOLIC UV RESIS-
TANT PANELS MOUNTED TO POST with
TAMPERPROOF 316L MARINE-GRADE
FASTENERS & SUB FRAMING AS REQ'D
FOR RIGIDITY AND SECURE MOUNTING.
ALL SHARP CORNERS & EDGES MUST BE
SOFTENED.

**NO VISIBLE SCREWS OR FASTENERS
PERMITTED ON SIGN FACES.** ANY
VISIBLE FRAMING BEHIND SIGN PANELS
MUST BE PAINTED TO MATCH SIGN FACE.

FONT USED: **ROCKWELL BOLD**

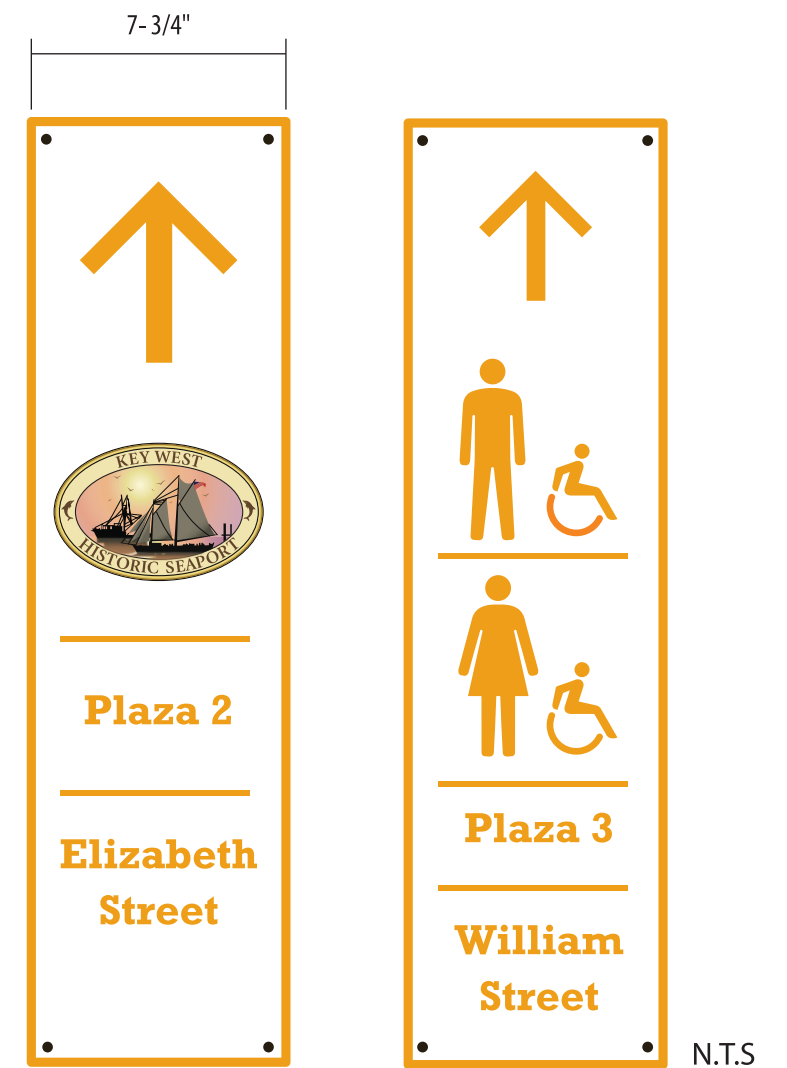
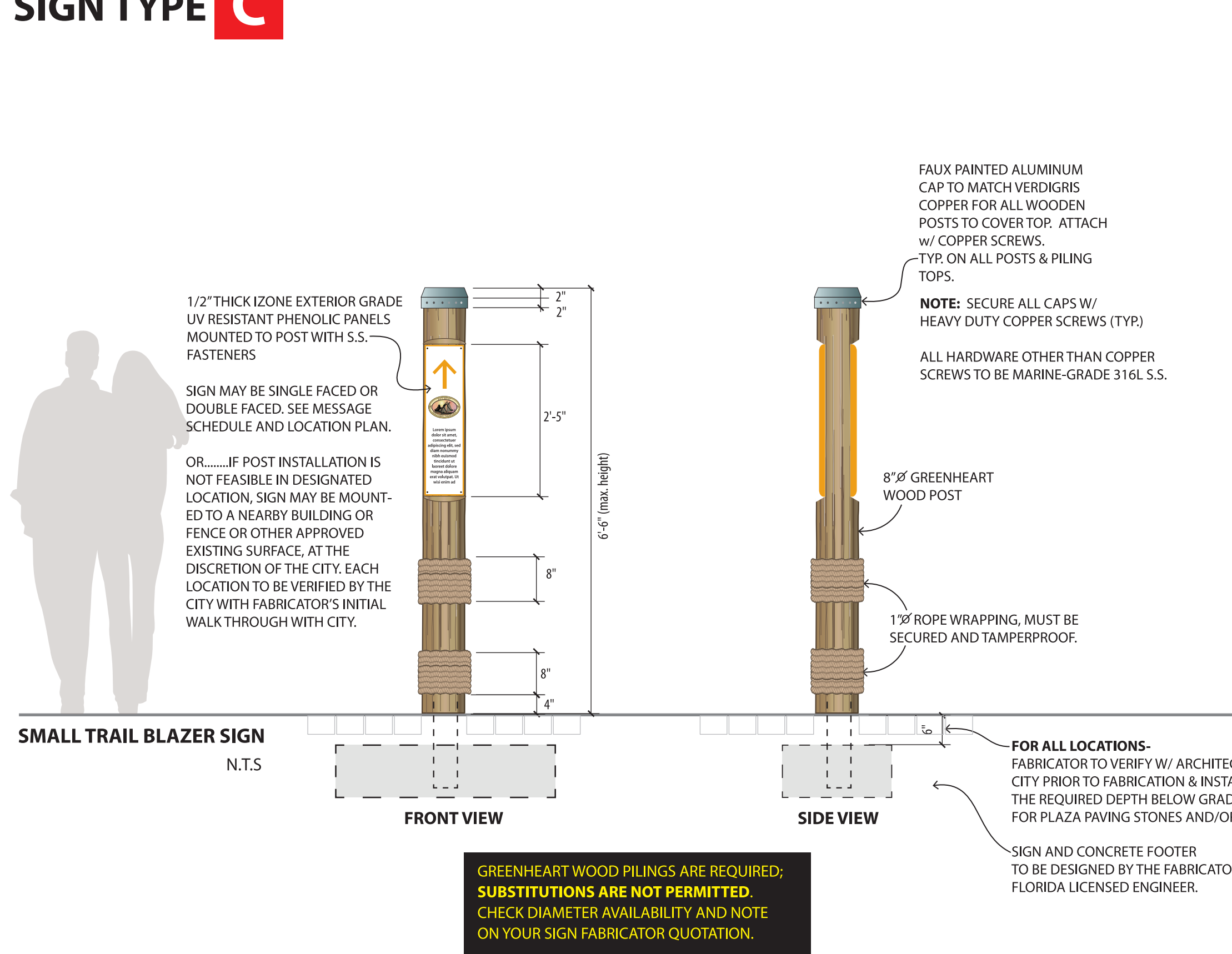

SAMPLE LAYOUTS
SEE SHEET C.1 FOR EXACT LAYOUTS

SIGN PLAQUES OF 1/2" thk. IZONE EXTERIOR GRADE UV RESISTANT PHENOLIC PANELS MOUNTED TO POST WITH TAMPERPROOF 316L STAINLESS STEEL FASTENERS. SHARP CORNERS AND EDGES MUST BE SOFTENED.

PLAQUES ATTACHED TO WOOD POSTS WITH STEEL FASTENERS AND SILICON ADHESIVES MADE FOR EXTERIOR USE.

FONT USED: **ROCKWELL BOLD**

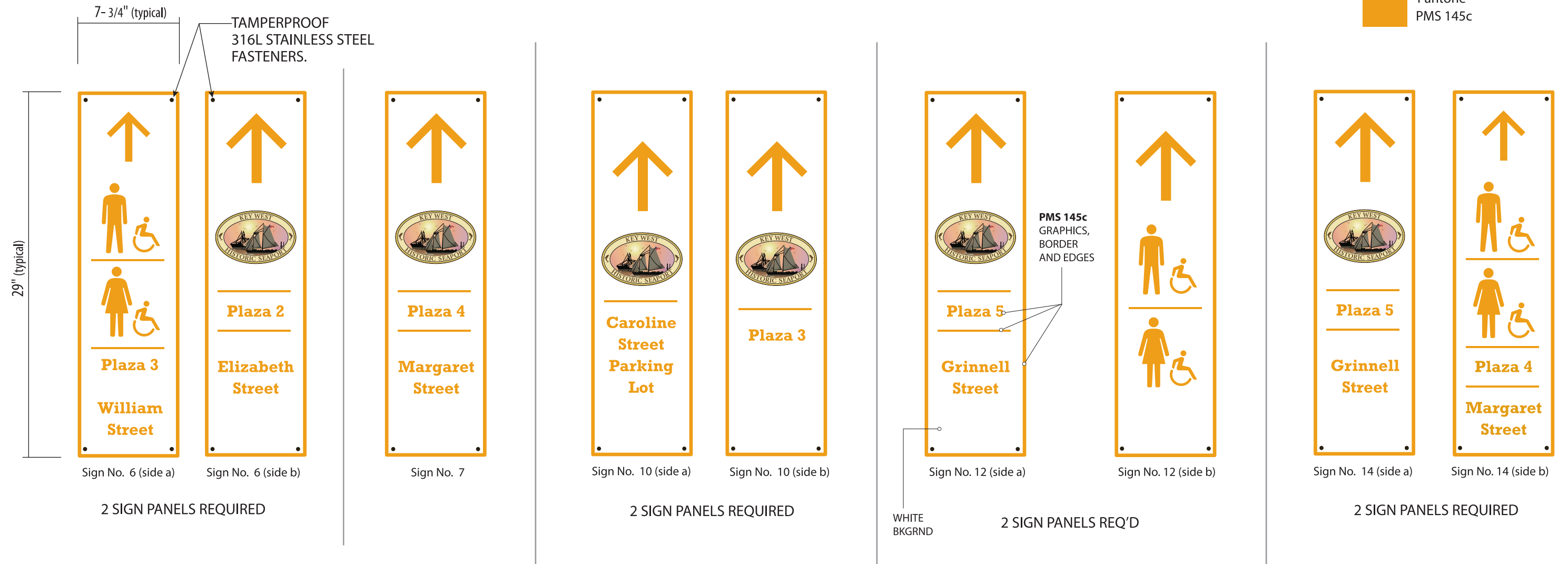

SIGN TYPE **D**

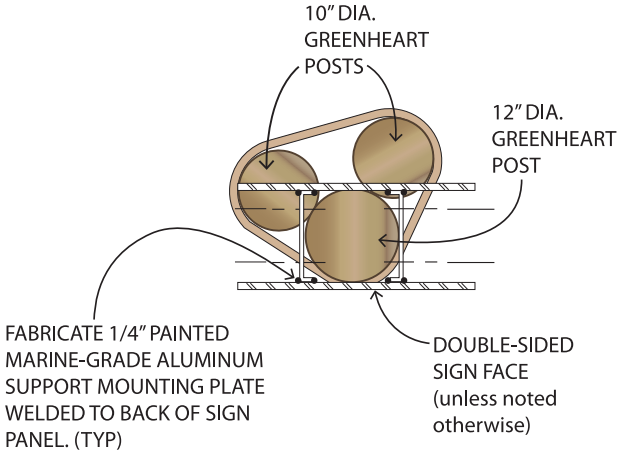

SECTION THRU MOUNTING BRACKET

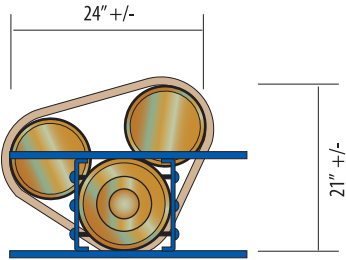

TOP VIEW

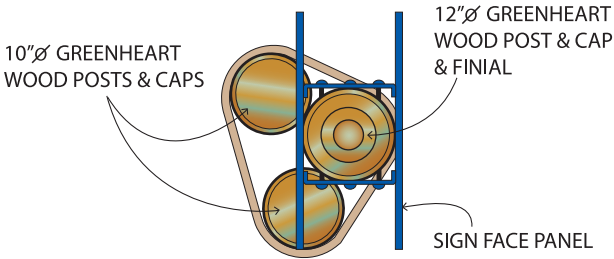

TOP VIEW

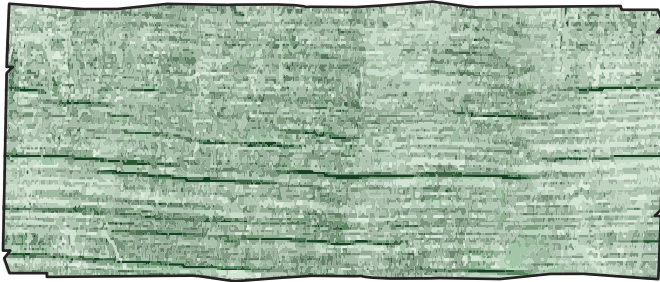

PANEL DETAIL SHOWING TYPICAL SHAPE & WOOD GRAIN

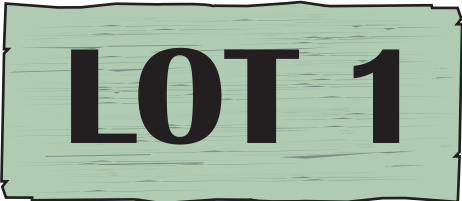

10" x 22"

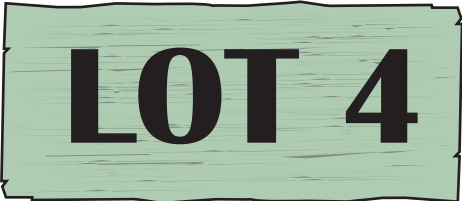
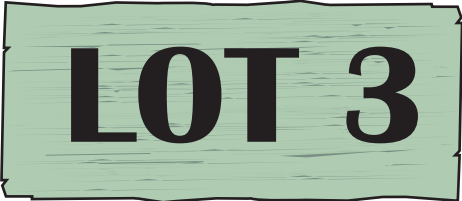
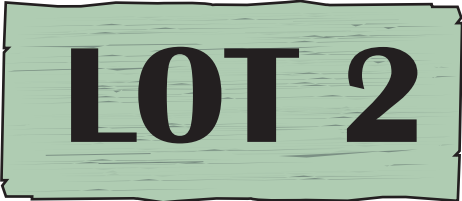

FONT USED: **BRITANNIC BOLD**
LOT NUMBER CHANGES PER LOCATION.
SEE SIGN LOCATION PLAN AND
MESSAGE SCHEDULE SHEET A.0.2

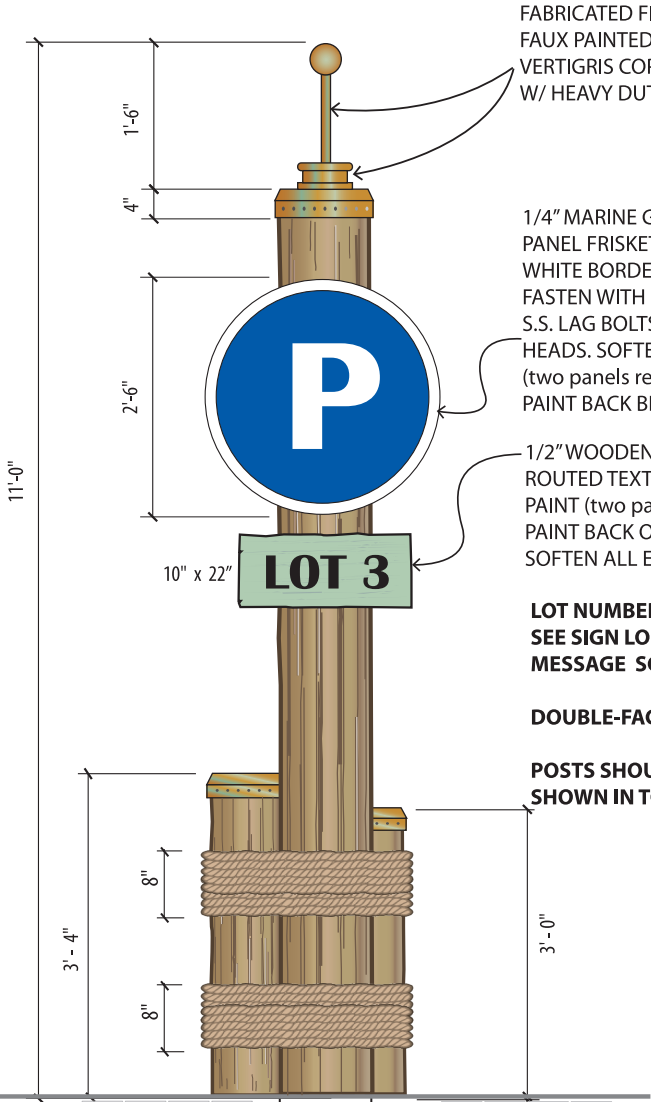

FRONT VIEW

FABRICATED FIBERGLASS FINIAL FAUX PAINTED TO MATCH VERTIGRIS COPPER. SECURE TOP W/ HEAVY DUTY COPPER SCREWS.

1/4" MARINE GRADE ALUMINUM PANEL FRISKET PAINTED PMS 294 W/ WHITE BORDER.
FASTEN WITH 3/4" MARINE-GRADE S.S. LAG BOLTS W/ TAMPER-PROOF HEADS. SOFTEN ALL EDGES (TYP) (two panels required)
PAINT BACK BLUE TO MATCH FACE

1/2" WOODEN PANEL (10" x 22") WITH ROUTED TEXT FILLED WITH BLACK PAINT (two panels required)
PAINT BACK OF PANEL SAME COLOR. SOFTEN ALL EDGES (TYP)

LOT NUMBER CHANGES PER LOCATION.
SEE SIGN LOCATION PLAN AND
MESSAGE SCHEDULE SHEET A.0.2

DOUBLE-FACE EACH LOCATION.

POSTS SHOULD BE ARRANGED AS SHOWN IN TOP VIEW GRAPHIC (above)

10"Ø GREENHEART WOOD POSTS, QTY. 2

1"Ø ROPE WRAPPING, SECURED AND TAMPERPROOF.

FOR ALL LOCATIONS-
FABRICATOR TO VERIFY W/ ARCHITECT AND CITY PRIOR TO FABRICATION & INSTALLATION, THE REQUIRED DEPTH BELOW GRADE TO ALLOW FOR PLAZA PAVING STONES AND/OR LANDSCAPING.

SIGN AND CONCRETE FOOTER TO BE DESIGNED BY THE FABRICATOR'S FLORIDA LICENSED ENGINEER.

SIDE VIEW

OPTION 1 - NATURAL FINISH THE PREFERRED FINISH OPTION. SELECT WOOD ACCORDINGLY.
OPTION 2 - SATIN TRANSPARENT STAIN FOR WOOD T.B.D.

GREENHEART WOOD PILINGS ARE REQUIRED;
SUBSTITUTIONS ARE NOT PERMITTED.
CHECK DIAMETER AVAILABILITY AND NOTE ON YOUR SIGN FABRICATOR QUOTATION.