

# **Solid Waste Management Plan**

# Solid Waste Management Plan

05/26/10

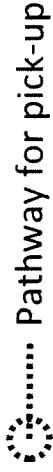

Pathway for pick-up

Waste pick-up to be determined by generation on an as-needed basis

Anticipate 36-inch square "toters" to be sufficient. Waste handling area can accommodate up to 24 "toters".

"Toters" to be moved street side at the end of business prior to pick-up

"Toters" shall be returned to a screened enclosure in the morning after pick-up

"Toters" shall not block the public right-of-way

Solid Waste Management Plan overlaid on site plan by Carlos Rojas, Architect

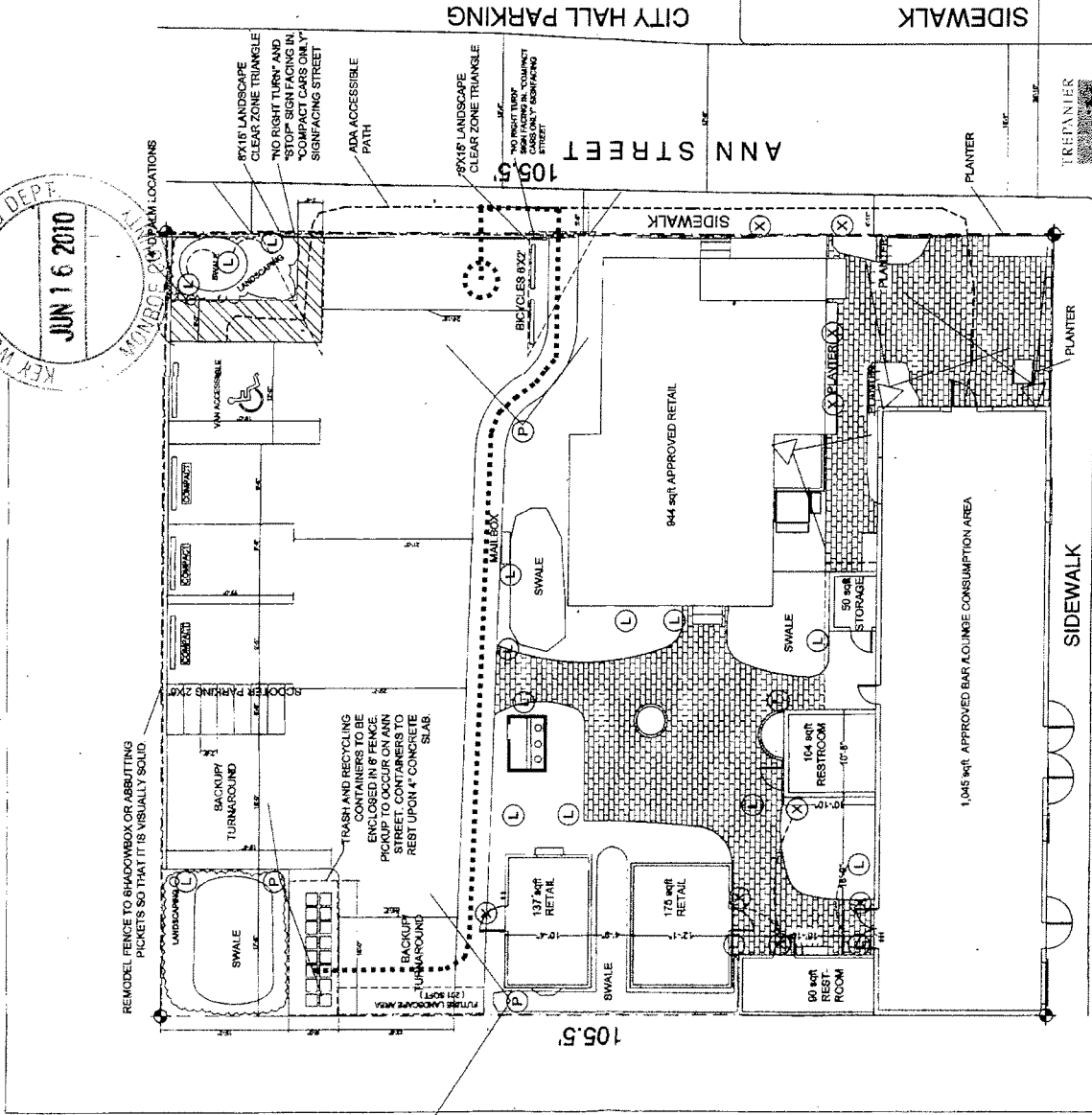

**SITE PLAN PROPOSED**

1/18" = 1'-0"

