



Property Appraiser Information

Ervin A. Higgs, CFA
Property Appraiser
Monroe County, Florida

office (305) 292-3420
 fax (305) 292-3501

Property Record View

Alternate Key: 1068691 Parcel ID: 00065830-000000

Ownership Details

Mailing Address:
 CORP OF THE PRESI BISH JESUS CHRIST LATTER-DAY STS
 50 E N TEMPLE
 SALT LAKE CITY, UT 84150

Property Details

PC Code: 71 - CHURCHES
 Millage Group: 10KW
 Affordable Housing: No
 Section-Township-Range: 34-67-25
 Property Location: 3424 NORTHSIDE DR KEY WEST
 Legal Description: KW 1.72AC PLAT OF SURVEY OF LANDS ON ISLAND OF KEY WEST MONROE CTY FLA PT TR18
 PB3-35 OR289-538-539

Show Parcel Map

Exemptions

Exemption	Amount
10 - RELIGIOUS	1,793,577.00

Land Details

Land Use Code	Frontage	Depth	Land Area
100E - COMMERCIAL EXEMPT	0	0	1.72 AC

Building Summary

Number of Buildings: 1
 Number of Commercial Buildings: 1
 Total Living Area: 3215
 Year Built: 1970

Building 1 Details

Building Type	Condition A	Quality Grade 350
Effective Age 15	Perimeter 270	Depreciation % 19

Year Built 1970
Functional Obs 0

Special Arch 0
Economic Obs 0

Grnd Floor Area 3,215

Inclusions:

Roof Type
Heat 1
Heat Src 1

Roof Cover
Heat 2
Heat Src 2

Foundation
Bedrooms 0

Extra Features:

2 Fix Bath 0
3 Fix Bath 0
4 Fix Bath 0
5 Fix Bath 0
6 Fix Bath 0
7 Fix Bath 0
Extra Fix 6

Vacuum 0
Garbage Disposal 0
Compactor 0
Security 0
Intercom 0
Fireplaces 0
Dishwasher 0

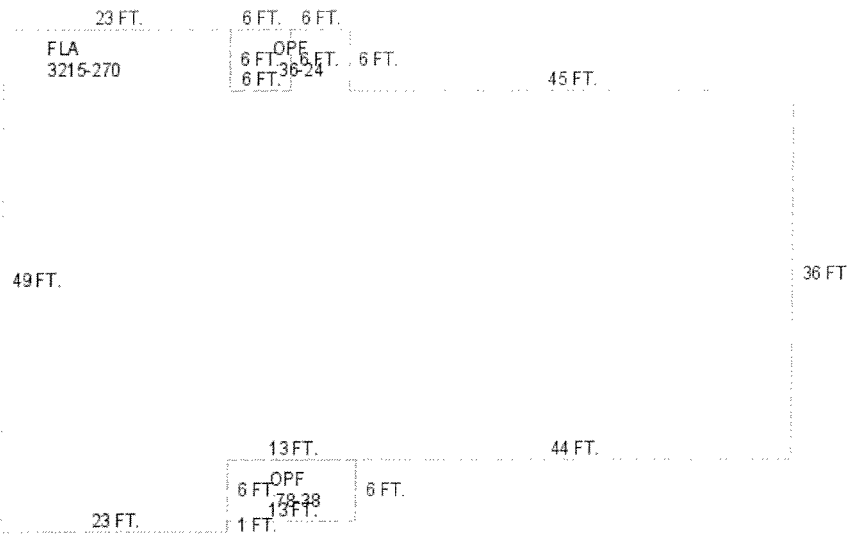

Sections:

Nbr	Type	Ext Wall	# Stories	Year Built	Attic	A/C	Basement %	Finished Basement %	Area
1	FLA		1	1990					3,215
2	OPF		1	1990					78
3	OPF		1	1990					36

Interior Finish:

Section Nbr	Interior Finish Nbr	Type	Area %	Sprinkler	A/C
	5996	CHURCHES	100	N	Y
	5997	OPF	100	N	N
	5998	OPF	100	N	N

Exterior Wall:

Interior Finish Nbr	Type	Area %
---------------------	------	--------

1644	C.B.S.	100
------	--------	-----

Misc Improvement Details

Nbr	Type	# Units	Length	Width	Year Built	Roll Year	Grade	Life
1	UB2:UTILITY BLDG	220 SF	20	11	1984	1985	4	50
2	AP2:ASPHALT PAVING	16,231 SF	0	0	1979	1980	2	25
3	PT3:PATIO	2,177 SF	0	0	1979	1980	2	50
4	CL2:CH LINK FENCE	6,108 SF	0	0	1995	1996	3	30

Appraiser Notes

CHURCH OF JESUS CHRIST OF LATTER DAY SAINTS 3424 NORTHSIDE DRIVE
--

Building Permits

Bldg Number	Date Issued	Date Completed	Amount	Description	Notes
6	07-2557	05/30/2007	1,000	Commercial	RED TAGED BY CODE. REPAIR AND REPLACE SP LER SYSTEM
1	B95-2035	06/01/1995	120,000	Commercial	BUILDING REMODELING
2	96-0373	01/01/1996	9,000	Commercial	A/C
3	96-0959	02/01/1996	8,000	Commercial	PLUMBING
4	96-1110	03/01/1996	10,000	Commercial	ELECTRICAL
5	96-1150	03/01/1996	6,300	Commercial	ROOFING

Parcel Value History

Certified Roll Values.

[View Taxes for this Parcel.](#)

Roll Year	Total Bldg Value	Total Misc Improvement Value	Total Land Value	Total Just (Market) Value	Total Assessed Value	School Exempt Value	School Taxable Value
2009	433,642	32,933	1,348,480	1,815,055	1,815,055	1,815,055	0
2008	433,642	33,873	1,348,480	1,815,995	1,815,995	1,815,995	0
2007	285,918	33,428	1,348,480	1,667,826	1,667,826	1,667,826	0
2006	292,645	34,412	1,873,080	2,200,137	2,200,137	2,200,137	0
2005	292,645	35,286	479,510	807,441	807,441	807,441	0
2004	296,007	36,160	479,510	811,677	811,677	811,677	0
2003	296,007	37,144	479,510	812,661	812,661	812,661	0
2002	296,007	38,018	479,510	813,535	813,535	813,535	0
2001	302,734	38,892	479,510	821,136	821,136	821,136	0
2000	302,734	18,297	479,510	800,541	800,541	800,541	0
1999	302,734	18,665	479,510	800,909	800,909	800,909	0

1998	202,294	19,032	479,510	700,836	700,836	700,836	0
1997	202,294	19,463	479,510	701,267	701,267	701,267	0
1996	179,817	9,716	479,510	669,043	669,043	669,043	0
1995	179,817	9,782	479,510	669,109	669,109	669,109	0
1994	179,817	10,562	479,510	669,889	669,889	669,889	0
1993	179,817	11,342	479,510	670,669	670,669	670,669	0
1992	179,817	12,122	479,510	671,449	671,449	671,449	0
1991	179,817	12,902	479,510	672,229	672,229	672,229	0
1990	153,347	13,682	430,000	597,029	597,029	597,029	0
1989	153,347	14,463	430,000	597,810	597,810	597,810	0
1988	139,792	10,414	430,000	580,206	580,206	580,206	0
1987	137,612	10,927	198,928	347,467	347,467	347,467	0
1986	137,878	10,164	187,753	335,795	335,795	335,795	0
1985	135,288	4,545	135,590	275,423	275,423	275,423	0
1984	0	86,449	135,590	222,039	222,039	222,039	0
1983	0	86,449	135,590	222,039	222,039	222,039	0
1982	0	86,449	135,590	222,039	222,039	222,039	0

Parcel Sales History

NOTE: Sales do not generally show up in our computer system until about two to three months after the date of sale. If a recent sale does not show up in this list, please allow more time for the sale record to be processed. Thank you for your patience and understanding.

There are no sales to display for this parcel.

This page has been visited 68,580 times.

Monroe County Property Appraiser
Ervin A. Higgs, CFA
P.O. Box 1176
Key West, FL 33041-1176