

Prior Modifications to Site Plan

May 19, 2010

May 4, 2010

April 26, 2010

April 8, 2010

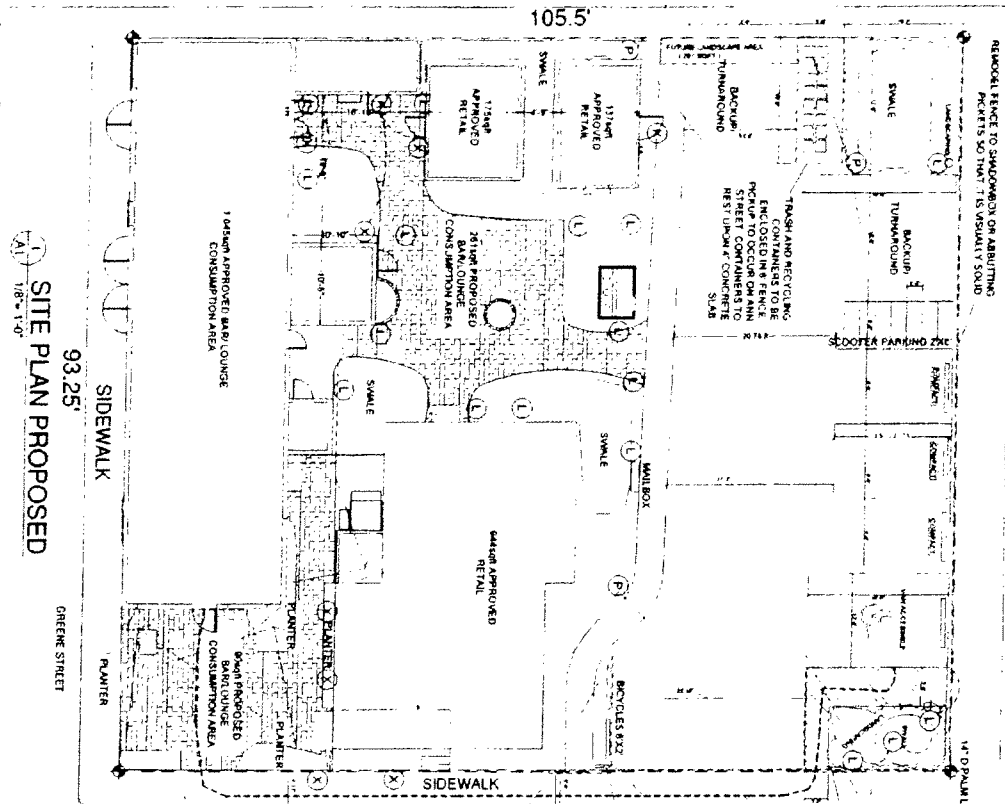

SITE PLAN PROPOSED
 1/8" = 1'-0"
 93.25'
 SIDEWALK
 GREEK STREET

ANN STREET 105.5'

SIDEWALK

CITY HALL PARKING



LIGHTING LEGEND

1	DOWN LIGHT
2	RECURRENT LIGHT
3	FOOT LIGHT

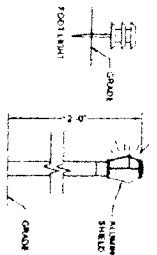

Carlos O. Rojas, AIA
 512 Greene Street
 Key West, Florida 33040

A1



Revision

NO. 1	DATE	DESCRIPTION

REMOVE FENCE TO SHOWDOWN ON ABUTTING
 PROPERTIES SO THAT IT IS VISUALLY SOLID

TRASH AND RECYCLING
 CONTAINERS TO BE
 PROVIDED FOR
 PICKUP TO OCCUR ON MAIN
 STREET CONTAINERS TO
 REST UPON 4" CONCRETE
 SLAB

EXIST LANDSCAPE
 CLEAR ZONE TRIANGLE
 NO RIGHT TURN & STOP
 SIGN PARKING IN CORNER
 LANE ONLY SHOW ACROSS
 STREET
 ADA ACCESSIBLE
 PAVIN

EXIST LANDSCAPE
 CLEAR ZONE TRIANGLE
 THE RIGHT TURN
 SIGN SHALL BE LOCATED
 ON THE CORNER OF THE
 STREET

14' 0" PLANT LOCATIONS

105.5'

REMODEL FENCE TO SHADOWBOX OR ABUTTING PICKETS SO THAT IT IS VISUALLY SOLID

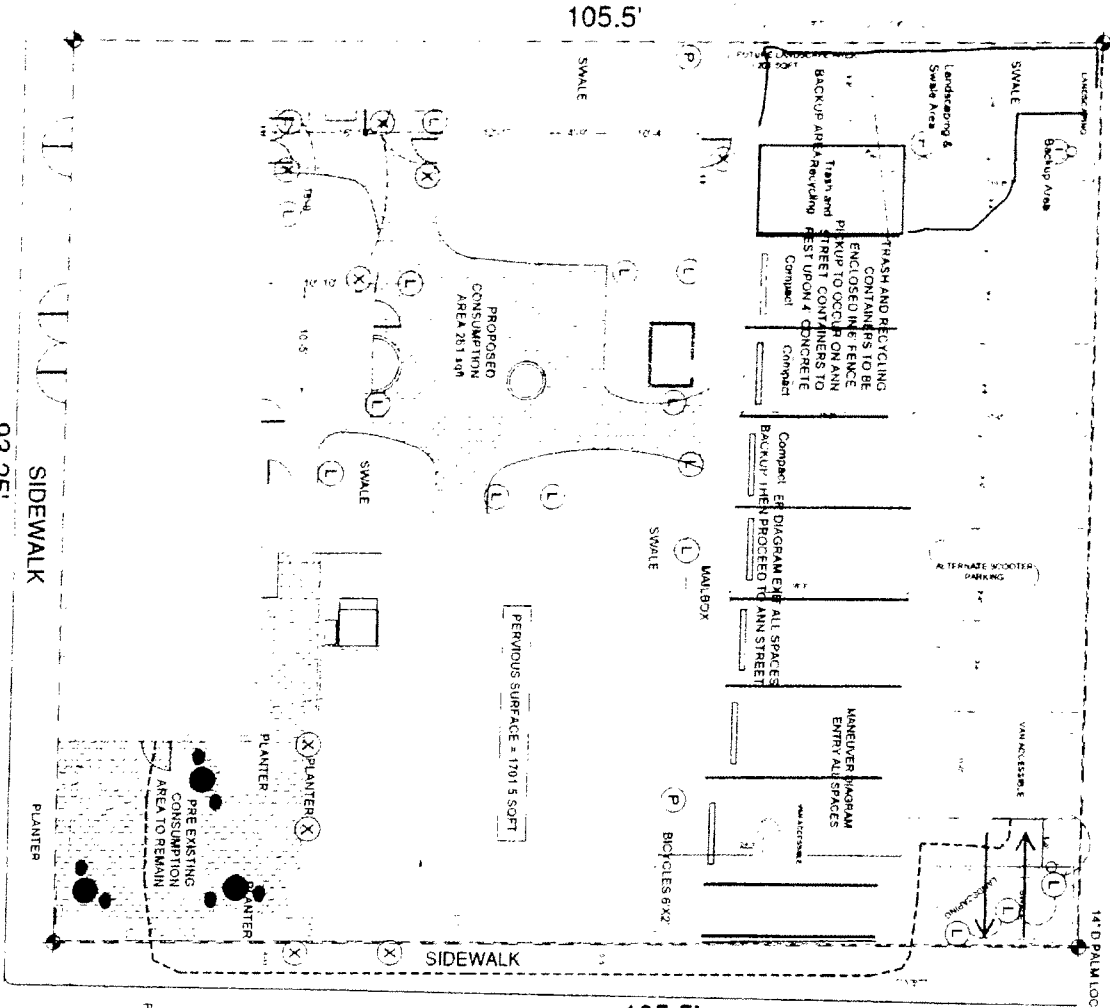

SITE PLAN PROPOSED
 1/8" = 1'-0"

ANN STREET 105.5'

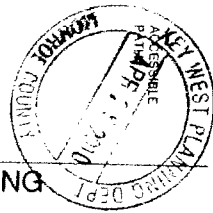

CITY HALL PARKING

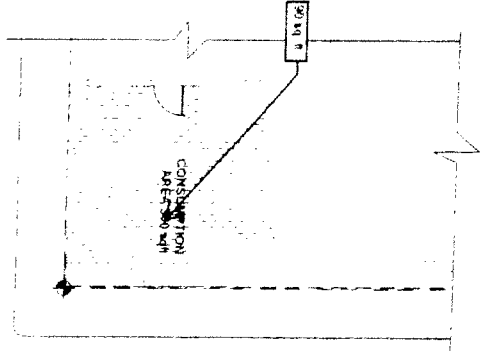

PRE EXISTING CONSUMPTION AREA
 1/8" = 1'-0"

LIGHTING LEGEND

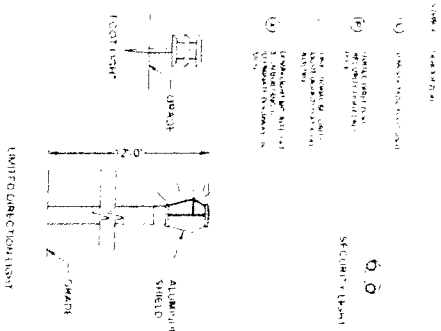

Carlos O. Rojas, AIA
 512 Greene Street
 Key West, Florida 33040

A1

Carlos O. Rojas, AIA
 AIA No. 6754
 512 Greene Street
 Key West, FL 33040
 305.292.4877
 Email: carlos@carlosrojas.com



