

Ervin A. Higgs, CFA
Property Appraiser
Monroe County, Florida

office (305) 292-3420
fax (305) 292-3501

Property Record View

Alternate Key: 8801131 Parcel ID: 00072082-003700

Ownership Details

Mailing Address:

CITY OF KEY WEST
PO BOX 1409
KEY WEST, FL 33041-1409

Property Details

PC Code: 21 - RESTAURANTS & CAFETERIAS
Millage Group: 10KW
Affordable Housing: No
Section-Township-Range: 06-68-25
Property Location: PART OF MALLORY SQUARE KEY WEST
Legal Description: (TROPICAL SHELL AND GIFT INC LEASE DATED 2/20/85) G64-274/275

Parcel Map

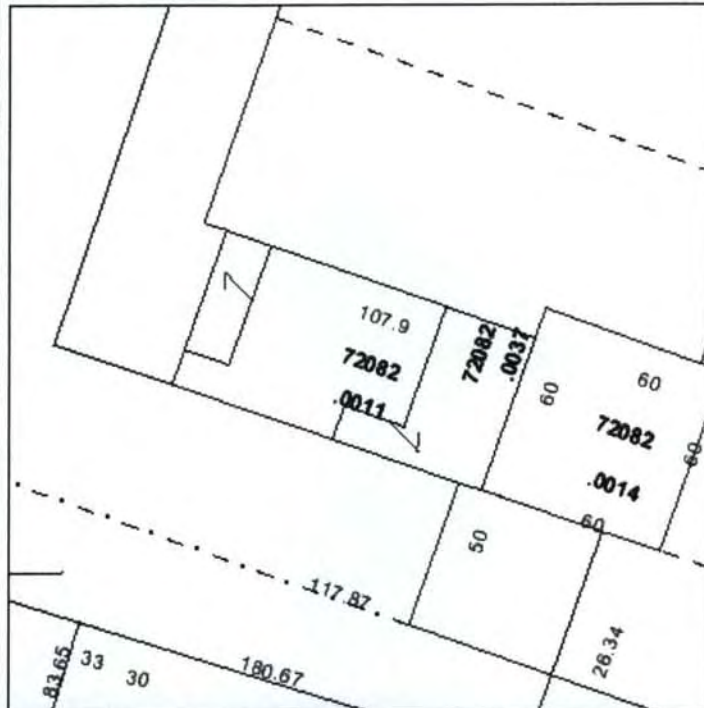

Land Details

Land Use Code	Frontage	Depth	Land Area
100W - COMMERCIAL WATERFRON	0	0	2,038.00 SF
100D - COMMERCIAL DRY	0	0	774.00 SF

Building Summary

Number of Buildings: 1
 Number of Commercial Buildings: 1
 Total Living Area: 625
 Year Built: 1950

Building 1 Details

Building Type
 Effective Age 10
 Year Built 1950
 Functional Obs 0

Condition E
 Perimeter 100
 Special Arch 0
 Economic Obs 0

Quality Grade 350
 Depreciation % 13
 Grnd Floor Area 625

Inclusions:

Roof Type
 Heat 1
 Heat Src 1

Roof Cover
 Heat 2
 Heat Src 2

Foundation
 Bedrooms 0

Extra Features:

2 Fix Bath 1
 3 Fix Bath 1
 4 Fix Bath 0
 5 Fix Bath 0
 6 Fix Bath 0
 7 Fix Bath 0
 Extra Fix 1

Vacuum 0
 Garbage Disposal 0
 Compactor 0
 Security 0
 Intercom 0
 Fireplaces 0
 Dishwasher 0

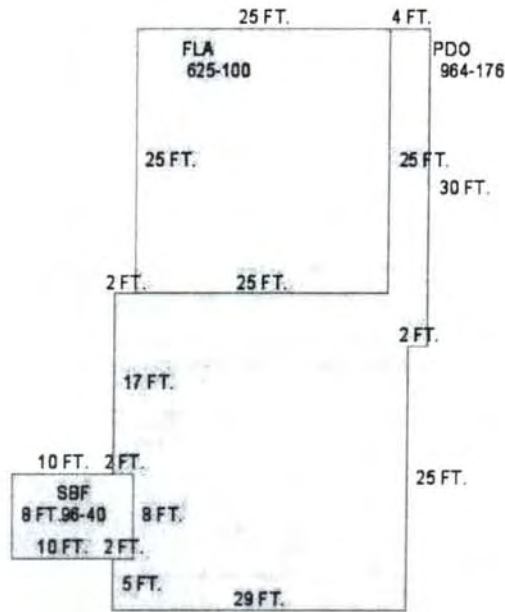

Sections:

Nbr	Type	Ext Wall	# Stories	Year Built	Attic	A/C	Basement %	Finished Basement %	Area
1	FLA		1	1993					625
2	PDO		1	1993					964
3	SBF		1	1999					96

Interior Finish:

Section Nbr	Interior Finish Nbr	Type	Area %	Sprinkler	A/C
	16369	RESTRNT/CAFETR-B-	100	N	N

Exterior Wall:

Interior Finish Nbr	Type	Area %
5644	REIN CONCRETE	100

Misc Improvement Details

Nbr	Type	# Units	Length	Width	Year Built	Roll Year	Grade	Life
1	UB2:UTILITY BLDG	660 SF	0	0	1949	1950	1	50
2	FN2:FENCES	560 SF	140	4	1999	2000	2	30
3	WD2:WOOD DECK	216 SF	24	9	1999	2000	1	40

Building Permits

Bldg	Number	Date Issued	Date Completed	Amount	Description	Notes
	9600712	02/01/1996	08/01/1996	2,000		ELECTRIC PERMIT
	9999999	11/05/1999	11/05/1999	1		REMODEL TO RESTAURANT
	9903174	10/25/1999	12/21/1999	3,000		INSTALL 10 NEW FIXTURES
	9903174	09/16/1999	12/21/1999	3,000		REMODELING
	9802425	08/10/1998	12/21/1999	2,800		FENCE
	9903522	10/29/1999	12/21/1999	3,800		DECK
	0103146	09/14/2001	12/04/2001	4,850		NEW COUNTER
	0102798	09/17/2001	12/04/2001	6,000		NEW ELECTRICAL/200 AMP

Parcel Value History

Certified Roll Values.

[View Taxes for this Parcel.](#)

Roll Year	Total Bldg Value	Total Misc Improvement Value	Total Land Value	Total Just (Market) Value	Total Assessed Value	School Exempt Value	School Taxable Value
2010	113,477	4,387	1,253,588	1,371,452	1,371,452	0	1,371,452
2009	114,781	4,489	1,357,336	1,476,606	1,368,594	0	1,476,606
2008	117,390	4,577	1,122,210	1,244,177	1,244,177	0	1,244,177
2007	87,389	4,699	1,122,210	1,214,298	1,214,298	0	1,214,298
2006	87,389	4,787	424,250	516,426	516,426	0	516,426

2005	70,700	4,890	339,890	415,480	415,480	0	415,480
2004	72,302	4,997	311,770	389,069	389,069	0	389,069
2003	72,302	5,100	287,648	365,050	365,050	0	365,050
2002	72,302	5,188	287,648	365,138	365,138	0	365,138
2001	72,302	5,310	287,648	365,260	365,260	0	365,260
2000	67,548	2,324	223,668	293,540	293,540	0	293,540
1999	0	1,056	177,813	178,869	178,869	0	178,869
1998	0	1,056	177,813	178,869	178,869	0	178,869
1997	0	1,056	173,208	174,264	174,264	0	174,264
1996	0	1,056	173,208	174,264	174,264	0	174,264
1995	0	1,056	173,208	174,264	174,264	0	174,264
1994	0	1,056	173,208	174,264	174,264	0	174,264
1993	0	1,056	173,208	174,264	174,264	0	174,264
1992	0	1,056	218,044	219,100	219,100	0	219,100

Parcel Sales History

NOTE: Sales do not generally show up in our computer system until about two to three months after the date of sale. If a recent sale does not show up in this list, please allow more time for the sale record to be processed. Thank you for your patience and understanding.

There are no sales to display for this parcel.

This page has been visited 410,609 times.

Monroe County Property Appraiser
 Ervin A. Higgs, CFA
 P.O. Box 1176
 Key West, FL 33041-1176

Ervin A. Higgs, CFA
Property Appraiser
Monroe County, Florida

office (305) 292-3420
fax (305) 292-3501

Property Record View

Alternate Key: 8757808 Parcel ID: 00072082-001400

Ownership Details

Mailing Address:
CITY OF KEY WEST
PO BOX 1409
KEY WEST, FL 33041-1409

Property Details

PC Code: 77 - CLUBS,LODGES (PC/LIST)
Millage Group: 10KW
Affordable Housing: No
Section-Township-Range: 06-68-25
Property Location: 10 MALLORY SQUARE KEY WEST
Legal Description: (OLD ISLAND RESTORATION FOUNDATION INC LEASE) G64-274/275

100D - COMMERCIAL DRY	60	60	3,600.00 SF
-----------------------	----	----	-------------

Building Summary

Number of Buildings: 1
Number of Commercial Buildings: 1
Total Living Area: 1080
Year Built: 1938

Building 1 Details

Building Type
Effective Age 14
Year Built 1938
Functional Obs 0

Condition E
Perimeter 132
Special Arch 0
Economic Obs 0

Quality Grade 500
Depreciation % 15
Grnd Floor Area 1,080

Inclusions:

Roof Type
Heat 1
Heat Src 1

Roof Cover
Heat 2
Heat Src 2

Foundation
Bedrooms 0

Extra Features:

2 Fix Bath 0
 3 Fix Bath 0
 4 Fix Bath 0
 5 Fix Bath 0
 6 Fix Bath 0
 7 Fix Bath 0
 Extra Fix 4

Vacuum 0
 Garbage Disposal 0
 Compactor 0
 Security 0
 Intercom 0
 Fireplaces 0
 Dishwasher 0

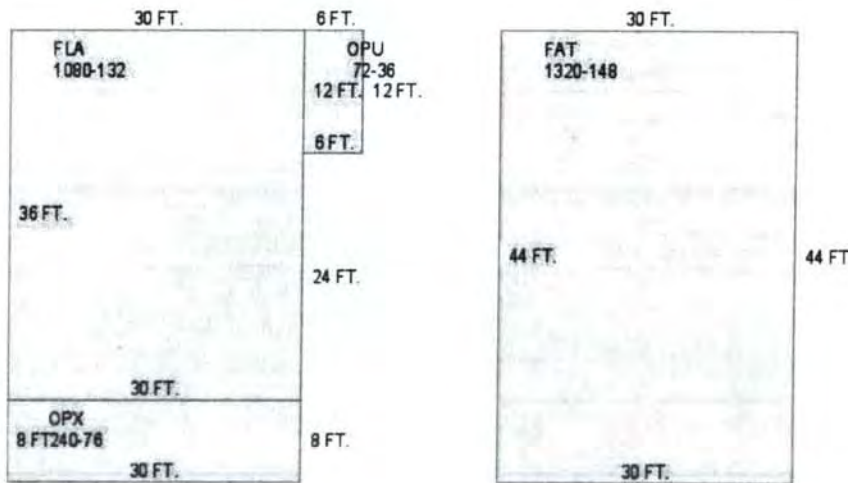

Sections:

Nbr	Type	Ext Wall	# Stories	Year Built	Attic A/C	Basement %	Finished Basement %	Area
-----	------	----------	-----------	------------	-----------	------------	---------------------	------

1	OPX	1	1988	240
2	FLA	1	1988	1,080
3	OPU	1	1988	72
4	FAT	1	1988	1,320

Interior Finish:

Section Nbr	Interior Finish Nbr	Type	Area %	Sprinkler	A/C
	15962	OPX	100	N	N
	15963	TOURIST ATTRAC-B-	100	Y	Y
	15964	OPU	100	N	N
	15965	FAT	100	N	N

Exterior Wall:

Interior Finish Nbr	Type	Area %
5492	AB AVE WOOD SIDING	100

Misc Improvement Details

Nbr	Type	# Units	Length	Width	Year Built	Roll Year	Grade	Life
1	PT2:BRICK PATIO	420 SF	60	7	1979	1980	1	50
2	PT2:BRICK PATIO	77 SF	11	7	1979	1980	2	50

Appraiser Notes

MALLORY SQUARE-- OLD ISLAND RESTORATION-HOSPITALITY HOUSE- #10 MALLORY SQUARE TPP 8610696 - OLD ISLAND RESTORATION FOUNDATION (EXEMPT)

Building Permits

Bldg	Number	Date Issued	Date Completed	Amount	Description	Notes
	B942155	06/01/1994	12/01/1994	3,400		REPAIRS & MODIFICATIONS
	B953897	11/01/1995	12/01/1995	2,500		REPAIRS
	9700923	03/01/1997	12/01/1997	1,960		ROOF REPAIRS
	0103340	10/24/2001	12/04/2001	18,000		RENOVATIONS/HANDICAP RAMP
	0103340	12/10/2001	09/10/2002	18,000		ELECTRICAL

Parcel Value History

Certified Roll Values.

[View Taxes for this Parcel.](#)

Roll Year	Total Bldg Value	Total Misc Improvement Value	Total Land Value	Total Just (Market) Value	Total Assessed Value	School Exempt Value	School Taxable Value
2010	228,058	1,323	1,363,968	1,593,349	1,432,050	1,593,349	0
2009	228,058	1,390	1,607,400	1,836,848	1,301,864	1,836,848	0

Property Search -- Monroe County Property Appraiser

2008	228,058	1,455	954,000	1,183,513	1,183,513	1,183,513	0
2007	166,054	1,522	954,000	1,121,576	1,121,576	1,121,576	0
2006	166,054	1,587	504,000	671,641	671,641	671,641	0
2005	167,963	1,654	396,000	565,617	565,617	565,617	0
2004	171,775	1,721	360,000	533,496	533,496	533,496	0
2003	171,775	1,786	295,200	468,761	468,761	468,761	0
2002	171,775	1,853	295,200	468,828	468,828	468,828	0
2001	163,383	1,918	295,200	460,501	460,501	460,501	0
2000	163,383	635	187,200	351,218	351,218	351,218	0
1999	163,383	657	187,200	351,240	351,240	351,240	0
1998	108,922	677	187,200	296,799	296,799	296,799	0
1997	108,922	699	180,000	289,621	289,621	289,621	0
1996	99,020	720	180,000	279,740	279,740	279,740	0
1995	99,020	741	180,000	279,761	279,761	279,761	0
1994	99,020	762	180,000	279,782	279,782	279,782	0
1993	99,020	784	180,000	279,804	279,804	279,804	0
1992	99,020	805	180,000	279,825	279,825	279,825	0
1991	99,020	826	180,000	279,846	279,846	279,846	0
1990	99,020	848	188,100	287,968	287,968	287,968	0
1989	99,020	868	187,200	287,088	287,088	0	287,088

Parcel Sales History

NOTE: Sales do not generally show up in our computer system until about two to three months after the date of sale. If a recent sale does not show up in this list, please allow more time for the sale record to be processed. Thank you for your patience and understanding.

There are no sales to display for this parcel.

This page has been visited 410,203 times.

Monroe County Property Appraiser
 Ervin A. Higgs, CFA
 P.O. Box 1176
 Key West, FL 33041-1176

Ervin A. Higgs, CFA
Property Appraiser
Monroe County, Florida

office (305) 292-3420
fax (305) 292-3501

Property Record View

Alternate Key: 8757778 Parcel ID: 00072082-001100

Ownership Details

Mailing Address:
CITY OF KEY WEST
PO BOX 1409
KEY WEST, FL 33041-1409

Property Details

PC Code: 89 - MUNICIPAL OTHER THAN (PC/LIST)
Millage Group: 10KW
Affordable Housing: No
Section-Township-Range: 06-68-25
Property Location: 1 MALLORY SQUARE KEY WEST
Legal Description: (F/K/A ISLAND ADVENTURES OF KEY WEST LEASE) EXPIRED 1/31/95 G64-274/275

Parcel Map



Exemptions

Exemption	Amount
15 - MUNICIPAL LANDS	1,428,251.00

Land Details

Land Use Code	Frontage	Depth	Land Area
---------------	----------	-------	-----------

100W - COMMERCIAL WATERFRON	47	58	2,992.00 SF
-----------------------------	----	----	-------------

Building Summary

Number of Buildings: 1
Number of Commercial Buildings: 1
Total Living Area: 703
Year Built: 1986

Building 1 Details

Building Type
Effective Age 8
Year Built 1986
Functional Obs 0

Condition E
Perimeter 136
Special Arch 0
Economic Obs 0

Quality Grade 350
Depreciation % 10
Grnd Floor Area 703

Inclusions:

Roof Type
Heat 1
Heat Src 1

Roof Cover
Heat 2
Heat Src 2

Foundation
Bedrooms 0

Extra Features:

2 Fix Bath 0
3 Fix Bath 0
4 Fix Bath 0
5 Fix Bath 0
6 Fix Bath 0
7 Fix Bath 0
Extra Fix 7

Vacuum 0
Garbage Disposal 0
Compactor 0
Security 0
Intercom 0
Fireplaces 0
Dishwasher 0

No sketch available to display

Sections:

Nbr	Type	Ext Wall	# Stories	Year Built	Attic	A/C	Basement %	Finished Basement %	Area
-----	------	----------	-----------	------------	-------	-----	------------	---------------------	------

1	FLA	1	1988	616
2	FLA	1	1988	87

Interior Finish:

Section Nbr	Interior Finish Nbr	Type	Area %	Sprinkler	A/C
	15952	OFF BLDG-1 STY-D	100	N	Y
	15953	OFF BLDG-1 STY-D	100	N	N

Exterior Wall:

Interior Finish Nbr	Type	Area %
5488	AB AVE WOOD SIDING	29
5489	C.B.S.	71

Misc Improvement Details

Nbr	Type	# Units	Length	Width	Year Built	Roll Year	Grade	Life
1	WD2:WOOD DECK	625 SF	25	25	1987	1988	3	40
2	WD2:WOOD DECK	1,688 SF	0	0	1987	1988	2	40
3	DK4:WOOD DOCKS	672 SF	56	12	1985	1986	1	40
4	SW2:SEAWALL	448 SF	56	8	1979	1980	4	60

Appraiser Notes

#1 MALLORY SQUARE

Building Permits

Bldg	Number	Date issued	Date Completed	Amount	Description	Notes
	9704298	12/22/1997	12/21/1999	1,000		GUTTERS
	9800138	01/14/1998	12/21/1999	5,000		ELECTRICAL
	04-3507	11/10/2004		2,000		DEDUCT METER
	04-3668	11/29/2004		23,995		FENCE, GATES

Parcel Value History

Certified Roll Values.

[View Taxes for this Parcel.](#)

Roll Year	Total Bldg Value	Total Misc Improvement Value	Total Land Value	Total Just (Market) Value	Total Assessed Value	School Exempt Value	School Taxable Value
2010	90,942	29,798	1,307,511	1,428,251	1,428,251	1,428,251	0
2009	92,963	31,431	1,496,000	1,620,394	1,618,969	1,620,394	0
2008	92,963	32,427	1,346,400	1,471,790	1,471,790	1,471,790	0
2007	69,951	28,394	1,346,400	1,444,745	1,444,745	1,444,745	0

Property Search -- Monroe County Property Appraiser

2006	69,951	26,559	463,760	560,270	560,270	560,270	0
2005	71,440	27,735	374,000	473,175	473,175	473,175	0
2004	72,880	28,698	344,080	445,658	445,658	445,658	0
2003	72,880	30,010	329,120	432,010	432,010	432,010	0
2002	72,880	30,838	329,120	432,838	432,838	432,838	0
2001	72,880	32,148	329,120	434,148	434,148	434,148	0
2000	72,880	11,362	269,280	353,522	353,522	353,522	0
1999	72,880	11,780	269,280	353,940	353,940	353,940	0
1998	48,700	12,110	269,280	330,090	330,090	330,090	0
1997	49,676	12,567	263,296	325,539	325,539	325,539	0
1996	45,160	12,857	263,296	321,313	321,313	321,313	0
1995	45,160	13,313	263,296	321,769	321,769	0	321,769
1994	45,160	13,645	263,296	322,101	322,101	0	322,101
1993	45,160	14,060	263,296	322,516	322,516	0	322,516
1992	45,160	14,392	263,296	322,848	322,848	0	322,848
1991	45,160	14,847	258,016	318,023	318,023	0	318,023
1990	45,186	15,138	235,293	295,617	295,617	0	295,617
1989	45,186	15,594	234,560	295,340	295,340	0	295,340

Parcel Sales History

NOTE: Sales do not generally show up in our computer system until about two to three months after the date of sale. If a recent sale does not show up in this list, please allow more time for the sale record to be processed. Thank you for your patience and understanding.

There are no sales to display for this parcel.

This page has been visited 410,091 times.

Monroe County Property Appraiser
 Ervin A. Higgs, CFA
 P.O. Box 1176
 Key West, FL 33041-1176