

Proposed Site Plans

1 SITE PLAN PROPOSED
 AT 1/8" = 1'-0"

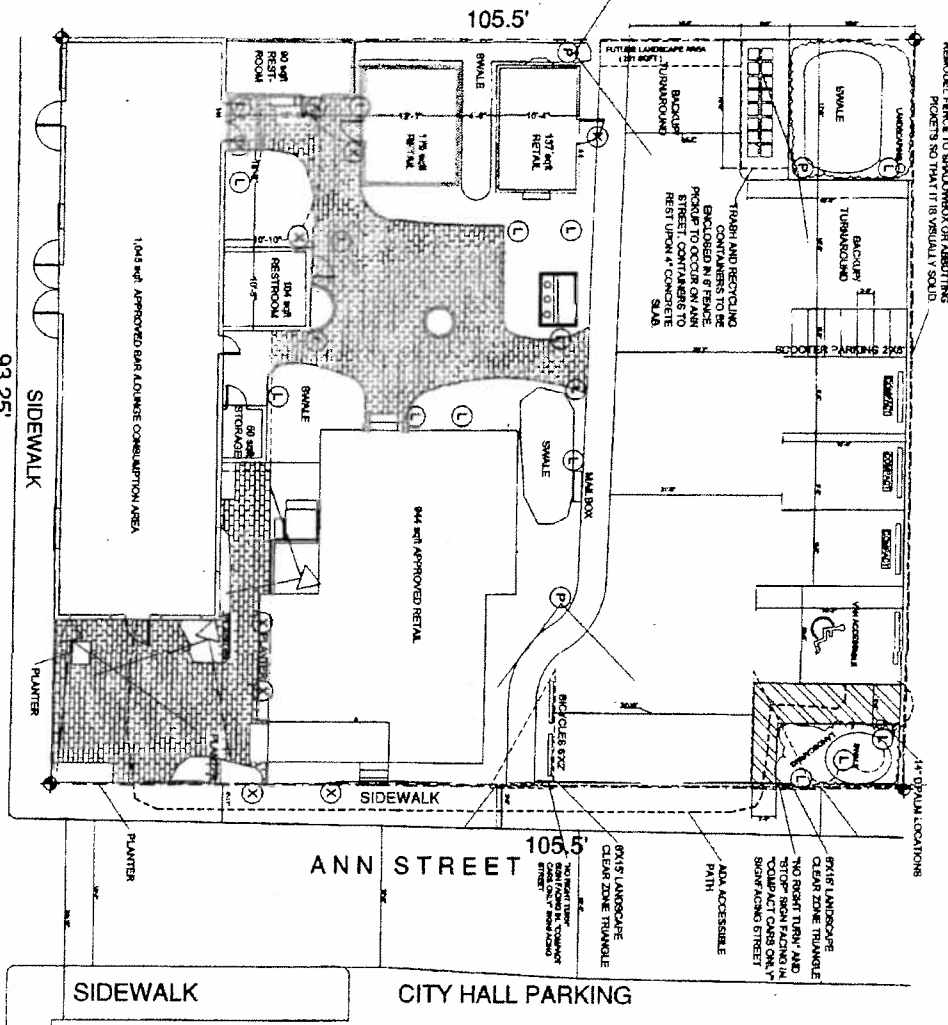

LIGHTING LEGEND

①	LOW VOLTAGE FOOTCANDLE
②	SECURITY LIGHT
③	DOWN LIGHT
④	SECURITY LIGHT

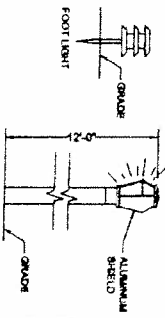

A1

Carlos O. Rojas, AIA
 512 Greene Street
 Key West, Florida 33040

Revisions

05/22/10	
06/10/10	
05/20/10	

Carlos O. Rojas, AIA
 AR 0015764
 840 White Street
 Key West, FL 33040
 305-293-4870
 TheaRojas@keywest.com



Landscape Plan

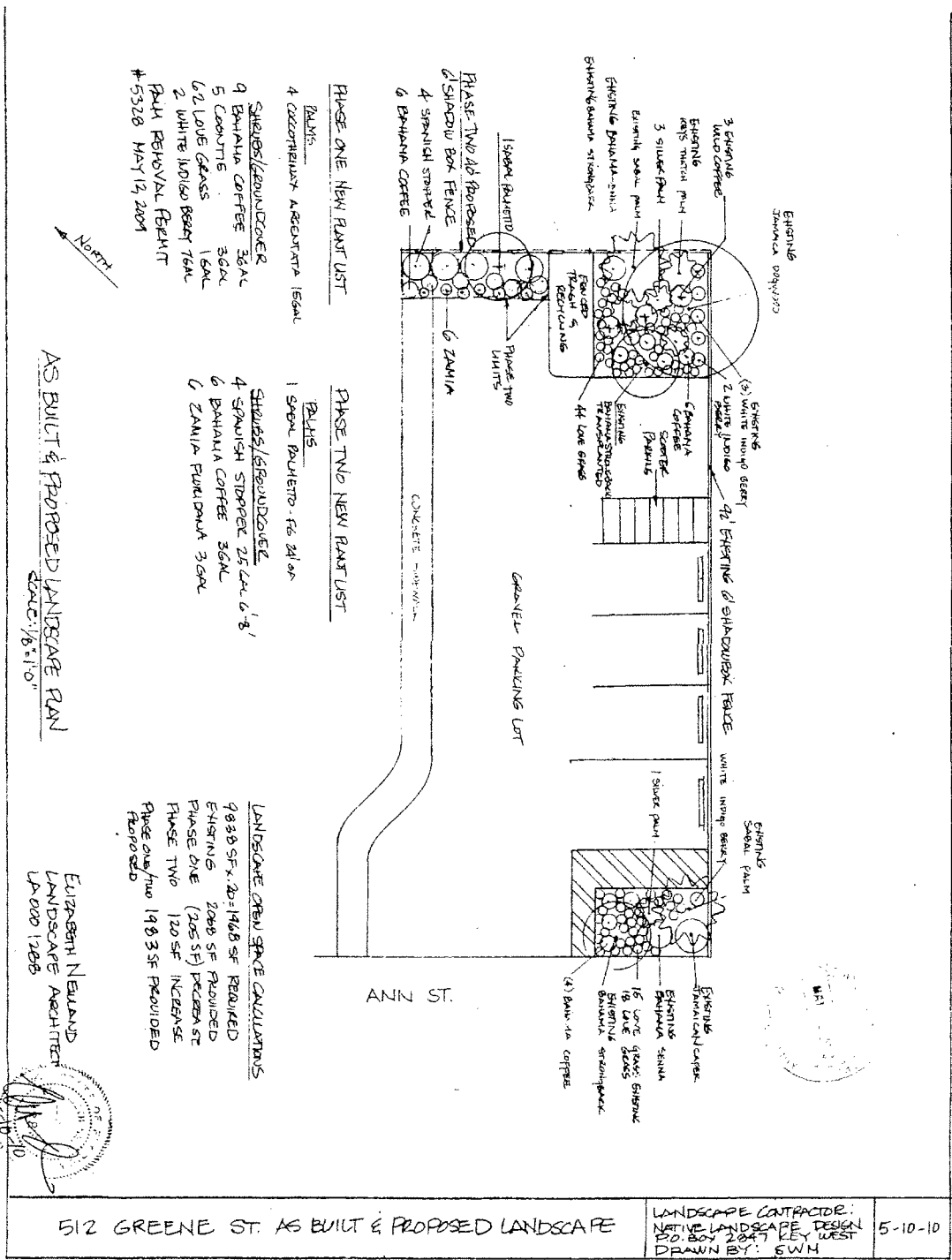

- PHASE ONE NEW PLANT LIST**
- PLANTS
- 4 COCCONUTS ARGENTATA 15 GAL
 - SHADES/REBOUNDER
 - 9 BANANA COFFEE 3 GAL
 - 5 COCOBUTS 3 GAL
 - 6/2 LOUE GRASS 1 GAL
 - 2 WHITE INDIGO BEET 7 GAL
 - PAH REHOVAL BEHUNT #5328 MAY 13, 2004

- PHASE TWO NEW PLANT LIST**
- PLANTS
- 1 SPAN BOUTERIA 7.5 GAL
 - SHADES/REBOUNDER
 - 4 SPANISH STOPPER 2.5 CAL 6" 8"
 - 6 BANANA COFFEE 3 GAL
 - 6 ZANIA FULCIVATA 3 GAL

LANDSCAPE OPEN SPACE CALCULATIONS

9833 SF x .20 = 1966 SF REQUIRED
 EXISTING 2000 SF PROVIDED
 PHASE ONE (705 SF) DECREASE
 PHASE TWO 120 SF INCREASE
 PHASE ONE/TWO 1483 SF PROVIDED
 Proposed

AS BUILT & PROPOSED LANDSCAPE PLAN
 SCALE: 1/8" = 1'-0"

ELIZABETH NEILAND
 LANDSCAPE ARCHITECT
 LP 000 12285

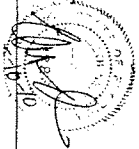

512 GREENE ST. AS BUILT & PROPOSED LANDSCAPE

LANDSCAPE CONTRACTOR:
 NATIVE LANDSCAPE DESIGN
 1510 BOYD ST. #2047 KEY WEST
 DRAWN BY: SWM

5-10-10