

2
LS2.1 **SECOND FLOOR LIFE SAFETY PLAN**
SCALE: 1/4"=1'-0"

SECOND FLOOR - OCCUPANCY & EGRESS CALCULATIONS

USE AND OCCUPANCY CLASSIFICATION: BUSINESS (B)

OCCUPANT LOAD: 14 (784 S.F. / 60)

EGRESS WIDTH REQUIRED:
.2 X 14 = 8.2', 44" MIN. EGRESS WIDTH REQ'D., (DOORS MIN. 32" CLEAR),

STAIR EGRESS WIDTH REQUIRED:
.3 X 14 = 12.3', 44" MIN. EGRESS WIDTH REQ'D., (DOORS MIN. 32" CLEAR),

MIN. NUMBER OF EXITS REQUIRED: 1 (1-500 PERSONS /STORY)

ACCESSIBLE ROUTE WIDTH REQUIRED: 36" (DOORS MIN. 32" CLEAR)

TABLE 1016.1 EXIT ACCESS TRAVEL DISTANCE:
MAX. EGRESS TRAVEL DISTANCE WITHOUT SPRINKLER SYSTEM = 200 F.T.
PROPOSED MAX. TRAVEL DISTANCE = 86' f.t.

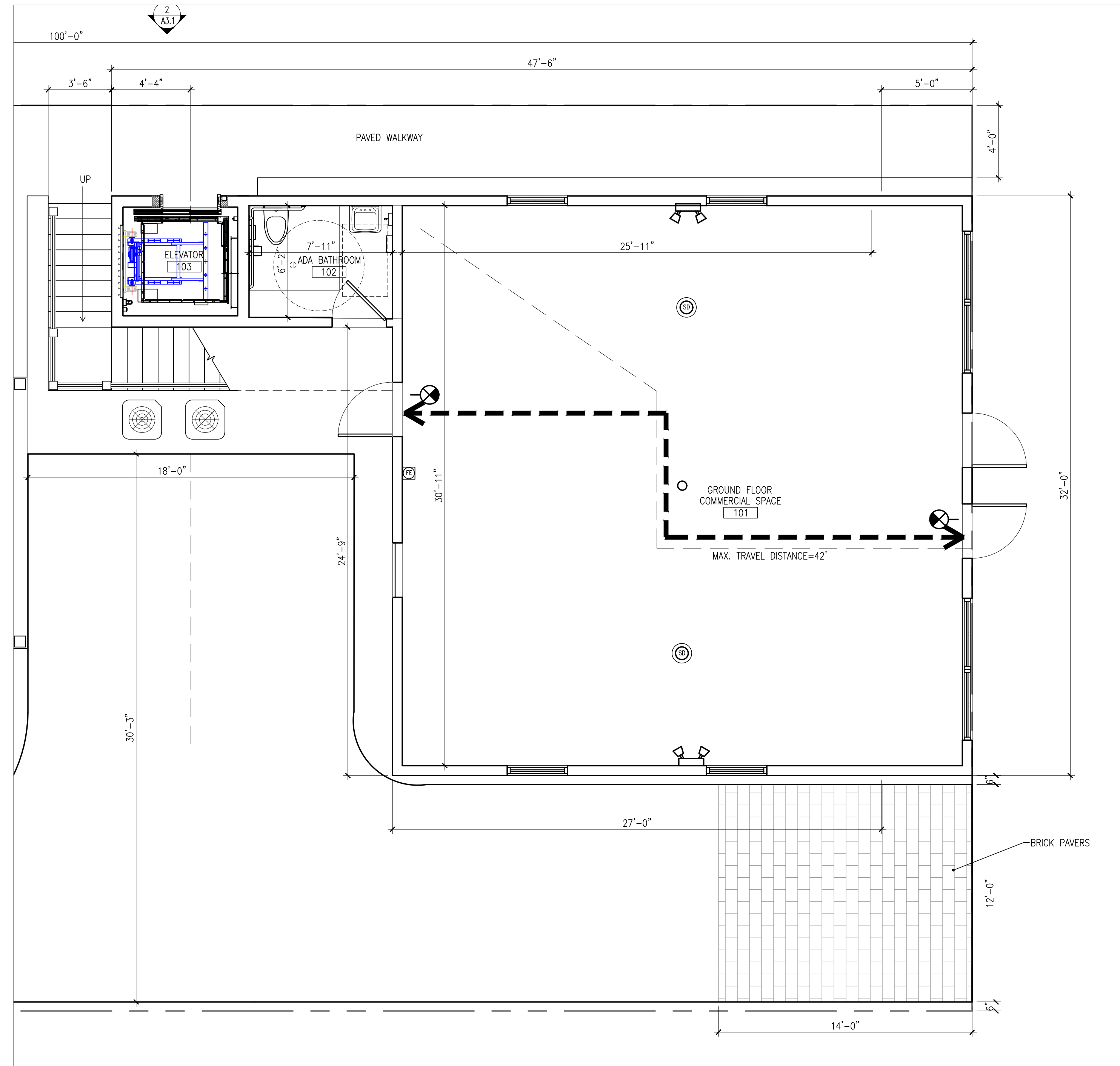

1
LS2.1 **FIRST FLOOR LIFE SAFETY PLAN**
SCALE: 1/4"=1'-0"

OCCUPANCY & EGRESS CALCULATIONS PER STAIR

USE AND OCCUPANCY CLASSIFICATION: MERCANTILE (M)

OCCUPANT LOAD: 17 (1008 S.F. / 60)

EGRESS WIDTH REQUIRED:
.2 X 17 = 3.4', 44" MIN. EGRESS WIDTH REQ'D., (DOORS MIN. 32" CLEAR),

STAIR EGRESS WIDTH REQUIRED:
.3 X 17 = 5.1', 44" MIN. EGRESS WIDTH REQ'D., (DOORS MIN. 32" CLEAR),

MIN. NUMBER OF EXITS REQUIRED: 1 (1-500 PERSONS /STORY)

ACCESSIBLE ROUTE WIDTH REQUIRED: 36" (DOORS MIN. 32" CLEAR)

TABLE 1016.1 EXIT ACCESS TRAVEL DISTANCE:
MAX. EGRESS TRAVEL DISTANCE WITHOUT SPRINKLER SYSTEM = 200 F.T.
PROPOSED MAX. TRAVEL DISTANCE = 42 f.t.

Seal:

Consultants:

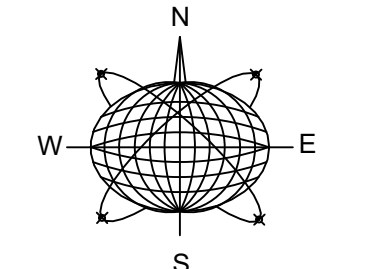

Meridian Engineering LLC

AUTHORIZATION #29401
ph.305-293-5263 fax.293-4899

Submissions / Revisions:

H.A.R.C. SUBMISSION: 2.26.18
PLANNING SUBMISSION: 5.31.18

1028-1030 TRUMAN AVE.
KEY WEST, FL
**NEW COMMERCIAL BUILDING &
TWO RESIDENTIAL UNITS**

Drawing Size: 24x36 | Project #: 18012

Title:

**FIRST FLOOR
PLANS
& SITE PLAN**

Sheet Number:

LS-2.1

Date: - FEBRUARY 14, 2018

© 2018 by WILLIAM SHEPLER & ASSOCIATES ARCHITECTURE LLC