

MEMORANDUM FOR THE FILE

DATE: May 20, 2013

RE: 618 White Street (permit application # 6418)

FROM: Karen DeMaria, Interim Urban Forestry Manager,
City of Key West

An application was received for the removal of **(1) Mango tree**. A site inspection was done on May 15, 2013 and documented the following:

Tree Species: Mango (*Mangifera indica*)



Diameter: 29"

Location: 70% (no utility line issues or foundation issues observed, very large tree)

Species: 100% (on protected tree list)

Condition: 40 % (health fair to poor, has a split trunk with included bark, some issue with a few larger branches, damage on main trunks, canopy looks ok)

Total Average Value = 70 %

Value x Diameter = **20 replacement caliper (dbh) inches**









Note: I spoke to Ken Graham May 23, 2013. He mentioned that his insurance agent has concerns about the tree. I suggested that Mr. Graham submit a letter stating the concerns and he also mentioned that he spoke to John at DOT Palm who also had concerns regarding the structural health of the tree. Mr. Graham will submit additional information for the board and for the final evaluation of the tree.



6418

City of Key West Tree Commission

Tree Permit Application

PO Box 1409
Key West, FL 33040
Phone: 305-809-3764
Fax: 305-809-3978

RE#: 00010210-000000

Alt Key: 1010499

TIC ✓
June 2013
KED
-mango

Home/Property Owner: Kenneth D. & Kristie Graham Date: 14 MAY 2013

Mailing Address: 6504 VANDA LANE, LAND O LAKES, FL 34637

Owner Signature: Kenneth D. Graham / Kristie A. Graham Owner Ph#: 305 942-6860

Represented by: _____ Rep. Ph#: () _____

Represented by mailing address: _____

Attendance at the Tree Commission meeting on the date when your request will be discussed is necessary in order to expedite the resolution of your application.

A letter of representation from the owner must accompany this application if the owner is unable to attend.

Letter of Representation ()

Tree(s) Address: 618 WHITE ST Cross/Corner Street: Angela

Common Name(s): MANGO Scientific Name(s): _____

Species Type(s) (check all that apply): () Palm () Flowering Fruit () Shade

Reason(s) for Application (check all that apply):
 REMOVE () TRANSPLANT () HEAVY MAINTENANCE
() Tree Health () New Location () Branch Removal
 Safety () Same Property () Crown Cleaning/Thinning
() Other / Explain () Other / Explain () Crown Reduction

Reason(s) for request:
TREE HAS GOTTEN FAR TOO LARGE FOR THE AREA. IT HAS A "SPLIT TRUNK" SHAPE AND WILL FALL DURING A HURRICANE. DEPENDING ON HOW IT FALLS, IT COULD POSSIBLY TAKE OUT TWO HOUSES. THIS TREE MUST BE REMOVED FOR SAFETY REASONS.

Replacement plant material must be Florida Grade #1. Replacement of a palm with a native palm is required. Replacement of a canopy tree with a native canopy tree is required. If you need assistance with replacements, please call the Landscape Department at 305-809-3723. If this process requires blocking of a city right-of-way, a separate ROW Permit is required. Please contact Diane Nicklaus 305-809-3951.

<<<<< Sketch location of tree in this area including cross/corner Street >>>>>

Provide access for viewing tree(s) prior to meeting
Identify tree(s) with colored tape

AGENDA ITEM #

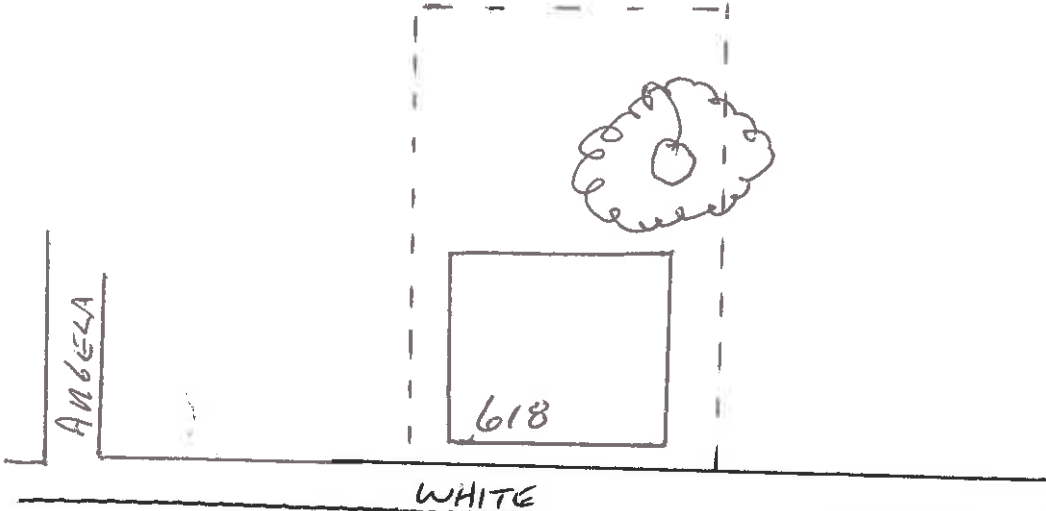

PLEASE DO NOT WRITE BELOW THIS LINE – FOR OFFICE USE ONLY

Tree Species _____
 Split-trunk 1 = 2' 10" cir 2 = 5' 2" circ
 Circumference 10" dbh + 19" dbh ÷ 3.14 = diameter total diameter = 29"

Location 70 % Species 100 % Condition 40 % Total Average Value 70 %

Avg. value 70 X 29 Diameter = 20"
 Replacement Inches

LOCATION: OLD CITY HALL, 510 GREENE STREET, 5:00 p.m.

FOR TREE COMMISSION USE ONLY.

() TABLED () APPROVED () DENIED () FURTHER ACTION

COMMENTS:







Fig 3

May 20, 2013

Kenneth Graham
6504 Vanda Lane
Land O Lakes, Fl. 34637

Jo Bennett, Admin. Coord.
Planning Dept.
P. O. Box 1409
Key West, Fl. 33041

Subj: Tree removal application for 618 White St. Key West

Dear Ms. Bennett,

Per our conversation when I brought the application in to remove a mango tree from 618 White St., please find enclosed three photos of the subject tree. On the application, I listed safety as the primary reason for removal.

Figure 1 shows the multi trunk configuration of the tree. As I suspected, the tree is likely to fail at the intersection of the two trunks. After meeting with an arborist, he confirms that is the most likely scenario.

Figure 2 shows damage on the smaller trunk, also a weak spot.

Figure 3 shows the size and location of the tree relative to the closest two houses. As you can see the tree has grown far too large for the area. One trunk leans toward 616 White St. while the smaller trunk leans toward 618 White St. In the event of failure of both trunks in a hurricane, it is likely to take out both houses.

After living in Key Largo for 15 years and being through many hurricanes, I am requesting permission to remove the mango tree in order to prevent damage to my and my neighbor's house during a storm.

Thanks for your assistance.

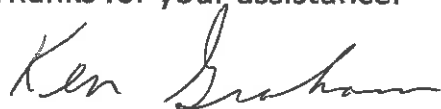
A handwritten signature in cursive script that reads "Ken Graham".