

21-0335
(1) palm
21-0355
(2) palms

T2026-0102



\$ 130.⁰⁰

RECEIVED

APR 29 2026

BY: ZB

Tree Permit Application

Please Clearly Print All Information unless indicated otherwise. Date: 4/20/26

Tree Address 729 Truman
 Cross/Corner Street Windsor
 List Tree Name(s) and Quantity one Royal poinciana / one Gumbo limbe
 Reason(s) for Application:
 Remove Tree Health Safety Other/Explain below
 Transplant New Location Same Property Other/Explain below
 Heavy Maintenance Trim Branch Removal Crown Cleaning/Thinning Crown Reduction
 Additional Information and Explanation Both trees have decay, Dropped large branch and are in decline

Mermaid Key West Group LLC
 Property Owner Name JOE MOFFA (330) 590 8040 ext 7
 Property Owner email Address 729 TRUMAN AVE
 Property Owner Mailing Address ANITA @ ISLAND CITY HOUSE . COM
 Property Owner Phone Number 305-294-5702
 Property Owner Signature [Signature]

*Representative Name John Hartman
 Representative email Address jhartman 90@gmail.com
 Representative Mailing Address 23027 Blugill Ln Cudjoe Key
 Representative Phone Number 305-587-4834

*NOTE: A Tree Representation Authorization form must accompany this application if someone other than the owner will be representing the owner at a Tree Commission meeting or picking up an issued Tree Permit.

As of August 1, 2022, application fees are required. See back of application for fee amounts.

Sketch location of tree (aerial view) including cross/corner street. Please identify tree(s) on the property regarding this application with colored tape or ribbon.

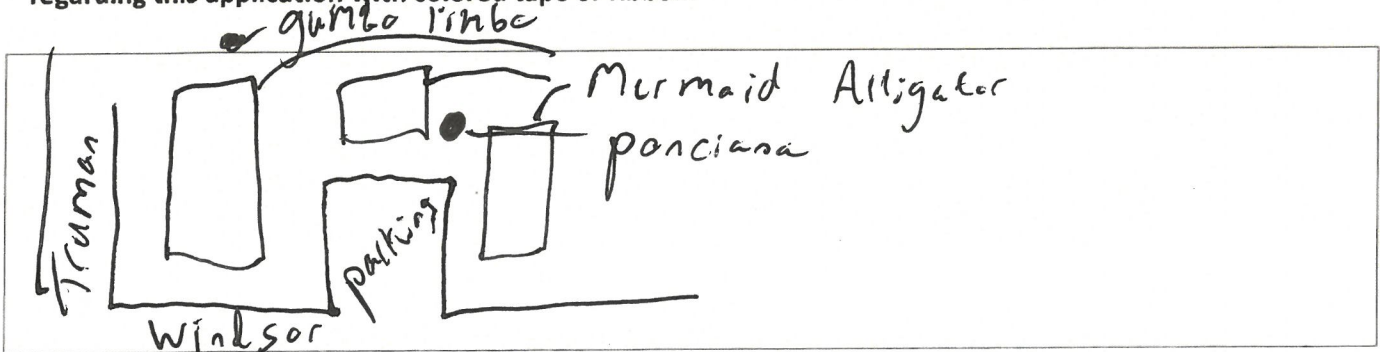



Tree Representation Authorization

Attendance at the Tree Commission meeting on the date when your request will be discussed is necessary in order to expedite the resolution of your application. This Tree Representation Authorization form must accompany the application if the property owner is unable to attend or will have someone else pick up the Tree Permit once issued. Please Clearly Print All Information unless indicated otherwise.

Date 4/20/26
 Tree Address 729 Truman/Mermaid & Alligator
 Property Owner Name JOE MORFA
 Property Owner Mailing Address 729 TRUMAN AVE
 Property Owner Mailing City,
 State, Zip KEY WEST 33040 FL
 Property Owner Phone Number 305-294-5702
 Property Owner email Address ANETA@ISLANDCITYHOUSE.COM
 Property Owner Signature [Signature]

Representative Name John Haltman
 Representative Mailing Address 23027 Bluegill Ln
 Representative Mailing City, Cudjoe Key
 State, Zip FL 33042
 Representative Phone Number 305-587-4834
 Representative email Address jhaltman94@gmail.com

I JOE MORFA hereby authorize the above listed agent(s) to represent me in the matter of obtaining a Tree Permit from the City of Key West for my property at the tree address above listed. You may contact me at the telephone listed above if there are any questions or need access to my property.

Property Owner Signature [Signature]

The forgoing instrument was acknowledged before me on this 20 day 2026

By (Print name of Affiant) PKC who is personally known to me or has produced as identification and who did take an oath.

Notary Public

Sign name: Vivian M. Portela
Print name: [Signature]

My Commission expires: 11/21/2026 Notary Public-State of Florida (Seal)



VIVIAN M. PORTELA
Notary Public
State of Florida
Comm# HH334314
Expires 11/21/2026

Monroe County, FL

PROPERTY RECORD CARD

Disclaimer

The Monroe County Property Appraiser's office maintains data on property within the County solely for the purpose of fulfilling its responsibility to secure a just valuation for ad valorem tax purposes of all property within the County. The Monroe County Property Appraiser's office cannot guarantee its accuracy for any other purpose. Likewise, data provided regarding one tax year may not be applicable in prior or subsequent years. By requesting such data, you hereby understand and agree that the data is intended for ad valorem tax purposes only and should not be relied on for any other purpose.

By continuing into this site you assert that you have read and agree to the above statement.

Summary

Parcel ID 00020420-000000
 Account# 1021172
 Property ID 1021172
 Millage Group 10KW
 Location 729 TRUMAN Ave, KEY WEST
 Address
 Legal Description KW PT LOTS 5 AND 6 SQR 2 TR 5 E1-298 OR30-314/15 OR145-64 OR330-91/92 OR550-277 OR691-749/50 OR1006-288 OR1029-1571 OR1439-389/91 OR1779-651/54 OR1955-2291/92 OR2009-2243/46 OR1975-2153/56 OR2385-259/61 OR2797-1327/29
 (Note: Not to be used on legal documents.)
 Neighborhood 32080
 Property Class HOTEL - GUEST HOUSE (10 ROOMS OR LESS) (3907)
 Subdivision
 Sec/Twp/Rng 06/68/25
 Affordable No
 Housing



Owner

MERMAID KEY WEST GROUP LLC
 387 Medina Rd
 Ste 400
 Medina OH 44256

Valuation

	2025 Certified Values	2024 Certified Values	2023 Certified Values	2022 Certified Values
+ Market Improvement Value	\$1,090,212	\$1,415,688	\$1,452,718	\$1,290,251
+ Market Misc Value	\$545,106	\$606,723	\$207,531	\$182,676
+ Market Land Value	\$1,998,723	\$2,022,412	\$2,490,373	\$2,172,361
= Just Market Value	\$3,634,041	\$4,044,823	\$4,150,622	\$3,645,288
= Total Assessed Value	\$3,634,041	\$4,044,823	\$3,982,661	\$3,620,601
- School Exempt Value	\$0	\$0	\$0	\$0
= School Taxable Value	\$3,634,041	\$4,044,823	\$4,150,622	\$3,645,288

Historical Assessments

Year	Land Value	Building Value	Yard Item Value	Just (Market) Value	Assessed Value	Exempt Value	Taxable Value	Maximum Portability
2024	\$2,022,412	\$1,415,688	\$606,723	\$4,044,823	\$4,044,823	\$0	\$4,044,823	\$0
2023	\$2,490,373	\$1,452,718	\$207,531	\$4,150,622	\$3,982,661	\$0	\$4,150,622	\$0
2022	\$2,172,361	\$1,290,251	\$182,676	\$3,645,288	\$3,620,601	\$0	\$3,645,288	\$0
2021	\$1,645,728	\$1,481,155	\$164,573	\$3,291,456	\$3,291,456	\$0	\$3,291,456	\$0
2020	\$1,531,760	\$1,701,956	\$170,196	\$3,403,912	\$3,403,912	\$0	\$3,403,912	\$0
2019	\$1,671,560	\$1,504,404	\$167,156	\$3,343,120	\$3,326,657	\$0	\$3,343,120	\$0
2018	\$1,512,117	\$1,360,905	\$151,212	\$3,024,234	\$3,024,234	\$0	\$3,024,234	\$0

The Maximum Portability is an estimate only and should not be relied upon as the actual portability amount. Contact our office to verify the actual portability amount.

Land

Land Use	Number of Units	Unit Type	Frontage	Depth
(3900)	16,350.00	Square Foot	100	163.5

Buildings

Building ID	39808	Exterior Walls	AB AVE WOOD SIDING
Style		Year Built	1933
Building Type	HOTELS/MOTEL A / 39A	EffectiveYearBuilt	2000
Building Name		Foundation	
Gross Sq Ft	5547	Roof Type	
Finished Sq Ft	2909	Roof Coverage	
Stories	2 Floor	Flooring Type	
Condition	EXCELLENT	Heating Type	
Perimeter	362	Bedrooms	0
Functional Obs	0	Full Bathrooms	0
Economic Obs	0	Half Bathrooms	0
Depreciation %	33	Grade	550
Interior Walls		Number of Fire PI	0

Code	Description	Sketch Area	Finished Area	Perimeter
OPX	EXC OPEN PORCH	1,128	0	0
FAT	FINISHED ATTIC	1,120	0	0
FLA	FLOOR LIV AREA	2,909	2,909	0
OPU	OP PR UNFIN LL	273	0	0
OUU	OP PR UNFIN UL	84	0	0
SBF	UTIL FIN BLK	33	0	0
TOTAL		5,547	2,909	0

Building ID	62042	Exterior Walls	MIN WOOD SIDING with 70% AVE WOOD SIDING
Style		Year Built	1938
Building Type	HOTEL/MOTEL B / 39B	EffectiveYearBuilt	1999
Building Name		Foundation	
Gross Sq Ft	1618	Roof Type	
Finished Sq Ft	952	Roof Coverage	
Stories	1 Floor	Flooring Type	
Condition	AVERAGE	Heating Type	
Perimeter	140	Bedrooms	0
Functional Obs	0	Full Bathrooms	1
Economic Obs	0	Half Bathrooms	0
Depreciation %	35	Grade	450
Interior Walls		Number of Fire PI	0

Code	Description	Sketch Area	Finished Area	Perimeter
OPX	EXC OPEN PORCH	168	0	0
DCF	F DET CARPORT	162	0	0
FLA	FLOOR LIV AREA	952	952	0
OPF	OP PRCH FIN LL	336	0	0
TOTAL		1,618	952	0

Yard Items

Description	Year Built	Roll Year	Size	Quantity	Units	Grade
CONC PATIO	1932	1933	0 x 0	1	448 SF	2
RW2	1959	1960	0 x 0	1	159 SF	3
BRICK PATIO	1979	1980	0 x 0	1	300 SF	2
FENCES	1985	1986	0 x 0	1	330 SF	2
UTILITY BLDG	1985	1986	8 x 10	1	80 SF	3
WALL AIR COND	1987	1988	0 x 0	1	1 UT	2
WATER FEATURE	1987	1988	0 x 0	1	1 UT	1
WOOD DECK	1987	1988	0 x 0	1	405 SF	2
WOOD DECK	1987	1988	0 x 0	1	64 SF	3
COMM POOL	2000	2001	0 x 0	1	155 SF	4
CH LINK FENCE	1964	1965	0 x 0	1	400 SF	1
FENCES	1987	1988	6 x 45	1	270 SF	3

Sales

Sale Date	Sale Price	Instrument	Instrument Number	Deed Book	Deed Page	Sale Qualification	Grantor	Grantee
5/17/2016	\$3,500,000	Warranty Deed		2797	1327	05 - Qualified		
9/1/2008	\$60,400	Warranty Deed		2385	259	M - Unqualified		
11/24/2003	\$24,300	Warranty Deed		1975	2153	P - Unqualified		
10/18/2001	\$18,600	Warranty Deed		1779	0651	P - Unqualified		
1/1/1997	\$750,000	Warranty Deed		1439	0389	Q - Qualified		
10/1/1987	\$373,500	Warranty Deed		1029	1571	Q - Qualified		
2/1/1977	\$61,000	Conversion Code		691	749	Q - Qualified		

Permits

Number	Date Issued	Status	Amount	Permit Type	Notes
BLD2023-2725	09/26/2023	Completed	\$12,500	Commercial	Emergency roof replacement - Emergency permit due to active leak. Remove existing shingles from the rear roof, marked on pic 1 and 2, approx. 300 sq ft. Remove torch down rubber from the valley area. Install new underlayment. Install new TPO in the valley. Install new Victorian Metal shingles to the roof. Remove first 2 lines of shingles from the lower roof in the left front of the house, marked on pic 3 in order to install new drip edge. Once drip edge installed, install new Victorian metal shingles, first 2 lines only.
23-0634	03/02/2023	Completed	\$7,450	Commercial	ROOF REPLACEMENT
18-2613	07/16/2018	Active	\$4,595	Commercial	TO REMOVE & DISPOSE OF 250 SF OF RUSTED AND DAMAGED METAL SHINGLE ROOFING VALLEY FLASHING & UNDERLAYMENT REPLACE WITH NEW GRACE ICE AND WATERSHIELD, VALLEY FLASHING, DRIP EDGE ON RIDGE CAP. N.O.C REQUIRED.
13-3630	09/02/2013	Completed	\$1,200	Commercial	COMPLETE ELECTRICAL INSTALLATION OF TWENTY SIX INCH RETROFIT RECESSED CANS IN COMMON AREA. MOVING OF ELECTRICAL BOXES IN UPSTAIRS BATHROOM.
12-3249	09/07/2012	Completed	\$7,000	Commercial	REPLACE EXISTING WOOD DECK BOARDS WITH NEW 2X6 EVERGRAIN COMPOSITE DECK BOARDS APPROX 600 SF.
04-2821	08/25/2004	Completed	\$3,500		METAL ROOF
04-2500	07/29/2004	Completed	\$800		REPLACE 2 WINDOWS
0103552	10/30/2001	Completed	\$3,000	Commercial	ROOF VALLEY REPAIRS
0003283	01/26/2001	Completed	\$2,725		RESURFACE POOL
9903387	09/28/1999	Completed	\$13,000		FIRE SPRINKLER SYSTEM
9901501	05/13/1999	Completed	\$2,000		GUTTERS
9901215	04/12/1999	Completed	\$12,000		PAINT & NEW FENCE
9804016	12/22/1998	Completed	\$500		ELECTRICAL
9802850	11/20/1998	Completed	\$20,500	Commercial	NEW BATHROOM ADDITION
9803304	10/22/1998	Completed	\$250		ELECTRICAL
9703860	04/20/1998	Completed	\$800	Commercial	WOOD DECK
9701776	06/01/1997	Completed	\$5,500		CENTRAL A/C
9701821	06/01/1997	Completed	\$1,500		SIGN
9701385	05/01/1997	Completed	\$600		ELECTRICAL (A/C)
9701352	04/01/1997	Completed	\$1,500		ELECTRICAL

View Tax Info

[View Taxes for this Parcel](#)

Sketches (click to enlarge)

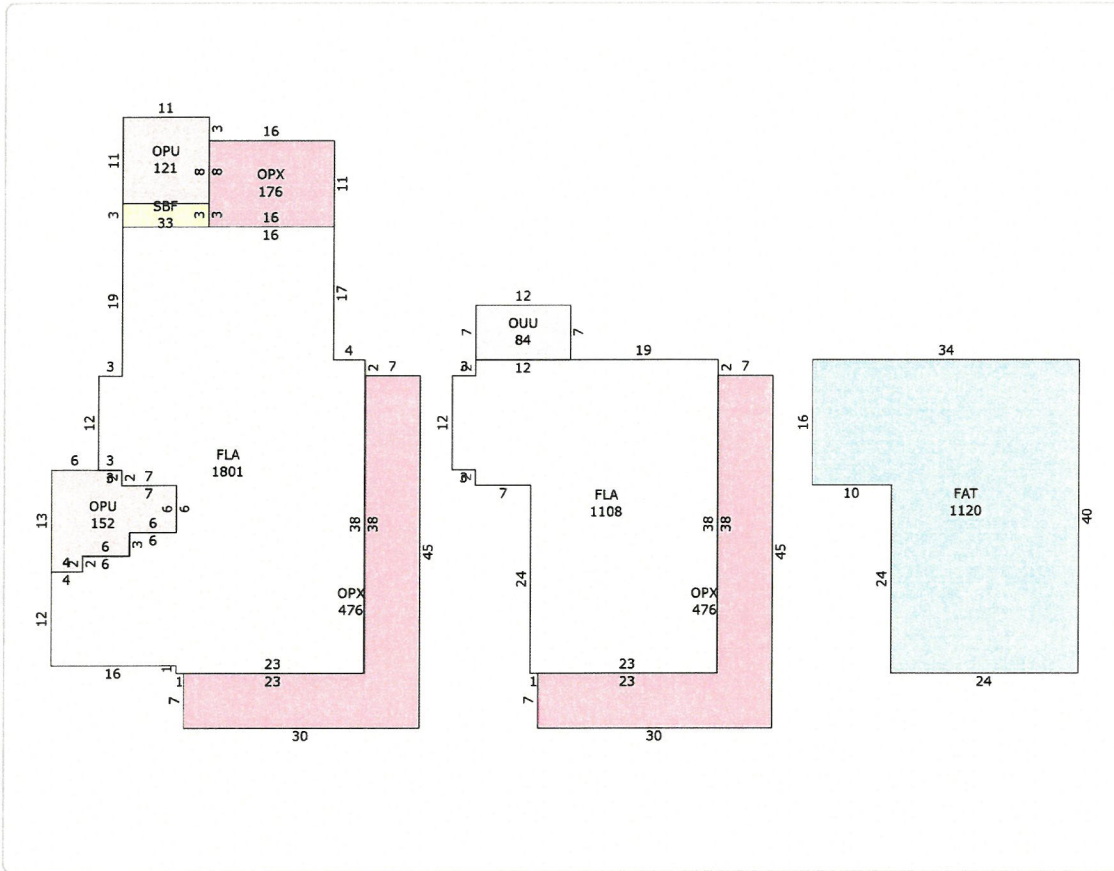

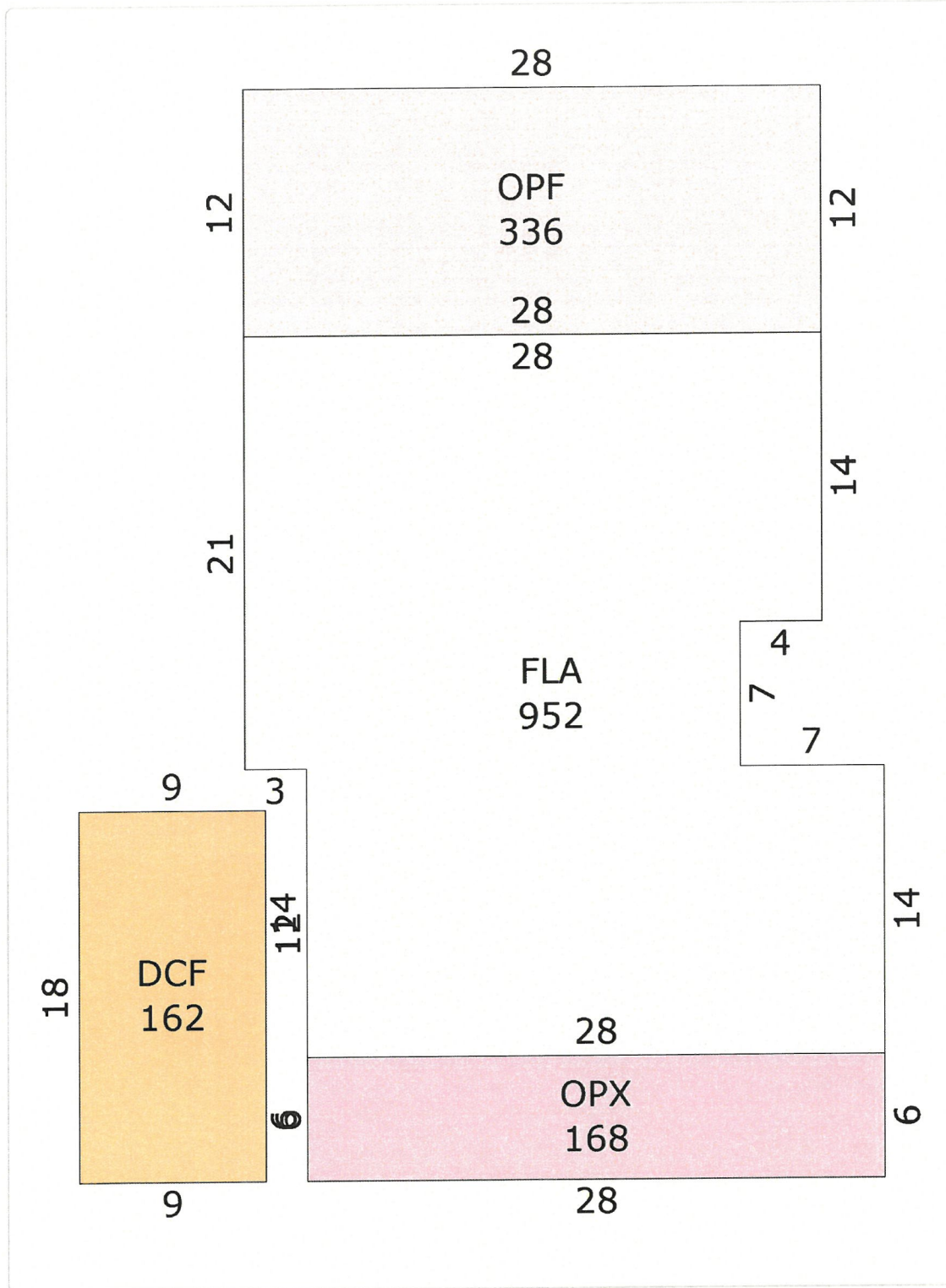

Photos



Map



TRIM Notice

[2025 TRIM Notice \(PDF\)](#)

The Monroe County Property Appraiser's office maintains data on property within the County solely for the purpose of fulfilling its responsibility to secure a just valuation for ad valorem tax purposes of all property within the County. The Monroe County Property Appraiser's office cannot guarantee its accuracy for any other purpose. Likewise, data provided regarding one tax year may not be applicable in prior or subsequent years. By requesting such data, you hereby understand and agree that the

[User Privacy Policy](#) | [GDPR Privacy Notice](#)
 Last Data Upload: 4/28/2026, 11:11:00 PM

[Contact Us](#)

Developed by
SCHNEIDER
 GEOSPATIAL



[Department of State](#) / [Division of Corporations](#) / [Search Records](#) / [Search by Entity Name](#) /

Detail by Entity Name

Foreign Limited Liability Company
MERMAID KEY WEST GROUP, LLC

Filing Information

Document Number M16000002908
FEI/EIN Number 81-1867988
Date Filed 04/07/2016
State OH
Status ACTIVE

Principal Address

387 MEDINA RD SUITE 400
MEDINA, OH 44256

Mailing Address

387 MEDINA RD SUITE 400
MEDINA, OH 44256

Registered Agent Name & Address

C T CORPORATION SYSTEM
1200 SOUTH PINE ISLAND ROAD
PLANTATION, FL 33324

Authorized Person(s) Detail

Name & Address

Title CFO

STEWART, ROBERT
387 MEDINA RD SUITE 400
MEDINA, OH 44256

Title P

LEOHR, DOUGLAS
387 MEDINA RD SUITE 400
MEDINA, OH 44256

Annual Reports

Report Year	Filed Date
2024	02/09/2024

2025 03/21/2025
2026 03/25/2026

Document Images

03/25/2026 -- ANNUAL REPORT	View image in PDF format
03/21/2025 -- ANNUAL REPORT	View image in PDF format
02/09/2024 -- ANNUAL REPORT	View image in PDF format
04/28/2023 -- ANNUAL REPORT	View image in PDF format
01/21/2022 -- ANNUAL REPORT	View image in PDF format
02/02/2021 -- ANNUAL REPORT	View image in PDF format
06/02/2020 -- ANNUAL REPORT	View image in PDF format
04/26/2019 -- ANNUAL REPORT	View image in PDF format
04/25/2018 -- ANNUAL REPORT	View image in PDF format
04/26/2017 -- ANNUAL REPORT	View image in PDF format
04/07/2016 -- Foreign Limited	View image in PDF format