

Specific Purpose Survey Map to illustrate a legal description of a parcel of land adjacent to Lot 2, Square 9, Island of Key West, prepared by the undersigned

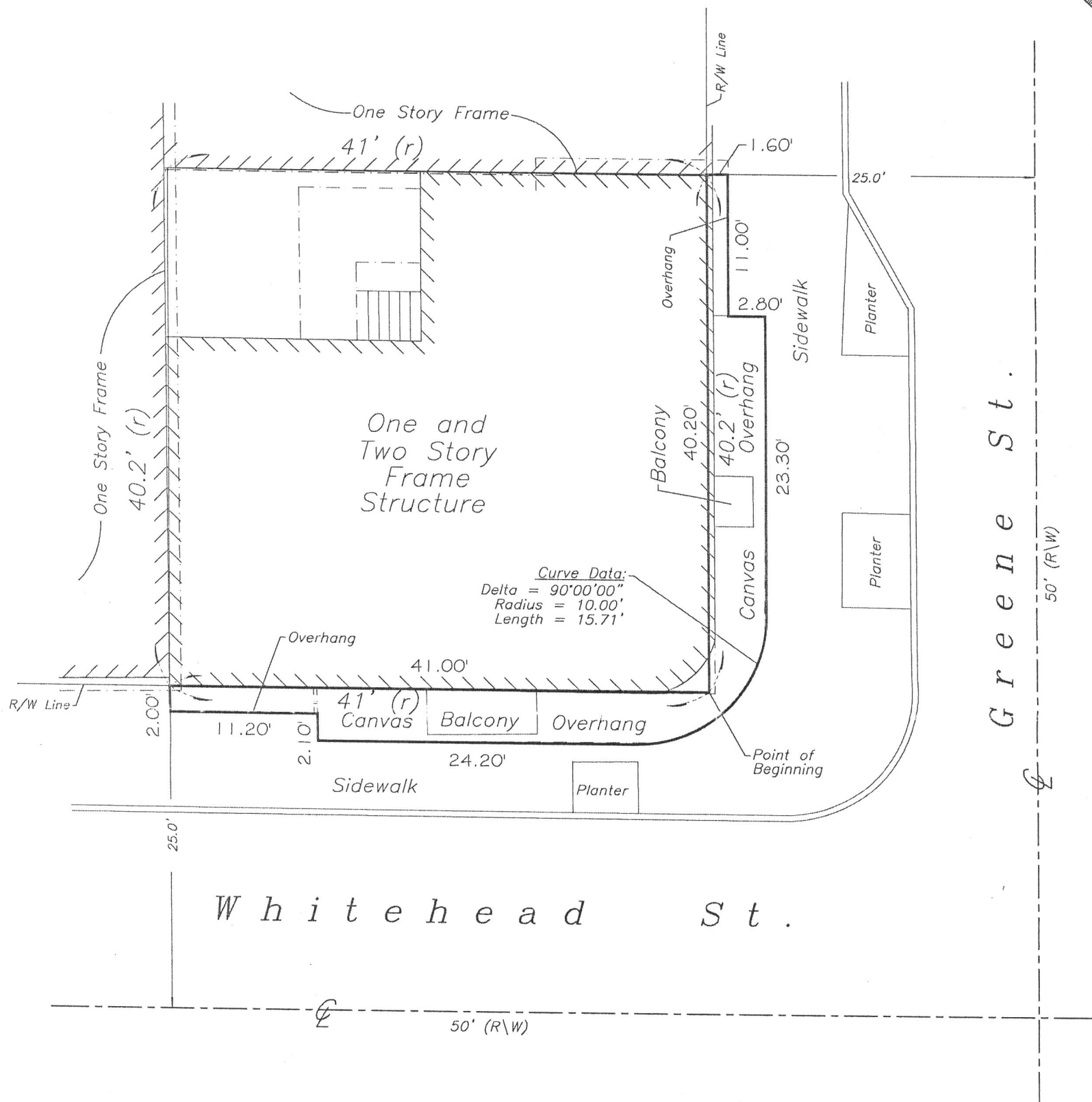
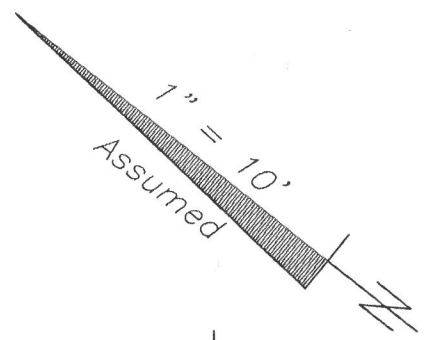

LEGEND

- (M) Measured
- (R) Record
- R\W Right of Way
- ⊕ Centerline

Sheet One of Two Sheets

NOTE:
This Survey Map is not full and complete without the attached Survey Report.

J. LYNN O'FLYNN, Inc.
Professional Surveyor & Mapper
PSM #6298
3430 Duck Ave., Key West, FL 33040
(305) 296-7422 FAX (305) 296-2244

Specific Purpose Survey Report to illustrate a legal description of a parcel of land adjacent to Lot 2, Square 9, Island of Key West, prepared by the undersigned

NOTES:

1. The legal description shown hereon was authored by the undersigned. This survey does not determine or imply ownership.
2. Underground foundations and utilities were not located.
3. All angles are 90° (Measured & Record) unless otherwise noted.
4. Street address: 111 Whitehead Street, Key West, FL.
5. This survey is not valid without the signature and the original raised seal of a Florida licensed surveyor and mapper.
6. Lands shown hereon were not abstracted for rights-of-way, easements, ownership, or other instruments of record.
7. North Arrow is assumed and based on the legal description.
8. Adjoiners are not furnished.
9. The Survey Report is not full and complete without the attached Survey Map.

SPECIFIC PURPOSE SURVEY OF: A parcel of land on the Island of Key West, Monroe County, Florida and being a part of Greene & Whitehead Streets adjacent to Lot 2, Square 9 of William A. Whitehead's Map of said city delineated in February 1829, said parcel being more particularly described by metes and bounds as follows: BEGIN at the intersection of the Northeasterly right of way line of Whitehead Street with the Northwesterly right of way line of Greene Street and run thence Northeasterly along the said Northwesterly right-of-way line of Greene Street for a distance of 40.20 feet to a the Easterly corner of the lands described as Parcel No. 1, in Official Records Book 1294, Page 362, of the Public Records of Monroe County, Florida; thence Southeasterly and at right angles 1.60 feet to the Southeasterly face of an existing overhang of a Frame structure; thence Southwesterly and at right angles along said overhang for a distance of 11.00 feet to an overhang; thence Southeasterly and at right angles along said overhang for a distance of 2.80 feet; thence Southwesterly and at right angles along said overhang for a distance of 23.30 feet to a curve, concave to the north and having for it's elements a radius of 10.00 feet and a central angle of 90°00'00"; thence Westerly and along said curve and said overhang for an arc distance of 15.71 feet to a point; thence Northwesterly and along said overhang for a distance of 24.20 feet; thence Northeasterly and at right angles along said overhang for a distance of 2.10 feet; thence Northwesterly and at right angles for a distance of 11.20 feet along an overhang to the Southwesterly projection of the Northwesterly boundary line of the said lands described as Parcel No. 1, in Official Records Book 1294, Page 362; thence Northeasterly and at right angle for distance of 2.00 feet to the said Northeasterly right of way line of Whitehead Street and the Westerly corner of the said lands described as Parcel No. 1, in Official Records Book 1294, Page 362; thence Southeasterly and at right angles along the said Northeasterly right of way line of Whitehead Street for a distance of 41.00 feet back to the Point of Beginning, containing 287 square feet, more or less.

SPECIFIC PURPOSE SURVEY FOR: Tracey Rupp;

I HEREBY CERTIFY that this survey was made under my responsible charge and meets the Standard of Practice as set forth by the Florida Board of Professional Surveyors & Mappers in Chapter 5J-17, Florida Administrative Code, pursuant to Section 472.027, Florida Statutes.

J. LYNN O'FLYNN, INC.

J. Lynn O'Flynn, PSM
Florida Reg. #6298

THIS SURVEY
IS NOT
ASSIGNABLE

March 28, 2016

Sheet Two of Two Sheets

J. LYNN O'FLYNN, Inc.



Professional Surveyor & Mapper
PSM #6298

3430 Duck Ave., Key West, FL 33040
(305) 296-7422 FAX (305) 296-2244