



Disclaimer

The Monroe County Property Appraiser's office maintains data on property within the County solely for the purpose of fulfilling its responsibility to secure a just valuation for ad valorem tax purposes of all property within the County. The Monroe County Property Appraiser's office cannot guarantee its accuracy for any other purpose. Likewise, data provided regarding one tax year may not be applicable in prior or subsequent years. By requesting such data, you hereby understand and agree that the data is intended for ad valorem tax purposes only and should not be relied on for any other purpose.

By continuing into this site you assert that you have read and agree to the above statement.

Summary

Parcel ID 00065820-000100
 Account# 1068683
 Property ID 1068683
 Millage Group 10KW
 Location 3420 NORTHSIDE Dr, KEY WEST
 Address
 Legal KW PLAT OF SURVEY OF LANDS ON ISLAND OF KEY WEST MONROE COUNTY FLA PT TR 18
 Description PB3-35 OR432-661/662 OR724-749 OR798-2095 OR837-2241/2244AG OR860-2066 OR942-2425 OR1436-917/919(MERGER) OR1651-444/446
 (Note: Not to be used on legal documents.)
 Neighborhood 31100
 Property Class ONE STORY OFFICE (1700)
 Subdivision
 Sec/Twp/Rng 34/67/25
 Affordable No
 Housing



Owner

COOKE COMMUNICATIONS LLC
 701 Simonton St
 Key West FL 33040

Valuation

	2018	2017	2016	2015
+ Market Improvement Value	\$1,678,064	\$1,250,447	\$1,122,950	\$1,122,950
+ Market Misc Value	\$120,335	\$120,335	\$131,967	\$119,812
+ Market Land Value	\$2,556,789	\$5,502,000	\$5,502,000	\$5,502,000
= Just Market Value	\$4,355,188	\$6,872,782	\$6,756,917	\$6,744,762
= Total Assessed Value	\$4,355,188	\$5,997,732	\$5,452,484	\$4,956,804
- School Exempt Value	\$0	\$0	\$0	\$0
= School Taxable Value	\$4,355,188	\$6,872,782	\$6,756,917	\$6,744,762

Land

Land Use	Number of Units	Unit Type	Frontage	Depth
COMMERCIAL DRY (100D)	73,750.00	Square Foot	137	410
ENVIRONMENTALLY SENS (000X)	0.24	Acreage	156	78

Commercial Buildings

Style OFF BLDG 1 STY-A / 17A
 Gross Sq Ft 12,784
 Finished Sq Ft 11,731
 Perimeter 0
 Stories 2
 Interior Walls
 Exterior Walls C.B.S.
 Quality 450 ()
 Roof Type
 Roof Material
 Exterior Wall1 C.B.S.
 Exterior Wall2
 Foundation
 Interior Finish
 Ground Floor Area
 Floor Cover
 Full Bathrooms 0
 Half Bathrooms 0
 Heating Type
 Year Built 1988
 Year Remodeled
 Effective Year Built 2010
 Condition

Code	Description	Sketch Area	Finished Area	Perimeter
CAN	CANOPY	147	0	0
FLA	FLOOR LIV AREA	11,731	11,731	0
CLP	LOAD PLATFORM	56	0	0

Code	Description	Sketch Area	Finished Area	Perimeter
OPU	OP PR UNFIN LL	654	0	0
ULP	UNFIN LOAD PLT	196	0	0
TOTAL		12,784	11,731	0

Yard Items

Description	Year Built	Roll Year	Quantity	Units	Grade
FENCES	1987	1988	1	242 SF	4
CH LINK FENCE	1987	1988	1	2500 SF	1
CONC PATIO	1987	1988	1	28732 SF	2
ASPHALT PAVING	1987	1988	1	800 SF	1

Sales

Sale Date	Sale Price	Instrument	Instrument Number	Deed Book	Deed Page	Sale Qualification	Vacant or Improved
8/23/2000	\$2,500,000	Warranty Deed		1651	0444	Q - Qualified	Improved
5/1/1985	\$360,000	Warranty Deed		942	2425	Q - Qualified	Vacant
8/1/1982	\$225,000	Warranty Deed		860	2066	Q - Qualified	Vacant
10/1/1979	\$160,000	Conversion Code		798	2095	Q - Qualified	Vacant

Permits

Number	Date Issued	Date Completed	Amount	Permit Type	Notes
14-1964	5/13/2014		\$8,500		INSTALL NEW FABRIC TO EXISTING AWNINGS
14-2046	5/10/2014		\$1,162		REINSTALL WALL LETTERING ON BACK OF BUILDING
06-5478	9/29/2006	12/18/2006	\$10,000		200' OF 6' BOX RAIN GUTTERS
06-4925	8/18/2006	12/18/2006	\$116,000		REMOVAL OF EXISTING ROOFING MATERIAL - INSTALL NEW 10,348 SF SYSTEM
06-4198	7/11/2006	12/18/2006	\$4,400	Commercial	CHANGE OUT A 5-TON A/C.
05-3594	8/24/2005	11/30/2005	\$2,350	Commercial	MAINTENENCE OF ROOF -NO NEW WORK
05-3206	8/2/2005	11/30/2005	\$14,000	Commercial	CHANGE OUT ONE 2.5 TON A/C
04-2059	6/30/2004	10/15/2004	\$4,400	Commercial	PARTION, PAINT, CARPET...
04-1640	5/20/2004	10/15/2004	\$1,650	Commercial	AWNING OVER REAR DOCK
03-0615	3/4/2003	12/16/2003	\$1,800	Commercial	INSTALL DUCTLESS A/C
98-0944	3/24/1998	12/31/1998	\$4,445	Commercial	ELECTRICAL
97-0247	1/1/1997	8/1/1997	\$12,000	Commercial	MECHANICAL
M952270	7/1/1995	12/1/1995	\$2,505	Commercial	REPLACE 15TON CONDENSOR
B932537	9/1/1993	6/1/1994	\$75,000	Commercial	ADDITION

Sketches (click to enlarge)

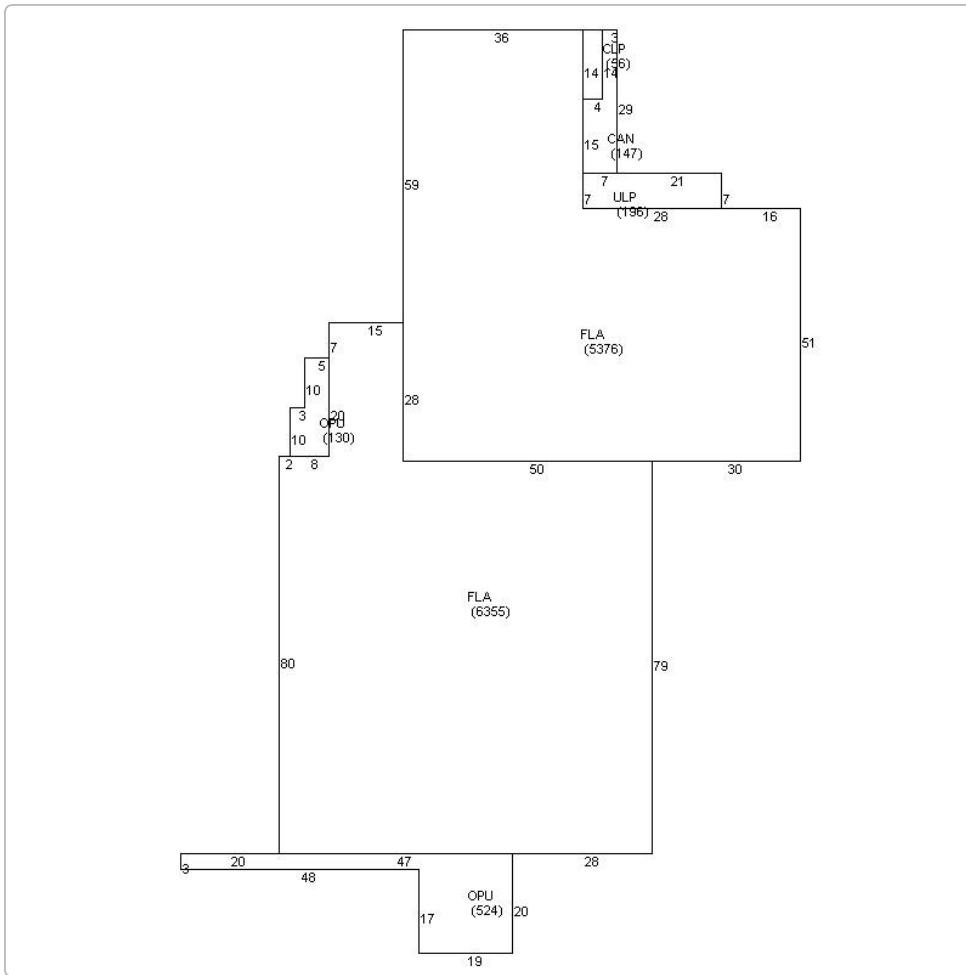

Photos



Map



TRIM Notice

Trim Notice

2018 Notices Only

No data available for the following modules: Buildings, Mobile Home Buildings, Exemptions.

The Monroe County Property Appraiser's office maintains data on property within the County solely for the purpose of fulfilling its responsibility to secure a just valuation for ad valorem tax purposes of all property within the County. The Monroe County Property Appraiser's office cannot guarantee its accuracy for any other purpose. Likewise, data provided regarding one tax year may not be applicable in prior or subsequent years. By requesting such data, you hereby understand and agree that the

Last Data Upload: 12/21/2018 1:41:51 AM

