

Specific Purpose Survey to illustrate a legal description
of portion of Havana Avenue, Island of Key West
prepared by the undersigned

LEGEND

R/W Right of Way
⊕ Centerline

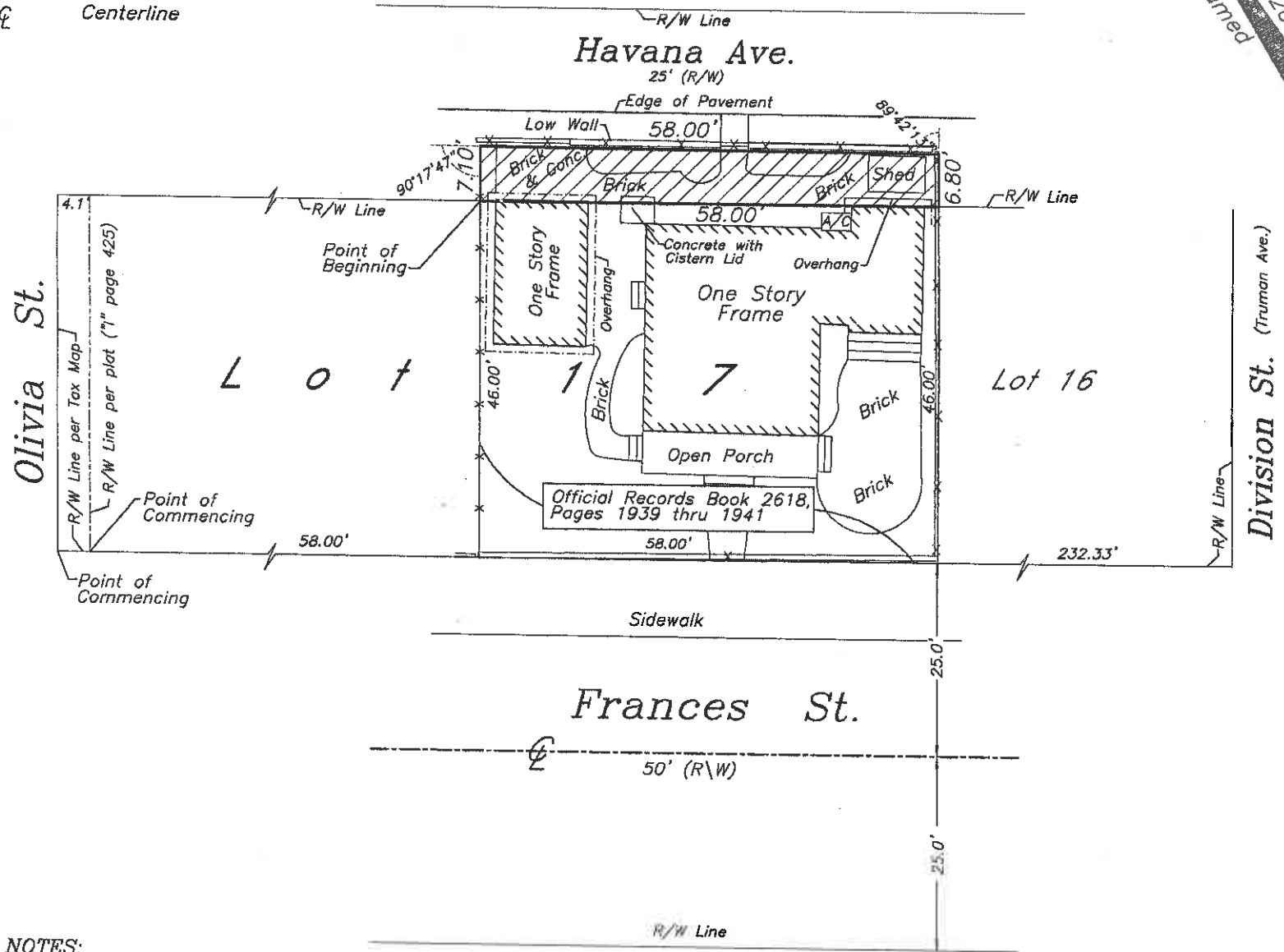
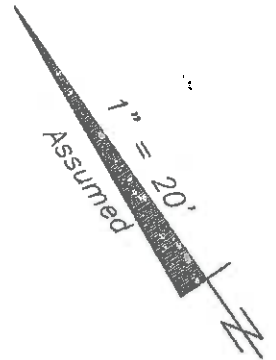

NOTES:

1. The legal description shown hereon was authored by the undersigned.
2. Underground foundations and utilities were not located.
3. All angles are 90° (Measured & Record) unless otherwise noted.
4. Street address: 907 Frances Street, Key West, FL.
5. This survey is not valid without the signature and the original raised seal of a Florida licensed surveyor and mapper.
6. Lands shown hereon were not abstracted for rights-of-way, easements, ownership, or other instruments of record.
7. North Arrow is assumed and based on the legal description.
8. This survey is not assignable.
9. Adjoiners are not furnished.
10. The description contained herein and sketch do not represent a field boundary survey.

SPECIFIC PURPOSE SURVEY TO ILLUSTRATE A LEGAL DESCRIPTION
AUTHORED BY THE UNDERSIGNED

A parcel of land on the Island of Key West, and known as part of Havana Lane in Tract 6, adjacent to Lot 17 in Square 3 of John Lowe's Subdivision of said Tract 6 according to Deed Book I, Page 425 of the Public Records of Monroe County, Florida, said parcel being more particularly described by metes and bounds as follows:

COMMENCE at the intersection of the Southeasterly right of way line of Olivia Street with the Northeasterly right of way line of Frances Street and run thence Southeasterly along the Northeasterly right of way line of the said Frances Street for a distance of 58.00 feet to the Westerly corner of the lands described in Official Record Book 2618 at Pages 1939 thru 1941 of the Public Records of said County; thence Northeasterly and at right angles along the Northwesternly boundary line of the said lands for a distance of 46.00 feet to the Southwesterly right of way line of Havana Lane, said point being the Northerly corner of said lands and also being the Point of Beginning; thence Southeasterly and at right angles along the Southwesterly right of way line of Havana Lane for a distance of 58.00 feet to the Easterly corner of said lands; thence Northeasterly and at right angles for a distance of 6.80 feet to a point; thence Northwesternly with a deflection angle of 89°42'13" to the left for a distance of 58.00 feet; thence Southwesterly with a deflection angle of 90°17'47" to the left for a distance of 7.10 feet back to the Point of Beginning, containing 403 square feet, more or less.

SPECIFIC PURPOSE SURVEY FOR: Carolyn Sprogel;

J. LYNN O'FLYNN, INC.

J. Lynn O'Flynn, PSM
Florida Reg. #6298

June 8, 2015

J. LYNN O'FLYNN, Inc.



Professional Surveyor & Mapper
PSM #6298

3430 Duck Ave., Key West, FL 33040
(305) 296-7422 FAX (305) 296-2244