

Plan of Amphitheater

1 PLAN VIEW OF AMPHITHEATER BUILDING

A4-01 SCALE: N/A

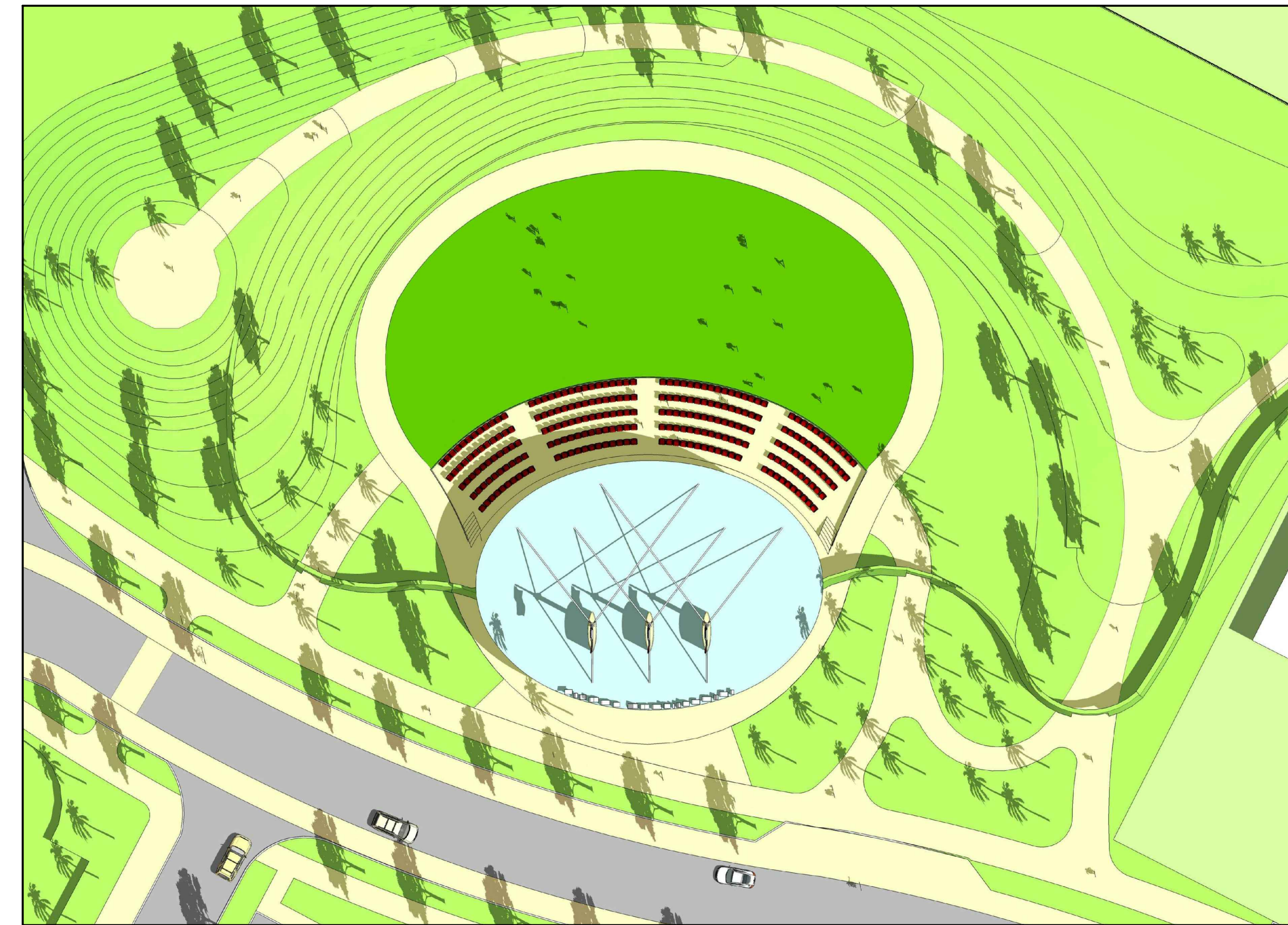

3 PLAN VIEW OF AMPHITHEATER

A4-01 SCALE: N/A

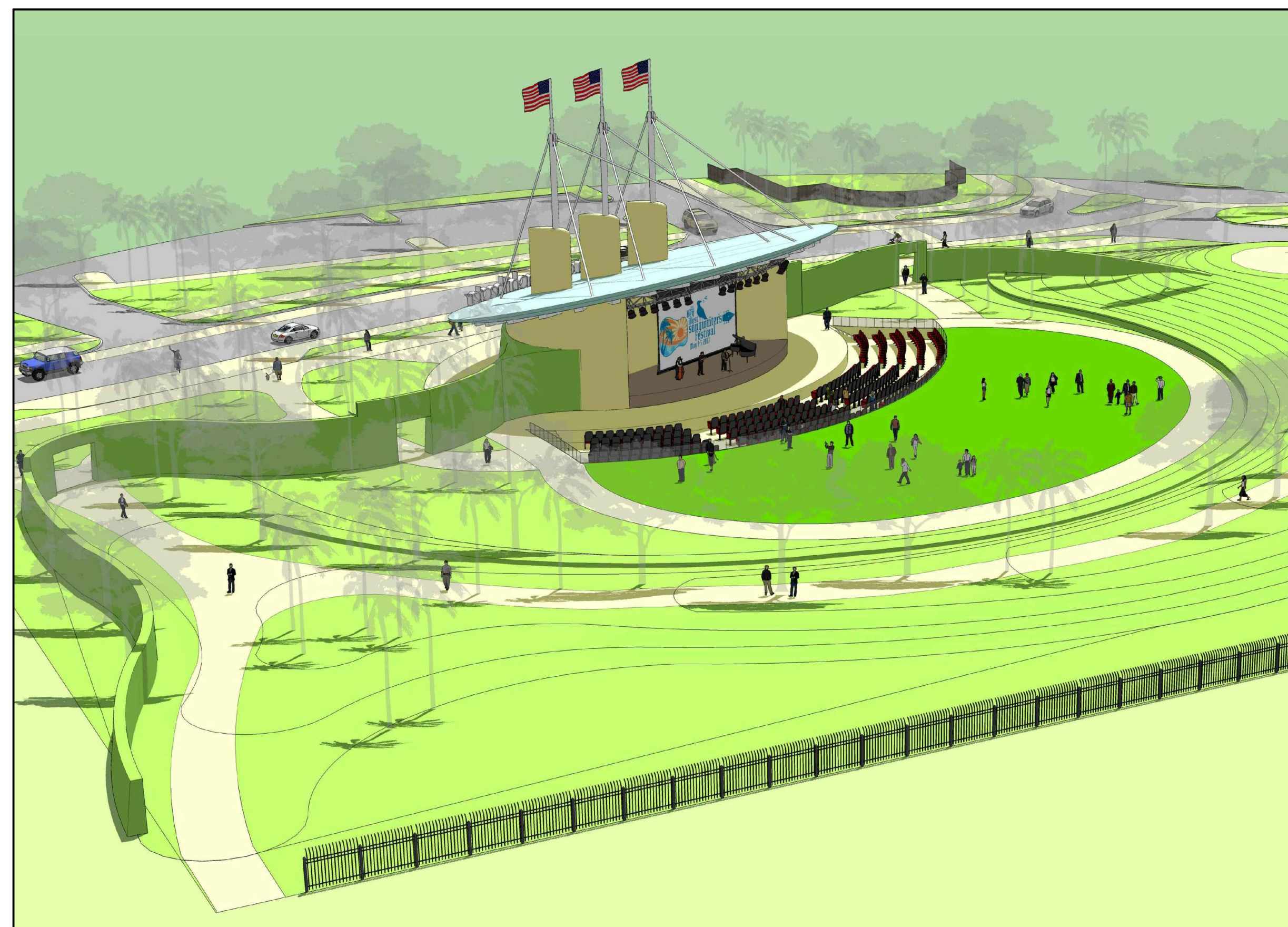

2 BIRD'S EYE VIEW FROM THE NORTH

A4-01 SCALE: N/A

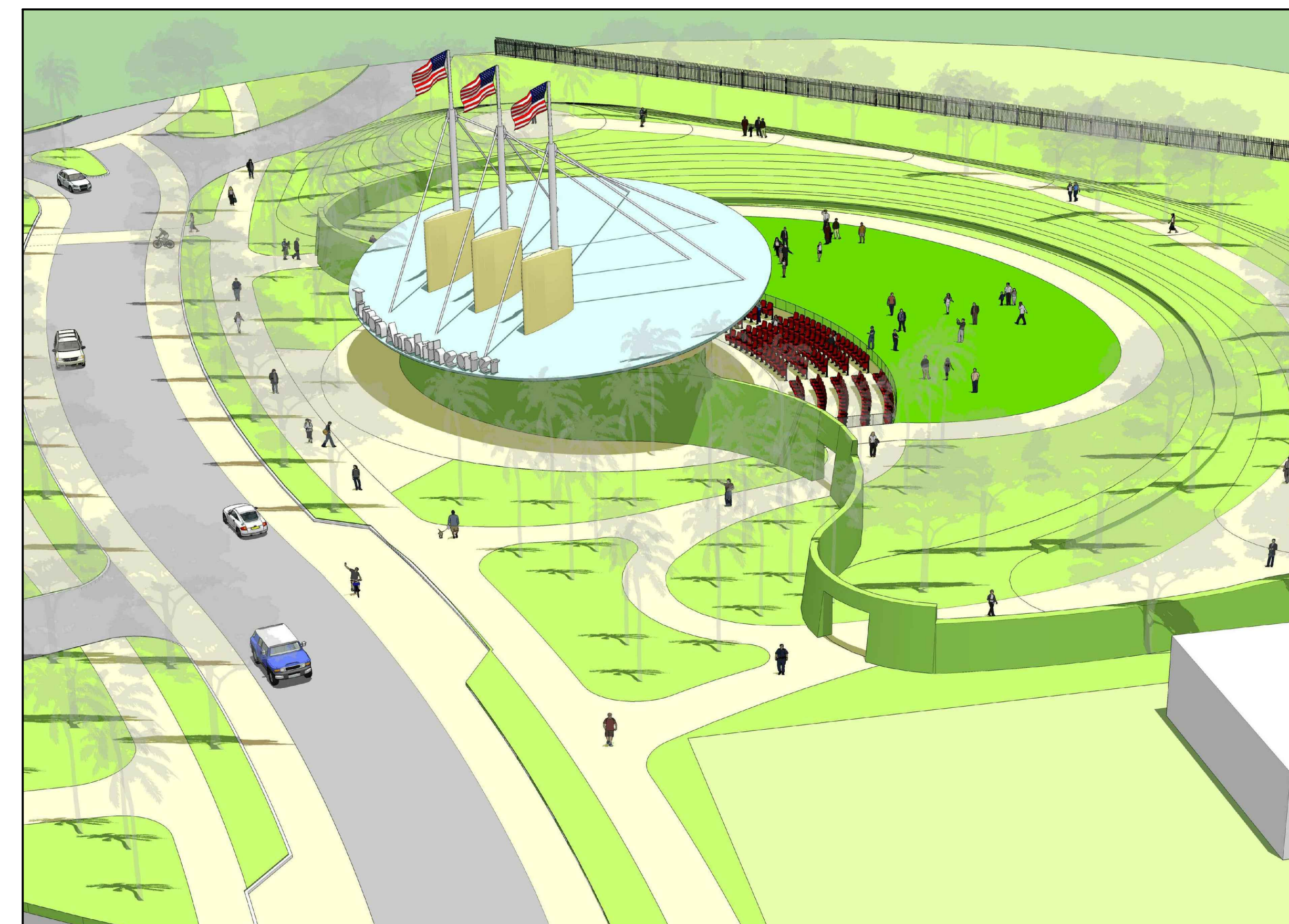

4 BIRD'S EYE VIEW FROM THE EAST

A4-01 SCALE: N/A



BERMELLO AJAMIL & PARTNERS • INC
 Architecture • Engineering • Planning
 Interior Design • Landscape Architecture
 2601 South Bayshore Drive
 Suite 1000
 Miami, Florida 33133
 (305) 859-2050
 Fax (305) 860-3700

PREPARED FOR/OWNER:
 CITY OF KEY WEST, FL
 P. O. BOX 1409
 3140 FLAGLER AVENUE
 KEY WEST, FL 33041



PROJECT NAME:
TRUMAN WATERFRONT PARK

PROJECT LOCATION/ADDRESS:
 TRUMAN WATERFRONT PARK
 WEST OF FORT STREET AND THE
 TRUMAN ANNEX DEVELOPMENT,
 NORTH OF KEY WEST NAVAL BASE

SUB-CONSULTANT INFORMATION:

PROFESSIONAL SEAL:

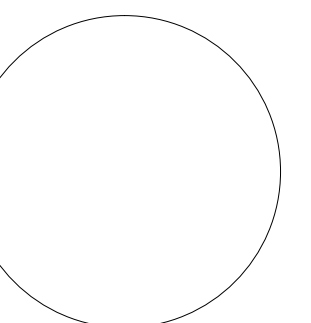

TODD OSBORN, R.A.
 AR 92877

SUBMITTAL DESCRIPTION / MILESTONE:

DEVELOPMENT APPLICATION
 March 3, 2014

REVISIONS:
 1 02/22/2013
 2 06/28/2013 Response to Navy Review

DRAWING SHEET INFORMATION

BA PROJECT NO.: 12010
 SCALE: AS NOTED
 DATE: February 12, 2014
 DRAWN BY: Y1
 CHECKED BY: SB
 CADD FILE: X:\Truman Waterfront Base.dwg

DRAWING TITLE:
AMPHITHEATER RENDERINGS

SHEET NO.

A4-01



1 BIRD'S EYE VIEW FROM THE WEST

A4-02 SCALE: N/A

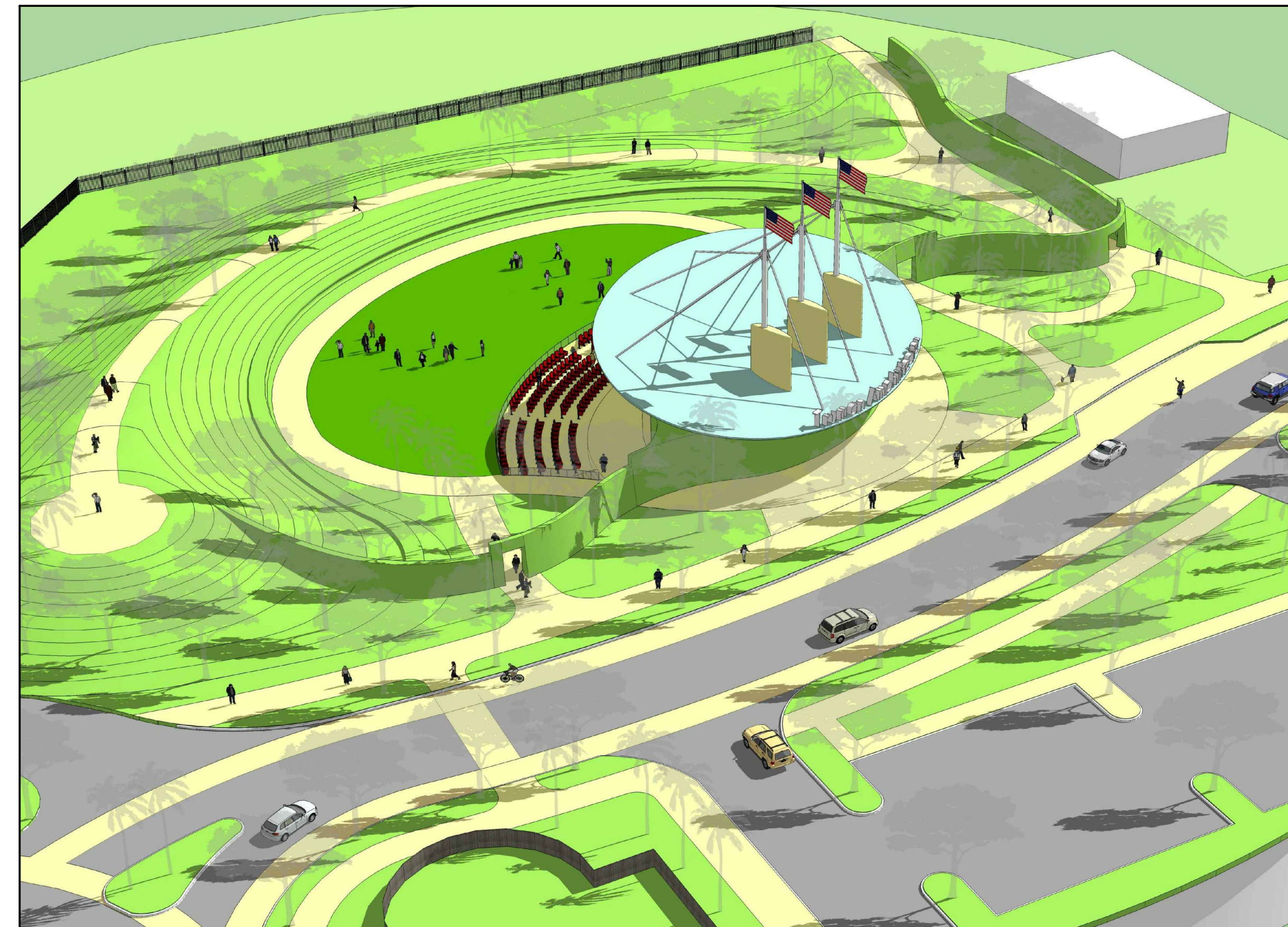

3 BIRD'S EYE VIEW FROM THE SOUTH

A4-02 SCALE: N/A

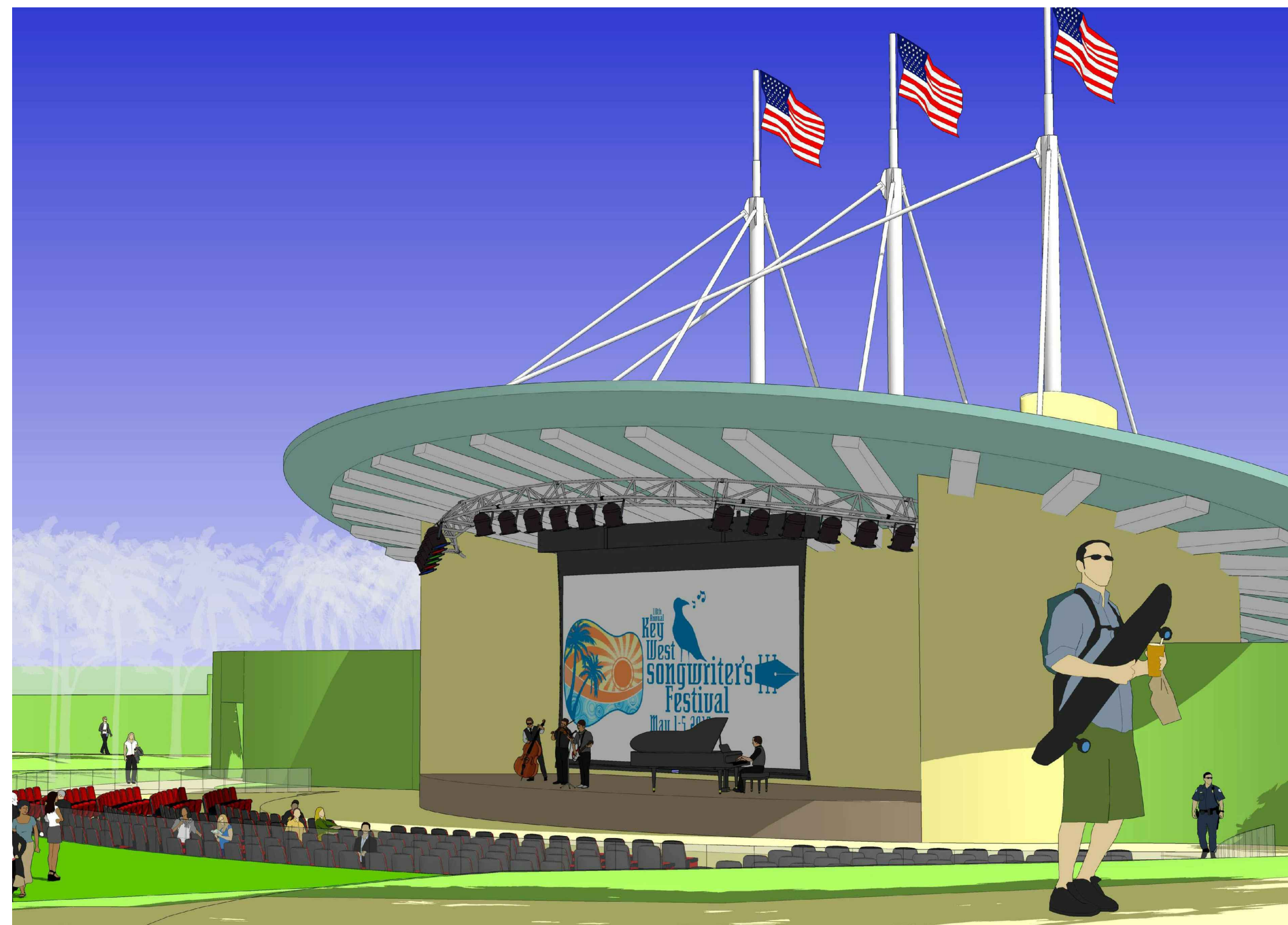

2 GROUND LEVEL VIEW FROM THE WEST

A4-02 SCALE: N/A

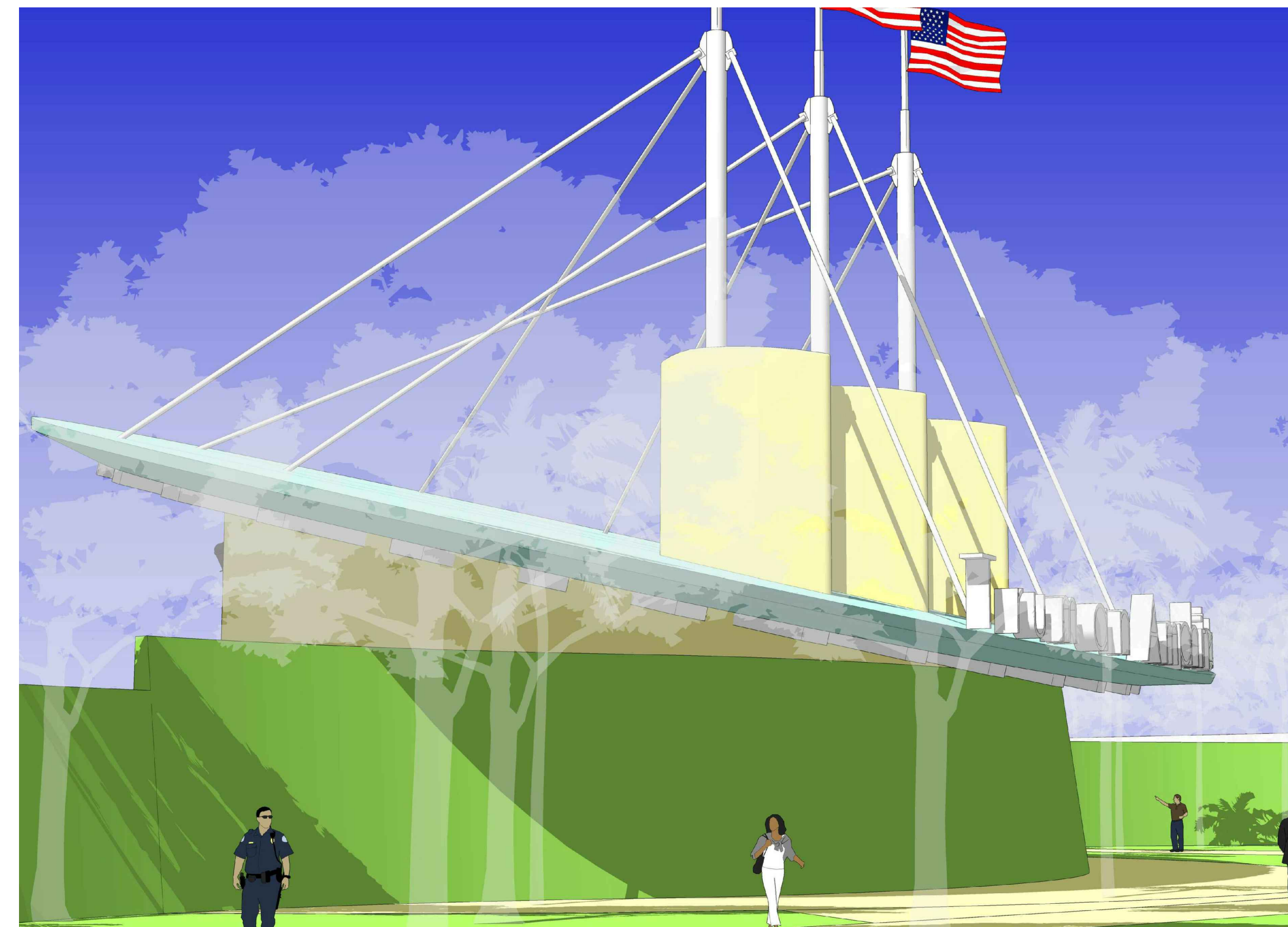

4 GROUND LEVEL VIEW FROM THE SOUTHWEST

A4-02 SCALE: N/A



BERMELLO AJAMIL & PARTNERS • INC

Architecture • Engineering • Planning
Interior Design • Landscape Architecture
2601 South Bayshore Drive
Suite 1000
Miami, Florida 33133
(305) 859-2050
Fax (305) 860-3700

PREPARED FOR/OWNER:
CITY OF KEY WEST, FL
P. O. BOX 1409
3140 FLAGLER AVENUE
KEY WEST, FL 33041



PROJECT NAME:
TRUMAN WATERFRONT PARK

PROJECT LOCATION/ADDRESS:
TRUMAN WATERFRONT PARK
WEST OF FORT STREET AND THE
TRUMAN ANNEX DEVELOPMENT,
NORTH OF KEY WEST NAVAL BASE

SUB-CONSULTANT INFORMATION:

PROFESSIONAL SEAL:

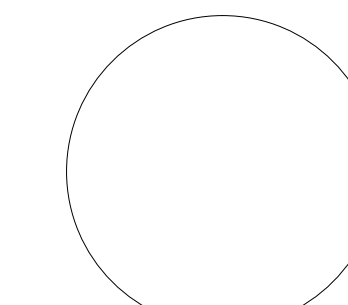

TODD OSBORN, R.A.
AR 92877

SUBMITTAL DESCRIPTION / MILESTONE:

DEVELOPMENT APPLICATION
March 3, 2014

REVISIONS:

- 1 02/22/2013
- 2 06/28/2013 Response to Navy Review

DRAWING SHEET INFORMATION

BA PROJECT NO.: 12010
SCALE: AS NOTED
DATE: February 12, 2014
DRAWN BY: Y1
CHECKED BY: SB
CADD FILE: X:\Truman Waterfront Base.dwg

DRAWING TITLE:
AMPHITHEATER RENDERINGS

SHEET NO.

A4-02

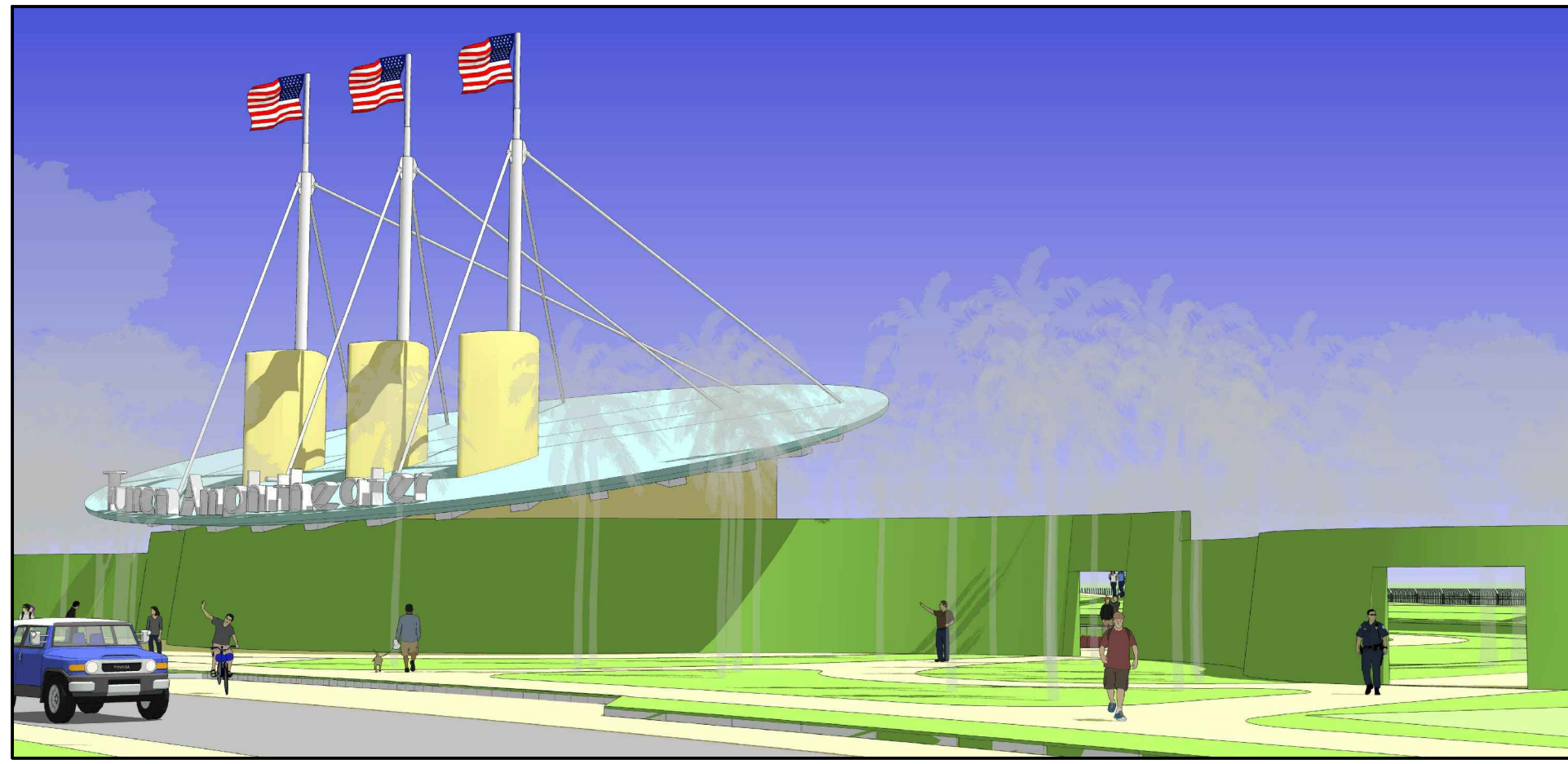

1 GROUND LEVEL VIEW FROM THE EAST
A4-03 SCALE: N/A

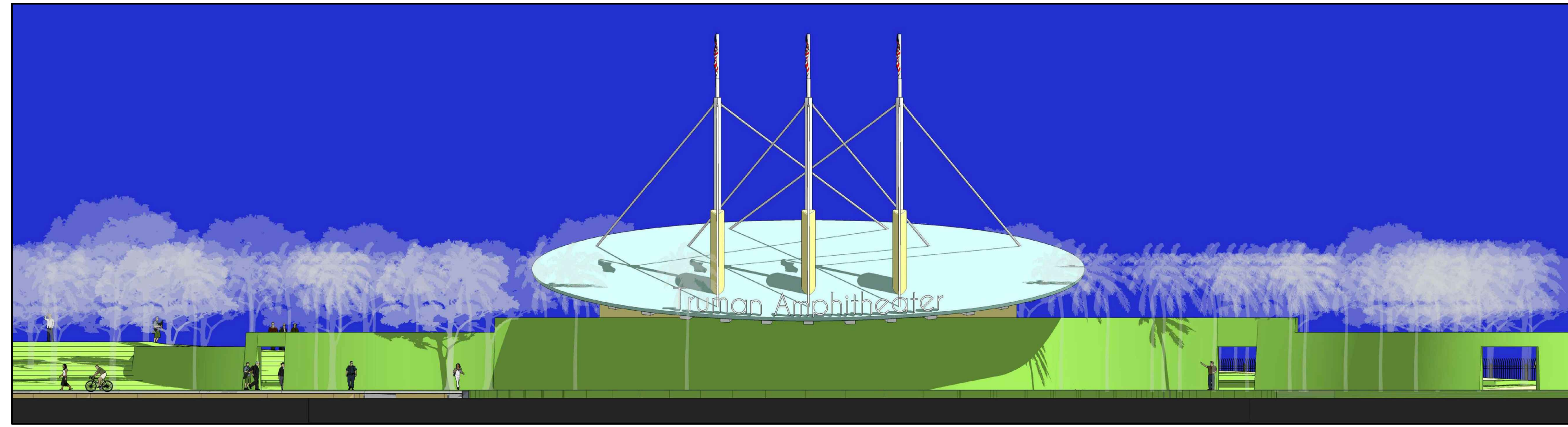

4 SOUTH ELEVATION
A4-03 SCALE: N/A



2 NORTH ELEVATION
A4-03 SCALE: N/A



3 EAST ELEVATION
A4-03 SCALE: N/A



BERMELLO AJAMIL & PARTNERS • INC
Architecture • Engineering • Planning
Interior Design • Landscape Architecture
2601 South Bayshore Drive
Suite 1000
Miami, Florida 33133
(305) 859-2050
Fax (305) 860-3700

PREPARED FOR/OWNER:
CITY OF KEY WEST, FL
P. O. BOX 1409
3140 FLAGLER AVENUE
KEY WEST, FL 33041



PROJECT NAME:
TRUMAN WATERFRONT PARK

PROJECT LOCATION/ADDRESS:
**TRUMAN WATERFRONT PARK
WEST OF FORT STREET AND THE
TRUMAN ANNEX DEVELOPMENT,
NORTH OF KEY WEST NAVAL BASE**

SUB-CONSULTANT INFORMATION:

PROFESSIONAL SEAL:

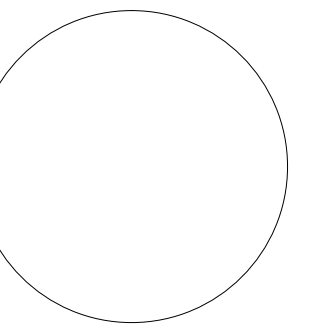

TODD OSBORN, R.A.
AR 92877

SUBMITTAL DESCRIPTION / MILESTONE:

**DEVELOPMENT APPLICATION
March 3, 2014**

REVISIONS:
1 02/22/2013
2 06/28/2013 Response to Navy Review

DRAWING SHEET INFORMATION

BA PROJECT NO.: 12010
SCALE: AS NOTED
DATE: February 12, 2014
DRAWN BY: Y1
CHECKED BY: SB
CADD FILE: X:\Truman Waterfront Base.dwg

DRAWING TITLE:
AMPHITHEATER RENDERINGS

SHEET NO.

A4-03