

ELIZABETH  
NEWLAND

LANDSCAPE  
ARCHITECTURE, LLC

P.O. BOX 140908  
CORAL GABLES, FL. 33114  
305-481-6301  
LA 0001288

WATERFRONT BREWERY

201 WILLIAM STREET  
KEY WEST BIGHT, FL.

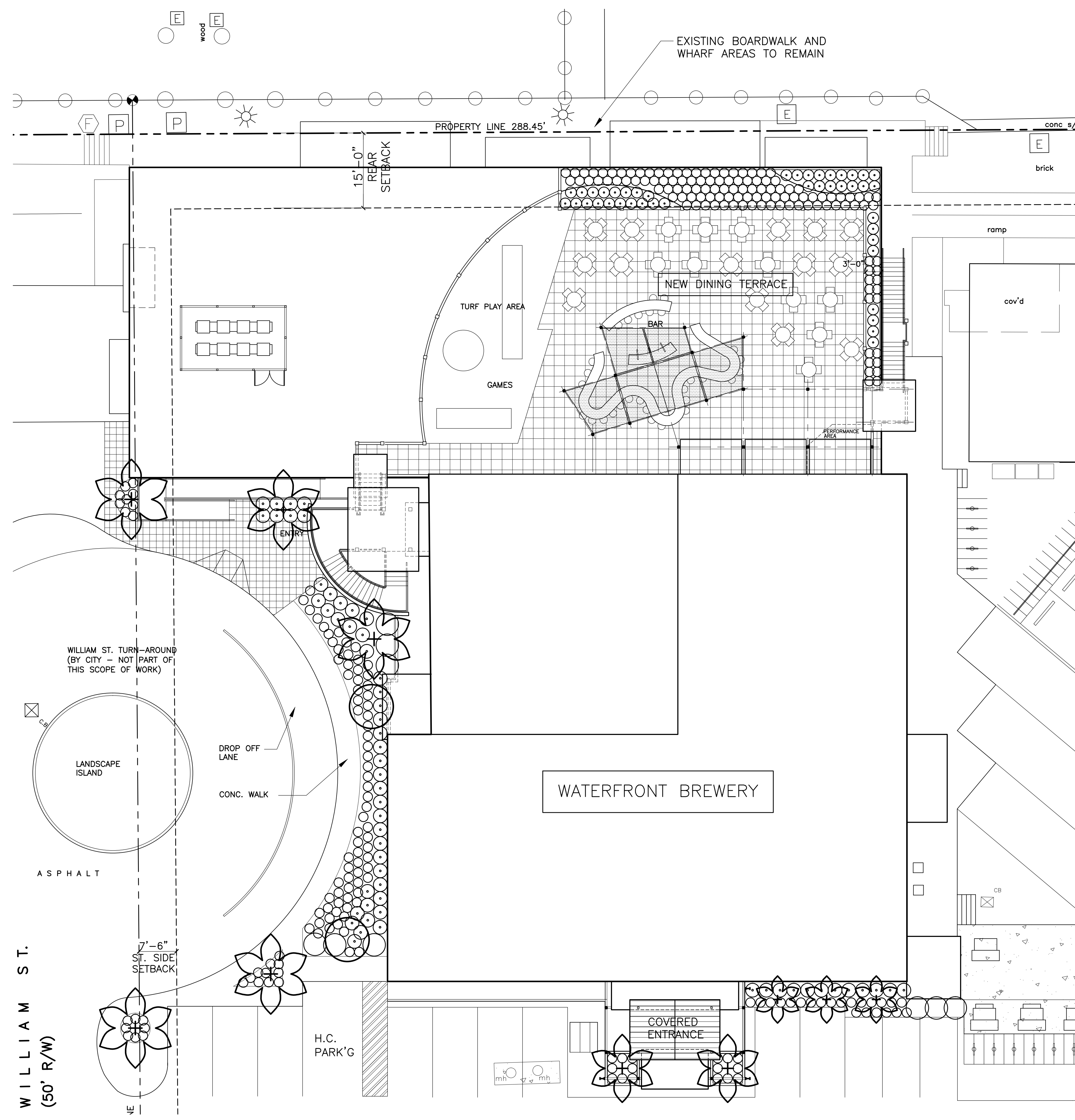

WATERFRONT BREWERY PLANT LIST										
SYMBOL	QUAN.	SCIENTIFIC NAME	COMMON NAME	NATIVE	CALIPER	HEIGHT	CANOPY	CONTAINER	SPACING	CONDITION
<b>TREES</b>										
+	BOS	Bourneria succulenta	Strongbark	Yes	3"-4"	10'-12'	8'-10'	45 Gal	As Shown	Tree Type
	CES	Conocarpus erectus 'sericeus'	Silver Buttonwood	Yes	NA	8'-10'	4'-6'	45 Gal	7' O.C.	Shrub Type
	COD	Coccoloba diversifolia	Pigeon Plum	Yes	3"-4"	12'-14'	8'-10'	45 Gal	As Shown	6' CT
	COS	Cordia sebestena	Orange Geiger	Yes	3"-4"	12'-14'	8'-10'		As Shown	6' CT
	GUS	Guaiacum sanctum	Lignum vitae	Yes	2"-3"	8'-10'	8'-10'	45 Gal	As Shown	Tree Type
<b>PALMS</b>										
+	CON	Cocos nucifera	Coconut Palm	No	12'-16"	26'-28' OA	20'-22'	B&B	As Shown	12' Grey Wood
	PTE	Ptychosperma elegans	Alexander Palm	No	6"-8"	10'-12'	8'-10'	B&B	As Shown	Multi
	SAP	Sabal palmetto	Palmetto	Yes	12'-16"	10'-14'	8'-10'	B&B	As Shown	With Boots
	THR	Thrinax radiata	Thatch Palm	Yes	2"-3"	4'-6"	4'-6"	30 Gal	As Shown	Multi
	VEM	Veitchii montgomeryana	Montgomery Palm	No	12'-16"	12'-14'	8'-10'	B&B	As Shown	Single
<b>LARGE SHRUBS</b>										
○	CAC	Capparis cynophallophora	Jamaican Caper	Yes	NA	6'-8"	3'-4'	30 Gal	7' O.C.	Shrub Type
	EUF	Eugenia foetida	Spanish Stopper	Yes	NA	6'-8"	3'-4'	30 Gal	7' O.C.	Shrub Type
	MFR	Myrcianthes fragrans	Simpson Stopper	Yes	NA	6'-8"	3'-4'	30 Gal	7' O.C.	Shrub Type
	RAA	Randia aculeata	Indigo Berry	Yes	NA	6'-8"	3'-4'	30 Gal	7' O.C.	Shrub Type
	THM	Thrinax morrisii	Key Thatch Palm	Yes	2"-3"	4'-6"	4'-6"	30 Gal	As Shown	Multi
<b>MEDIUM SHRUBS</b>										
○	BRL	Brysonima lucida	Locust Berry	Yes	NA	36"-48"	36"-48"	3 Gal	4' OC	
	ERF	Erithalis fruticosa	Black Torch	Yes	NA	36"-48"	36"-48"	3 Gal	4' OC	
	CHI	Chrysobalanus icaco	Cocoplum	Yes	NA	24"-36"	24"-36"	3 Gal	4' OC	
	PSN	Psychotria nervosa	Wild Coffee	Yes	NA	24"-36"	24"-36"	3 Gal	4' OC	
	SAB	Sava bahamensis	Maiden Bush	Yes	NA	24"-36"	24"-36"	3 Gal	4' OC	
<b>SMALL SHRUBS/GROUNDCOVER</b>										
○	BOA	Borrichia arborescens	Sea Ox-Eye Daisy	Yes	NA	12"-18"	12"-18"	3 Gal	18" O.C.	
	ERL	Ernodia littoralis	Golden Creeper	Yes	NA	12"-18"	12"-18"	3 Gal	18" O.C.	
	MUC	Muhlenbergia capillaris	Muhly Grass	Yes	NA	12"-18"	12"-18"	3 Gal	18" OC	
	PLI	Psychotria ligustrifolia	Dwf. Wild Coffee	Yes	NA	24"-36"	24"-36"	3 Gal	18" O.C.	
	RUE	Ruellia brittonia	Ruellia	Yes	NA	12"-18"	12"-18"	1 Gal	18" O.C.	
	SER	Serenoa repens	Saw Palmetto	Yes	NA	18"-24"	18"-24"	7 Gal	24" O.C.	
	STJ	Stachytarpheta jamaicensis	Porterweed	Yes	NA	18"-24"	18"-24"	1 Gal	18" O.C.	
	TRF	Tripsacum floridanum	Dwarf Fakahatchee	Yes	NA	18"-24"	18"-24"	3 Gal	24" O.C.	
	ZAP	Zamia pumila	Coontie	Yes	NA	18"-24"	18"-24"	7 Gal	24" OC	
	<b>MATERIALS</b>									
	193	Planting Soil						CY	24" Perv. Area	Entrance Planter 5' Depth
	30	Mulch						CY	4" Perv. Area	
										11/29/2011

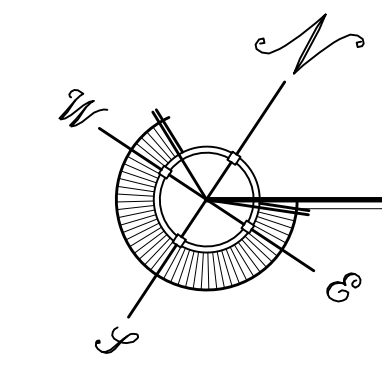

LANDSCAPE PLAN

SITE PLAN BASED ON INFORMATION OBTAINED FROM SURVEY PREPARED BY FREDERICK H. HILDEBRANDT, SURVEYOR DATED ON 02-27-06

SCALE: 3/32" = 1'-0"

SEAL

THESE DRAWINGS MAY NOT BE REPRODUCED WITHOUT WRITTEN AUTHORIZATION BY WILLIAM P. HORN

DATE  
11-11-11 HARC  
12-01-11 DRC

REVISIONS

DRAWN BY  
EMA  
FIH  
PROJECT NUMBER  
1113

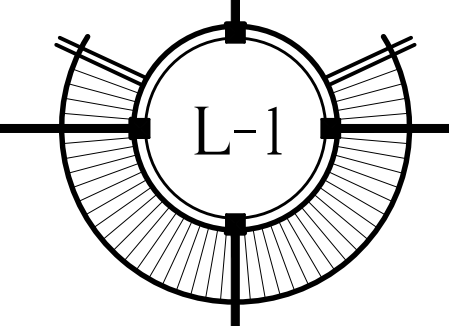

WATERFRONT BREWERY  
201 WILLIAM STREET  
KEY WEST BIGHT, FLORIDA