



THE CITY OF KEY WEST
Tree Commission
Post Office Box 1409 Key West, FL 33041-1409
Telephone: 305-809-3725

May 5, 2020

Joe Walsh
PO Box 4147
Key West, FL 33041

Dear Mr. Walsh:

Regarding your permit application, T2020-0142 for an updated Final Landscape Plan Approval for property located at 1 Mallory Square (Tropical Soup project). Review of the application by the Urban Forester for the updated landscape plan indicates the updated plans are consistent with the approved Tree Commission final landscape plan approval of March 13, 2018 with some minor changes that were requested by the Urban Forester. Therefore, the **Final Landscape Plan dated March 16, 2020 and May 5, 2020 is approved.**

If you have any questions please call the office at (305) 809-3768.

Sincerely,

Karen DeMaria
Urban Forestry Program Manager
City of Key West
1300 White Street
Key West, FL33040
Office: (305) 809-3768
kdemaria@cityofkeywest-fl.gov

TROPICAL SOUP GARDEN
TROPICAL SOUP | MALLORY SQUARE | KEY WEST, FLORIDA 33040

Handwritten signature
5-5-20
T2020-0142

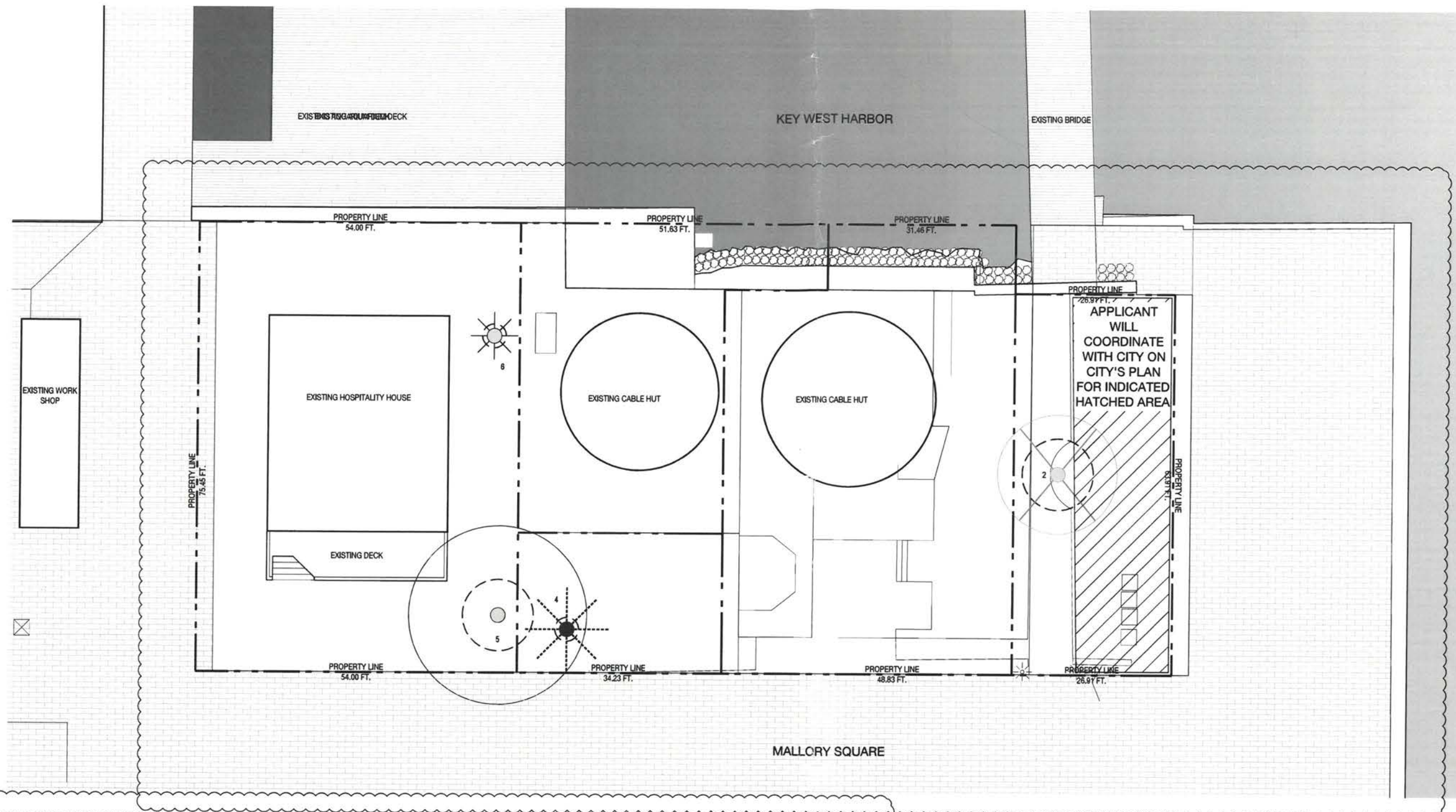

TREE & PALM SURVEY SCHEDULE

#	BOTANICAL NAME	COMMON NAME	DBH.	HT.	SPREAD	ACTION	NOTES
1	ROYAL POINCIANA						DIED; REMOVED BY CITY
2	BURSERIA SIMARUBA	GUMBO LIMBO	12"	24'	20'	REMOVE	HEAVILY DAMAGED BY CRANE DOING REPAIRS TO MOORING DOLPHIN - TO BE REMOVED & REPLACED WITH 2 GUMBO LIMBO TREES (ENFORCEMENT CASE)
3	COCONUT PALM						REMOVED BY AQUARIUM SEAWALL CONTRACTOR (ENFORCEMENT CASE)
4	COCOS NUCIFERA	COCONUT PALM	10"	30'	16'	RELOCATE	LOCATION OF PLANT MATERIAL CONFLICTS WITH CONSTRUCTION ENVELOPE
5	FICUS AUREA	STRANGLER FIG	80"	35'	30'	PRESERVE	CONTRACTOR TO PROTECT AND CARE FOR PLANT MATERIAL
6	WASHINGTONIA ROBUSTA	WASHINGTON PALM	12"	30'	10'	PRESERVE	CONTRACTOR TO PROTECT AND CARE FOR PLANT MATERIAL

TREE DISPOSITION LEGEND



SEAL (S TYLER NIELSEN - LA0087087)



TREE & PALM SURVEY

DATE	ISSUE
11.18.2017	TREE COMMISSION
02.19.2020	REVISION 01
03.16.2020	REVISION 02

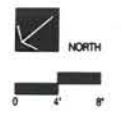

LSRV

TROPICAL SOUP GARDEN
TROPICAL SOUP | MALLORY SQUARE | KEY WEST, FLORIDA 33940

T2020-0142
[Signature]
5-5-20

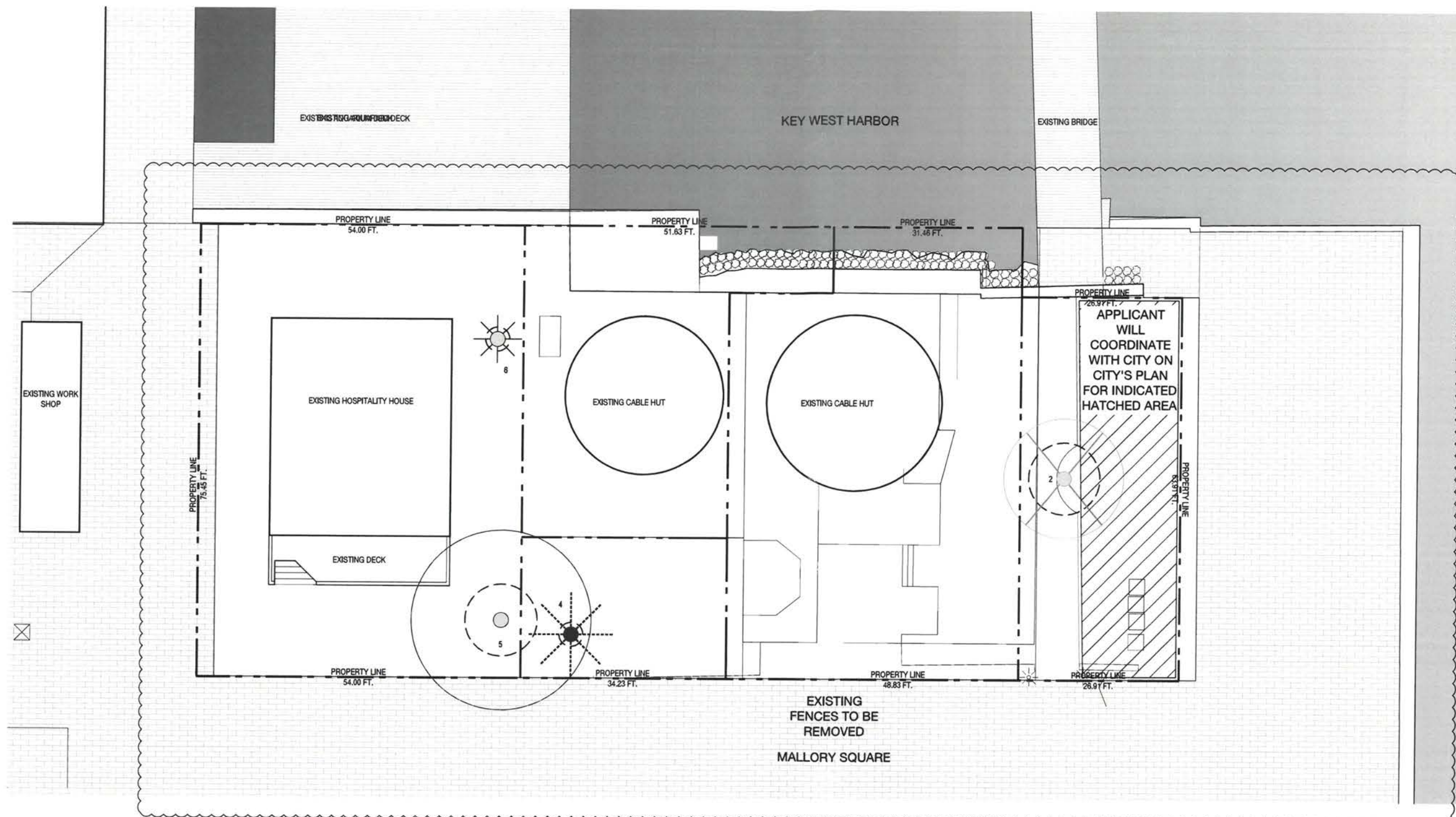

TREE DISPOSITION LEGEND



TREE & PALM DISPOSITION SCHEDULE

#	BOTANICAL NAME	COMMON NAME	DBH.	HT.	SPREAD	ACTION	NOTES
1	ROYAL POINCIANA					REMOVE	DIED; REMOVED BY CITY
2	BURSERIA SIMARUBA	GUMBO LIMBO	12"	24'	20'	REMOVE	HEAVILY DAMAGED BY CRANE DOING REPAIRS TO MOORING DOLPHIN - TO BE REMOVED & REPLACED WITH 2 GUMBO LIMBO TREES (ENFORCEMENT CASE)
3	COCONUT PALM					RELOCATE	REMOVED BY AQUARIUM SEAWALL CONTRACTOR (ENFORCEMENT CASE)
4	COCOS NUCIFERA	COCONUT PALM	10"	30'	16'	RELOCATE	LOCATION OF PLANT MATERIAL CONFLICTS WITH CONSTRUCTION ENVELOPE
5	FICUS AUREA	STRANGLER FIG	60"	35'	30'	PRESERVE	CONTRACTOR TO PROTECT AND CARE FOR PLANT MATERIAL
6	WASHINGTONIA ROBUSTA	WASHINGTON PALM	12"	30'	10'	PRESERVE	CONTRACTOR TO PROTECT AND CARE FOR PLANT MATERIAL

SEAL (S TYLER NIELSEN - LA6067087)



TREE DISPOSITION PLAN

DATE	ISSUE
11.18.2017	TREE COMMISSION
02.19.2020	REVISION 01
03.16.2020	REVISION 02

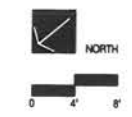

L102

TROPICAL SOUP GARDEN
TROPICAL SOUP | MALLORY SQUARE | KEY WEST, FLORIDA 33040

T2020-0142
[Signature] 5-5-20

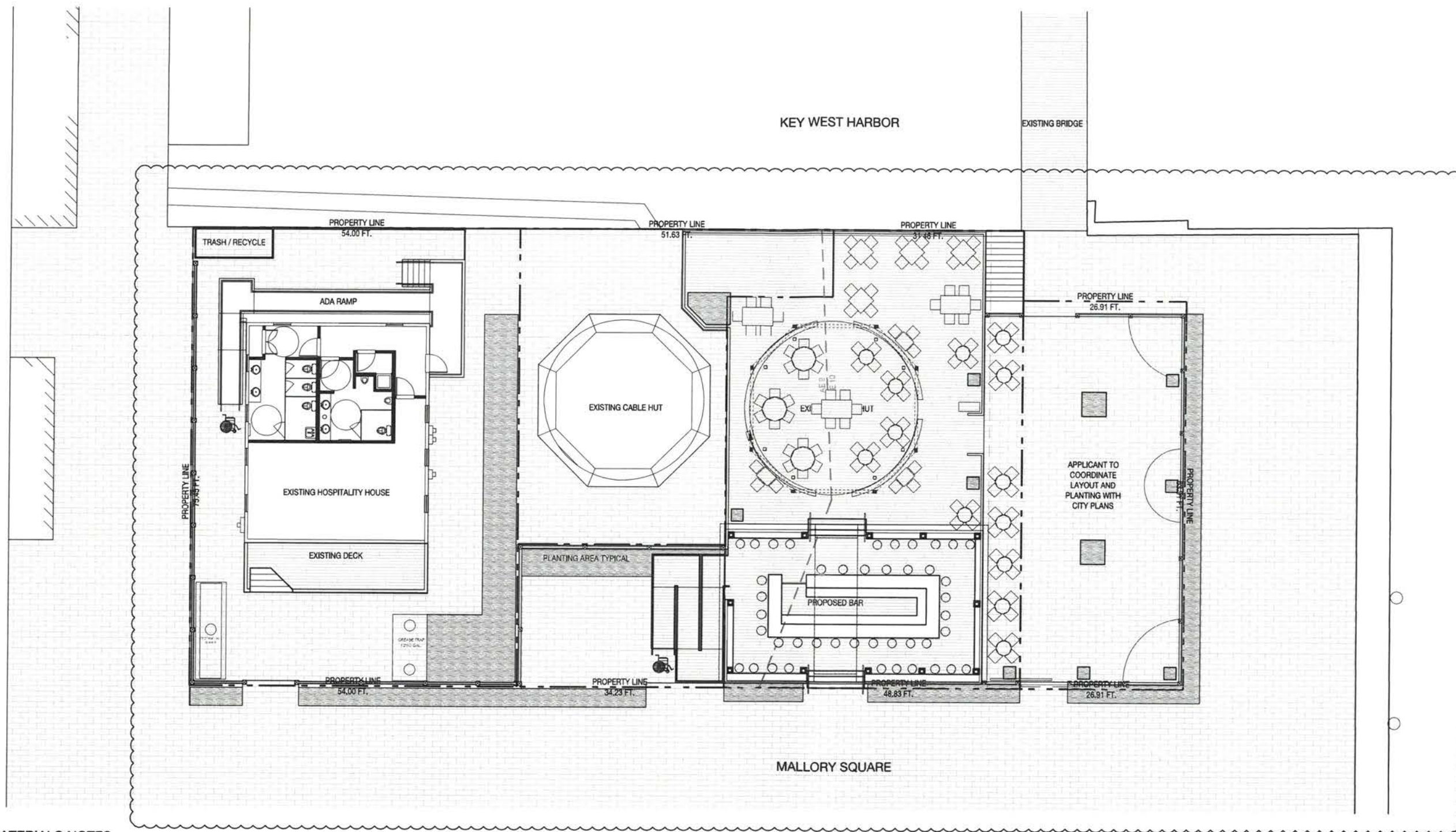

MATERIALS NOTES

1. CONTRACTOR TO VERIFY ALL QUANTITIES. IN CASE OF ANY DISCREPANCIES, GRAPHICALLY SHOWN MATERIAL QUANTITIES SHALL TAKE PRECEDENCE.
2. ALL CONSTRUCTION AND MATERIALS NOT SPECIFICALLY ADDRESSED IN THE CONTRACT DOCUMENTS OR SPECIFICATIONS SHALL BE IN ACCORDANCE WITH LOCAL, STATE AND FEDERAL JURISDICTIONS AND GOVERNING BODIES/AGENCIES STANDARDS.
3. THE CONTRACTOR SHALL PROVIDE A FULL-SCALE MOCKUP AND RECEIVE APPROVAL FROM THE LANDSCAPE ARCHITECT FOR ALL SYSTEMS BEFORE BEGINNING CONSTRUCTION OF PAVEMENT.
4. EXPANSION JOINTS SHALL BE PROVIDED WHERE FLATWORK MEETS VERTICAL STRUCTURES, SUCH AS WALLS, CURBS, STEPS, AND OTHER HARDSCAPE ELEMENTS. EXPANSION JOINTS SHALL ALSO BE PROVIDED AT MATERIAL CHANGES. EXPANSION JOINT MATERIALS/METHODS SHALL BE SUBMITTED TO THE LANDSCAPE ARCHITECT FOR REVIEW AND APPROVAL PRIOR TO INSTALLATION.
5. CONTROL JOINTS SHOULD BE SPACED NO GREATER THAN TEN (10) LINEAR FEET MAXIMUM, UNLESS OTHERWISE SPECIFIED. EXPANSION JOINTS SHOULD BE SPACED NO GREATER THAN FORTY (40) LINEAR FEET MAXIMUM, UNLESS OTHERWISE SPECIFIED. CONTRACTOR SHALL ADVISE ON OTHER JOINTS AS NEEDED TO MINIMIZE CRACKING. THIS INFORMATION SHALL BE SUBMITTED TO THE LANDSCAPE ARCHITECT FOR REVIEW AND APPROVAL PRIOR TO INSTALLATION.
6. ALL STEPS SHALL HAVE TWELVE (12) INCH TREADS AND SIX (6) INCH RISERS, UNLESS OTHERWISE SPECIFIED.
7. HOLD TOP OF WALLS AND FENCES LEVEL, UNLESS OTHERWISE SPECIFIED.
8. CONTRACTOR SHALL NOT INSTALL WORK LOCATED ON TOP OF ARCHITECTURAL STRUCTURES WITHOUT FIRST REVIEWING ARCHITECTURAL DRAWINGS.
9. SAMPLES OF SPECIFIED MATERIALS SHALL BE SUBMITTED TO THE LANDSCAPE ARCHITECT FOR REVIEW AND APPROVAL PRIOR TO ORDERING FOR JOB.

MATERIALS LEGEND

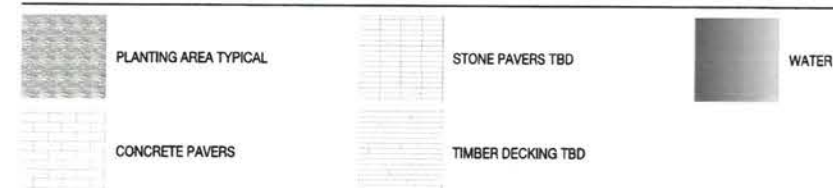

SEAL (S TYLER NIELSEN - LA6667067)



03.16.2020

MATERIALS PLAN

DATE	ISSUE
11.18.2017	TREE COMMISSION
02.19.2020	REVISION 01
03.16.2020	REVISION 02



L300

T2020-0142
[Signature]
5-5-20

PLANTING NOTES

1. PLANT MATERIAL IS TO BE HEALTHY SPECIMENS FREE FROM DISEASE OR DAMAGE, AND IS TO BE MAINTAINED IN EXCELLENT CONDITION WHILE ON THE JOBSITE. LANDSCAPE ARCHITECT SHALL INSPECT PLANT MATERIAL UPON ARRIVAL TO JOBSITE AND WILL REJECT PLANT MATERIAL THAT DOES NOT MEET THE STANDARDS DESCRIBED WITHIN THE CONTRACT DOCUMENTS.
2. THE LANDSCAPE ARCHITECT WILL PERIODICALLY INSPECT PLANT MATERIAL STOCKPILED AND/OR PLANTED ON SITE DURING THE COURSE OF CONSTRUCTION. PLANT MATERIAL NOT MEETING THE STANDARDS CONTAINED WITHIN CONTRACT DOCUMENTS SHALL BE REPLACED AT NO COST TO THE OWNER.
3. PROVIDE MATCHING SIZES AND FORMS FOR EACH PLANT OF THE SAME SPECIES UNLESS OTHERWISE INDICATED.
4. CONTRACTOR TO VERIFY ALL QUANTITIES. IN CASE OF DISCREPANCIES, GRAPHICALLY SHOWN QUANTITIES SHALL TAKE PRECEDENCE.
5. ALL MATERIALS USED SHALL CONFORM TO THE GUIDELINES ESTABLISHED BY THE CURRENT AMERICAN STANDARDS FOR NURSERY STOCK, PUBLISHED BY THE AMERICAN ASSOCIATION OF NURSERYMEN.
6. ALL PLANT MATERIAL SHALL BE INSTALLED PLUMB AND PER THE SPECIFICATIONS CONTAINED WITHIN THE CONTRACT DOCUMENTS. ANY NECESSARY STAKING AND/OR OTHER SUPPORTS MATERIALS/METHODS SHALL BE SUBMITTED TO THE LANDSCAPE ARCHITECT FOR REVIEW AND APPROVAL PRIOR TO INSTALLATION.
7. THE CONTRACTOR SHALL PRUNE EXISTING AND/OR NEW TREES ONLY PER LANDSCAPE ARCHITECT DIRECTION.
8. THE CONTRACTOR SHALL STAKE THE LOCATIONS OF ALL TREES AND B&B SHRUBS FOR LANDSCAPE ARCHITECT REVIEW AND APPROVAL, PRIOR TO INSTALLATION.
9. ALL ROOT-WRAPPING MATERIALS THAT ARE NOT BIO-DEGRADABLE SHALL BE REMOVED FROM THE ROOT BALL. ROOT BALLS SHALL BE FREE OF WEEDS.
10. SPECIFIED PLANT MATERIAL SIZES SHALL BE CONSIDERED MINIMUM SIZES.
11. FINISH GRADE OF PLANTING BEDS SHALL BE ONE (1) INCH BELOW ADJACENT FLATWORK, UNLESS SPECIFIED OTHERWISE.
12. MULCH OR PLANTING BED DRESSING SHALL BE PLACED IN ALL PLANTING AREAS AS SPECIFIED. MULCH OR PLANTING BED DRESSING SHALL NOT BE PLACED WITHIN SIX (6) INCHES OF TREE TRUNKS. MULCHING SHOULD BE REPEATED ANNUALLY DURING THE AUTUMN TO A THREE (3) INCH DEPTH.
13. ALL PLANT MATERIAL SHOULD RECEIVE AN ORGANIC FERTILIZER IN LIMITED APPLICATION FOLLOWING INSTALLATION. TYPE AND APPLICATION RATE AND METHOD OF APPLICATION TO BE SPECIFIED BY THE CONTRACTOR AND APPROVED BY THE LANDSCAPE ARCHITECT.
14. EXCESS FERTILIZER SHALL BE DISPOSED OF PROPERLY OFF-SITE. IT SHALL NOT BE DISPOSED OF IN STORM DRAINS AND/OR DRYWELLS.
15. STOCKPILED PLANT MATERIAL TO BE PLACED IN THE SHADE AND PROPERLY HAND-WATERED UNTIL PLANTED.
16. MINI-NUGGET TYPE DECORATIVE BARK MULCH WILL BE USED TO RETURN NUTRIENTS TO THE SOIL, REDUCE MAINTENANCE AND MINIMIZE EVAPORATION FOR AREAS APPROXIMATE TO THE RESIDENCE. LARGER SHREDDED BARK MULCH WILL BE USED FOR STEEP AREAS SO SLOUGHING IS LESS LIKELY TO OCCUR.
17. PRESERVE & PROTECT ALL EXISTING VEGETATION INDICATED TO REMAIN AT ALL TIMES.
18. ALL VEGETATION PROPOSED FOR OUTSIDE THE BUILDING ENVELOPE TO BE NATIVE UNLESS OTHERWISE NOTED. PLANTING THAT OCCURS OUTSIDE THE BUILDING ENVELOPE IS FOR RESTORATION PURPOSES ONLY OR IS SPECIFIC TO UTILITIES RESTORATION.
19. SIX (6) INCH PLANT MIX SHALL BE PROVIDED FOR ALL LAWN, TURF, AND NATIVE PLANTING ZONES. 18 INCH PLANT MIX SHALL BE PROVIDED FOR ALL PERENNIAL PLANTING BEDS UNLESS OTHERWISE NOTED.
20. ALL PLANT MATERIAL SHALL BE FLORIDA GRADE #1 OR BETTER AS OUTLINED IN GRADES AND STANDARDS FOR NURSERY PLANTS, PARTS I AND II OF THE LATEST EDITION, PUBLISHED BY THE FLORIDA DEPARTMENT OF AGRICULTURE AND CONSUMER SERVICES.

PLANTING SCHEDULE

ABR.	QUANTITY	BOTANICAL NAME	COMMON NAME	SPECIFICATIONS			
PRESERVED TREES & PALMS							
5		FICUS AUREA	STRANGLER FIG	60"	35'	30'	PRESERVE CONTRACTOR TO PROTECT AND CARE FOR PLANT MATERIAL
6		WASHINGTONIA ROBUSTA	WASHINGTON PALM	12"	30'	10'	PRESERVE CONTRACTOR TO PROTECT AND CARE FOR PLANT MATERIAL
RELOCATED TREES & PALMS							
4		COCOS NUCIFERA	COCONUT PALM	10"	30'	18'	RELOCATE LOCATION OF PLANT MATERIAL CONFLICTS WITH CONSTRUCTION ENVELOPE
TREES							
CDI	6	COCCOLOBA DIVERSIFOLIA	PIGEON PLUM	65 GAL. GRADE #1 SINGLE LEADER / STANDARD 2.5 IN. CAL 12 FT. HT OA			
PALMS							
CNU	7	COCOS NUCIFERA 'GREEN MALAYAN'	COCONUT PALM	FG. 16 FT. GW - CHARACTER CURVE TRUNK (GC PROVIDE IMAGES FOR APPROVAL)			
TZ	18	THRINAX RADIATA	THATCH PALM	15. GAL. 4 FT. OA			
TRA	1	THRINAX RADIATA	THATCH PALM	100 GAL. TRIPLE 10 - 12 FT. OA.			
UNDERSTORY TREES & SHRUBS							
MD	19	MONSTERA DELICIOSA	MEXICAN BREADFRUIT	7 GAL. FULL			
GROUNDCOVERS							
SP	55	SPARTINA PATENS	SALTCHORD GRASS	7 GAL.			
MISC.							
CONTRACTOR TO PROVIDE LANDSCAPE ARCHITECT WITH \$4,000 WHOLESALE PLANT ALLOWANCE							

PLANT IMAGES



PIGEON PLUM



COCONUT PALM



THATCH PALM



MONSTERA



SALTCHORD GRASS



BROMELIADS, ORCHIDS & TILLANDSIAS TO BE PLACED ON SCREEN & THE TRUNKS OF PALMS & TREES



SEAL (S TYLER NIELSEN - LA667007)

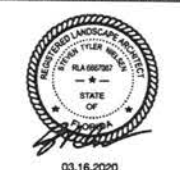

03.16.2020

PLANTING SCHEDULE & NOTES	
DATE	ISSUE
11.18.2017	TREE COMMISSION
02.19.2020	REVISION 01
03.16.2020	REVISION 02

L700

Applicant will coordinate with the city any additional plantings in this area.

5520
Kaufman
2020-0142

TROPICAL SOUP GARDEN
TROPICAL SOUP | MALLORY SQUARE | KEY WEST, FLORIDA 33040

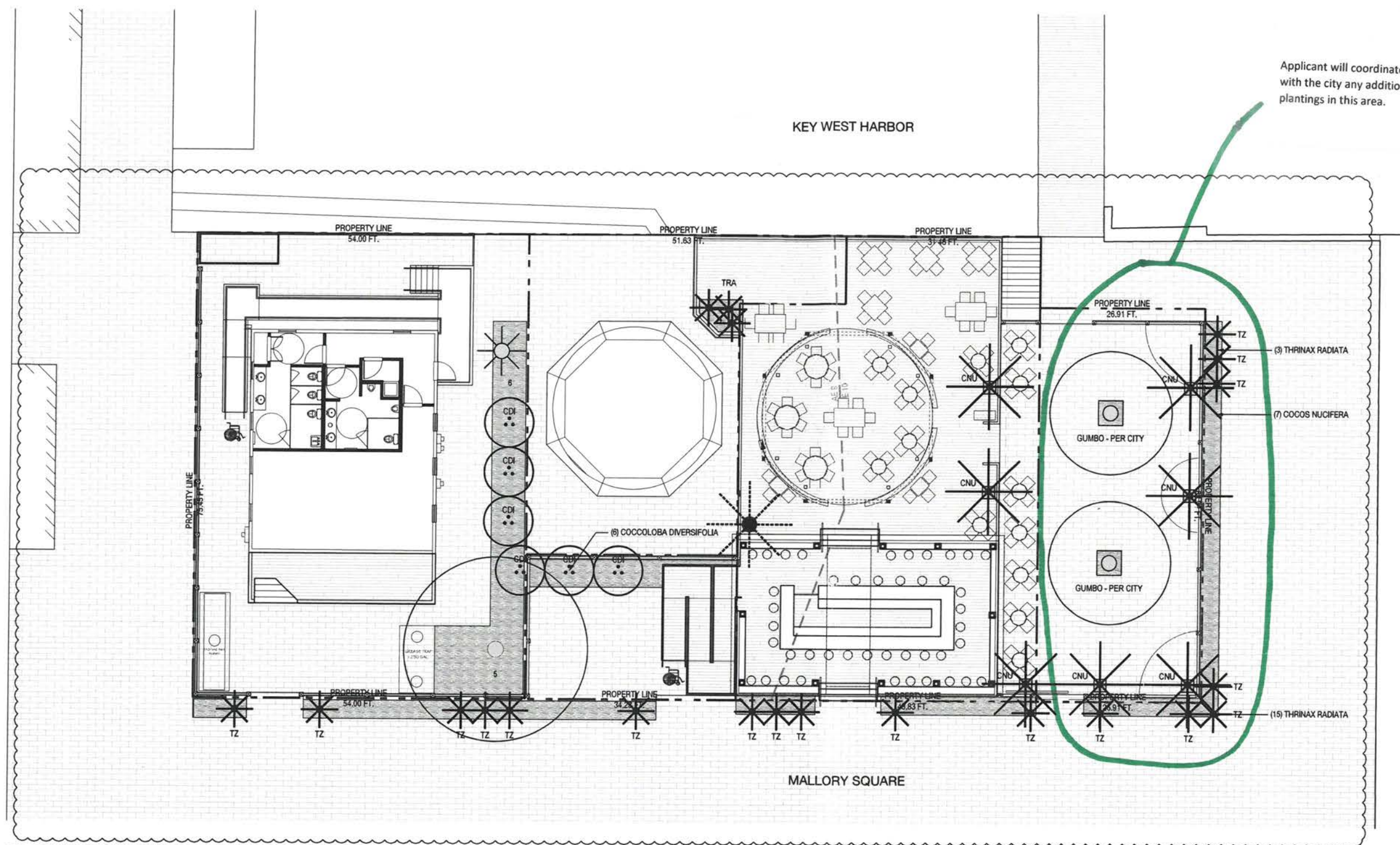

PLANTING SCHEDULE

ABR.	QUANTITY	BOTANICAL NAME	COMMON NAME	SPECIFICATIONS	
PRESERVED TREES & PALMS					
5		FICUS AUREA	STRANGLER FIG	60" 35" 30"	PRESERVE CONTRACTOR TO PROTECT AND CARE FOR PLANT MATERIAL
6		WASHINGTONIA ROBUSTA	WASHINGTON PALM	12" 30" 10"	PRESERVE CONTRACTOR TO PROTECT AND CARE FOR PLANT MATERIAL
RELOCATED TREES & PALMS					
4		COCOS NUCIFERA	COCONUT PALM	10" 30" 16"	RELOCATE LOCATION OF PLANT MATERIAL CONFLICTS WITH CONSTRUCTION ENVELOPE
TREES					
CDI	6	COCCOLOBA DIVERSIFOLIA	PIGEON PLUM	65 GAL. GRADE #1 SINGLE LEADER / STANDARD 2.5 IN. CAL 12 FT. HT OA	
PALMS					
CNU	7	COCOS NUCIFERA 'GREEN MALAYAN'	COCONUT PALM	FG. 16 FT. GW - CHARACTER CURVE TRUNK (GC PROVIDE IMAGES FOR APPROVAL)	
TZ	18	THRINAX RADIATA	THATCH PALM	15. GAL. 4 FT. OA	
TRA	1	THRINAX RADIATA	THATCH PALM	100 GAL. TRIPLE 10 - 12 FT. OA.	
UNDERSTORY TREES & SHRUBS					
MD	19	MONSTERA DELICIOSA	MEXICAN BREADFRUIT	7 GAL. FULL	
GROUNDCOVERS					
SP	55	SPARTINA PATENS	SALTCHORD GRASS	7 GAL.	
MISC.					
CONTRACTOR TO PROVIDE LANDSCAPE ARCHITECT WITH \$4,000 WHOLESALE PLANT ALLOWANCE					

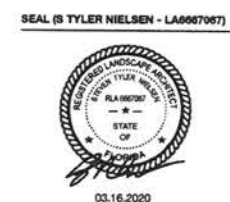
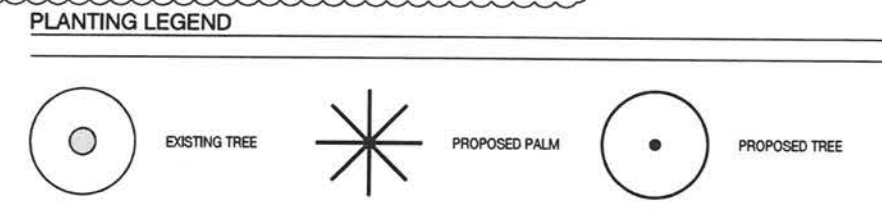

TREE & PALM PLANTING PLAN

DATE	ISSUE
11.18.2017	TREE COMMISSION
02.19.2020	REVISION 01
03.16.2020	REVISION 02

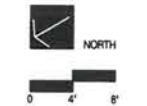

L701

KEY WEST HARBOR

Applicant will coordinate with the city any additional plantings in this area.

5-5-20
Lyn J. Nielsen
TZ020-0142

TROPICAL SOUP GARDEN
TROPICAL SOUP | MALLORY SQUARE | KEY WEST, FLORIDA 33040

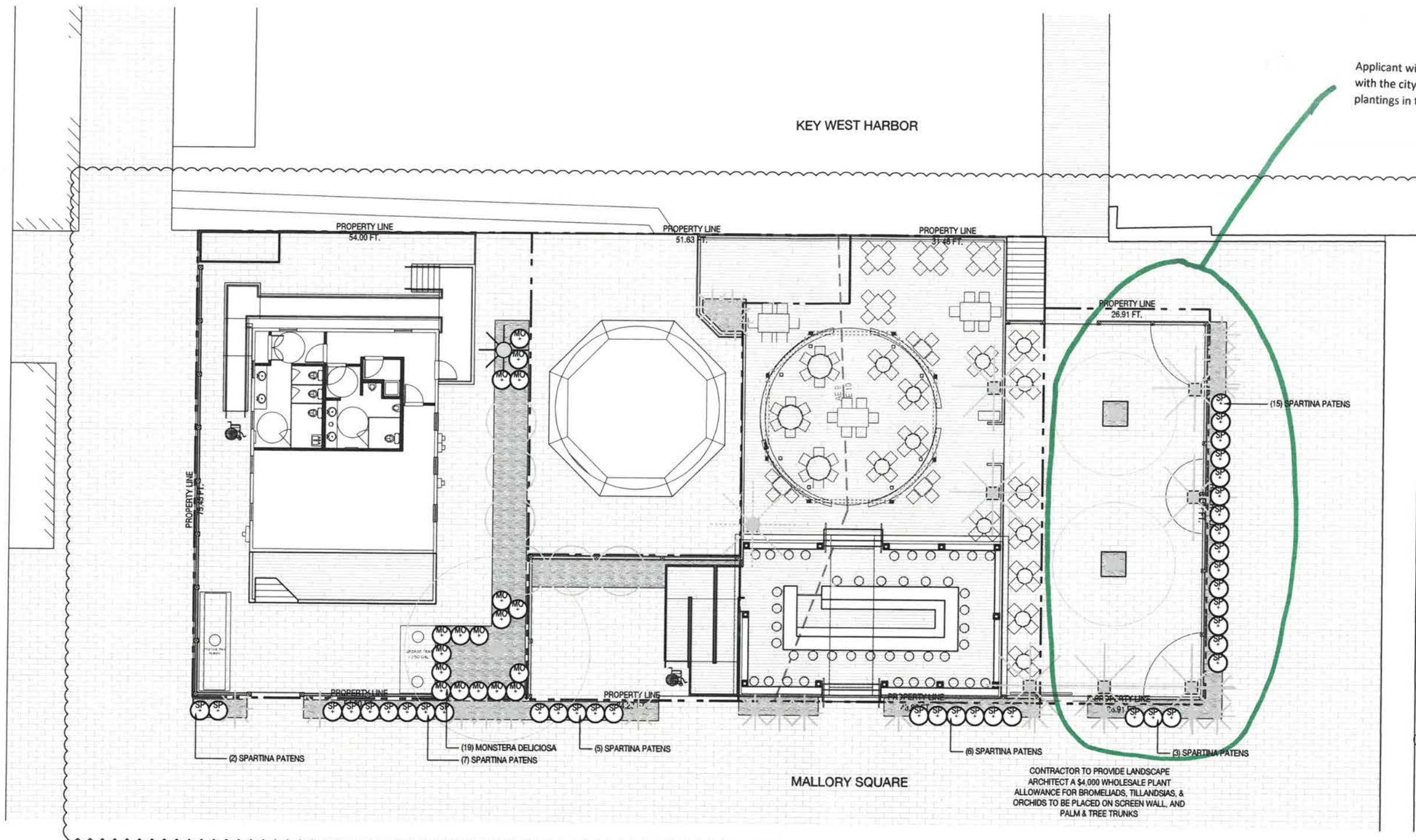

PLANTING SCHEDULE

ABR.	QUANTITY	BOTANICAL NAME	COMMON NAME	SPECIFICATIONS
PRESERVED TREES & PALMS				
5		FICUS AUREA	STRANGLER FIG	60" x 35" x 30" PRESERVE CONTRACTOR TO PROTECT AND CARE FOR PLANT MATERIAL
6		WASHINGTONIA ROBUSTA	WASHINGTON PALM	12" x 30" x 10" PRESERVE CONTRACTOR TO PROTECT AND CARE FOR PLANT MATERIAL
RELOCATED TREES & PALMS				
4		COCOS NUCIFERA	COCONUT PALM	10" x 30" x 16" RELOCATE LOCATION OF PLANT MATERIAL CONFLICTS WITH CONSTRUCTION ENVELOPE
TREES				
CDI	6	COCCOLOBA DIVERSIFOLIA	PIGEON PLUM	65 GAL. GRADE #1 SINGLE LEADER / STANDARD 2.5 IN. CAL 12 FT. HT OA
PALMS				
CNU	7	COCOS NUCIFERA 'GREEN MALAYAN'	COCONUT PALM	FG. 18 FT. GW - CHARACTER CURVE TRUNK (GC PROVIDE IMAGES FOR APPROVAL)
TZ	18	THRINAX RADIATA	THATCH PALM	15. GAL. 4 FT. OA
TRA	1	THRINAX RADIATA	THATCH PALM	100 GAL. TRIPLE 10 - 12 FT. OA.
UNDERSTORY TREES & SHRUBS				
MD	19	MONSTERA DELICIOSA	MEXICAN BREADFRUIT	7 GAL. FULL
GROUNDCOVERS				
SP	55	SPARTINA PATENS	SALTCHORD GRASS	7 GAL.
MISC.				
CONTRACTOR TO PROVIDE LANDSCAPE ARCHITECT WITH \$4,000 WHOLESALE PLANT ALLOWANCE				

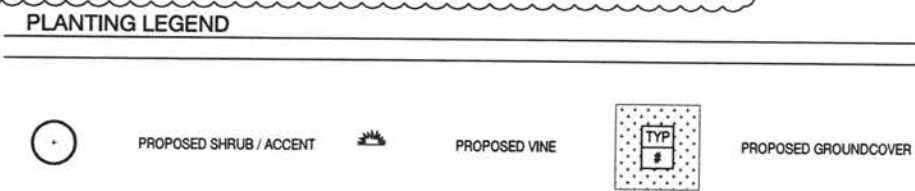

SEAL (S TYLER NIELSEN - LA0087067)



UNDERSTORY PLANTING PLAN

DATE	ISSUE
11.18.2017	TREE COMMISSION
02.19.2020	REVISION 01
03.18.2020	REVISION 02

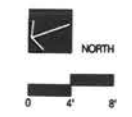

L702