

- NOTES**
1. SEE REPORT FOR KEY TO TREE NUMBERS
 2. DRAWING SHOWS EXISTING TREES WITHIN LOT WITH PROPOSED SITE PLAN.
 3. BUILDING OUTLINES SHOWN FOR CLARITY.

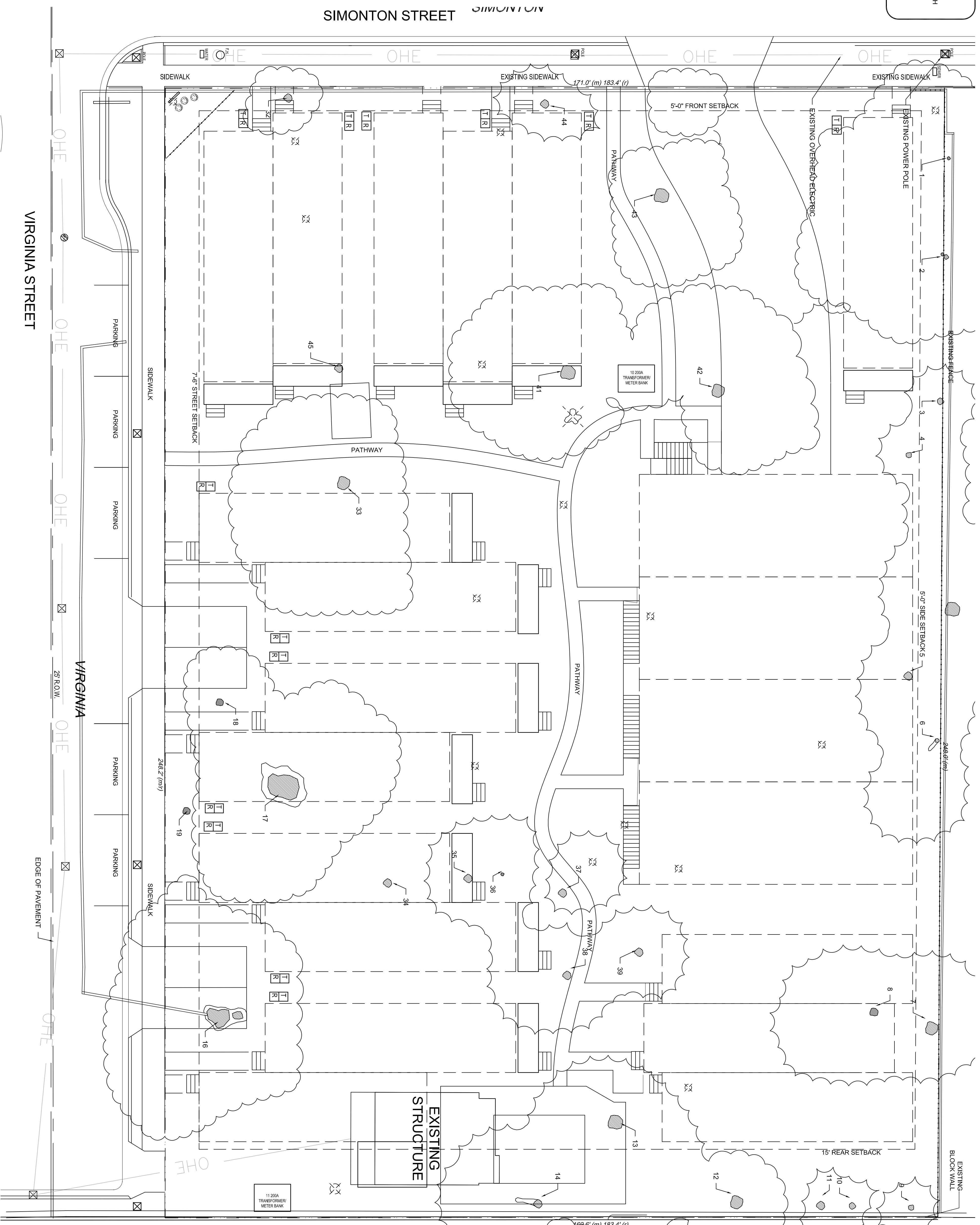

1

EXISTING TREE PLAN AND PROPOSED SITE PLAN

SCALE: 3/32" = 1'-0"

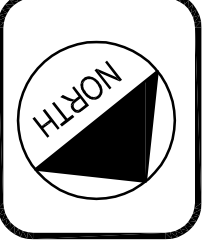
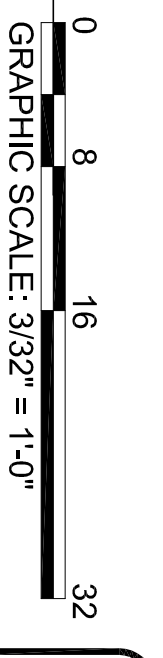

SOUTHERNMOST CABANA RESORT
SOUTHERNMOST CABANA RESORT L.L.C.
 1015 - 1027 Simonton Street
 Key West 33040

Title:
EXISTING TREE PLAN

Sheet Number:
AE1.1.3
 Date: 10 APRIL 2013

ANNALISE MANNIX
ENGINEERING
AND CONSULTING, LLC
 3739 Paula Avenue
 Key West, Florida 33040
 Tel: 305-797-0463
 Email: amannix@aol.com
 FLORIDA REG. P.E. #57533
 CA #27779

Submissions:
 DRC PLANNING REVIEW: 10 APR 2013
 FOR REVIEW
 NOT FOR CONSTRUCTION