

DRAFT
For In-House Use Only

This proposal is presented by Rep Services, Inc.

Proposed To: City of Key West
Public Works
633 Palm Avenue
Key West, FL 33040-4602

Ship To: TBD at a later date

Bill To: City of Key West
Public Works
633 Palm Avenue
Key West, FL 33040-4602

Attn: Richard Sarver

Attn:

Attn: Richard Sarver

Project No: 21667
Proposal No: 21667.01
Proposal Date: 5/13/2025
Project Name: Key West Shelters
Proposal Name: Various Shelters Key West
Proposal Expires: 6/13/2025

Project Contact: Richard Sarver
Project Location: 3420 Northside Dr
Key West, FL 33040
Project County: Monroe

For Questions Contact: Wendy Bowerman ☎ 407-853-3557 ✉ wendy@rep-services.com
Consultant: Kevin Harding ☎ 407-853-3575 ✉ kevin@rep-services.com

Opt/Rev: A/0 5/13/25 - WB

Vendor: Polygon **Proj Drawings:** Engr-permit 602883

Class	Part No	Qty	Description	Unit Price	Ext Price
Shelters	22737R0	1 EA	Polygon Shelter Model: REK 16x24 Primary Roof: PBR Secondary Roof: N/A Number of Columns 4 Eave Height (UPB): 8 Upper Roof Slope: 4/12 Electrical Cutout: yes Electrical Access: 4 Ornamentation: N/A Powder Coat over Galvanized Finish Rated for Exposure D Lightning Protection: N/A Anchor Bolts Included 2023 Florida Building Code 8th Edition Engineering to comply with HVHZ: Yes	45,140.00	45,140.00
Product Subtotal:					\$45,140.00
Discount per the Sourcwell (NJPA) Purchasing Contract #012621-PPC				8%	(\$3,611.20)
Discounted Product Total:					\$41,528.80
Electronic of Signed & Sealed Engineering:					\$1,000.00
Freight: Prepaid Ship Method: Best Way FOB: Destination Freight Charge					\$6,350.00
Polygon Total:					\$48,878.80

Vendor: Polygon			Proj Drawings: Engr-permit		602884
Class	Part No	Qty	Description	Unit Price	Ext Price
Shelters	22739R0	1 EA	Polygon Shelter Model: OTC 24 Primary Roof: PBR Secondary Roof: N/A Number of Columns 8 Eave Height (UPB): 8 Upper Roof Slope: 5/12 Electrical Cutout: 4 Electrical Access: Yes Ornamentation: N/A Powder Coat over Galvanized Rated for Exposure D Lightning Protection: N/A Anchor Bolts Included yes 2023 Florida Building Code 8th Edition Engineering to comply with HVHZ Yes	59,525.00	59,525.00
Product Subtotal:					\$59,525.00
Discount per the Sourcwell (NJPA) Purchasing Contract #012621-PPC				8%	(\$4,762.00)
Discounted Product Total:					\$54,763.00
Electronic of Signed & Sealed Engineering:					\$1,000.00
Freight: Prepaid Ship Method: Best Way FOB: Destination Freight Charge					\$3,000.00
Polygon Total:					\$58,763.00

General Terms of Sale and Proposal Summary

Net 30

Product: \$98,291.80

Freight: \$9,350.00

Proposal Total: \$107,641.80

Notes

Sourcwell Purchasing Contract #012621-PPC for Poligon: 8% discount off of product list price. All structures in Florida exceed the standard wind load conditions, and are therefore not included in the Sourcwell price list. The contract limits installation to 42% of the list price, before discount. Site preparation, concrete, engineered footings and freight are not subject to the Sourcwell contract.

Basis of Proposal:

Our proposal is based upon a request for shelters. Email request to Manufacturer 4/3/2024 requesting a REK 16x24 and OTC 16x24 for equipment only.

Proposal includes:

- Supply of equipment requested
- Freight to site
- Engineering for structure

Proposal excludes

- Offloading, assembly, foundations and installation of shelters
- permit filing and permit fees

Please note the vendor information itemized below.

If a performance and payment bond is required, add 3% to the proposal total.

If a owner controlled insurance program (OCIP) is required, add 2% to the proposal total.

Also, please be aware that we generate separate invoices for product at the time of delivery. If your project should include products from multiple manufacturers, each will be invoiced and taxed separately. If you require consolidated invoices, please alert your sales team.

Estimated project completion schedule

(This schedule starts when all required information for engineering has been gathered.)

8 Weeks: Shelter Engineering

4 Weeks: Submittal Approval

17 Weeks Longest manufacturing lead time. (Typical for scheduling.)

1 Week Shipping

30 Weeks TOTAL

Note that RSI is committed to do all it can to meet the needs of your project.

This proposal is for material, freight, and applicable tax only. Any building permits, engineering, unloading, assembly, installation, site preparation and surfacing are by others. Drivers will not unload the shipment. Purchaser must make arrangements for unloading of playground or exercise equipment, shade, and shelter product lines. In most circumstances this will require a forklift. For certain site furnishing orders, a lift gate and pallet jack may be available for an additional fee. Please alert your sales team of this need.

Poligon by PorterCorp:

- Porter units are designed to meet 2023 Florida Building Code 8th Edition.
- Please provide Building Department permit application requirements including Risk Category.
- The following certificates are available:
 - Miami-Dade County Certificate of Competency No. 23-0915.11
 - PCI (Powder Coating Institute) 4000 Certified
 - American Institute of steel construction quality management systems certified
- Four sets of signed and sealed drawings and calc books for building permitting will be provided. If additional sets of drawings and calc books are required, additional fees will apply.

Electrical Cutout: Selections to be made at time of electrical cut out submittal approval

Color Selection:

To be made at time of color submittal approval

Can find standard roofing and frame color selections here: <https://poligon.com/shelter-option/frame-roof-colors/>

Non-Standard colors and finishes are available at an additional charge

Warranty

The 10-year limited warranty excludes buildings erected at sites where salt air, corrosive environment, high humidity, or sprinkler systems come in contact with the shelter.

Failure to maintain the finished system with annual touch-ups and documented maintenance procedures will void the limited warranty.

See Poligon warranty document for full details and terms.

Terms Porter Billing

Porter requires a 50% deposit with the order before fabrication can begin. Balance net 15 with credit approval.

Time Limitations Holding Prices Firm:

Orders are shipped within our manufacturer's standard lead times. Requests for delayed shipping may result in additional costs due to increases in freight, material costs or other factors. To secure the prices on this proposal, the offer must be accepted prior to the expiration date noted.

If, during the performance of this contract, the price of a product increases 3% or more as documented by factory quotes, invoices or receipts to contractor (Rep Services, Inc.) from the date of the contract signing the price of shall be equitably adjusted by an amount reasonably necessary to cover such price

DRAFT - For In-House Use Only

increases. Where the delivery of a product is delayed, through no fault of contractor (RSI) as a result of the shortage or unavailability of a product, contractor (RSI) shall not be liable for any additional costs or damages associated with such delay(s).

The undersigned warrants that he/she is an authorized representative of the City of Key West noted and has the requisite authority to bind the City of Key West and/or principal.

Accepted By:

City of Key West

[illegible]

Company Name

Authorized By

Printed Name

Date _____

As Its: _____ (Title)

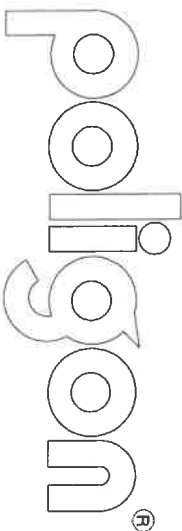

PROJECT:

LOCATION:

BUILDING TYPE: OTC-24

ROOF TYPE: MULTI-RIB

BUILDING NUMBER:

ORDER NUMBER:

QUOTE NUMBER:

DRAWING LIST:

SHEET NUMBER	DRAWING DESCRIPTION
CS	COVER SHEET
1	ARCHITECTURAL ELEVATIONS
2	STRUCTURAL FRAMING PLAN
3	COLUMN LAYOUT

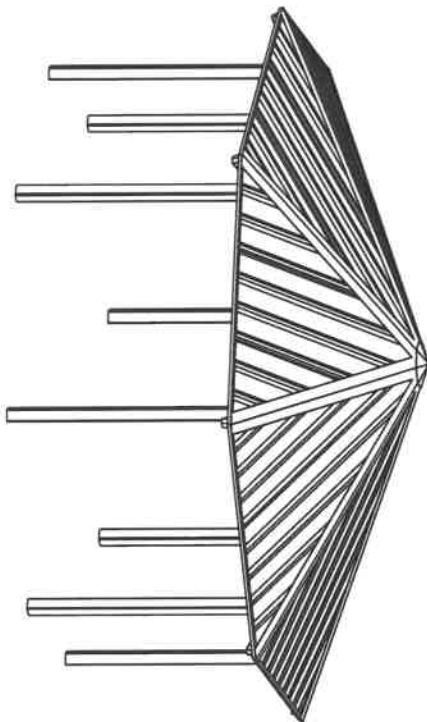

CERTIFICATE:
MANHATTAN COUNTY CERTIFICATE OF COMPETENCY NO. 21-0819.13
PCI (PORTER COATING INSTITUTE) 4000 CERTIFIED

FABRICATOR APPROVALS:
CITY OF PHOENIX, AZ APPROVED FABRICATOR #C08-2010
CITY OF LOS ANGELES, CA APPROVED FABRICATOR #F01596
CITY OF RIVERSIDE, CA APPROVED FABRICATOR #F01596
CITY OF SAN JOSE, CA APPROVED FABRICATOR #F01596
CLARK COUNTY, NV APPROVED FABRICATOR #F01596
STATE OF UTAH APPROVED FABRICATOR 02006-14
AISC APPROVED FABRICATOR C-00018751

MATERIALS:

DESCRIPTION:
TUBE STEEL
SCHEDULE PIPE
MULTI-RIB ROOF
STRUCTURAL STEEL PLATE
ROOF PANELS (STEEL)

ASTM DESIGNATION:
A500 (GRADE B)
A519
A536 (GRADE 50)
A563

STOP!!
NOT FOR CONSTRUCTION
USE FOR PRELIMINARY
PLANNING AND ESTIMATING
ONLY



GENERAL NOTES:
UNLESS NOTED OTHERWISE, THIS STRUCTURE WAS DESIGNED TO
OBTAIN THE MAXIMUM STRENGTH OF THE MATERIALS. THE
MANUFACTURER SHALL BE RESPONSIBLE FOR THE DESIGN OF THE
ATTACHED TO THIS STRUCTURE (WALLS, COLUMN WRAPS, RAILINGS,
ETC.) SO THE DESIGN OF THIS STRUCTURE CAN BE REVIEWED AND
POSSIBLY REVISED.
UNLESS NOTED OTHERWISE, THIS STRUCTURE WAS DESIGNED
WITH AN EAVE HEIGHT EQUAL TO OR GREATER THAN THE EAVE
HEIGHT OF THIS STRUCTURE. IF THAT SEPARATION DOES NOT EXIST,
THE MANUFACTURER MUST BE CONTACTED SO THE DESIGN OF THIS
STRUCTURE CAN BE REVIEWED AND POSSIBLY REVISED.
STRUCTURAL STEEL SHALL BE DETAIL, FABRICATED, AND ERECTED
IN ACCORDANCE WITH THE LATEST EDITION OF THE AMERICAN
INSTITUTE OF STEEL CONSTRUCTION (AISC) SPECIFICATION MANUAL.

ALL WELDING IS PERFORMED BY AMERICAN WELDING SOCIETY
A500 (GRADE B) AND A519 (GRADE 50) CONFORMS TO THE LATEST EDITION
OF AISC D1.1 OR D1.3 AS REQUIRED.
PARTS SHOWN MAY BE UPGRADED DUE TO STANDARDIZED
FABRICATION. REFER TO THE SHIPPING BILL OF MATERIALS FOR
POSSIBLE SUBSTITUTIONS.
FOR PROPER FIELD INSTALLATION OF THE BUILDING IT IS
RECOMMENDED THAT THE PRIMARY FRAME INSTALLER AND THE
ROOF INSTALLER HAVE A MINIMUM FIVE (5) YEARS DOCUMENTED
EXPERIENCE INSTALLING THIS TYPE OF PRODUCT.
FOR PROPER FIELD INSTALLATION OF THE BUILDING IT IS
RECOMMENDED THAT ELECTRIC WIRING, IF REQUIRED, BE RUN
THROUGH THE STRUCTURAL MEMBERS BEFORE THE BUILDING IS
ERECTED.

PROJECT:	PRINT DATE: 12/21/2023	DRAWN BY: chris.lisac	REV LEVEL: A02
PROJECT LOCATION:	JOB NO.:		SCALE: 1:48
DRAWING: COVER SHEET	CAD MODEL: E1W-OTC-24MR	poligon® by PORTER CORP FIELD SUPPORT: (616) 888-3504	

CS

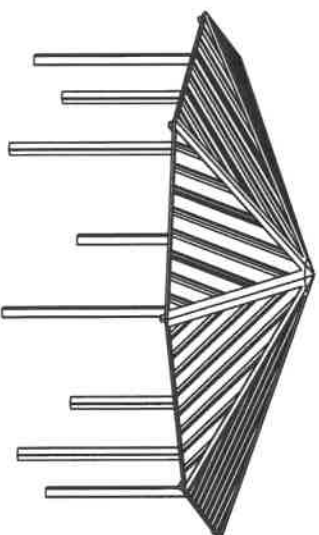
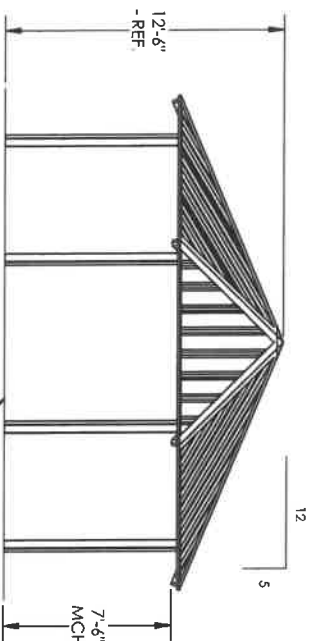
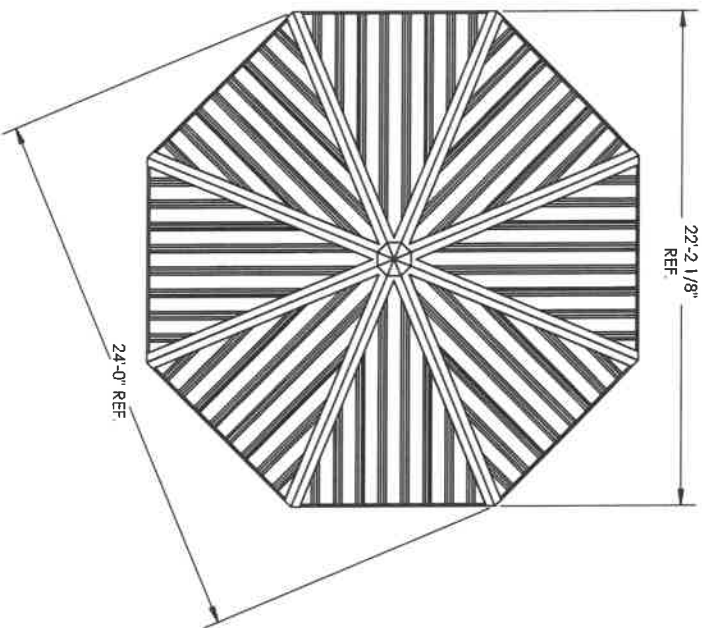

- GENERAL ROOF NOTES:**
1. METAL ROOFING:
 - 24 GAUGE
 - GALVALUME COATED
 - KYNAR 500 PAINTED
 2. TRIM COLOR MATCHES ROOF
 3. SEE POLYGON.COM FOR COLOR OPTIONS

STOPii
NOT FOR CONSTRUCTION
USE FOR PRELIMINARY
PLANNING AND ESTIMATING
ONLY

DRAWING:	
ARCHITECTURAL ELEVATIONS	
SCALE: 1"=6'-5"	REV LEVEL: A
poligon ® (616)399-1963 www.poligon.com CONTRIBUTOR: PORTERCORP PATENTED OR PENDING DESIGN: PORTERCORP 420 N. 18TH AVE. HOLLAND, MI 49423	
SHEET	1

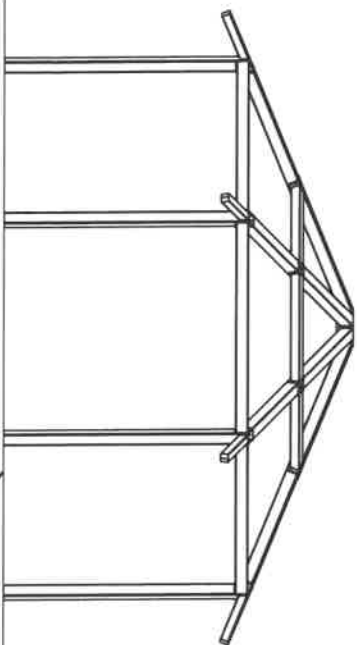
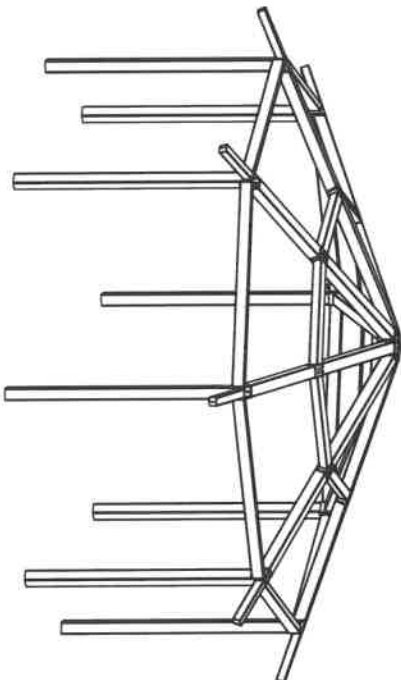
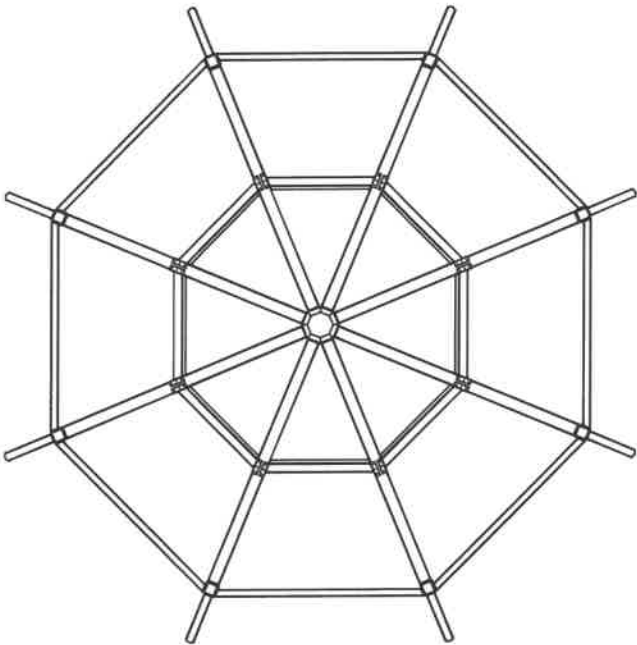

FINISH GRADE:
MOUNTING VARIES
BASED ON ENGINEERING
REQUIREMENTS.

STOPii
NOT FOR CONSTRUCTION
USE FOR PRELIMINARY
PLANNING AND ESTIMATING
ONLY

DRAWING: STRUCTURAL FRAMING PLAN		REV LEVEL: A
SCALE: 1:50		
poligon ® COPYRIGHT 2014 PORTER-CORP. 4200 N. LINCOLN AVENUE, HOULAND, MI 48041		SHEET 2

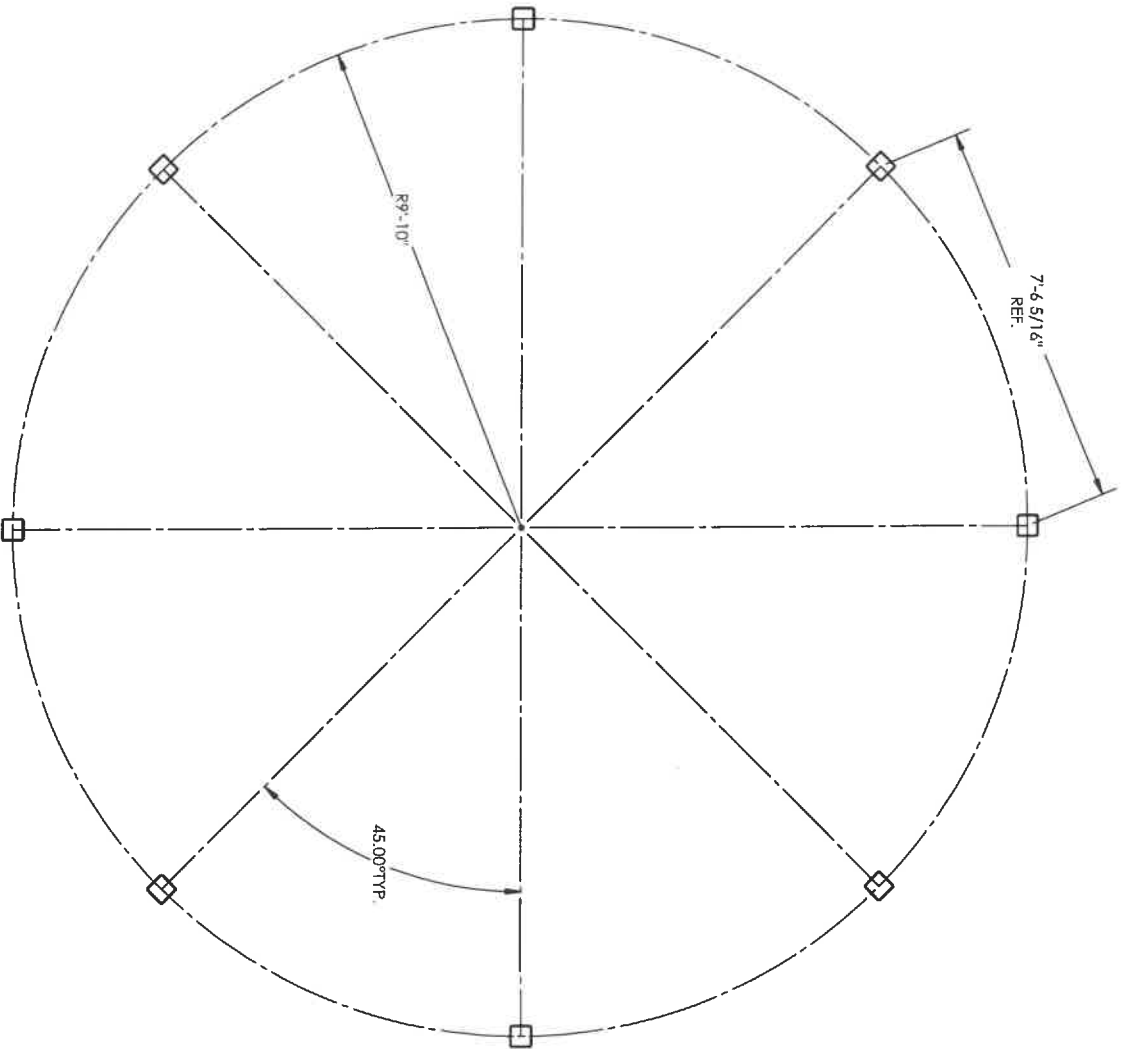

STOPii
 NOT FOR CONSTRUCTION
 USE FOR PRELIMINARY
 PLANNING AND ESTIMATING
 ONLY

DRAWING:	
COLUMN LAYOUT	
SCALE:	REV LEVEL:
1"=8'	A
poligon ® www.poligon.com PORTERCORP 420 N. 12TH AVE. ROLAND, MI 48062	
SHEET	3

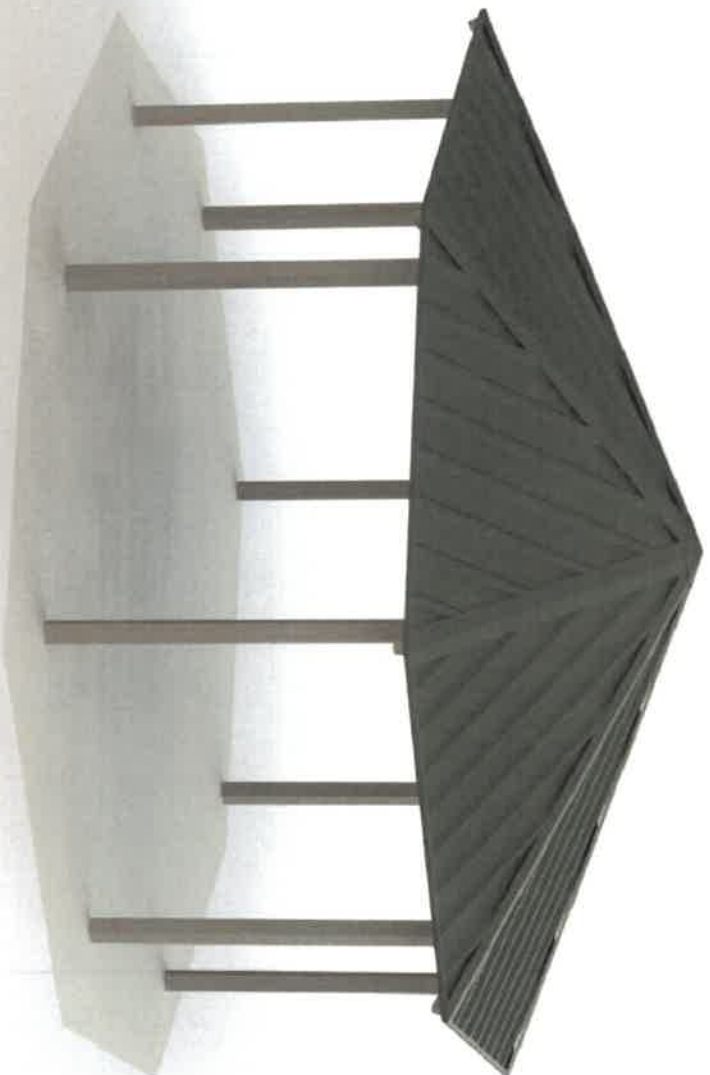

FRAME COLOR: SURREY BEIGE
ROOF COLOR: EVERGREEN
COLORS SHOWN FOR ILLUSTRATIVE PURPOSES ONLY. FOR OTHER
COLOR SELECTIONS, PLEASE SUBMIT AN EI DRAWING REQUEST.

Poligon[®] WWW.POLIGON.COM
 MAIN: (616) 888-3500
 CORP FIELD SUPPORT: (616) 888-3504

UNLESS NOTED OTHERWISE, THIS STRUCTURE WAS DESIGNED ASSUMING A 20 SEPARATION BETWEEN ANY ADJACENT STRUCTURE WITH AN EAVE HEIGHT EQUAL TO OR GREATER THAN THE EAVE HEIGHT OF THIS STRUCTURE. IF THAT SEPARATION DOES NOT EXIST, THE MANUFACTURER MUST BE CONTACTED SO THE DESIGN OF THIS STRUCTURE CAN BE REVIEWED AND POSSIBLY REVISED.

STRUCTURAL STEEL SHALL BE DETAILED, FABRICATED, AND ERRECTED IN ACCORDANCE WITH THE LATEST EDITION OF THE AMERICAN INSTITUTE OF STEEL CONSTRUCTION (AISC) SPECIFICATION MANUAL.

ALL WELDING IS PERFORMED BY AMERICAN WELDING SOCIETY (AWS) CERTIFIED WELDERS AND CONFORMS TO THE LATEST EDITION OF AWS D1.1 OR D1.3 AS REQUIRED.

PARTS SHOWN MAY BE UPGRADED DUE TO STANDARDIZED FABRICATION. REFER TO THE SHIPPING BILL OF MATERIALS FOR POSSIBLE SUBSTITUTIONS.

FOR PROPER FIELD INSTALLATION OF THE BUILDING, IT IS RECOMMENDED THAT THE PRIMARY FRAME INSTALLER AND THE ROOF INSTALLER HAVE A MINIMUM FIVE (5) YEARS DOCUMENTED EXPERIENCE INSTALLING THIS TYPE OF PRODUCT.

FOR PROPER FIELD INSTALLATION OF THE BUILDING, IT IS RECOMMENDED THAT ELECTRIC WINING, IF REQUIRED, BE RUN THROUGH THE STRUCTURAL MEMBERS BEFORE THE BUILDING IS ERECTED.

2

PRINT DATE:	12/27/2023	DRAWN BY:	ch
JOB NO:			
CAD MODEL:			
REK-16X24-EIW.SLDPRT			

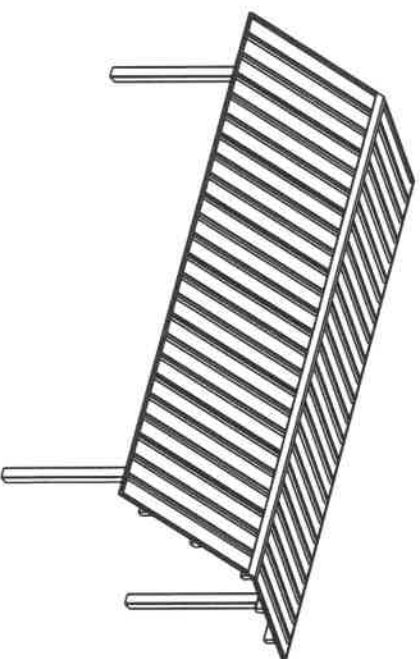
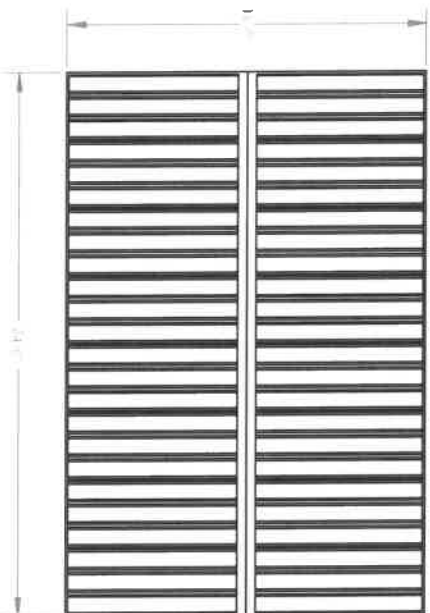

- GENERAL ROOF NOTES:**
1. METAL ROOFING:
 - 24 GAUGE
 - GALVALUME COATED
 - KYNAR 500 PAINTED
 2. TRIM COLOR MATCHES ROOF
 3. SEE POLYGON.COM FOR COLOR OPTIONS

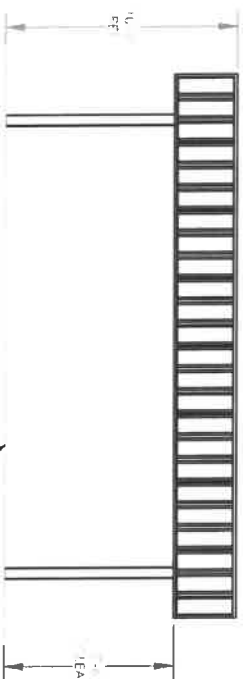

FINISH GRADE
MOUNTING VARIES
BASED ON ENGINEERING
REQUIREMENTS.

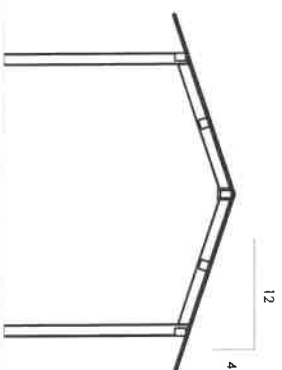

STOPii
NOT FOR CONSTRUCTION
USE FOR PRELIMINARY
PLANNING AND ESTIMATING
ONLY

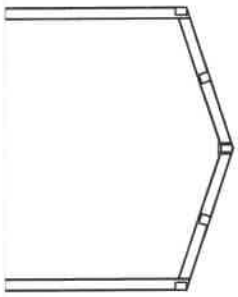
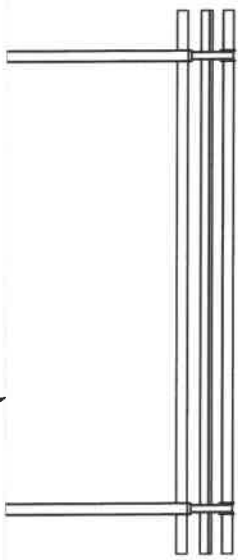
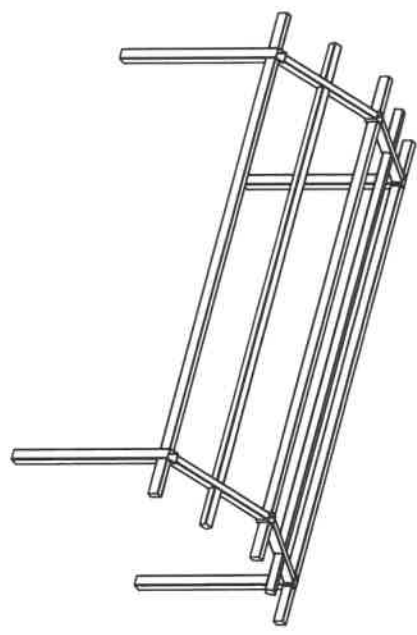
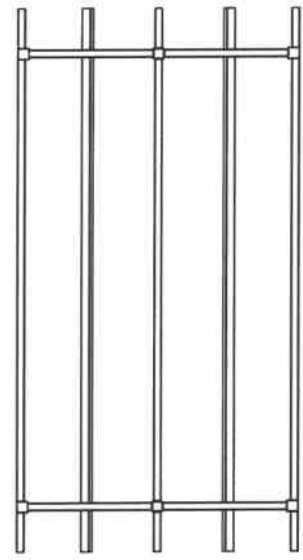

FINISH GRADE.
MOUNTING VARIES
BASED ON ENGINEERING
REQUIREMENTS.

STOP!!
NOT FOR CONSTRUCTION
USE FOR PRELIMINARY
PLANNING AND ESTIMATING
ONLY

DRAWING: STRUCTURAL FRAMING PLAN	
SCALE: 1"=6'	REV LEVEL: A
poligon ® www.poligon.com COPYRIGHT 2015 PORTERCORP 4200 N. 25th AVE. ANKENY, IA 52422	
by PORTERCORP	
SHEET 2	

BASEPLATE NOTES:

1. POLYGON ENGINEERING WILL DETERMINE REQUIRED BASEPLATE DESIGN AFTER ENGINEERING PACKAGE IS ORDERED.
2. CUSTOMER MAY SUGGEST PREFERRED BASEPLATE DESIGN.

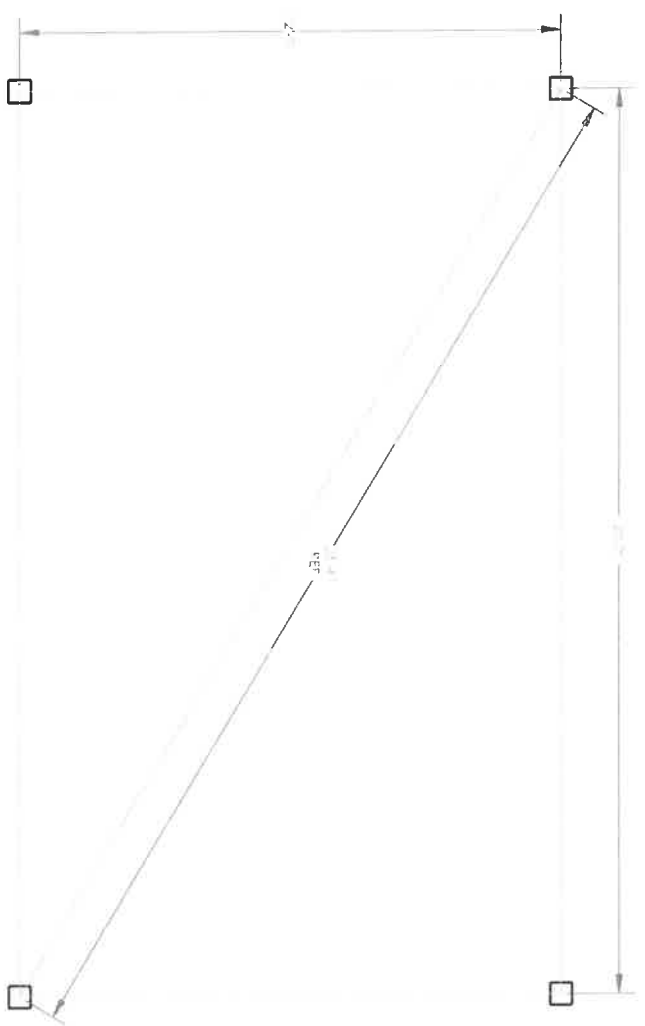

STOP!!
NOT FOR CONSTRUCTION
USE FOR PRELIMINARY
PLANNING AND ESTIMATING
ONLY

DRAWING:	
COLUMN LAYOUT	REV LEVEL:
SCALE 1:32	A
poligon ® www.poligon.com by PORTERCORP	
SHEET 3	

COPYRIGHT 2015
POLYGON CORP. 420 N. LAMAR BLVD. HOUSTON, TX 77024

poligon®

FRAME COLOR: SURREY BEIGE
ROOF COLOR: EVERGREEN
COLORS SHOWN FOR ILLUSTRATIVE PURPOSES ONLY. FOR OTHER
COLOR SELECTIONS, PLEASE SUBMIT AN E1 DRAWING REQUEST.

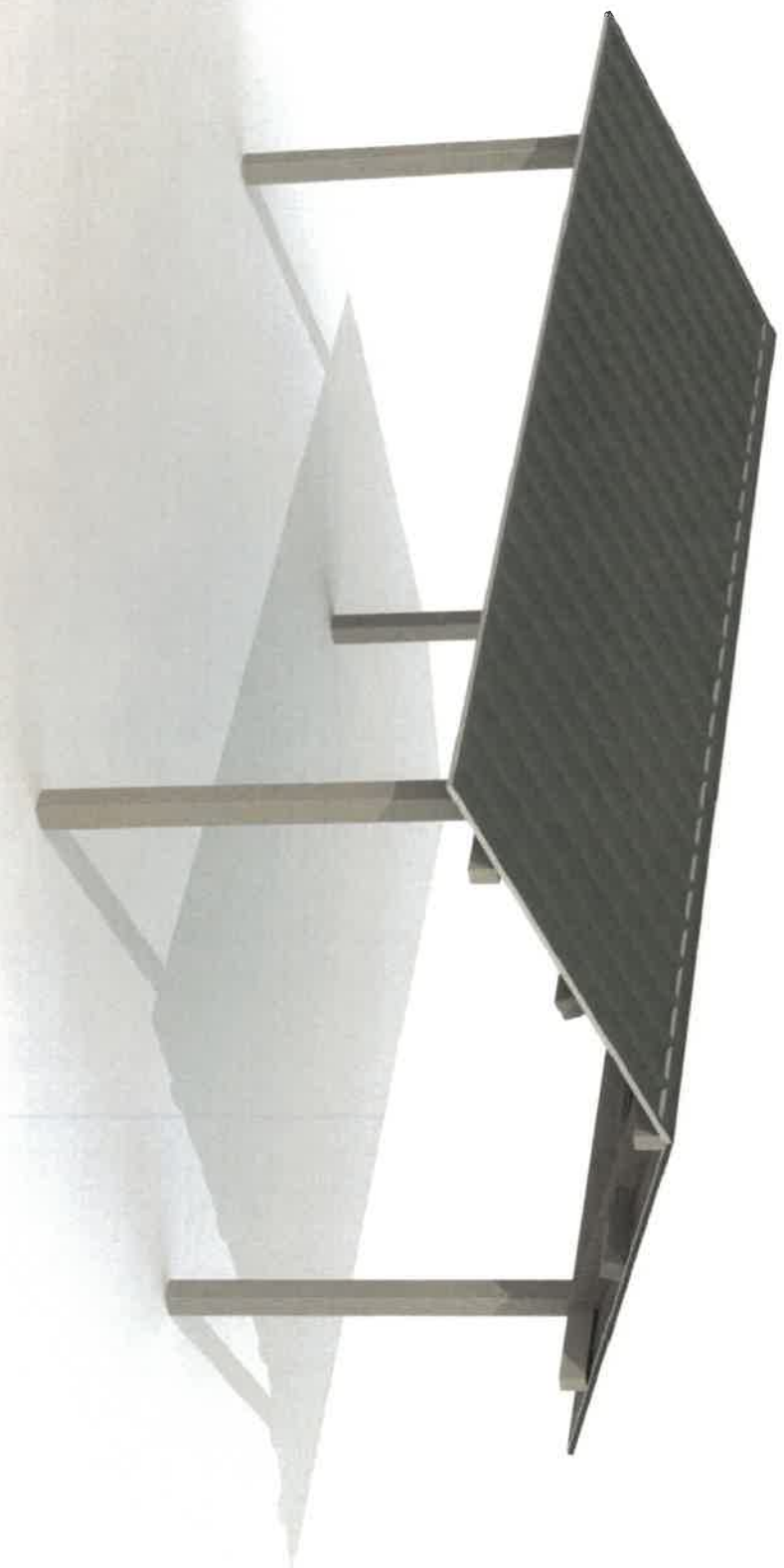

REK 16x24