

DRIVING DIRECTIONS

FROM AT&T OFFICE HEAD SOUTH ON SR-874 FOR 4.3 MILES TO EXIT 3A (SR-508/DOE/PHN EXPI), HEAD WEST ON DOE/PHN FOR 7 MILES TO SR-401 (SR-401/DOE/PHN EXPI), EXIT HEAD SOUTH ON PALMETTO FOR 3.8 MILES TO SR-874 (DOE/PHN/SHILLA EXPI), EXIT HEAD SOUTH ON TOWN SHILLA FOR 7.5 MILES AND MERGE ONTO FLORIDA'S TURNPIKE HEAD SOUTH ON US-1 FOR 10.9 MILES AND MERGE ONTO US-1, HEAD SOUTH THEN SOUTHWEST ON US-1 FOR 10.9 MILES TO HENKNEY DR. TURN LEFT AND HEAD SOUTH FOR 0.1 MILES, THEN WEST FOR 1.2 MILES TO HENKNEY DR. TURN LEFT AND HEAD SOUTH FOR 0.1 MILES, SITE IS ON THE RIGHT SIDE OF ROAD.

LOCAL MAP

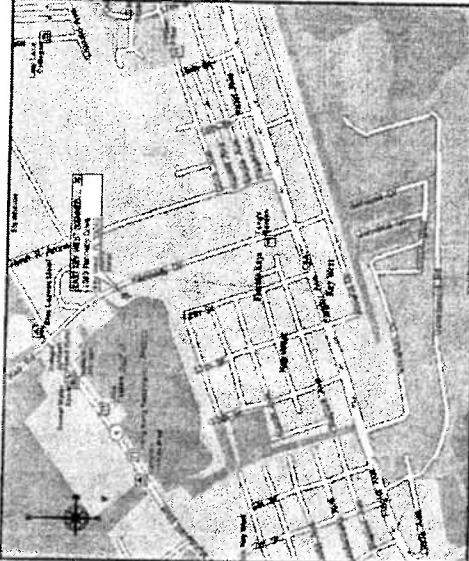

VICINITY MAP

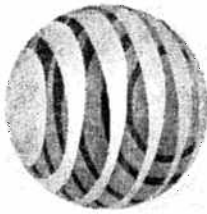
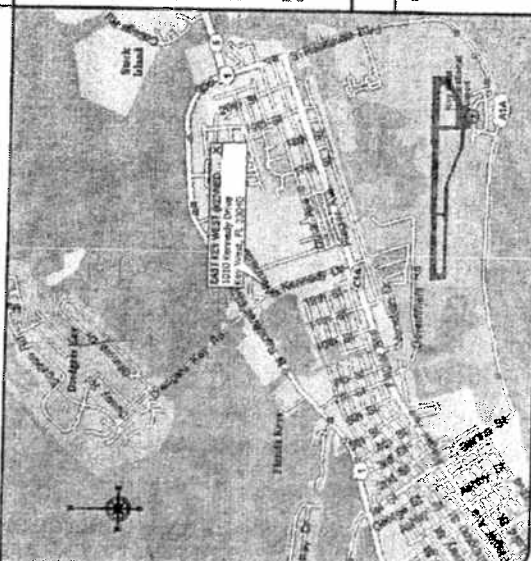

at&t

**EAST KEY WEST
(KENNEDY CENTER CONDO)**

1010 KENNEDY DRIVE
KEY WEST, FL 33040

10113201

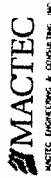

MACTEC
ENGINEERING & CONSULTING, INC.
CORPORATE OFFICE
1105 LAURENS AVENUE
AUSTIN, TX 78704
7805 W. 194TH STREET
AMMO CANAL, FL 33074
TEL: (305) 894-1799

CERTIFICATE OF ADOPTION: J. 6160
PROJECT NO.: 8798-08-1918 (42)

REV. NO.	DESCRIPTION
0	2/28/10 FOR PERMIT
1	FOR PERMIT
2	DESCRIPTION
3	DESCRIPTION
4	DESCRIPTION
5	DESCRIPTION
6	DESCRIPTION
7	DESCRIPTION
8	DESCRIPTION
9	DESCRIPTION
10	DESCRIPTION
11	DESCRIPTION
12	DESCRIPTION
13	DESCRIPTION
14	DESCRIPTION
15	DESCRIPTION
16	DESCRIPTION
17	DESCRIPTION
18	DESCRIPTION
19	DESCRIPTION
20	DESCRIPTION
21	DESCRIPTION
22	DESCRIPTION
23	DESCRIPTION
24	DESCRIPTION
25	DESCRIPTION
26	DESCRIPTION
27	DESCRIPTION
28	DESCRIPTION
29	DESCRIPTION
30	DESCRIPTION
31	DESCRIPTION
32	DESCRIPTION
33	DESCRIPTION
34	DESCRIPTION
35	DESCRIPTION
36	DESCRIPTION
37	DESCRIPTION
38	DESCRIPTION
39	DESCRIPTION
40	DESCRIPTION

DESIGNED BY: M. ARREY
CHECKED BY: D. JOHNSON



DATE OF SIGNATURE: 2/28/10

EAST KEY WEST
(KENNEDY CENTER
CONDO)

1010 KENNEDY DRIVE
KEY WEST, FL 33040

SHEET NAME

TITLE SHEET

SHEET NUMBER

Z1

PROPOSED INSTALLATION OF TELECOMMUNICATIONS EQUIPMENT ON ROOFTOP

SITE DATA		APPROVALS		CONSTRUCTION NOTES		INDEX OF DRAWINGS	
FIELD #:	00065690-000100	CONSTRUCTION MANAGER		1. ALL NEW BUILDINGS AND STRUCTURES HAVE BEEN DESIGNED IN ACCORDANCE WITH THE 2007 EDITION OF THE FLORIDA BUILDING CODE AND ALL STRUCTURES FOR DESIGN PRESSURE RESISTANCE WITH NOMINAL DESIGN 3-SECOND GUST WIND VELOCITY OF 150 MPH.	SHT. NO.	DESCRIPTION	REV. NO.
LATITUDE:	24° 33' 56.96" N	SITE ACQUISITION		2. CONTRACTOR SHALL VERIFY ALL PLANS AND EXISTING DIMENSIONS AND CONDITIONS ON THE JOB SITE AND SHALL IMMEDIATELY DISCREPANCIES BE DETECTED. THE WORK ON BE RESPONSIBLE FOR SAME.	21	TITLE SHEET	0
LONGITUDE:	81° 46' 04.90" W	RF ENGINEER		3. CONTRACTOR SHALL NOTIFY OWNER FOR ACCESS TO SITE.	22	SITE PLAN	0
ZONING:	CITY OF KEY WEST	PROPERTY OWNER			23	ROOF PLAN	0
ADDRESS:	CITY OF KEY WEST	CONSTRUCTION MANAGER (FINAL)			24	EQUIPMENT LAYOUT	0
ZONING CLASSIFICATION:	COMMERCIAL CONDO	PROJECT INFORMATION			25	BUILDING ELEVATIONS	0
PROPERTY OWNER(S):	KENNEDY BUILDING ASSOCIATES, LLC PO BOX 2039 KEY WEST, FL 33045	1. THIS IS AN UNMANNED FACILITY AND WILL BE USED FOR THE TRANSMISSION OF RADIO SIGNALS FOR THE PURPOSE OF PROVIDING PUBLIC CELLULAR SERVICE.			26	BUILDING ELEVATIONS	0
LEGAL DESCRIPTION:	UNIT 101 KENNEDY CENTER CONDOMINIUM	2. ALWAYS REMEMBER THAT THIS EQUIPMENT FACILITY WILL BE SERVICED ONLY BY AT&T EMPLOYEES AND SUBCONTRACTORS. ANY EQUIPMENT CANNOT BE PERFORMED BY HANDICAPPED PERSONNEL FOR PURPOSES ONLY.			27	BUILDING ELEVATIONS	0
		3. NO POTABLE WATER SUPPLY IS TO BE PROVIDED AT THIS LOCATION.			28	BUILDING ELEVATIONS	0
		4. NO WASTEWATER WILL BE GENERATED AT THIS LOCATION.					
		5. NO SOLID WASTE WILL BE GENERATED AT THIS LOCATION.					



MACTEC
 MACTEC ENGINEERING & CONSULTING, INC.
 CORPORATE OFFICE
 1102 LAURELWOOD PARKWAY
 LAURELWOOD, FL 33014
 (954) 333-1200
 5845 SW 13TH STREET
 MIAMI DAVES, FL 33014
 (305) 446-1200
 FAX (305) 638-1299

CERTIFICATE OF AUTHORIZATION # 6590

PROJECT NO.	8788-08-1915 (43)	
REV	DATE	DESCRIPTION
0	2/26/10	FOR PERMIT
DRAWN BY: O. JOHNSON		
CHECKED BY: M. AMERY		



DATE OF SIGNATURE: 2/26/10
 EAST KEY WEST
 (KENNEDY CENTER
 CONDO)
 1010 KENNEDY DRIVE
 KEY WEST, FL 33040
 SHEET NAME
 SITE PLAN
 SHEET NUMBER
 72

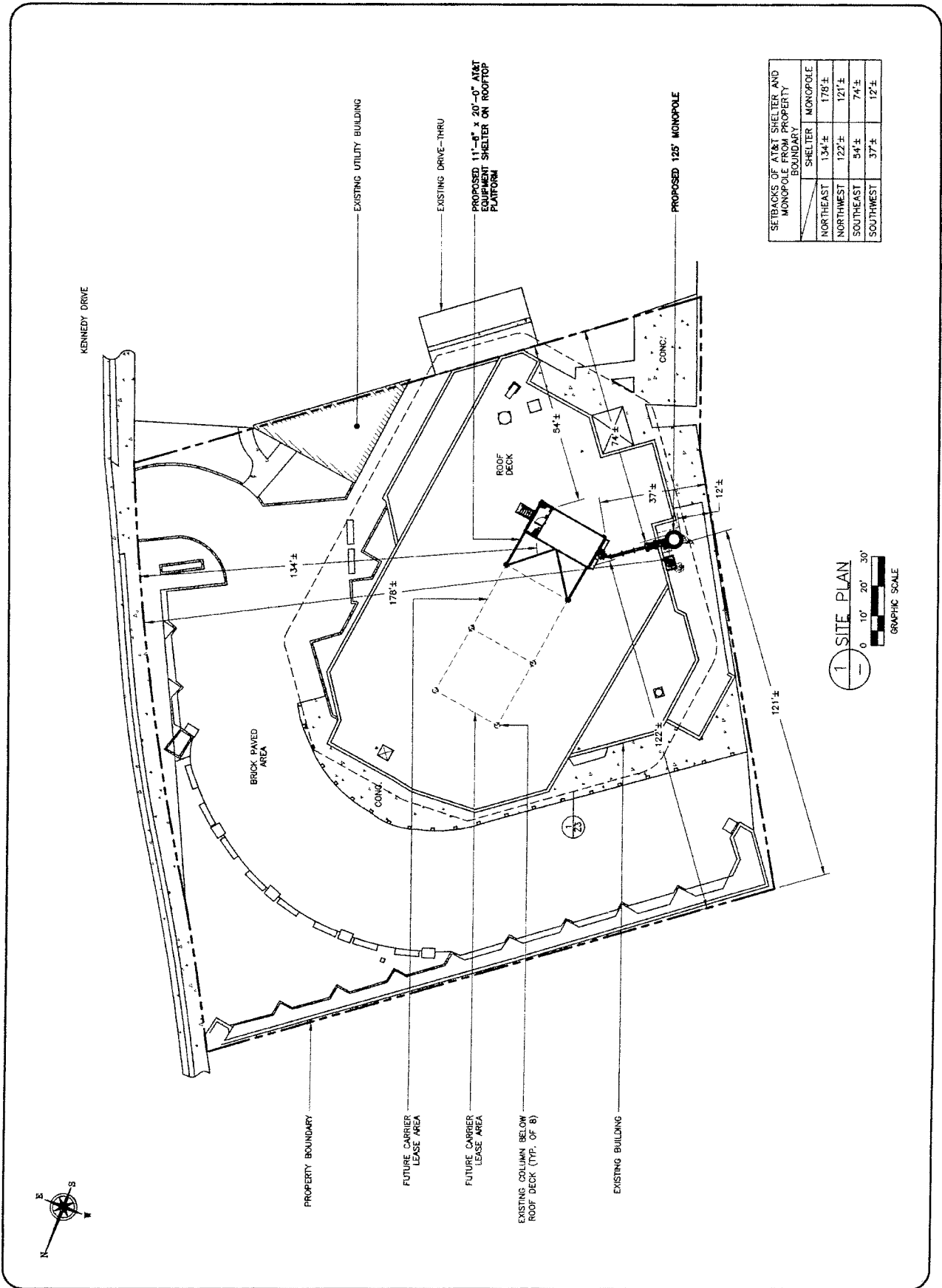

SETBACKS OF AT&T SHELTER AND MONOPOLE FROM PROPERTY BOUNDARY

SHELTER	MONOPOLE	
NORTHEAST	134'±	178'±
NORTHWEST	122'±	121'±
SOUTHEAST	54'±	74'±
SOUTHWEST	37'±	12'±





MACTEC
 MACTEC ENGINEERING & CONSULTING, INC.
 1105 GARDNER PARKWAY
 ALPHARETTA, GA 30004
 LOCAL OFFICE
 2645 WINDY HILL
 WALKER, FL 33014
 TEL: (305) 516-5548
 FAX: (305) 584-1799

CERTIFICATE OF ADOPTION: F. 8230
 PROJECT NO.: 0726-09-1812 (43)

REV	DATE	DESCRIPTION
0	2/26/10	FOR PERMIT

DRAWN BY: O. JOHNSON
 CHECKED BY: M. ABEY



DATE OF SIGNATURE: 2/26/10
**EAST KEY WEST
 (KENNEDY CENTER
 CONDO)**
 1010 KENNEDY DRIVE
 KEY WEST, FL 33040
 SHEET NAME
**ROOF
 PLAN**
 SHEET NUMBER
73

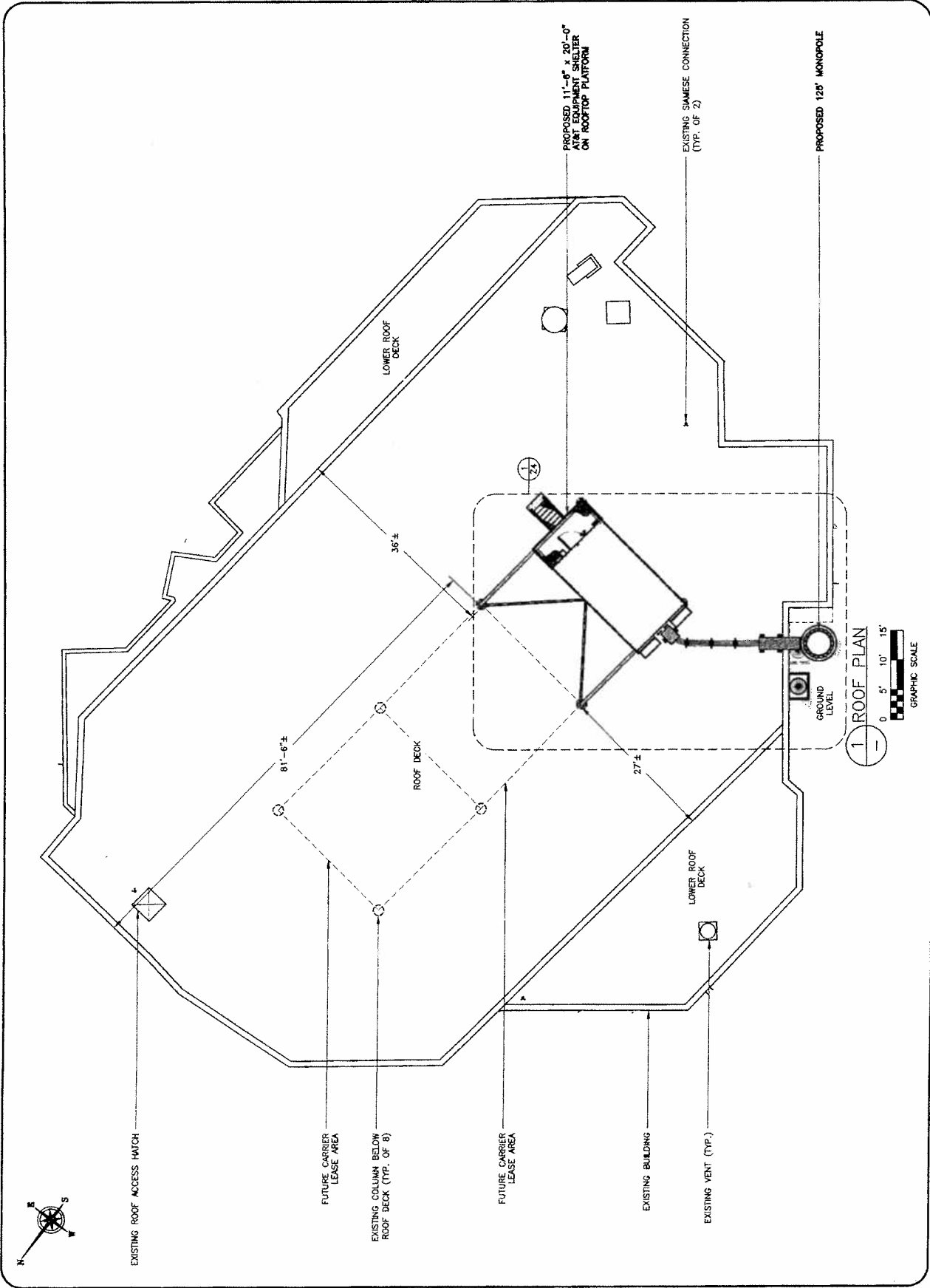

THIS DRAWING IS CHECKED AND IS THE SOLE PROPERTY OF THE OWNER. IT IS PRODUCED SOLELY FOR USE BY THE OWNER AND ITS AFFILIATES, REPRODUCTION OR USE OF THIS DRAWING AND/OR THE INFORMATION CONTAINED HEREIN WITHOUT THE WRITTEN PERMISSION OF THE OWNER.



MACTEC
 MACTEC ENGINEERING & CONSULTING, INC.
 CORPORATE OFFICE
 11500 WILLOW CREEK
 ALPHARETTA, GA 30004
 LOCAL OFFICE
 1010 KENNEDY BOULEVARD
 MIAMI BEACH, FL 33109
 TEL: (404) 994-5068
 FAX: (404) 994-1789

GENERAL & AUTHORIZATION # 6090

PROJECT NO.: 8798-09-1916 (42)

REV	DATE	DESCRIPTION
0	2/25/10	FOR PERMIT

DRAWN BY: O. JOHNSON
 CHECKED BY: N. ARBEY



DATE OF SIGNATURE: 2/26/10
 EAST KEY WEST
 (KENNEDY CENTER
 CONDO)
 1010 KENNEDY BOULEVARD
 KEY WEST, FL 33040
 SHEET NAME
**EQUIPMENT
 LAYOUT**
 SHEET NUMBER
Z4

