



RECEIVED
July 12, 2011
KW Planning Dpt



Carlos O. Rojas, AIA
AR 0016754
2017 Roosevelt Drive
Key West, FL 33040
(305) 292-4870
Ttrojesa@horrnal.com

Revisions
REV 7-12-11

Carlos O. Rojas, AIA
512 Greene Street
Key West, Florida 33040

Project Number
092716GR
Date
09/21/09
Drawn By
COR
Check By

A1

LIGHTING NOTE:
POLE LIGHTS AND LOW VOLTAGE LIGHTING TO BE ON DUSK TO DAWN TIMER OR NIGHT SENSING SWITCH.
SECURITY LIGHTS TO BE ON DAWN TO DUSK TIMER SWITCH.
DOWN LIGHTS ARE TO BE ON MANUAL SWITCH.

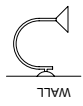

DOWN LIGHT



SECURITY LIGHT

SYMBOL	DESCRIPTION
(L)	LOW VOLTAGE FOOTLIGHT
(X)	LIMITED DIRECTION SECURITY LIGHT ON 12 POLE
(A)	DIRECTIONAL SECURITY LIGHTS MOUNTED AT 6' ON BUILDING
(S)	DOWN LIGHT MOUNTED AT 6' ON BUILDING TO ILLUMINATE DOORWAY OR BRUSH

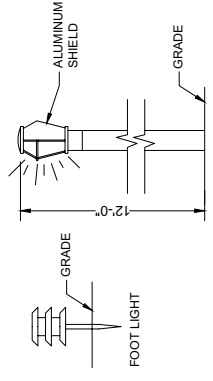

LIMITED DIRECTION LIGHT

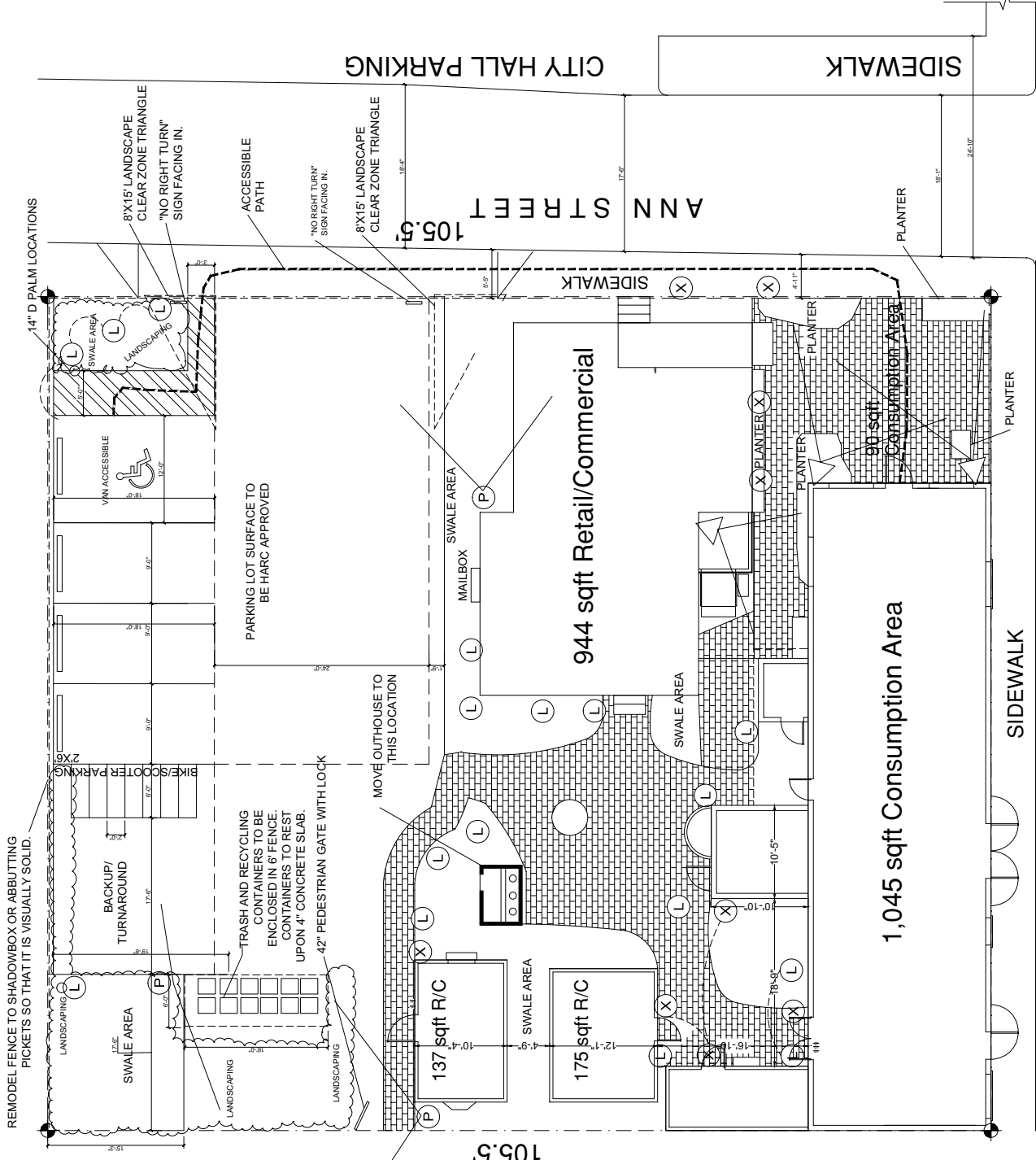

93.25'
1 SITE PLAN PROPOSED
1/8" = 1'-0"

**Stormwater Drainage
Approval & Plan**



THE CITY OF KEY WEST

Post Office Box 1409 Key West, FL 33041-1409 (305) 809-3700

TO: Donald Craig, Planner
Nicole Malo, Planner

CC: Trepanier & Associates, Inc.
Rick Milelli, P.E.
Doug Bradshaw, Senior Project Manager

FROM: Elizabeth Ignoffo, E.I., Permit Engineer

DATE: April 21, 2011

**SUBJECT: 512 Greene Street
Parking Lot Drainage Plan Review & Comments**

The Site and Drainage Plans, dated March 24, 2011, for 512 Greene Street have been reviewed. The following comments are provided:

1. The Site Plan shows a proposed asphalt parking area, including eight (8) bicycle spaces, three (3) standard vehicle parking spaces, one (1) van-accessible parking ADA space, and trash and recycling storage area.
2. The parking area impervious area will be reduced by approximately 130 square feet. The percent impervious area for the proposed parking area will be 74.8%.
3. The Drainage Plan shows a 24LF trench grate installed at the driveway entrance, three (3) stormwater retention swales, and grading to direct the stormwater runoff into the swales.
4. The required stormwater retention volume, allowing a 50% credit for utilization of dry retention, is based on 2.5 inches times the percent impervious ratio, shall be 365 cubic feet.
5. The combined retention volume of Swale A, B and C is 411 cubic feet.

The architect's Site Plan, Sheet A1, revision date 12/19/2010, shows the parking area lighting plan and ADA Access Route. The Site Plan A1, Site Plan C-1, and Drainage Plan C-2 meet the requirements of the City of Key West Code of Ordinances, Chapter 108 Off-street Parking and Loading.

Solid Waste Plan



Carlos O. Rojas, AIA
2017 Roosevelt Drive
Key West, FL 33040
(305) 292-4870
T:trrojasa@horthal.com

Revisions
REV 7-12-11

Carlos O. Rojas, AIA
512 Greene Street
Key West, Florida 33040

Project Number
05212GR
Date
05/21/09
Drawn By
COR
CGR

A1

LIGHTING NOTE:
POLE LIGHTS (L) ON VOLTAGE FOOTLIGHTS TO BE ON DUSK TO DAWN TIMER OR NIGHT SENSING SWITCH.
SECURITY LIGHTS (S) TO BE ON DUSK TO DAWN TIMER SWITCH.
DOWN LIGHTS ARE TO BE ON MANUAL SWITCH.



DOWN LIGHT



SECURITY LIGHT

SYMBOL	DESCRIPTION
(L)	LOW VOLTAGE FOOTLIGHT
(S)	LIMITED DIRECTION SECURITY LIGHT ON 12 POLE
(X)	DIRECTIONAL SECURITY LIGHTS MOUNTED AT 6' ON BUILDING
(X)	DOWN LIGHT MOUNTED AT 6' ON BUILDING TO ILLUMINATE DOORWAY OR SIGN

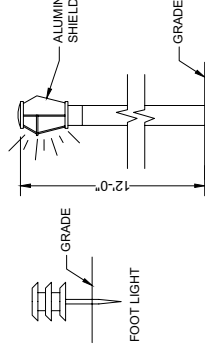

LIMITED DIRECTION LIGHT

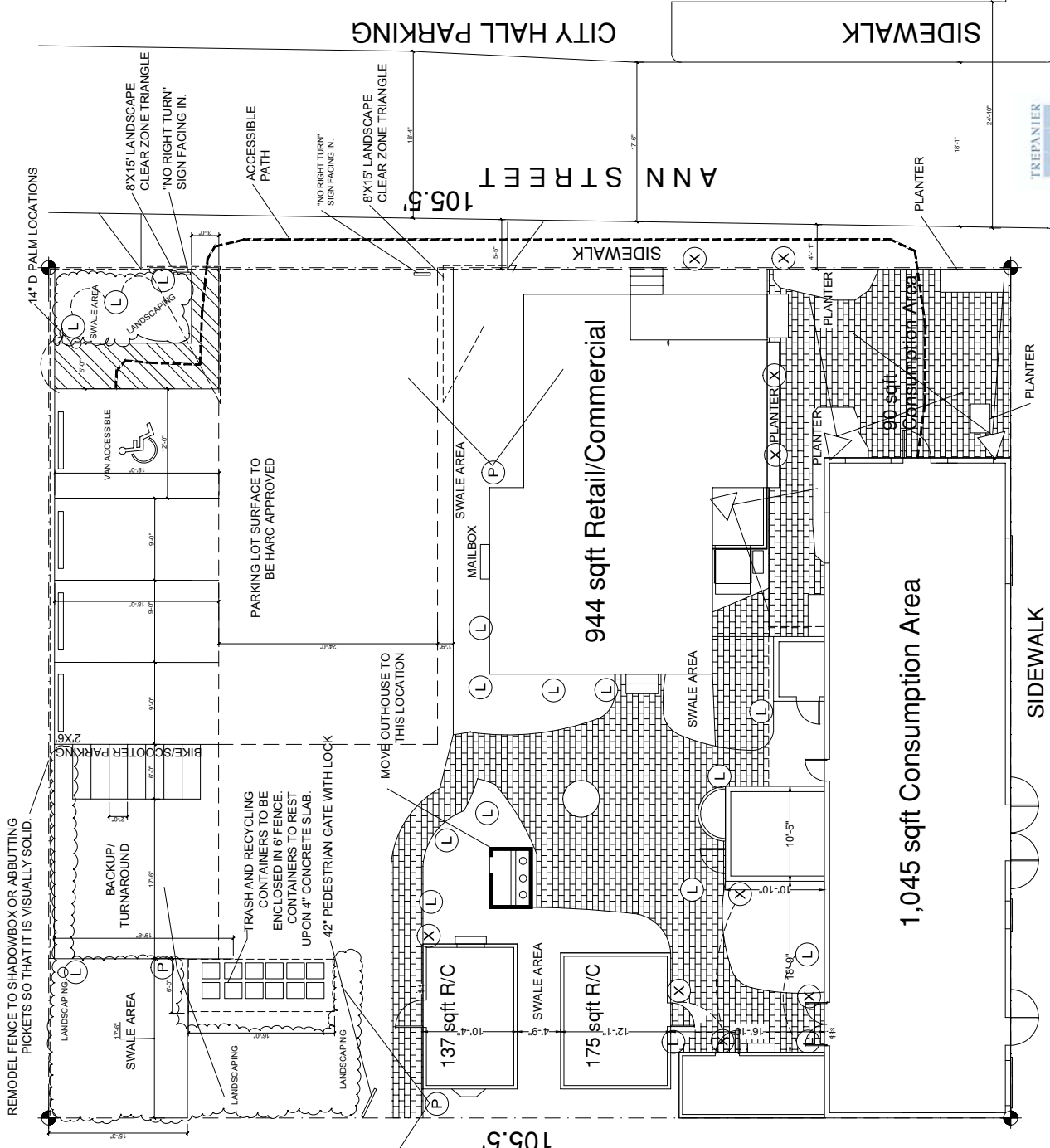

93.25'
1 SITE PLAN PROPOSED
1/8" = 1'-0"