

Natalie Hill

From: Karen DeMaria
Sent: Wednesday, April 18, 2018 10:51 AM
To: Natalie Hill
Cc: Melissa Paul-Leto
Subject: RE: April DRC Agenda

My e-mail comments regarding 638 United-Major Development Plan and 3228 Flagler Ave-Minor Development Plan dated March 28 and April 4, 2018 respectively are still valid. I have not received any updates from the consultant. I have no comment regarding the Conditional Use request for 3228 Flagler Avenue.

I have no comment regarding the Easement request for 528 Duval Street.

Sincerely,

Karen

Karen DeMaria
Urban Forestry Manager/Tree Commission
Certified Arborist
305-809-3768

From: Natalie Hill
Sent: Tuesday, April 17, 2018 4:51 PM

DRC Members:

The April DRC Agenda is now available for review on the City's website.

<http://keywest.legistar.com/Calendar.aspx>

Respectfully,

Natalie L. Hill

Administrative Assistant II
City of Key West
Planning Department at
Josephine Parker City Hall
1300 White Street
(305) 809-3764
nhill@cityofkeywest-fl.gov
www.cityofkeywest-fl.gov

Value and Condition Policy Guidelines (October 2011)

Location: 60% = if in fence area or utility lines
40% = if foundation issues
20% = major foundation issues, utility lines and/or safety issues

Species: 100% = on protected tree list as stated in Sec 110-253
50% = not on protected tree list or unprotected tree list but is over 3.5" dbh
0% = on unprotected tree list as stated in Sec 110-254

Condition: Look at the height of tree, the crown and trunk, any injuries or disease
100% = excellent health
80% = good health
60% = fair health
40% = poor health
20% = diseased
0 = dead tree

TREE #	LOCAL NAME	BOTANICAL NAME	NOTES	APPRX. DSH	HEIGHT	SPREAD	Remove	Location	CONDITION (%)			
									Species	Condition	Mit. Req.	Total
1	Bushy Fleabane	Pluchea carolinensis	NN - shrub - volunteers not protected	na	24"	36"	X	0	0	0	n	0
2	Washington Palm	Washingtonia robusta	NN - not protected	12"	10' oa	10'	X	0	0	0	n	0
3	Bushy Fleabane	Pluchea carolinensis	NN - shrub - volunteers not protected	na	24"	36"	X	0	0	0	n	0
4	Triangle Palm	Dypsis decaryi	NN - not protected	12"	10' oa	8'	X	0	0	0	n	0
5	Gumbo Limbo	Bursea simaruba	Native - Poor Condition	4"	8'	8'	X	0	100	50	n	50
6	Areca Palm	Dypsis lutescens	NN - not protected	na	6'	4'	X	0	0	0	n	0
7	Areca Palm	Dypsis lutescens	NN - not protected	na	6'	4'	X	0	0	0	n	0
8	Areca Palm	Dypsis lutescens	NN - not protected	na	6'	4'	X	0	0	0	n	0
9	Stangler Fig	Ficus aurea	Native - Poor Condition	2"	6'	3'	X	0	100	50	n	50
											Total Mitigation %	50%

FLAGLER AVENUE MIXED-USE
KEY WEST, FL 33040



SCALE 1" = 10'-0"

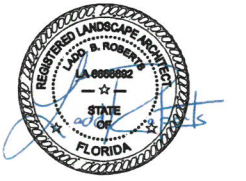

FLAGLER AVE MIXED USE

DATE: 2.15.18

REVISIONS:		
No.	Date	Notes
1.		
2.		

CONSTRUCTION DOCUMENTS

SHEET NUMBER:
L-1

JOB #: 18002 DRAWN BY: LBR
THIS DRAWING IS THE PROPERTY OF LANDWISE DESIGN, INC. UNLESS OTHERWISE PROVIDED FOR BY CONTRACT, THE CONTENTS OF THIS DRAWING ARE CONFIDENTIAL AND SHALL NOT BE TRANSMITTED TO ANY OTHER PARTY EXCEPT AS AGREED TO BY LANDWISE DESIGN, INC.
© Copyright 2018

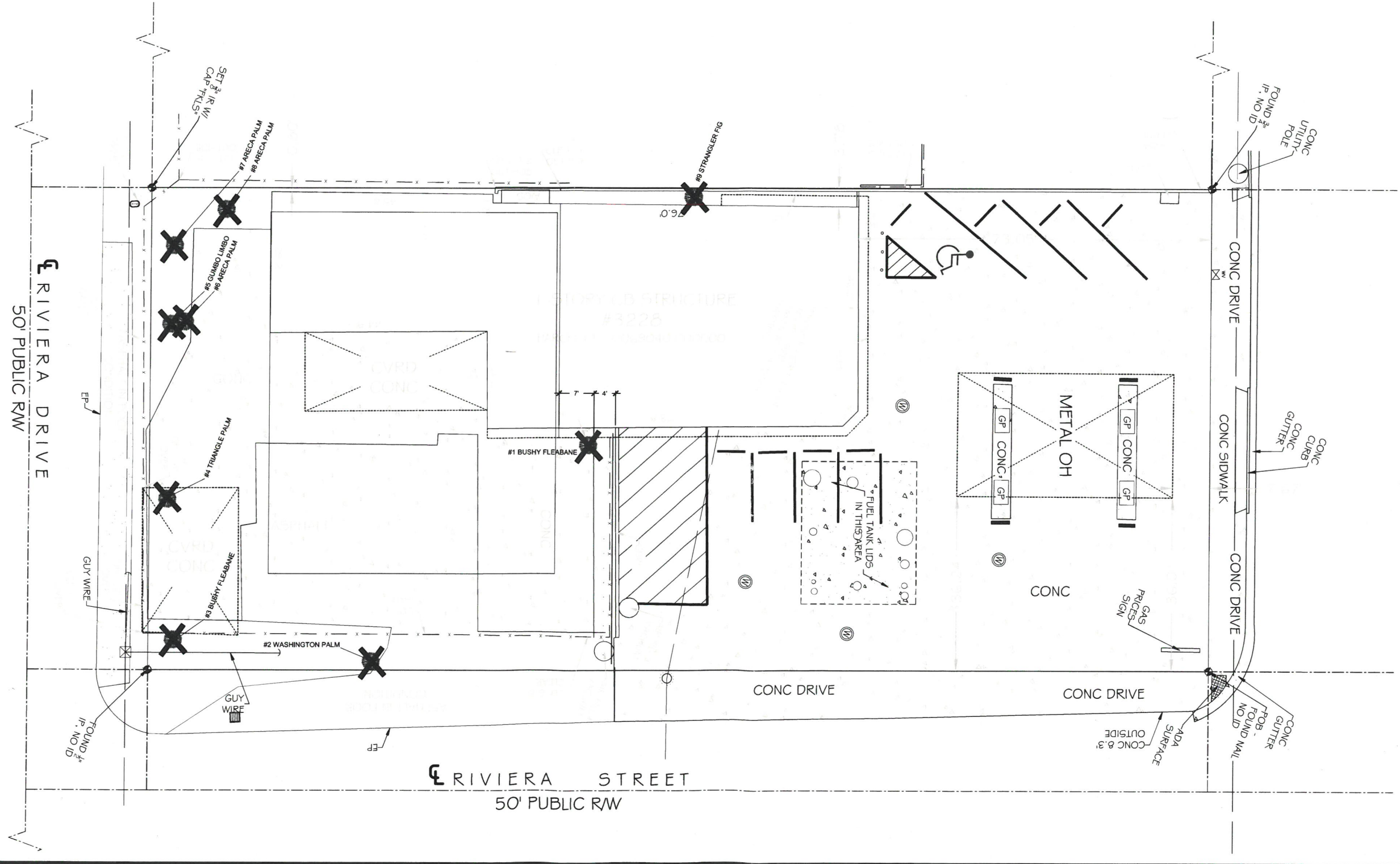

THIS DRAWING, DESIGN AND INVENTION IS THE INSTRUMENT OF SERVICE AND PROPERTY OF LANDWISE DESIGN, INC. ANY USE OR REPRODUCTION WITHOUT EXPRESSED WRITTEN PERMISSION FROM LANDWISE DESIGN, INC. IS PROHIBITED.