

1319 Williams ST, Minor Modification to MDP



APPLICATION

MEMORANDUM

TREPANIER



& ASSOCIATES INC
LAND USE PLANNING
DEVELOPMENT CONSULTANTS

Date: September 15, 2022 (revised)
To: Ms. Katie Halloran, City Planner
From: Thomas Francis-Siburg
CC: Mr. Paul Misch, Owner
 Mr. Owen Trepanier
Re: **1319 William Street-1316 Royal Street (RE# 00036920-000000)**
Condition Modification to Res. No. 21-197

This is the applicant response to DRC comments on 05/26/22 regarding the conditions of the Major Development Plan Res. No. 21-197 to relative to phasing.

DRC Comment:

Katie Halloran - Planning Director: BPAS approvals would expire prior to permits being pulled. A development agreement is the only mechanism to extend BPAS approvals. The current expiration date of the BPAS approval is 10/31/2023. Please review Secs. 90-360.B, 90-361, Sec. 108-203, and Sec. 108-248.

Applicant Response:

The proposed phasing shall require construction of Unit 4 to commence permitting prior to the expiration of its associated BPAS.

Phasing Plan

Phase	Units	ROGO		Commencement	Completion
		Type	Exp. Date		
1	1	Beneficial	NA	11/15/22 - Commenced	Progress and completion pursuant to the KW LDRs and Florida Building Code
	3	Beneficial	NA	11/15/22 - Commenced	
	5	BPAS	10/31/23	11/15/22 - Commenced	
2	4	BPAS	10/31/23	04/15/24 or prior to the expiration of the associated BPAS, whichever is sooner ¹	
	6	Beneficial	NA	04/15/24	
3	2	Beneficial	NA	04/15/26	

DRC Comment:

Karen DeMaria - Urban Forestry Manager: Landscape planting will need to be in coordination with phasing, COs will only be issued when there is substantial landscaping per house.

Applicant Response:

The portion of landscaping associated with and adjacent to each individual unit shall be installed prior to the issuance of the C.O. for each individual unit. Landscaping around the existing structures along William Street will be installed / planted prior to the issuance of the C.O. of units 2, 4, and 6.

¹ Expiration dates are subject to change pursuant to F.S. 252.363 (State of Emergency Extensions)

DRC Comment:

Mario Duron – Planning Consultant: There is a requirement for AIPP. Do you have timing details for that?

Applicant Response:

The 2 required art pieces will be installed prior to the issuance of the C.O. of units 2, 4, and 6.

1319 Williams ST, Minor Modification to MDP



CONSTRUCTION MANAGEMENT PLAN

Construction Management Plan and Inspection Schedule

1319 William & 1300 Royal Street
(RE No. 00036920-000000)

Revised 9/14/2022



Construction Management Plan and Inspection (Sec. 108-248):

PHASING SCHEDULE

Phase	Units	ROGO		Commencement	Completion
		Type	Exp. Date		
1	1	Beneficial	NA	11/15/22 - Commenced	Progress and completion pursuant to the KW LDRs and Florida Building Code
	3	Beneficial	NA	11/15/22 - Commenced	
	5	BPAS	10/31/23	11/15/22 - Commenced	
2	4	BPAS	10/31/23	04/15/24 or prior to the expiration of the associated BPAS, whichever is sooner ¹	
	6	Beneficial	NA	04/15/24	
3	2	Beneficial	NA	04/15/26	

PROJECT DOCUMENTATION

The contractor shall maintain all applicable local, state, and federal licenses and permits that apply to the construction project.

Compliance with any and all required public notifications shall be met.

A project sign shall be constructed and posted that identifies, at a minimum, the property owner, contractor, and land use planner.

PROJECT IMPLEMENTATION

Dates of construction shall commence according to the phasing schedule.

Construction hours shall comply with all applicable Ordinances.

Project shall be constructed as three phases.

No person shall excavate on land close enough to a property line to endanger any adjacent public street, sidewalk, and alley, other public or private property, or easement, without supporting and protecting the property from any damage that might result from construction operations.

All construction areas shall have a non-removable construction fence or other approved device securely placed around the areas to be protected.

¹ Expiration dates are subject to change pursuant to F.S. 252.363 (State of Emergency Extensions)

The construction project shall uphold respect to public health and welfare.

Project construction shall be oriented to minimize harm to all aspects of the property's natural environment.

The portion of any and all needed infrastructure associated with and adjacent to each individual unit shall be installed prior to the issuance of the C.O. for each individual unit.

PARKING MANAGEMENT

The contractor shall maintain continuous emergency vehicle access, on and around site, including but not limited to police, fire, and ambulance services. This includes projects adjacent to roads and alleys.

The project shall accommodate construction staging areas on site.

Construction trailers, job materials storage, portable restrooms, waste management and recycling containers shall be stored on private property and not within ROW, without the required approvals.

TRAFFIC CONTROL

All traffic control operations shall be managed by the designated traffic control supervisor.

Project haul routes shall be oriented to minimize traffic congestion and maximize pedestrian safety.

SEDIMENT AND EROSION CONTROL

The project shall employ Best Management Practices, which will minimize erosion and sediment transport.

- a. Stock piles must be protected with erosion control devices.
- b. County and near shore water inlets, gutters, swales and irrigation ditches shall be protected with erosion control devices and such protection maintained for the duration of the project.

EMISSIONS

All vehicles and equipment used on site will be properly maintained such that the engines will function within manufacture's standards or parameters.

NOISE SUPPRESSION

The noise limit for construction shall comply with any and all requirements of the County Code. All construction equipment shall be adequately muffled and maintained to minimize project noise.

1319 Williams ST, Minor Modification to MDP



PHASING DIAGRAM

Landscaping around the existing structures along William Stet will be installed / planted prior to the issuance of the C.O. of units 2, 4, and 6.

SITE UTILITIES NOTES:

1. ALL ELECTRIC, CABLE, INTERNET AND WATER SERVICES SHALL COME FROM ROYAL STREET SIDE OF THE PROPERTY AND SHALL BE UNDERGROUND ON SITE
2. ALL SEWER LINES FROM INDIVIDUAL UNITS SHALL JOIN A MAIN BRANCH UNDER THE CENTER DRIVE AND CONNECT TO SEWER MAIN ON ROYAL STREET

SITE LIGHTING SYMBOL KEY

- ☉ PEDESTRIAN PATH GROUND LEVEL DOWN-LIGHT
- ☉ PEDESTRIAN PATH WALL MOUNTED DOWN-LIGHT
- ☉ WALL MOUNTED AREA LIGHT (PARKING & DRIVEWAY)

EXTERIOR LIGHTING NOTES:

1. ALL LIGHTING FIXTURES SHALL BE FULLY SHIELDED AND ALL LIGHT SHALL BE DOWN LIGHTING
2. LIGHT SHALL BE NO LOWER THAN 10' FROM ANY PROPERTY LINE OR DRIVE
3. LIGHT SHALL BE NO LOWER THAN 12' FROM ANY SIDEWALK OR DRIVE
4. LIGHT SHALL BE NO LOWER THAN 15' FROM ANY DRIVEWAY
5. LIGHT SHALL BE NO LOWER THAN 18' FROM ANY DRIVE
6. LIGHT SHALL BE NO LOWER THAN 20' FROM ANY DRIVEWAY
7. LIGHT SHALL BE NO LOWER THAN 25' FROM ANY DRIVE
8. LIGHT SHALL BE NO LOWER THAN 30' FROM ANY DRIVEWAY
9. LIGHT SHALL BE NO LOWER THAN 35' FROM ANY DRIVE
10. LIGHT SHALL BE NO LOWER THAN 40' FROM ANY DRIVEWAY
11. LIGHT SHALL BE NO LOWER THAN 45' FROM ANY DRIVE
12. LIGHT SHALL BE NO LOWER THAN 50' FROM ANY DRIVEWAY
13. LIGHT SHALL BE NO LOWER THAN 55' FROM ANY DRIVE
14. LIGHT SHALL BE NO LOWER THAN 60' FROM ANY DRIVEWAY
15. LIGHT SHALL BE NO LOWER THAN 65' FROM ANY DRIVE
16. LIGHT SHALL BE NO LOWER THAN 70' FROM ANY DRIVEWAY
17. LIGHT SHALL BE NO LOWER THAN 75' FROM ANY DRIVE
18. LIGHT SHALL BE NO LOWER THAN 80' FROM ANY DRIVEWAY
19. LIGHT SHALL BE NO LOWER THAN 85' FROM ANY DRIVE
20. LIGHT SHALL BE NO LOWER THAN 90' FROM ANY DRIVEWAY
21. LIGHT SHALL BE NO LOWER THAN 95' FROM ANY DRIVE
22. LIGHT SHALL BE NO LOWER THAN 100' FROM ANY DRIVEWAY
23. LIGHT SHALL BE NO LOWER THAN 105' FROM ANY DRIVE
24. LIGHT SHALL BE NO LOWER THAN 110' FROM ANY DRIVEWAY
25. LIGHT SHALL BE NO LOWER THAN 115' FROM ANY DRIVE
26. LIGHT SHALL BE NO LOWER THAN 120' FROM ANY DRIVEWAY
27. LIGHT SHALL BE NO LOWER THAN 125' FROM ANY DRIVE
28. LIGHT SHALL BE NO LOWER THAN 130' FROM ANY DRIVEWAY
29. LIGHT SHALL BE NO LOWER THAN 135' FROM ANY DRIVE
30. LIGHT SHALL BE NO LOWER THAN 140' FROM ANY DRIVEWAY
31. LIGHT SHALL BE NO LOWER THAN 145' FROM ANY DRIVE
32. LIGHT SHALL BE NO LOWER THAN 150' FROM ANY DRIVEWAY
33. LIGHT SHALL BE NO LOWER THAN 155' FROM ANY DRIVE
34. LIGHT SHALL BE NO LOWER THAN 160' FROM ANY DRIVEWAY
35. LIGHT SHALL BE NO LOWER THAN 165' FROM ANY DRIVE
36. LIGHT SHALL BE NO LOWER THAN 170' FROM ANY DRIVEWAY
37. LIGHT SHALL BE NO LOWER THAN 175' FROM ANY DRIVE
38. LIGHT SHALL BE NO LOWER THAN 180' FROM ANY DRIVEWAY
39. LIGHT SHALL BE NO LOWER THAN 185' FROM ANY DRIVE
40. LIGHT SHALL BE NO LOWER THAN 190' FROM ANY DRIVEWAY
41. LIGHT SHALL BE NO LOWER THAN 195' FROM ANY DRIVE
42. LIGHT SHALL BE NO LOWER THAN 200' FROM ANY DRIVEWAY
43. LIGHT SHALL BE NO LOWER THAN 205' FROM ANY DRIVE
44. LIGHT SHALL BE NO LOWER THAN 210' FROM ANY DRIVEWAY
45. LIGHT SHALL BE NO LOWER THAN 215' FROM ANY DRIVE
46. LIGHT SHALL BE NO LOWER THAN 220' FROM ANY DRIVEWAY
47. LIGHT SHALL BE NO LOWER THAN 225' FROM ANY DRIVE
48. LIGHT SHALL BE NO LOWER THAN 230' FROM ANY DRIVEWAY
49. LIGHT SHALL BE NO LOWER THAN 235' FROM ANY DRIVE
50. LIGHT SHALL BE NO LOWER THAN 240' FROM ANY DRIVEWAY
51. LIGHT SHALL BE NO LOWER THAN 245' FROM ANY DRIVE
52. LIGHT SHALL BE NO LOWER THAN 250' FROM ANY DRIVEWAY
53. LIGHT SHALL BE NO LOWER THAN 255' FROM ANY DRIVE
54. LIGHT SHALL BE NO LOWER THAN 260' FROM ANY DRIVEWAY
55. LIGHT SHALL BE NO LOWER THAN 265' FROM ANY DRIVE
56. LIGHT SHALL BE NO LOWER THAN 270' FROM ANY DRIVEWAY
57. LIGHT SHALL BE NO LOWER THAN 275' FROM ANY DRIVE
58. LIGHT SHALL BE NO LOWER THAN 280' FROM ANY DRIVEWAY
59. LIGHT SHALL BE NO LOWER THAN 285' FROM ANY DRIVE
60. LIGHT SHALL BE NO LOWER THAN 290' FROM ANY DRIVEWAY
61. LIGHT SHALL BE NO LOWER THAN 295' FROM ANY DRIVE
62. LIGHT SHALL BE NO LOWER THAN 300' FROM ANY DRIVEWAY
63. LIGHT SHALL BE NO LOWER THAN 305' FROM ANY DRIVE
64. LIGHT SHALL BE NO LOWER THAN 310' FROM ANY DRIVEWAY
65. LIGHT SHALL BE NO LOWER THAN 315' FROM ANY DRIVE
66. LIGHT SHALL BE NO LOWER THAN 320' FROM ANY DRIVEWAY
67. LIGHT SHALL BE NO LOWER THAN 325' FROM ANY DRIVE
68. LIGHT SHALL BE NO LOWER THAN 330' FROM ANY DRIVEWAY
69. LIGHT SHALL BE NO LOWER THAN 335' FROM ANY DRIVE
70. LIGHT SHALL BE NO LOWER THAN 340' FROM ANY DRIVEWAY
71. LIGHT SHALL BE NO LOWER THAN 345' FROM ANY DRIVE
72. LIGHT SHALL BE NO LOWER THAN 350' FROM ANY DRIVEWAY
73. LIGHT SHALL BE NO LOWER THAN 355' FROM ANY DRIVE
74. LIGHT SHALL BE NO LOWER THAN 360' FROM ANY DRIVEWAY
75. LIGHT SHALL BE NO LOWER THAN 365' FROM ANY DRIVE
76. LIGHT SHALL BE NO LOWER THAN 370' FROM ANY DRIVEWAY
77. LIGHT SHALL BE NO LOWER THAN 375' FROM ANY DRIVE
78. LIGHT SHALL BE NO LOWER THAN 380' FROM ANY DRIVEWAY
79. LIGHT SHALL BE NO LOWER THAN 385' FROM ANY DRIVE
80. LIGHT SHALL BE NO LOWER THAN 390' FROM ANY DRIVEWAY
81. LIGHT SHALL BE NO LOWER THAN 395' FROM ANY DRIVE
82. LIGHT SHALL BE NO LOWER THAN 400' FROM ANY DRIVEWAY
83. LIGHT SHALL BE NO LOWER THAN 405' FROM ANY DRIVE
84. LIGHT SHALL BE NO LOWER THAN 410' FROM ANY DRIVEWAY
85. LIGHT SHALL BE NO LOWER THAN 415' FROM ANY DRIVE
86. LIGHT SHALL BE NO LOWER THAN 420' FROM ANY DRIVEWAY
87. LIGHT SHALL BE NO LOWER THAN 425' FROM ANY DRIVE
88. LIGHT SHALL BE NO LOWER THAN 430' FROM ANY DRIVEWAY
89. LIGHT SHALL BE NO LOWER THAN 435' FROM ANY DRIVE
90. LIGHT SHALL BE NO LOWER THAN 440' FROM ANY DRIVEWAY
91. LIGHT SHALL BE NO LOWER THAN 445' FROM ANY DRIVE
92. LIGHT SHALL BE NO LOWER THAN 450' FROM ANY DRIVEWAY
93. LIGHT SHALL BE NO LOWER THAN 455' FROM ANY DRIVE
94. LIGHT SHALL BE NO LOWER THAN 460' FROM ANY DRIVEWAY
95. LIGHT SHALL BE NO LOWER THAN 465' FROM ANY DRIVE
96. LIGHT SHALL BE NO LOWER THAN 470' FROM ANY DRIVEWAY
97. LIGHT SHALL BE NO LOWER THAN 475' FROM ANY DRIVE
98. LIGHT SHALL BE NO LOWER THAN 480' FROM ANY DRIVEWAY
99. LIGHT SHALL BE NO LOWER THAN 485' FROM ANY DRIVE
100. LIGHT SHALL BE NO LOWER THAN 490' FROM ANY DRIVEWAY
101. LIGHT SHALL BE NO LOWER THAN 495' FROM ANY DRIVE
102. LIGHT SHALL BE NO LOWER THAN 500' FROM ANY DRIVEWAY
103. LIGHT SHALL BE NO LOWER THAN 505' FROM ANY DRIVE
104. LIGHT SHALL BE NO LOWER THAN 510' FROM ANY DRIVEWAY
105. LIGHT SHALL BE NO LOWER THAN 515' FROM ANY DRIVE
106. LIGHT SHALL BE NO LOWER THAN 520' FROM ANY DRIVEWAY
107. LIGHT SHALL BE NO LOWER THAN 525' FROM ANY DRIVE
108. LIGHT SHALL BE NO LOWER THAN 530' FROM ANY DRIVEWAY
109. LIGHT SHALL BE NO LOWER THAN 535' FROM ANY DRIVE
110. LIGHT SHALL BE NO LOWER THAN 540' FROM ANY DRIVEWAY
111. LIGHT SHALL BE NO LOWER THAN 545' FROM ANY DRIVE
112. LIGHT SHALL BE NO LOWER THAN 550' FROM ANY DRIVEWAY
113. LIGHT SHALL BE NO LOWER THAN 555' FROM ANY DRIVE
114. LIGHT SHALL BE NO LOWER THAN 560' FROM ANY DRIVEWAY
115. LIGHT SHALL BE NO LOWER THAN 565' FROM ANY DRIVE
116. LIGHT SHALL BE NO LOWER THAN 570' FROM ANY DRIVEWAY
117. LIGHT SHALL BE NO LOWER THAN 575' FROM ANY DRIVE
118. LIGHT SHALL BE NO LOWER THAN 580' FROM ANY DRIVEWAY
119. LIGHT SHALL BE NO LOWER THAN 585' FROM ANY DRIVE
120. LIGHT SHALL BE NO LOWER THAN 590' FROM ANY DRIVEWAY
121. LIGHT SHALL BE NO LOWER THAN 595' FROM ANY DRIVE
122. LIGHT SHALL BE NO LOWER THAN 600' FROM ANY DRIVEWAY
123. LIGHT SHALL BE NO LOWER THAN 605' FROM ANY DRIVE
124. LIGHT SHALL BE NO LOWER THAN 610' FROM ANY DRIVEWAY
125. LIGHT SHALL BE NO LOWER THAN 615' FROM ANY DRIVE
126. LIGHT SHALL BE NO LOWER THAN 620' FROM ANY DRIVEWAY
127. LIGHT SHALL BE NO LOWER THAN 625' FROM ANY DRIVE
128. LIGHT SHALL BE NO LOWER THAN 630' FROM ANY DRIVEWAY
129. LIGHT SHALL BE NO LOWER THAN 635' FROM ANY DRIVE
130. LIGHT SHALL BE NO LOWER THAN 640' FROM ANY DRIVEWAY
131. LIGHT SHALL BE NO LOWER THAN 645' FROM ANY DRIVE
132. LIGHT SHALL BE NO LOWER THAN 650' FROM ANY DRIVEWAY
133. LIGHT SHALL BE NO LOWER THAN 655' FROM ANY DRIVE
134. LIGHT SHALL BE NO LOWER THAN 660' FROM ANY DRIVEWAY
135. LIGHT SHALL BE NO LOWER THAN 665' FROM ANY DRIVE
136. LIGHT SHALL BE NO LOWER THAN 670' FROM ANY DRIVEWAY
137. LIGHT SHALL BE NO LOWER THAN 675' FROM ANY DRIVE
138. LIGHT SHALL BE NO LOWER THAN 680' FROM ANY DRIVEWAY
139. LIGHT SHALL BE NO LOWER THAN 685' FROM ANY DRIVE
140. LIGHT SHALL BE NO LOWER THAN 690' FROM ANY DRIVEWAY
141. LIGHT SHALL BE NO LOWER THAN 695' FROM ANY DRIVE
142. LIGHT SHALL BE NO LOWER THAN 700' FROM ANY DRIVEWAY
143. LIGHT SHALL BE NO LOWER THAN 705' FROM ANY DRIVE
144. LIGHT SHALL BE NO LOWER THAN 710' FROM ANY DRIVEWAY
145. LIGHT SHALL BE NO LOWER THAN 715' FROM ANY DRIVE
146. LIGHT SHALL BE NO LOWER THAN 720' FROM ANY DRIVEWAY
147. LIGHT SHALL BE NO LOWER THAN 725' FROM ANY DRIVE
148. LIGHT SHALL BE NO LOWER THAN 730' FROM ANY DRIVEWAY
149. LIGHT SHALL BE NO LOWER THAN 735' FROM ANY DRIVE
150. LIGHT SHALL BE NO LOWER THAN 740' FROM ANY DRIVEWAY
151. LIGHT SHALL BE NO LOWER THAN 745' FROM ANY DRIVE
152. LIGHT SHALL BE NO LOWER THAN 750' FROM ANY DRIVEWAY
153. LIGHT SHALL BE NO LOWER THAN 755' FROM ANY DRIVE
154. LIGHT SHALL BE NO LOWER THAN 760' FROM ANY DRIVEWAY
155. LIGHT SHALL BE NO LOWER THAN 765' FROM ANY DRIVE
156. LIGHT SHALL BE NO LOWER THAN 770' FROM ANY DRIVEWAY
157. LIGHT SHALL BE NO LOWER THAN 775' FROM ANY DRIVE
158. LIGHT SHALL BE NO LOWER THAN 780' FROM ANY DRIVEWAY
159. LIGHT SHALL BE NO LOWER THAN 785' FROM ANY DRIVE
160. LIGHT SHALL BE NO LOWER THAN 790' FROM ANY DRIVEWAY
161. LIGHT SHALL BE NO LOWER THAN 795' FROM ANY DRIVE
162. LIGHT SHALL BE NO LOWER THAN 800' FROM ANY DRIVEWAY
163. LIGHT SHALL BE NO LOWER THAN 805' FROM ANY DRIVE
164. LIGHT SHALL BE NO LOWER THAN 810' FROM ANY DRIVEWAY
165. LIGHT SHALL BE NO LOWER THAN 815' FROM ANY DRIVE
166. LIGHT SHALL BE NO LOWER THAN 820' FROM ANY DRIVEWAY
167. LIGHT SHALL BE NO LOWER THAN 825' FROM ANY DRIVE
168. LIGHT SHALL BE NO LOWER THAN 830' FROM ANY DRIVEWAY
169. LIGHT SHALL BE NO LOWER THAN 835' FROM ANY DRIVE
170. LIGHT SHALL BE NO LOWER THAN 840' FROM ANY DRIVEWAY
171. LIGHT SHALL BE NO LOWER THAN 845' FROM ANY DRIVE
172. LIGHT SHALL BE NO LOWER THAN 850' FROM ANY DRIVEWAY
173. LIGHT SHALL BE NO LOWER THAN 855' FROM ANY DRIVE
174. LIGHT SHALL BE NO LOWER THAN 860' FROM ANY DRIVEWAY
175. LIGHT SHALL BE NO LOWER THAN 865' FROM ANY DRIVE
176. LIGHT SHALL BE NO LOWER THAN 870' FROM ANY DRIVEWAY
177. LIGHT SHALL BE NO LOWER THAN 875' FROM ANY DRIVE
178. LIGHT SHALL BE NO LOWER THAN 880' FROM ANY DRIVEWAY
179. LIGHT SHALL BE NO LOWER THAN 885' FROM ANY DRIVE
180. LIGHT SHALL BE NO LOWER THAN 890' FROM ANY DRIVEWAY
181. LIGHT SHALL BE NO LOWER THAN 895' FROM ANY DRIVE
182. LIGHT SHALL BE NO LOWER THAN 900' FROM ANY DRIVEWAY
183. LIGHT SHALL BE NO LOWER THAN 905' FROM ANY DRIVE
184. LIGHT SHALL BE NO LOWER THAN 910' FROM ANY DRIVEWAY
185. LIGHT SHALL BE NO LOWER THAN 915' FROM ANY DRIVE
186. LIGHT SHALL BE NO LOWER THAN 920' FROM ANY DRIVEWAY
187. LIGHT SHALL BE NO LOWER THAN 925' FROM ANY DRIVE
188. LIGHT SHALL BE NO LOWER THAN 930' FROM ANY DRIVEWAY
189. LIGHT SHALL BE NO LOWER THAN 935' FROM ANY DRIVE
190. LIGHT SHALL BE NO LOWER THAN 940' FROM ANY DRIVEWAY
191. LIGHT SHALL BE NO LOWER THAN 945' FROM ANY DRIVE
192. LIGHT SHALL BE NO LOWER THAN 950' FROM ANY DRIVEWAY
193. LIGHT SHALL BE NO LOWER THAN 955' FROM ANY DRIVE
194. LIGHT SHALL BE NO LOWER THAN 960' FROM ANY DRIVEWAY
195. LIGHT SHALL BE NO LOWER THAN 965' FROM ANY DRIVE
196. LIGHT SHALL BE NO LOWER THAN 970' FROM ANY DRIVEWAY
197. LIGHT SHALL BE NO LOWER THAN 975' FROM ANY DRIVE
198. LIGHT SHALL BE NO LOWER THAN 980' FROM ANY DRIVEWAY
199. LIGHT SHALL BE NO LOWER THAN 985' FROM ANY DRIVE
200. LIGHT SHALL BE NO LOWER THAN 990' FROM ANY DRIVEWAY
201. LIGHT SHALL BE NO LOWER THAN 995' FROM ANY DRIVE
202. LIGHT SHALL BE NO LOWER THAN 1000' FROM ANY DRIVEWAY

SITE DATA:

ZONING: HMDR
 ZONING HMR: AUTO PARKING ALLOWED: N/A
 EXISTING: 10, PROPOSED: 16
 BICYCLE PARKING ALLOWED: N/A
 EXISTING: 4, PROPOSED: 24

SITE CALCS - ZONING DISTRICT: HMDR

	ALLOWED	EXISTING	PROPOSED	COMPLIANCE
HEIGHT	30'	N/A	30'	Yes
BUILDING COVERAGE	40%	8,431 s.f. (21.3%)	8,122 s.f. (20.7%)	Yes
IMPERVIOUS SURFACE RATIO	60%	11,275 s.f. (28.4%)	13,073 s.f. (33.6%)	Yes
LOT SIZE	Min: 4,000 s.f.	23,000 s.f.	N/A	N/A
LOT WIDTH	Min: 40'	110'	N/A	N/A
LOT DEPTH	Min: 90'	200'	N/A	N/A
FRONT SETBACK (MINIMUM)	Min: 10'	30'	N/A	Yes
FRONT SETBACK (MAXIMUM)	Min: 10'	54.7'	10'	Yes
SIDE SETBACK (NORTH)	Min: 5'	7.6'	5'	Yes
SIDE SETBACK (SOUTH)	Min: 5'	9.2'	5'	Yes
REAR SETBACK	Min: 15'	29.7'	15'	Yes
OPEN SPACE	Min: 35%	10,476 s.f. (26.6%)	8,240 s.f. (21.6%)	Yes

PROPERTY UNITS:
 THIS PROPERTY HAS BEEN ALLOCATED:
 6 BENEFACTORY USE UNITS
 2 SPAS UNITS
 TOTAL
 8 UNITS
 2 UNITS FOR EXISTING BUILDINGS 1317 & 1319

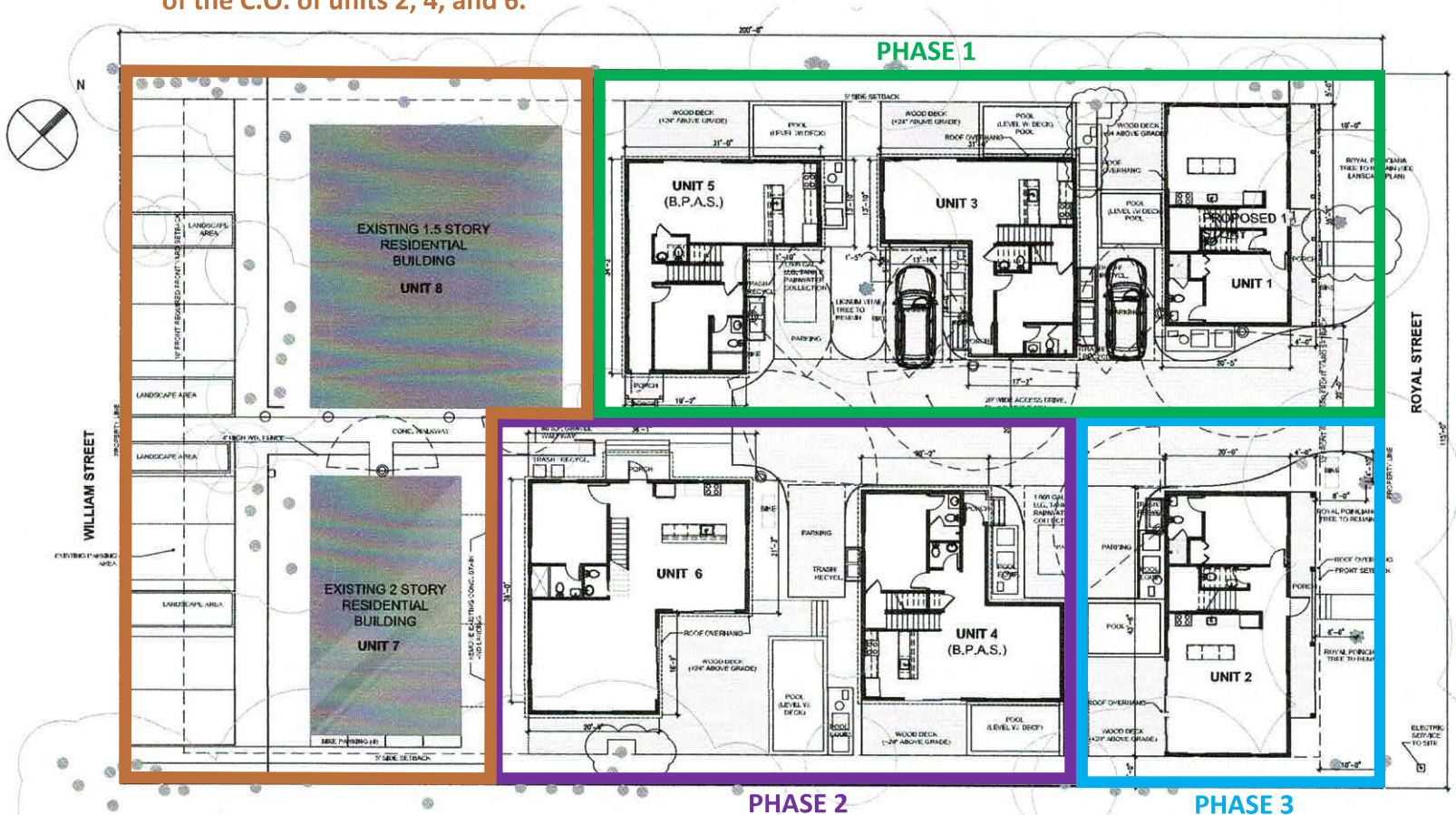

1 PROPOSED SITE PLAN
 SCALE: 1/8"=1'-0"

WS
 William Stetler & Associates
 architecture

393 Royal Street, Suite 101
 Key West, FL 33401
 Tel: 305.705.1111
 Email: wstetler@williamstetler.com

1316 ROYAL STREET
 KEY WEST, FL
 NEW RESIDENTIAL PROJECT

Submission / Revision:
 PLANNING REVIEW #1 (1/18)
 PLANNING REVIEW #2 (3/18)
 PLANNING REVIEW #3 (11/18)
 PLANNING REVIEW #4 (2/19)
 FINAL SUBMISSION (4/21)
 PLANNING REVIEW #5 (7/21)

Drawing Set / Project #:
 2026 / 1002

PROPOSED SITE PLAN

Sheet Number:
A-1.0

Date: 4/21/2019
 Drawn by: SPENTLER & ASSOCIATES ARCHITECTURE LLC

1319 Williams ST, Minor Modification to MDP



URBAN FORESTRY MANAGER MEMO



THE CITY OF KEY WEST – Tree Commission

Post Office Box 1409, Key West, FL 33041-1409
(305) 809-3768

Tree Commission
MEMORANDUM

Date: September 8, 2022

From: Karen DeMaria, Urban Forestry Manager

Reference: 1319 William Street-1316 Royal Street Development Plan Modification

A request was made to the Planning Department regarding the approval of the phasing of construction related to the approved development plan at 1319 William-1316 Royal Streets, Res #21-197.

On September 7, 2022, a revised memorandum was received regarding the installation of landscaping in association with the proposed phased development (copy of memo attached). Landscaping will be installed prior to the issuance of the CO for each unit. Prior to the issuance of a CO for units 2, 4, and 6, the landscaping will also be installed/planted along William Street and the existing structure.

Based on the above information, I have no objection to the proposed phased construction request. The conditions of the landscaping installation must be made a part of the agreement.

Karen DeMaria
Urban Forestry Manager

MEMORANDUM

TREPANIER

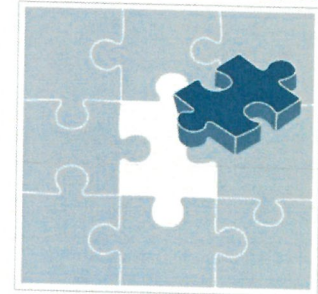

& ASSOCIATES INC
 LAND USE PLANNING
 DEVELOPMENT CONSULTANTS

Date: September 7, 2022 (revised)
To: Ms. Katie Halloran, City Planner
From: Thomas Francis-Siburg
CC: Mr. Paul Misch, Owner
 Mr. Owen Trepanier
Re: **1319 William Street-1316 Royal Street (RE# 00036920-000000)**
Condition Modification to Res. No. 21-197

This is the applicant response to DRC comments on 05/26/22 regarding the conditions of the Major Development Plan Res. No. 21-197 to relative to phasing.

DRC Comment:

Katie Halloran - Planning Director: BPAS approvals would expire prior to permits being pulled. A development agreement is the only mechanism to extend BPAS approvals. The current expiration date of the BPAS approval is 10/31/2023. Please review Secs. 90-360.B, 90-361, Sec. 108-203, and Sec. 108-248.

Applicant Response:

The proposed phasing shall require construction of Unit 4 to commence permitting prior to the expiration of its associated BPAS.

Phasing Plan

Phase	Units	ROGO		Commencement	Completion
		Type	Exp. Date		
1	1	Beneficial	NA	11/15/22 - Commenced	Progress and completion pursuant to the KW LDRs and Florida Building Code
	3	Beneficial	NA	11/15/22 - Commenced	
	5	BPAS	10/31/23	11/15/22 - Commenced	
2	4	BPAS	10/31/23	04/15/24 or prior to the expiration of the associated BPAS, whichever is sooner ¹	
	6	Beneficial	NA	04/15/24	
3	2	Beneficial	NA	04/15/26	

DRC Comment:

Karen DeMaria - Urban Forestry Manager: Landscape planting will need to be in coordination with phasing, COs will only be issued when there is substantial landscaping per house.

Applicant Response:

The portion of landscaping associated with and adjacent to each individual unit shall be installed prior to the issuance of the C.O. for each individual unit. Landscaping around the existing structures along William Street will be installed / planted prior to the issuance of the C.O. of units 2, 4, and 6.

¹ Expiration dates are subject to change pursuant to F.S. 252.363 (State of Emergency Extensions)

1319 Williams ST, Minor Modification to MDP



RESOLUTION NO. 21-197

RESOLUTION NO. 21-197

A RESOLUTION OF THE CITY COMMISSION OF THE CITY OF KEY WEST, FLORIDA, GRANTING APPROVALS FOR A MAJOR DEVELOPMENT PLAN, A LANDSCAPE WAIVER AND AN AFFORDABLE WORKFORCE HOUSING REQUIREMENT LINKAGE PROVISION FOR PROPERTY AT 1319 WILLIAM STREET AND 1316 ROYAL STREET UNITS #1-6 (RE# 00036920-000000) TO CONSTRUCT AND REDEVELOP EIGHT (8) RESIDENTIAL DWELLING UNITS LOCATED WITHIN THE HISTORIC MEDIUM DENSITY (HMDR) ZONING DISTRICT PURSUANT TO SECTIONS 108-91 A.2(A), SECTION 108-517, AND SECTION 122-1467(1)(B) OF THE LAND DEVELOPMENT REGULATIONS OF THE CODE OF ORDINANCES OF THE CITY OF KEY WEST, FLORIDA; PROVIDING FOR AN EFFECTIVE DATE.

WHEREAS, Section 108-91 of the Code of Ordinances (the "Code") of the City of Key West, Florida (the "City") provides that within the Historic District, a Major Development Plan is required for the addition or reconstruction of five or more permanent residential units; and

WHEREAS, the proposed use of the property is for the construction and redevelopment of eight residential dwelling units; and

WHEREAS, waivers to the City's landscaping requirements are pursuant to City Code Section 108-517; and

WHEREAS, requirements of the affordable work force housing ordinance and specifically, linkage of project provisions, are pursuant to 122-1467(1)(b); and

WHEREAS, Code Section 108-196(a) requires the Planning Board

to review and approve, approve with conditions or deny the proposed Major Development Plan in an advisory capacity to the City Commission; and

WHEREAS, Code Section 108-517(a) requires the Planning Board to consider the landscape waiver request and render the final action; and

WHEREAS, this matter came before and was approved by the Planning Board at a duly noticed public hearing on April 22, 2021, through Planning Board Resolution #2021-12; and

WHEREAS, the granting of a Major Development Plan and Landscape Waiver application is consistent with the criteria of the Code of Ordinances; and

WHEREAS, the City Commission finds that the granting of a Major Development Plan and Landscape Waiver application is in harmony with the general purpose and intent of the Land Development Regulations, and will not be injurious to the neighborhood, or otherwise detrimental to the public welfare; and

WHEREAS, the City Commission finds that the project at 1319 William Street & 1316 Royal Street complies with Section 122-1467(1)(b) so long as specific proposed conditions of approval related to the linked redevelopment project at 1703 Von Phister are also adopted together with this Major Development Plan; and

WHEREAS, the City Commission has moved to further modify the

proposed specific conditions of approval to include a modification to the affordable housing linkage provision to specify all median income AMI rental units for the duplex at 1703 Von Phister, as also agreed at the hearing by the applicant; and

WHEREAS, the applicant provided revised plans for the linked redevelopment project at 1703 VonPhister, dated June 24, 2021, by William Byron Shepler, after the Planning Board approval on April 22,2021; and

WHEREAS, staff has reviewed the revised plans for 1703 VonPhister and affirms they remain compliant with the required provisions of Section 122-1467(1)(b); and

NOW THEREFORE, BE IT RESOLVED BY THE CITY COMMISSION OF THE CITY OF KEY WEST, FLORIDA, AS FOLLOWS:

Section 1. That the above recitals are incorporated by reference as if fully set forth herein.

Section 2. The Major Development Plan, landscape waiver, and an affordable workforce housing requirement linkage provision for property at 1319 William Street and 1316 Royal Street Units #1-6 (RE# 00036920-000000) to construct and redevelop eight (8) dwellings units located within the Historic Medium Density (HMDR) zoning district pursuant to Section 108-91A.2.(A), Section 108-517, and Section 122-1467(1)(B) of the Land Development Regulations of

the Code of Ordinances of the City of Key West, Florida, as shown in the attached plans dated September 10, 2020 by William Byron Shepler, R.A., for 1319 and 1316 Royal Street Units #1-6, and revised plans dated June 24, 2021 by William Byron Shepler, is hereby approved with the following conditions:

General conditions:

1. The proposed construction at 1319 William Street and 1316 Royal Street shall be consistent with the site plan signed, sealed, and dated September 10, 2020 by William Byron Shepler, R.A.

2. Per Fire: Shall maintain the 20-foot driveway for emergency response. The owner is currently working on a fire sprinkler solution (yard hydrants) to be depicted on the signed and sealed plans that will need to be accepted by the Fire Marshal's office before issuance of a permit.

3. Per Urban Forester: Existing Page C-10 indicates the location of several swales to be constructed within the critical root zones of existing trees/ palms that are to remain. This page must be reconciled with the final landscape plan and the swales relocated so as not to impact

the root areas of those existing trees and palms to remain onsite.

4. During all phases of construction, temporary fencing and erosion barriers shall be installed and maintained. All adjacent City streets and sidewalks shall be kept clean and clear of construction debris.
5. Per Sections 108-412 and 108-482, the development plan shall require landscape maintenance in the short term for survivability and in perpetuity. The property owner shall be responsible for the maintenance of the landscaping but the HOA will have the right to step in if it is not maintained.
6. The proposed construction at 1703 VonPhister Street to satisfy the affordable housing linkage provision in Section 122-1467(1)(b), of the new two-story structure that will consist of two affordable deed restricted units shall be consistent with the site plan signed, sealed, and dated June 24, 2021, by William Byron Shepler, R.A. These two units shall be restricted for affordable housing (median income) as defined in City of Key West Code Section 122-1467, and the developer/property owners shall not increase the sales or rental above 100% area median income.

Conditions prior to the City Commission hearing:

7. The applicant shall obtain final landscape plan approval from the Tree Commission.
8. The Landscape and Irrigation Plans shall be signed, sealed, and dated prior to City Commission.
9. The applicant shall obtain a Certificate of Appropriateness from the Historic Architectural Review Committee (HARC).

Conditions prior to issuance of a building permit:

10. Approval of a Public Art Plan shall be obtained from the AIPP Board, pursuant to City Code Section 2-487, and may include payment of an in-lieu fee.
11. Prior to issuance of building permits the property owner shall record a deed restriction for the two-market rate units located within the two-story duplex at 1703 Von Phister property, approved by the City Attorney, and submitted into the Records of the Monroe County Clerk of the Court.

Conditions prior to issuance of a Certificate of Occupancy:

12. Prior to issuance of a Certificate of Occupancy for the Major Development Plan at 1319 William Street and 1316 Royal Street, the applicant shall complete all permitting, construction, inspections and receive a Certificate of Occupancy for the linked project at 1703 Von Phister Street. The two units at 1703 Von Phister shall be restricted for affordable housing (median income) as defined in City of Key West Code Section 122-1467, and the developer/property owners shall not increase the sales or rental above 100% area median income.

13. On-site artwork shall be installed and inspected by the City pursuant to Code Section 2-487.

Section 3. Full, complete and final application for all permits required for which this resolution is wholly or partly necessary, shall be submitted in its entirety within 12 months after the date hereof.

Section 4. This Major Development Plan and Landscape Waiver and Affordable Workforce Housing Linkage Provision application

approval by the City Commission does not constitute a finding as to ownership or right to possession of the property, and assumes, without finding, the correctness of the applicant's assertion of legal authority respecting the property.

Section 5. This resolution shall go into effect immediately upon its passage and adoption and authentication by the signatures of the presiding officer and the Clerk of the Board.

Section 6. This resolution is subject to appeal periods as provided by the City of Key West Code of Ordinances (including the Land Development Regulations). After the City appeal period has expired, this permit or development order shall be rendered to the Florida Department of Economic Opportunity. Pursuant to Chapter 73C-44, F.A.C., this permit or development order is not effective for 45 days after it has been properly rendered to the DEO with all exhibits and applications attached to or incorporated by reference in this approval; that within the 45-day review period, the DEO can appeal the permit or development order to the Florida Land and Water Adjudicatory Commission; and that such an appeal stays the effectiveness of the permit until the appeal is resolved by agreement or order.

Read and passed on first reading at a regularly scheduled meeting held this 14th day of September 2021.

Authenticated by the presiding officer and Clerk of the Commission on September 21, 2021.

Filed with the Clerk this 21st day of September, 2021.

Mayor Teri Johnston	<u>Yes</u>
Commissioner Gregory Davila	<u>Yes</u>
Commissioner Mary Lou Hoover	<u>Yes</u>
Vice Mayor Sam Kaufman	<u>Yes</u>
Commissioner Clayton Lopez	<u>Yes</u>
Commissioner Billy Wardlow	<u>Yes</u>
Commissioner Jimmy Weekley	<u>Yes</u>



TERI JOHNSTON, MAYOR

ATTEST:

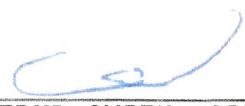

CHERYL SMITH, CITY CLERK

1319 Williams ST, Minor Modification to MDP



SITE PLAN

