

DEMOLITION NOTES
1. SAWCUT AND REMOVE ASPHALT AS REQUIRED TO FORM FACE OF CURB AND SIDEWALK.
2. REMOVE FENCE POST AND ROPING AS REQUIRED FOR NEW SIDEWALK. CITY TO REINSTALL.
3. CONTRACTOR TO GRIND OUT EXISTING PARKING LOT MARKINGS.

GENERAL NOTES
1. CONTRACTOR RESPONSIBLE FOR NOTIFYING RESIDENTS OF PARKING RESTRICTIONS 72 HOURS IN ADVANCE.
2. SIDEWALK/ WALKWAY CROSS SLOPE 2% MAX.
3. LANDINGS TO BE LEVEL W/ 2% MAX. SLOPE TOWARDS ROADWAY.
4. SIDEWALK/ WALKWAY RUNNING SLOPE SHALL BE NO GREATER THAN 1:20
5. CONTRACTOR RESPONSIBLE FOR PROPER DRAINAGE WHERE NEW ASPHALT IS PROVIDED.
6. PROVIDE PAVEMENT STRIPING AND SYMBOL AS SHOWN (THERMOPLASTIC).
7. SIDEWALKS/ WALKWAYS TO BE 5.0' IN WIDTH.
8. CONTRACTOR TO GRADE AROUND FLEXI-PAVE WALKWAY AS REQUIRED FOR ADA COMPLIANCE.

LEGEND	
S-1	-EXISTING HC PARKING SIGN (NIC) TO BE RELOCATED BY CITY
S-2	- EXISTING PARKING SIGN (NIC) TO BE RELOCATED BY CITY
S-3	- NEW W15-1 PARK SIGN (FLUORESCENT YELLOW-GREEN) (NIC) TO BE INSTALLED BY CITY
S-4	- NEW W11-2 W/ W16-P PEDESTRIAN CROSSING SIGN (FLUORESCENT YELLOW-GREEN)
T-1	- THATCH PALM TO BE RELOCATED WITHIN PARK
T-2	- BALOLLY TREE TO BE RELOCATED WITHIN PARK
T-3	- AVOCADO TREE TO BE RELOCATED WITHIN PARK OR REMOVED (REMOVAL BY CITY)
T-4	- CITRUS TREE TO BE REMOVED BY CITY

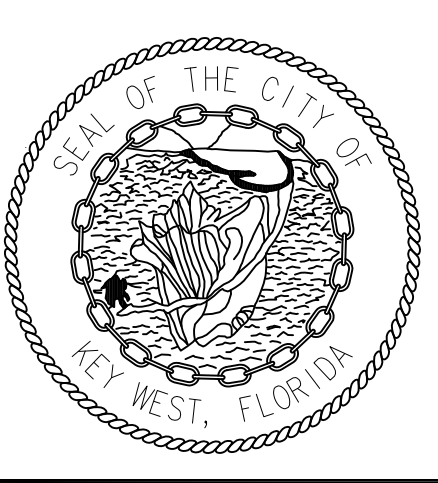
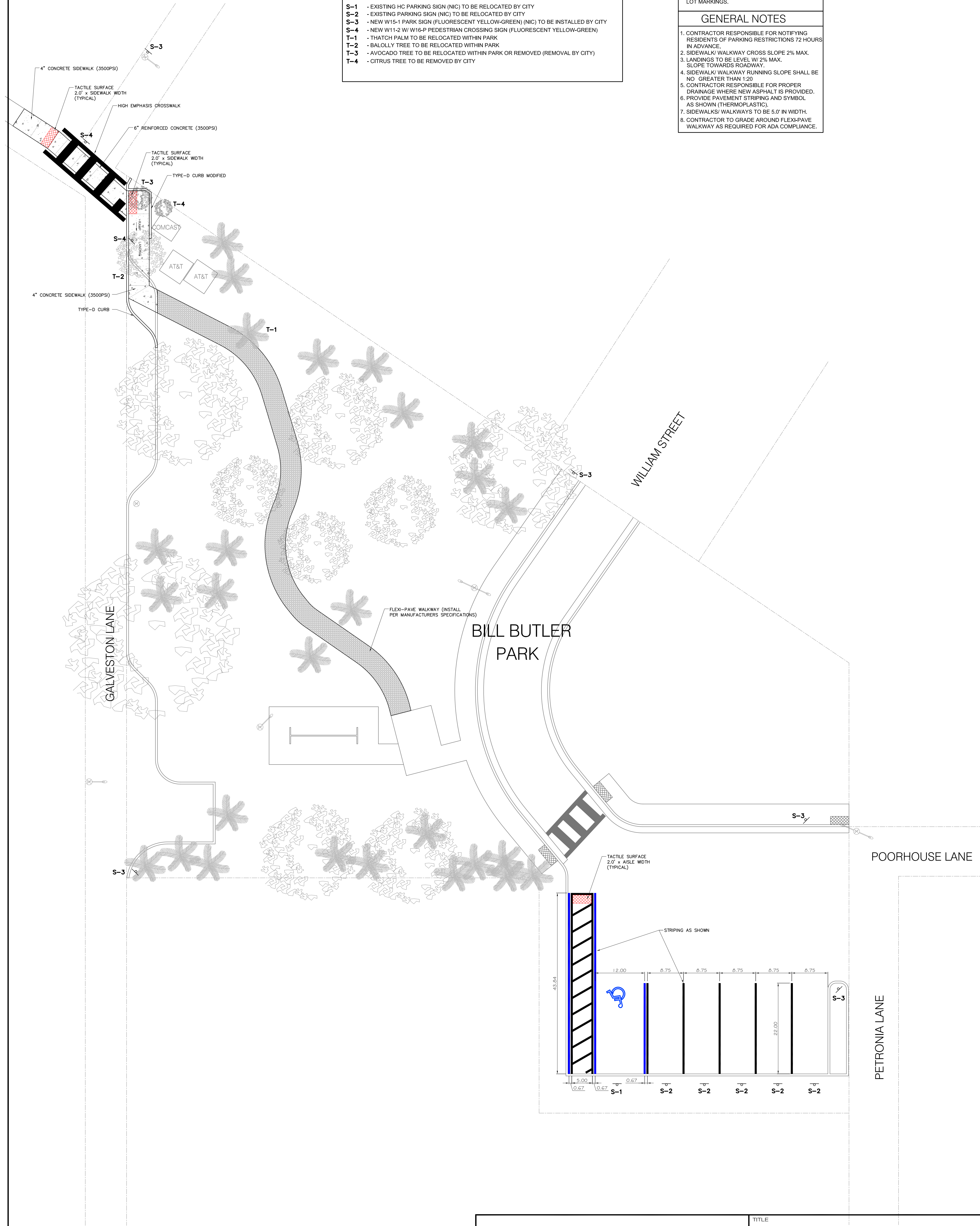

City of
Key West
Engineering Services
3140 Flager Avenue
Key West, FL 33040

TITLE BILL BUTLER PARK IMPROVEMENTS		
DESIGN KMO	PROPOSED SITE LAYOUT	PROJECT No.
DRAWN KMO		DWG. No.
CHKD J. Bouquet	GENERAL SERVICES CONTRACT	DATE 5-8-14
SCALE NOTED		SHEET 1 of 1