



AGENDA ITEM #

City of Key West Tree Commission

Tree Permit Application

PO Box 1409  
Key West, FL 33040  
Phone: 305-809-3764  
Fax: 305-809-3978

Home/Property Owner: Chris Schultz Date: 1-23-12  
Mailing Address: WATERFRONT BREWERY LLC  
915 SOUTHARD ST. #2 KEY WEST, FL 33040  
Owner Signature: [Signature] Owner Ph#: 305 849 0930  
Represented by: ELIZABETH NEULAND Rep. Ph#: 305 481 6301  
Represented by mailing address: PO BOX 140908, CORAL GABLES, FL 33114

Attendance at the Tree Commission meeting on the date when your request will be discussed is necessary in order to expedite the resolution of your application.

A letter of representation from the owner must accompany this application if the owner is unable to attend.

Letter of Representation ( 4 )

Tree(s) Address: 201 WILLIAM STREET Cross/Corner Street: CAROLINE  
Common Name(s): 1 THICINAX RADIATA Scientific Name(s): THATCH PALM 3'x3'  
3 SERENOA REPENS SAW PALMETTO 3'x3'  
Species Type(s) (check all that apply): PHOTOS OF 4 EXISTING PALMS ATTACHED  
 Palm ( ) Flowering ( ) Fruit ( ) Shade

Reason(s) for Application (check all that apply):

- REMOVE
- Tree Health
- Safety
- Other / Explain
- TRANSPLANT
- New Location
- Same Property
- Other / Explain
- HEAVY MAINTENANCE
- Branch Removal
- Crown Cleaning/Thinning
- Crown Reduction

Reason(s) for request:

BUILDING RENOVATION AND LANDSCAPE/HARDSCAPE IMPROVEMENTS. SEE ATTACHED PROPOSED LANDSCAPE PLAN

Replacement plant material must be Florida Grade #1. Replacement of a palm with a native palm is required. Replacement of a canopy tree with a native canopy tree is required. If you need assistance with replacements, please call the Landscape Department at 305-809-3764.

<<<< Sketch location of tree in this area including cross/corner Street >>>>

Provide access for viewing tree(s) prior to meeting  
Identify tree(s) with colored tape

AGENDA ITEM #

SEE ATTACHED PHOTOS OF  
EXISTING PALMS.

SEE ATTACHED LANDSCAPE PLAN.

SEE ATTACHED EXISTING VEGETATION  
PLAN FOR REMOVAL LOCATIONS.

Tree Species \_\_\_\_\_

Circumference \_\_\_\_\_ ÷ 3.14 = diameter \_\_\_\_\_

Location \_\_\_\_\_ % Species \_\_\_\_\_ % Condition \_\_\_\_\_ % Total Average Value \_\_\_\_\_ %

Avg. value \_\_\_\_\_ X \_\_\_\_\_ Diameter = \_\_\_\_\_

Replacement Inches

LOCATION: OLD CITY HALL, 510 GREENE STREET, 5:00 p.m.

FOR TREE COMMISSION USE ONLY.

( ) TABLED ( ) APPROVED ( ) DENIED ( ) FURTHER ACTION

COMMENTS: \_\_\_\_\_

\_\_\_\_\_

CHAIRPERSONS SIGNATURE/DATE

City Engineer comments if required: \_\_\_\_\_

\_\_\_\_\_

ENGINEER'S SIGNATURE/DATE



THE CITY OF KEY WEST  
TREE COMMISSION

Post Office Box 1409, Key West, FL 33041-1409 (305) 809-3764

AUTHORIZATION LETTER

CHRIS SCHULTZ  
WATERFRONT BREWERY, LLC  
915 Southard St. #2  
Key West, FL 33040

Print clearly, name, address

Dear Tree Commissioners:

This letter is authorization and confirmation that I, Chris Shultz,  
(owner name, print)

have retained ELIZABETH NEWLAND  
(representative name, address and phone number, print)

to represent me in the matter of obtaining a permit from the City of Key West Tree Commission for my  
property at: 201 WILLIAM STREET, KEY WEST, FL 33040  
(tree address, print)

You may contact me at 305 849 0930. Thank you.  
(telephone number)

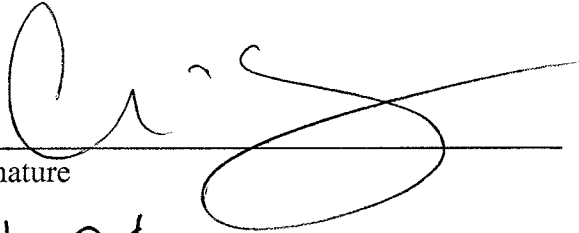
  
Signature

1-24-12  
Date

WILLIAM P. HORN  
ARCHITECT, P.A.

ONE EIGHT SEVEN  
KEY WEST  
FLORIDA  
34894

TEL: 305-888-2800  
FAX: 305-888-2800  
LICENSE NO.  
A-10000

WATERFRONT BREWERY  
201 WILLIAM STREET  
KEY WEST NIGHT FL.

SCALE

THIS PLAN WAS PREPARED BY  
WILLIAM P. HORN ARCHITECT, P.A.  
REGISTERED ARCHITECT  
FLORIDA LICENSE NO. A-10000

DATE  
11-11-11  
12:41:11 PM

REVISIONS

DRAWN BY  
EMA

PROJECT  
NUMBER  
1113

EX-2

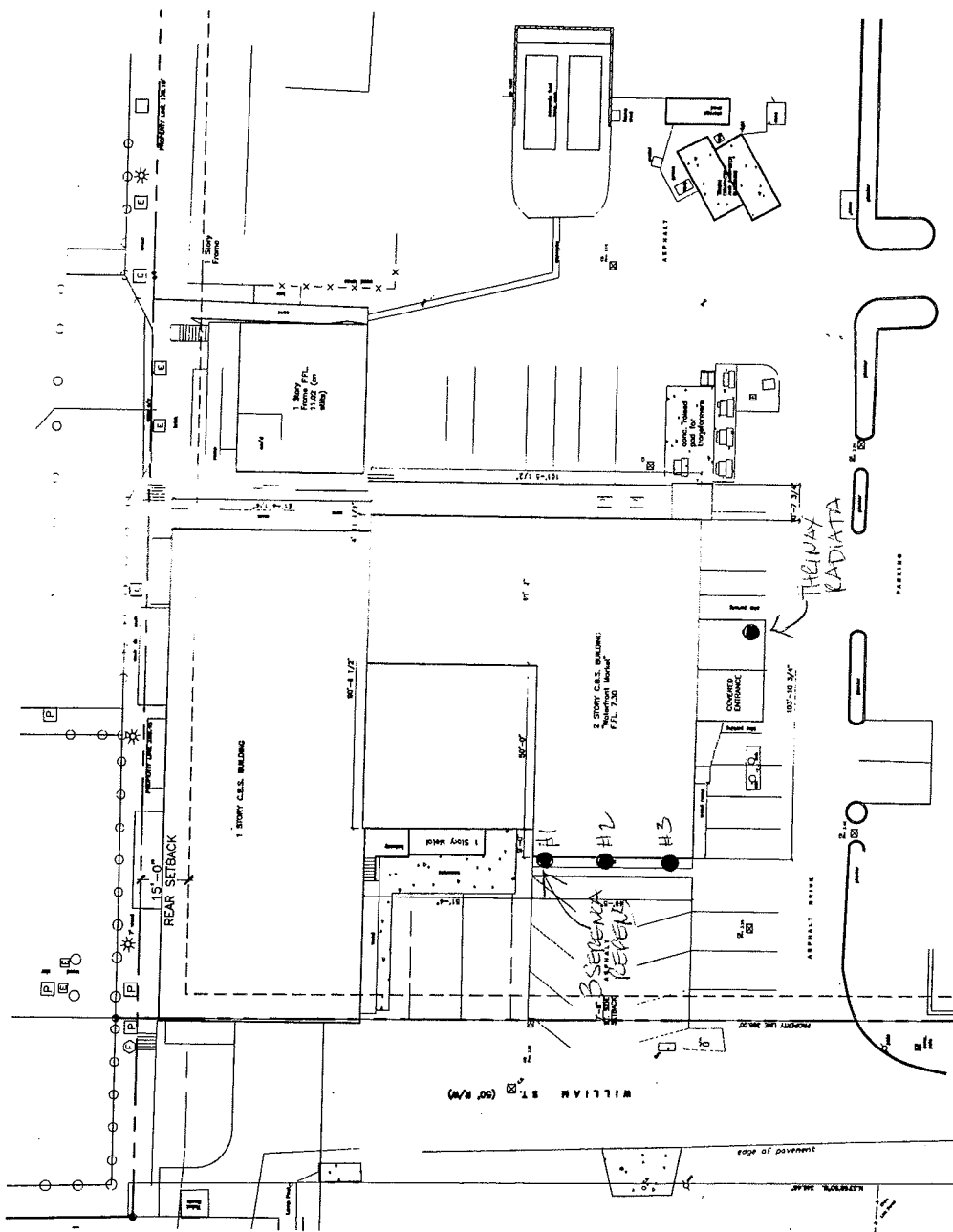

EXISTING SITE PLAN - ROOF PLAN  
SCALE: 1/8" = 1'-0"  
SITE PLAN BASED ON INFORMATION OBTAINED FROM SURVEY, PREPARED  
BY FREDERICK R. HILDEBRANDT, SURVEYOR DATED ON 02-27-06

EXISTING VEGETATION  
TO BE REMOVED

WATERFRONT BREWERY  
201 WILLIAM STREET  
KEY WEST NIGHT, FLORIDA

THIRUVA  
RADIATA



SERENDA PEPEUS  
#1



SENECA REPELS  
#2



SERENDA REPAS

#3



