

SCOPE OF WORK MEMORANDUM

2/22/2017

RELOCATE KWPD PORT SECURITY GUARDHOUSE (CONEX) AT MOLE PIER ENTRANCE

Provide lump sum price for the following work to include all labor, material, administration, overhead, and profit. Refer to attached figure with Item # key. Provide breakdown of lump sum price by Item #.

Scope includes the following Work Items:

1. Place concrete-paver pad for two rectangular tents @ 20' x 40'. Pad is slightly larger than tent footprint as show on attached diagram. Approx. 2,070 square feet. (Pavers per attached cut sheet placed on compacted local sand. Edges stabilized per recommendation of installer.)
 - a. Please provide alternate price for 4" concrete slab in lieu of pavers:
 - Level, compacted gravel sub-base, min. 6"
 - 4,000 psi concrete
 - 6" thickened edge
 - 6x6x6 WWM
 - Broom finish
 - Expansion joints nominally 20' OC
 - Sawcuts nominally 10' OC.
2. Form and pour two 4" concrete sidewalks (ADA-compliant) connecting existing sidewalk to two guardhouse door locations. Approx. 50 sq. ft.
3. Set a 30' class 5 wood pole as shown for temporary electrical service.
4. Install temporary 100A/240V electric service (existing meter moved from opposite side of road). Place meter housing, riser, weatherhead, ground and 100A disconnect at pole.
5. Coordinate with Keys Energy for relocation of meter and extension of aerial service drop.
6. Clear and grub as necessary and place a 40' x 10' level, compacted #57 stone bed to support an 8' x 40' shipping container (conex) converted to KWPD guardhouse.
7. Place stub ups for utility connections: electrical, water, sewer. (Permanent connections for these are provided for under the Amphitheater project.)
8. Relocate conex to prepared site.
9. Connect temporary electrical service from conex to new pole (underground 2" UV-PVC).
10. Place 240V/20A outlet for restroom trailer with in-service weatherproof cover on pole. (Coordinate outlet spec with Marcus Davila, CKW Public Works.)
11. Provide temporary water connection (1/2") to bathroom trailer using existing Navy meter.

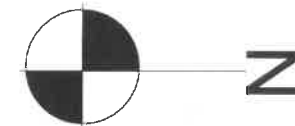

11 1/2" FLEXIBLE WATER LINE
APPROX. 280 L.F.
ON GROUND ALONG FENCE
DIRECT-BURIED @ 6"
ELSEWHERE.
(TEMPORARY SERVICE)

8 OVERHEAD SERVICE DROP
(BY KEYS ENERGY)

10 TEMPORARY RESTROOM
AIR-CONDITIONED TRAILER
(BY CKW)
20A / 240V OUTLET ON
TEMP. POLE (BY DLP)

3 PLACE 30'-5 WOODEN POLE
METER, RISER, 100A DISC.
4 FOR TEMP. POWER SERVICE

9 2" UV-PVC UG FEEDER
(3) #2 & (1) #6 GND

5 10' x 42' PAD
6 LEVEL, COMPACTED
#57 STONE

125A LOAD CENTER
(INSIDE CONEX)

EXISTING
NAVY
GATE

NAVY SETBACK

7 EXISTING CONEX
TO BE RELOCATED

EXISTING TENT
TO BE
RELOCATED

2" PVC 24" BELOW FINISHED GRADE
(INCL. IN AMPH. SCOPE--PLACE BEFORE PAVERS)

1" WATER SERVICE - PE TUBING
(INCLUDED IN AMPH. SCOPE
PLACE BEFORE PAVERS.
SEE 33 11 00-2.01D)

EXISTING TENT
TO BE
RELOCATED

EXISTING ASPH. RD.

TEMP. BYPASS ROAD

PROPOSED RELOCATION OF
KWPD SECURITY OFFICE
AT MOLE PIER ENTRANCE
T. JUSTICE 305-809-3943 22 FEB 2017

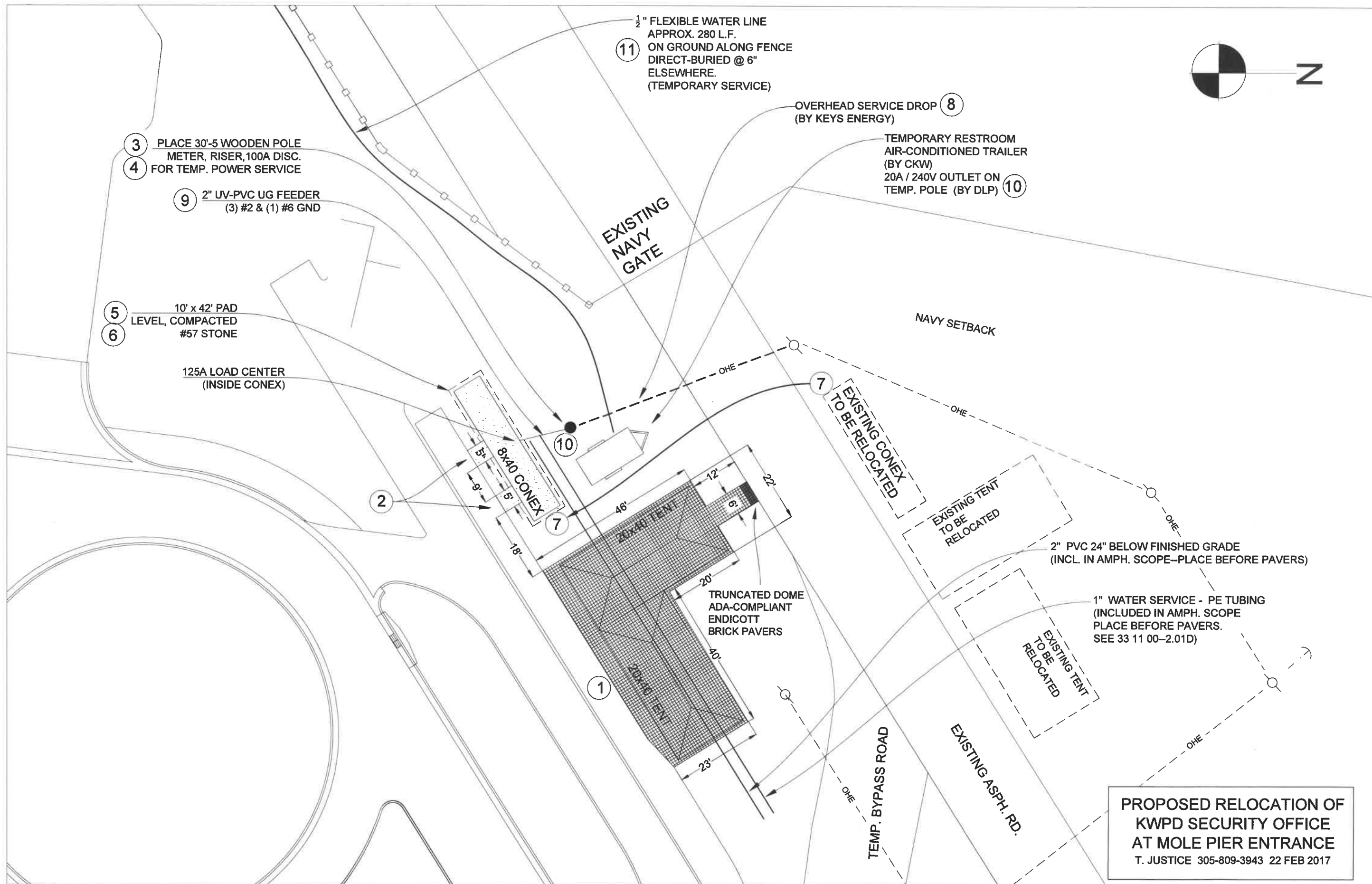



Holland Stone



Standard Finish-Part # H6



Antiqued Texture Finish-Part # TH6

Product	Size	Centimeter (Thickness)	Layers Per Cube	Sq. Ft. Per Cube	Pieces Per Cube	Weight/lbs Per Cube	Bands Per Cube	Sq. Ft. Per Band	Weight/lbs Per Band	Pieces Per Band	Pieces Per Sq. Ft.
Holland Stone	4" x 8" x 2 3/8"	6	9	96	432	2500	6	16	417	72	4.5

Holland Stone comes in Standard & Antiqued™ Texture Finish. Colors: 02=charcoal, 03=ant.gray, 04=red, 05=red flash, 09=brn flash, 36=butternut & 47=hickory.
Made to order 08=brown and 69=walnut.



Physical Requirements (ASTM C-936)

- 1. Compressive strength-the average compressive strength shall not be less than 8000 P.S.I.
- 2. Resistance to Freeze Thaw Cycle-dry weight loss not to be greater than 1% of weight when subjected to 50 cycles of freezing and thawing.
- 3. Absorption-the average absorption of test samples shall not be greater than 5%.
- 4. Made according to ASTM C936 Specifications.



CST Pavers
23 Ridge Road
Branchville, NJ 07826
Ph# 973-948-7193

CST Pavers
43 Leonards Drive
Montgomery, NY 12549
Ph# 845-457-4491

www.cstpavers.com



©2016 by CST Pavers a Pavestone Company. All rights reserved.

SCOPE OF WORK MEMORANDUM

2/22/2017

12. Coordinate with Key West Community Services Department who will perform the following:
- Place helical screw anchors and attach to relocated conex.
 - Relocate two tents after pad is prepared by DLP.
 - Deliver and connect restroom trailer to water and electric service.

Work is to be completed during scheduled window in cruise ship calendar: March 18 – 24 and/or April 12-17, 2017